

three inches = one foot
one and one half inches = one foot
one inch = one foot
three quarters inch = one foot
one half inch = one foot
three eighths inch = one foot
one quarter inch = one foot
one eighth inch = one foot

GRAPHIC SCALE
(IN FEET)
1 inch = 30 ft.

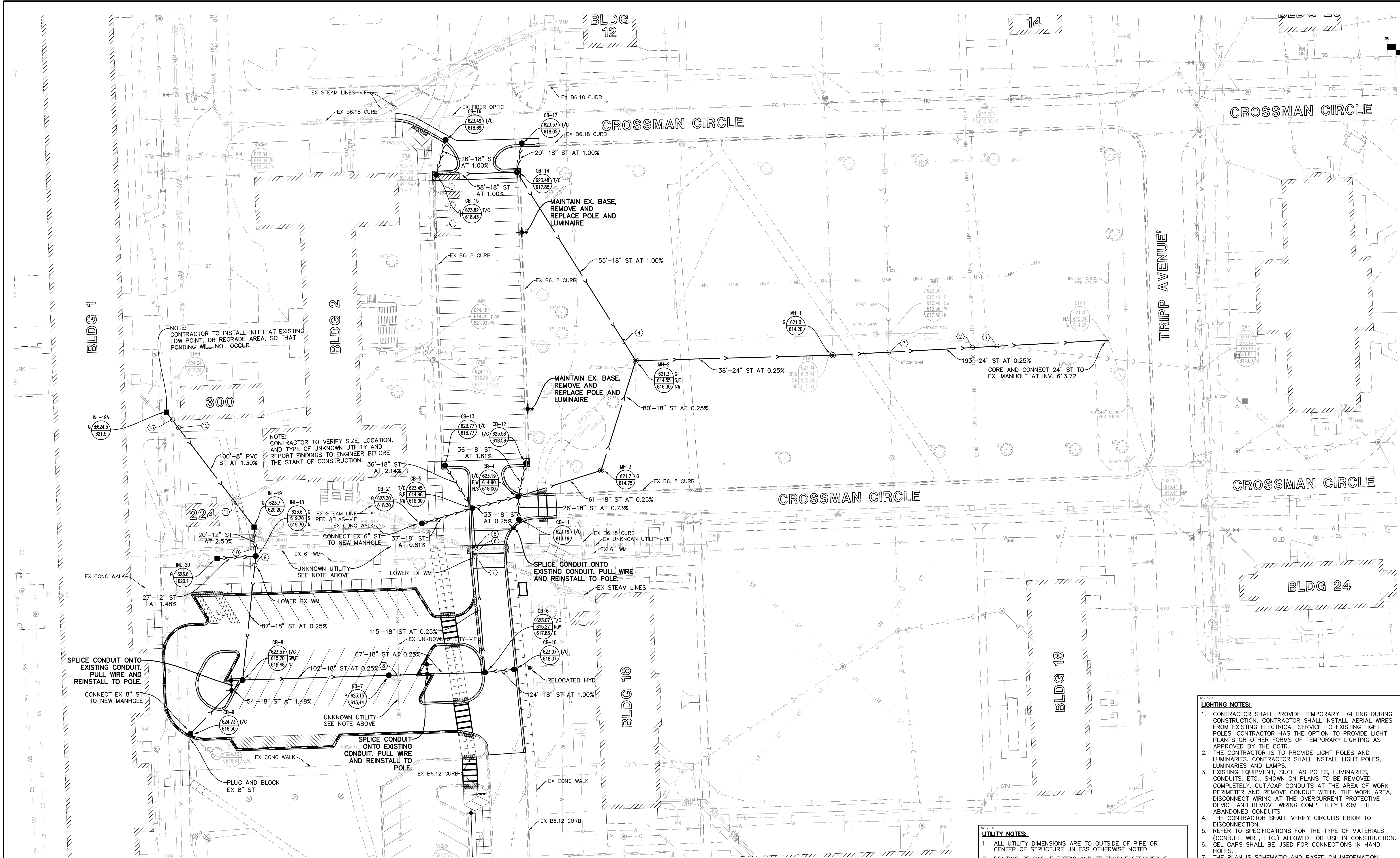

MATERIAL STANDARDS		
ITEM	BRAND	PRODUCT
PIPE JOINTS (TRAFFIC MODEL)	MUELLER SUPER CONTURION	A-423 WB-67
GATE VALVES (SPECIFY SIZE, NON-RISING STEM, 2" NUT, M.J., OPEN LEFT)	MUELLER (SIZE) AMERICAN FLOW CONTROL	A-2360-200 SERIES 2500
VALVE BOXES	EAST JORDAN TYLER/UNION	SCREW ADJUSTING EXTENSION TYPE
CURB STOPS (SPECIFY SIZE)	MUELLER FORD	300 BALL VALVE BALL VALVE
CORPORATION VALVE (SPECIFY SIZE)	MUELLER FORD	H-15000 F8600 (ANNA/CC THREAD)
MANHOLES/CATCHBASINS/INLETS (SELF-SEALING LID WITH PROPER UTILITY MARKINGS)	NEENAH CLOSED LID OPEN LID	R-1772 R-1772 C R-4340 B
CURB FRAMES & GRATES (BICYCLE SALES)	NEENAH ROLL MOUNTABLE CURB	R-3501-D2A R-3201A
WATER SERVICE SADDLES (ALL SERVICE SADDLES SHALL BE DOUBLE STRAP, BRONZE, NYLON COATED OR STAINLESS STEEL)	MUELLER FORD SMITH-BLAIR 3/4" & 1"	RP25 PS-303 # 317
R-BOX ARCH PATTERN PLUG STYLE LID	FORD MUELLER	EA2 CURB BOX
*1 WHEREVER STORMWATER COULD POSSIBLY ENTER STORM STRUCTURE		
MATERIAL STANDARDS		

LEGEND

PULL BOX

STREET LIGHT - TYPE EF-1 (SHORT ARM-BLACK)
STREET LIGHT - TYPE EF-2 (HIGH HAT)
STREET LIGHT - TYPE EF-3A (SINGLE ARM-SILVER)
STREET LIGHT - TYPE EF-3B (DOUBLE ARM-SILVER)
STREET LIGHT - TYPE EF-4 (ILLUMINATED COLUMN)
STREET LIGHT - TYPE EF-5 (WALL LIGHT)

1" MINIMUM SIZE CONDUIT OR AS NOTED ON THE PLANS (SCHEDULE 40 IN LANDSCAPED AREAS AND SCHEDULE 80 UNDER ROAD OR OTHER PAVED AREAS)

- UTILITY NOTES.
- ALL UTILITY DIMENSIONS ARE TO OUTSIDE OF PIPE OR CENTER OF STRUCTURE UNLESS OTHERWISE NOTED.
 - ROUTING OF GAS, ELECTRIC AND TELEPHONE SERVICES IF SHOWN ARE APPROXIMATE ONLY AND SUBJECT TO CHANGE BASED UPON FINAL REVIEW AND APPROVAL BY RESPECTIVE UTILITY COMPANIES AND OWNER. CONTRACTOR SHALL CONTACT EACH UTILITY COMPANY AND COORDINATE FINAL LOCATIONS FOR ALL UTILITY SERVICES PRIOR TO START OF CONSTRUCTION.
 - CONTRACTOR SHALL EXCAVATE AND VERIFY ALL EXISTING SEWER OR WATER MAIN LOCATIONS, SIZES, CONDITIONS & ELEVATIONS AT PROPOSED POINTS OF CONNECTION PRIOR TO ANY UNDERGROUND CONSTRUCTION AND NOTIFY THE OWNER OF ANY DISCREPANCIES OR CONFLICTS.
 - LIGHTING AND UNDERGROUND CABLE IF SHOWN ON PLANS ARE FOR APPROXIMATE LOCATION ONLY. REFER TO ARCHITECTURAL PLANS FOR SPECIFICATIONS AND DETAILS.
 - THE CONTRACTOR SHALL ADJUST RIM ELEVATIONS OF ALL EXISTING STRUCTURES TO PROPOSED GRADES AS INDICATED ON PLANS.
 - ALL UNDERGROUND IMPROVEMENTS SHALL BE CONSTRUCTED AND TESTED IN ACCORDANCE WITH THE STANDARD SPECIFICATIONS FOR WATER AND SEWER MAIN CONSTRUCTION IN ILLINOIS AND STANDARD SPECIFICATIONS FOR ROAD AND BRIDGE CONSTRUCTION, DEPARTMENT OF TRANSPORTATION, STATE OF ILLINOIS. IN THE EVENT OF CONFLICTING GUIDELINES, THE MORE RESTRICTIVE SHALL GOVERN.
 - CONTRACTOR SHALL VERIFY DEPTH AND LOCATION OF EXISTING DRY UTILITIES PRIOR TO CONSTRUCTION AND SHALL NOTIFY ENGINEER OF ANY CONFLICTS.
 - IN THE CONSTRUCTION AREA, EXISTING PIPES THAT ARE TO REMAIN SHALL BE CLEANED WITH A JET OF WATER.

- LIGHTING NOTES.
- CONTRACTOR SHALL PROVIDE TEMPORARY LIGHTING DURING CONSTRUCTION. CONTRACTOR SHALL INSTALL AERIAL WIRES FROM EXISTING ELECTRIC SERVICE TO EXISTING LIGHT POLES. CONTRACTOR HAS THE OPTION TO PROVIDE LIGHT PLANTS OR OTHER FORMS OF TEMPORARY LIGHTING AS APPROVED BY THE COTR.
 - THE CONTRACTOR IS TO PROVIDE LIGHT POLES AND LUMINARIES. CONTRACTOR SHALL INSTALL LIGHT POLES, LUMINARIES AND LAMPS.
 - EXISTING EQUIPMENT, SUCH AS POLES, LUMINARIES, CONDUITS, ETC., SHOWN ON PLANS TO BE REMOVED COMPLETELY. CUT/CAP CONDUITS AT THE AREA OF WORK PERIMETER AND REMOVE CONDUIT WITHIN THE WORK AREA. DISCONNECT WIRING AT THE OVERCURRENT PROTECTIVE DEVICE AND REMOVE WIRING COMPLETELY FROM THE ABANDONED CONDUITS.
 - THE CONTRACTOR SHALL VERIFY CIRCUITS PRIOR TO DISCONNECTION.
 - GEL CAPS SHALL BE USED FOR CONNECTIONS IN HAND HOLES.
 - THE PLAN IS SCHEMATIC AND BASED ON INFORMATION SUPPLIED BY THE OWNER. DUE TO THE NATURE OF CONSTRUCTION FIELD MODIFICATIONS MAY BE NECESSARY TO IMPLEMENT PLAN. CONTRACTOR TO OBTAIN WRITTEN CONFIRMATION OF THE MODIFICATIONS WITH THE COTR PRIOR TO PROCEEDING WITH THE WORK.
 - CONTRACTOR SHALL VERIFY ALL DIMENSIONS, ELEVATIONS, EQUIPMENT AND UTILITY LOCATIONS WITH OWNER PRIOR TO BEGINNING WORK.
 - CONTRACTOR SHALL PUSH ALL CONDUIT UNDER EXISTING PAVEMENT UNLESS OTHERWISE APPROVED BY THE OWNER. ALL CONDUIT UNDER PAVEMENT SHALL BE GALVANIZED STEEL CONDUIT.
 - CONTRACTOR SHALL COORDINATE WITH OWNER THE LOCATION OF ALL EXISTING TELEPHONE AND FIBER OPTIC CIRCUITS PRIOR TO DISCONNECTION.
 - REMOVE ALL ACCESSIBLE ABANDONED WIRING OF ALL TYPES, OR CAP AND LABEL IN JUNCTION BOX FOR RE-USE, IN COMPLIANCE WITH THE NATIONAL ELECTRIC CODE.
 - MAINTAIN AND RESTORE, IF INTERRUPTED, ALL CONDUITS AND CONDUCTORS PASSING THROUGH RENOVATED AREAS AND SERVICING UNDISTURBED AREAS.
 - UNLESS NOTED OTHERWISE, ALL LIGHTING FOR KANSAS LOT SHALL BE FED FROM PANEL IN BUILDING 16.
 - CONTRACTOR SHALL PROVIDE PHOTOCELL TIME CLOCK FOR EACH LIGHTING CIRCUIT. PHOTOCELL TIME CLOCK SHALL BE LOCATED ON A NEW LIGHT POLE WITHIN THAT CIRCUIT. CONTRACTOR TO DETERMINE MOST EFFICIENT ROUTING OF WIRING FOR CIRCUITS. FINAL LOCATION OF PHOTOCELL TIME CLOCK TO BE APPROVED BY COTR.
 - REFER TO LUMINAIRE SCHEDULE FOR POLE HEIGHTS.

UTILITY CROSSINGS	
24" RCP STM OVER 8" VCP SAN B/P 24" RCP STM = 613.66 T/P 8" VCP SAN = 612.4 CLEARANCE = ±1.3'	18" RCP STM AT EX. UNKNOWN UTILITY EX. UNKNOWN UTIL. (PER ATLAS) - V.I.F. B/P 18" RCP STM = 617.13 T/P 18" RCP STM = 615.21 EX. GROUND ELEV. = 624.0
24" RCP STM AT EX. UNKNOWN UTILITY EX. UNKNOWN UTIL. (PER ATLAS) - V.I.F. T/P 24" RCP STM = 616.20 B/P 18" RCP STM = 613.70 EX. GROUND ELEV. = 621.0	LOWER EX. 6" WATER MAIN 18" RCP STM OVER EX. 6" WATER MAIN B/P 18" RCP STM = 615.47 T/P 6" WATER MAIN = 617.97 CLEARANCE = 1.5' MIN.
24" RCP STM OVER 8" VCP SAN B/P 24" RCP STM = 613.85 T/P 18" RCP STM = 612.6 CLEARANCE = ±1.3'	18" RCP STM AT EX. UNKNOWN UTILITY EX. UNKNOWN UTIL. (PER ATLAS) - V.I.F. B/P 18" RCP STM = 616.57 EX. GROUND ELEV. = 624.1
18" RCP STM OVER 8" VCP SAN B/P 18" RCP STM = 616.24 T/P 8" VCP SAN = 614.7 CLEARANCE = ±1.5'	8" PVC STM AT EX. UNKNOWN UTILITY EX. UNKNOWN UTIL. (PER ATLAS) - V.I.F. T/P 8" PVC STM = 621.25 B/P 6" PVC STM = 620.40 EX. GROUND ELEV. = 624.6
18" RCP STM AT EX. UNKNOWN UTILITY EX. UNKNOWN UTIL. (PER ATLAS) - V.I.F. T/P 18" RCP STM = 616.76 B/P 18" RCP STM = 614.84 EX. GROUND ELEV. = 621.0	8" PVC STM OVER EX. 8" STORM T/P EX. 8" RCP STM = ±618.35 B/P PROP. 8" PVC STM = 621.25 CLEARANCE = ±2.9'
18" RCP STM OVER EX. STEAM LINES B/P 24" STM = 614.85 T/P STEAM LINES = V.I.F. EX. GROUND ELEV. = 623.7	8" PVC STM OVER EX. 8" WM B/P 8" PVC STM = 621.30 T/P 8" WM = ±619.0 CLEARANCE = ±2.3' - V.I.F.
LOWER EX. 6" WATER MAIN 18" RCP STM OVER EX. 6" WATER MAIN B/P 18" RCP STM = 614.86 T/P 6" WATER MAIN = ±613.36 CLEARANCE = 1.5' MIN.	
UTILITY CROSSING NOTES:	
1. CONTRACTOR SHALL POTHOLE ALL UTILITY CROSSING LOCATIONS PRIOR TO CONSTRUCTION AND REPORT FINDINGS TO ENGINEER.	
2. WATER AND SEWER CROSSINGS SHALL MEET STATE EPA SEPARATION AND PIPE MATERIAL REQUIREMENTS. (SEE DETAIL SHEET)	
3. CROSSINGS 1, 3 & 4 SHALL HAVE A CONCRETE COLLAR PLACED AROUND THE SANITARY SEWER IN ACCORDANCE WITH THE DETAIL.	

Revised Per VA Comments
Construction Amendment 1

04/18/12
05/17/12

Revisions

Date

CONSULTANTS:

Cowhey Manhard
A MANHARD CONSULTING DIVISION

Jacobs/Ryan Associates
Landscape Architects
1527 North Sandburg Terrace Chicago, Illinois 60610 (312) 664-3217

ARCHITECT / ENGINEER:

TRAFFIC ANALYSIS & DESIGN, INC.

Drawing Title
BUILDING 2
UTILITY AND LIGHTING PLAN

Approved Project Director

Project Title
Edward J. Hines Jr. VA Hospital
Reconfigure Parking Lots-Phase 4

Location
HINES, ILLINOIS

Date
03/29/12

Checked
BJA

Drawn
BDM

Project Number
578-12-090

Building Number
BLDG 2

Drawing Number
C-205

Dwg. of

Office of Construction and Facilities Management
Department of Veterans Affairs