

three inches = one foot
one and one half inches = one foot
one inch = one foot
three quarters inch = one foot
one half inch = one foot
three eighths inch = one foot
one quarter inch = one foot
one eighth inch = one foot

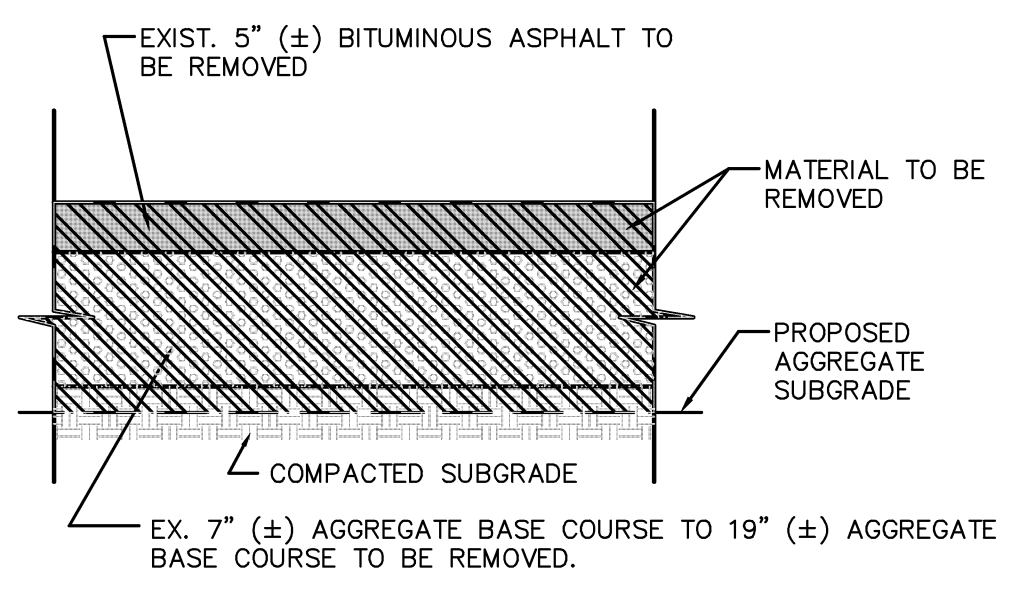

NOTE:
DEPTHS OF ASPHALT AND AGGREGATE TO BE REMOVED ARE BASED ON THE SOILS REPORT BY TSC DATED 04/12/12. PAVEMENT CORES 10 & 11. CONTRACTOR SHALL REMOVE ALL ASPHALT & AGGREGATE. ALL COST ASSOCIATED WITH THIS WORK SHALL BE INCIDENTAL TO THE CONTRACT.

CONTRACTOR SHALL FOLLOW THE RECOMMENDATIONS FROM THE SOIL REPORT.

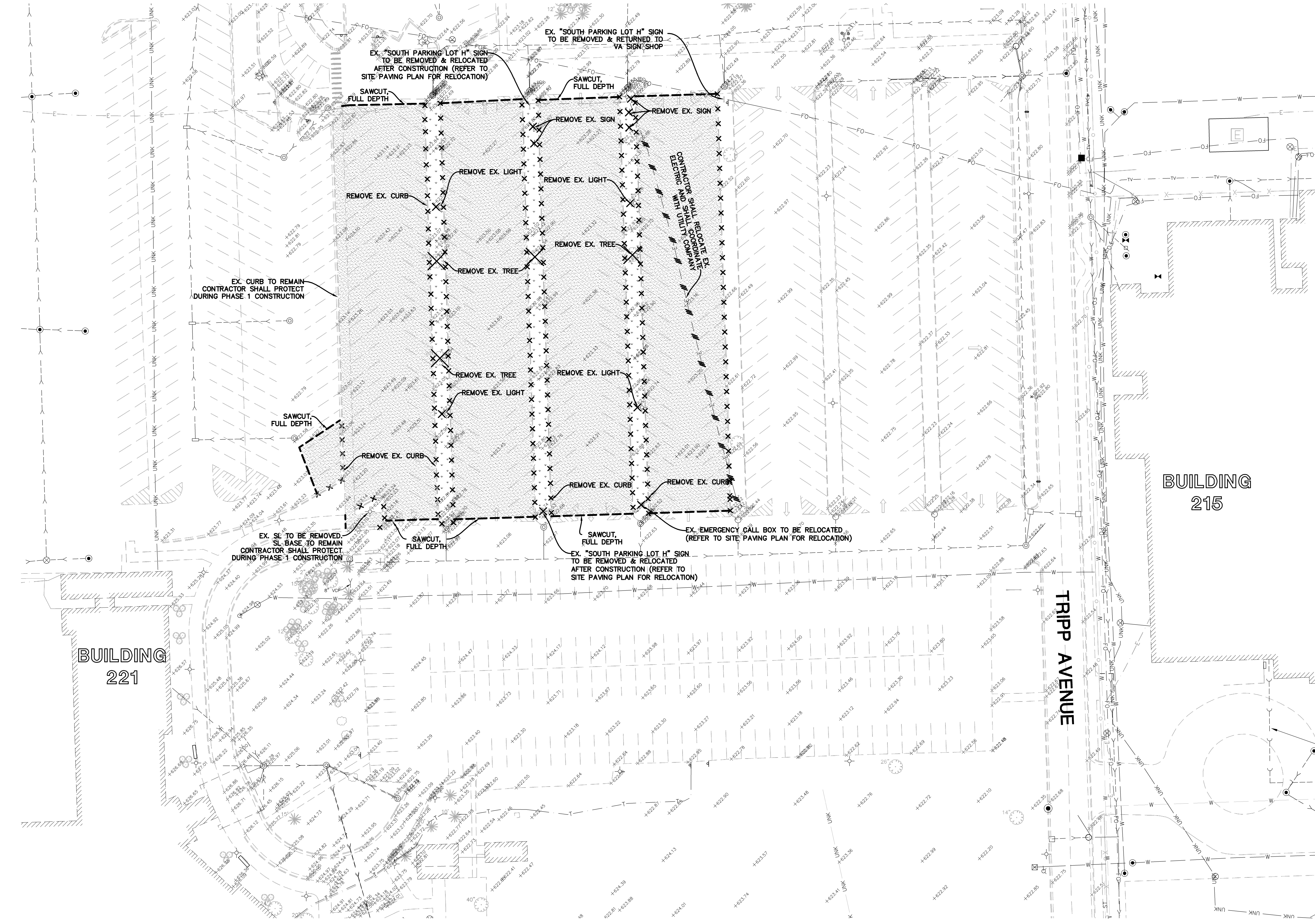
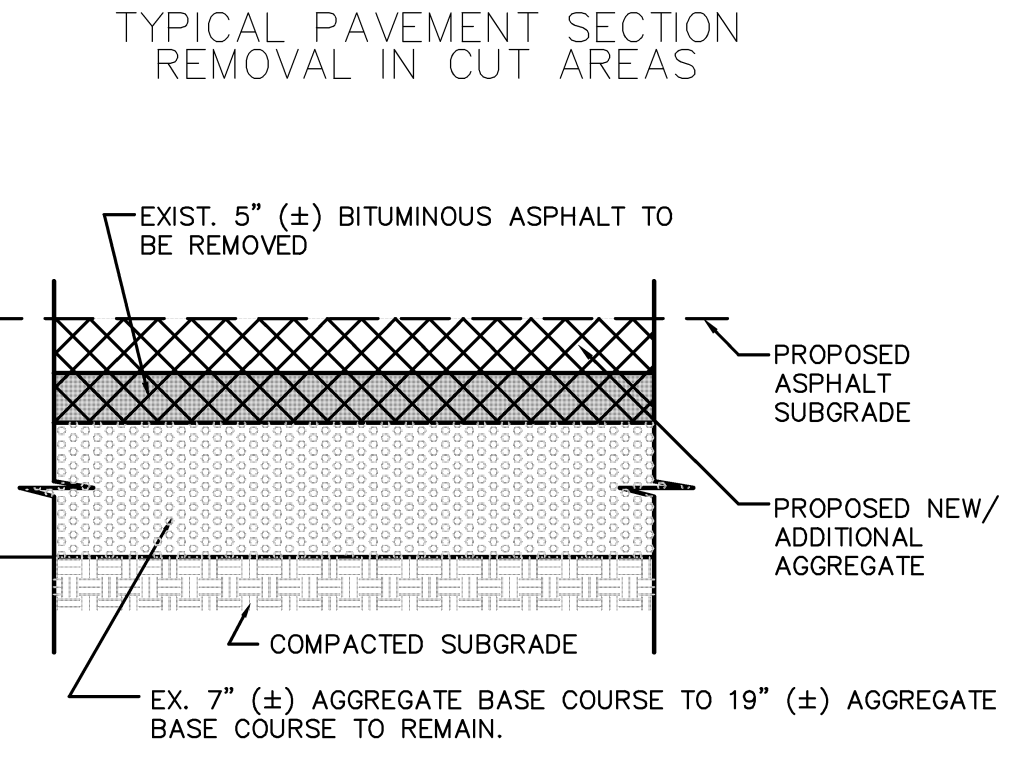

NOTES:
DEPTHS OF ASPHALT AND AGGREGATE TO BE REMOVED ARE BASED ON THE SOILS REPORT BY TSC DATED 04/12/12. SOIL BORINGS 11 & 13. CONTRACTOR SHALL REMOVE ALL ASPHALT TO SUBGRADE ELEVATION, OR TO SUITABLE SUBGRADE MATERIAL AS REQUIRED. ALL COST ASSOCIATED WITH THIS WORK SHALL BE INCIDENTAL TO THE CONTRACT.

CONTRACTOR SHALL TEST EXISTING SUBGRADE TO ENSURE SUBGRADE MEETS A COMPACTION OF 95% DENSITY. IF SUBBASE DOES NOT MEET STANDARDS, THE CONTRACTOR SHALL REMOVE THE AGGREGATE, PROOF ROLL THE SUBGRADE AND REPLACE WITH NEW AGGREGATE.

CONTRACTOR SHALL POTHOLE EXISTING AGGREGATE TO DETERMINE THE ACTUAL DEPTH. PROPOSED AGGREGATE DEPTH MUST EQUAL WHAT IS SPECIFIED ON THE PAVING PLAN.

CONTRACTOR SHALL FOLLOW THE RECOMMENDATIONS FROM THE SOIL REPORT.

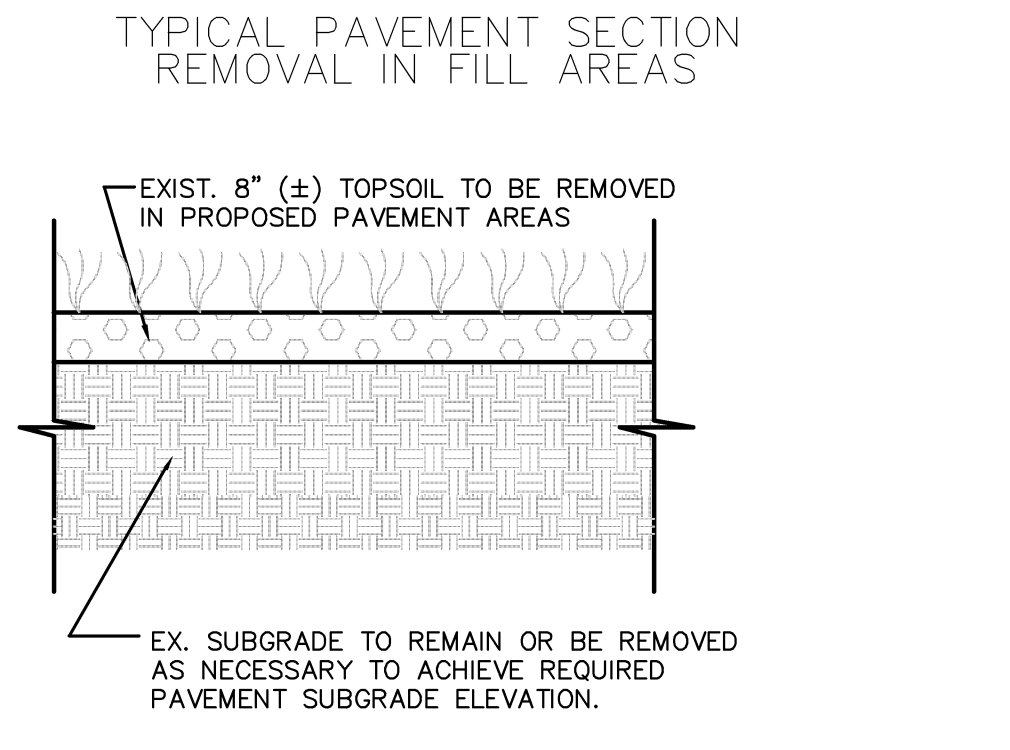

NOTES:
DEPTHS OF TOPSOIL TO BE REMOVED IS BASED ON THE SOILS REPORT BY TSC DATED 04/12/12. SOIL BORINGS 11 & 13. CONTRACTOR SHALL REMOVE ALL TOPSOIL. ALL COST ASSOCIATED WITH THIS WORK SHALL BE INCIDENTAL TO THE CONTRACT.

DEMOLITION LEGEND	
	FULL DEPTH PAVEMENT/CONCRETE/ SIDEWALK AND BASE TO BE REMOVED
	REMOVE EXISTING TOPSOIL
	FENCE, RETAINING WALL, RAILROAD TIES, POLES, CURB AND GUTTER, ETC. TO BE REMOVED
	UTILITY STRUCTURE TO BE REMOVED
	UTILITY LINE REMOVAL
	REFER TO LANDSCAPE PLANS FOR TREE PRESERVATION AND REMOVAL
	TO BE REMOVED
	SAWCUT PAVEMENT, FULL DEPTH
	CONSTRUCTION FENCE

- DEMOLITION NOTES:**
- THE CONTRACTOR IS RESPONSIBLE FOR DEMOLITION, REMOVAL AND DISPOSAL (IN A LOCATION APPROVED BY ALL GOVERNING AUTHORITIES) OF ALL STRUCTURES, PADS, WALLS, FENCES, FOUNDATIONS, PARKING, DRIVES, DRAINAGE STRUCTURES, UTILITIES, ETC., SUCH THAT THE IMPROVEMENTS SHOWN ON THESE PLANS CAN BE CONSTRUCTED. ALL FACILITIES TO BE REMOVED SHALL BE UNDERCUT TO SUITABLE MATERIAL AND BROUGHT TO GRADE WITH SUITABLE COMPACTED FILL MATERIAL PER THE SPECIFICATIONS.
 - HAUL OFF AND DISPOSAL OF ALL MATERIALS SHALL BE INCIDENTAL TO THE CONTRACT.
 - THE CONTRACTOR IS RESPONSIBLE FOR REMOVING ALL DEBRIS FROM THE SITE AND DISPOSING THE DEBRIS IN A LAWFUL MANNER.
 - THE CONTRACTOR SHALL REMOVE ALL TOPSOIL AND UNSUITABLE MATERIAL BELOW NEW AND EXISTING PARKING LOT AND ROADWAY AREAS. REFER TO THE SOILS REPORT FOR DEPTHS.
 - THE CONTRACTOR IS RESPONSIBLE FOR OBTAINING ALL PERMITS REQUIRED FOR DEMOLITION AND DISPOSAL.
 - THE CONTRACTOR SHALL COORDINATE WITH HINES VA HOSPITAL AND THE RESPECTIVE UTILITY COMPANIES PRIOR TO THE REMOVAL AND/OR RELOCATION OF UTILITIES. THE CONTRACTOR SHALL COORDINATE WITH THE UTILITY COMPANY CONCERNING PORTIONS OF WORK WHICH MAY BE PERFORMED BY THE UTILITY COMPANY'S FORCES AND ANY FEES WHICH ARE TO BE PAID TO THE UTILITY COMPANY FOR THEIR SERVICES. THE CONTRACTOR IS RESPONSIBLE FOR PAYING FOR ALL FEES AND CHARGES.
 - THE CONTRACTOR IS RESPONSIBLE FOR REMOVING THE EXISTING IRRIGATION SYSTEM IN THE AREAS OF PROPOSED IMPROVEMENTS. THE CONTRACTOR SHALL CAP THE EXISTING IRRIGATION SYSTEM TO REMAIN SUCH THAT THE REMAINING SYSTEM SHALL CONTINUE TO FUNCTION PROPERLY.
 - THE PARKING LOT SHALL BE COMPLETED IN SECTIONS SO THAT IT DOES NOT INTERRUPT THE FACILITY OPERATIONS. BOTH VEHICULAR AND PEDESTRIAN. THE CONTRACTOR SHALL COORDINATE WITH THE C.O.T.R. FOR WORK TO BE PERFORMED.
 - THE LOCATIONS OF ALL EXISTING UTILITIES SHOWN ON THIS PLAN HAVE BEEN DETERMINED FROM THE BEST INFORMATION AVAILABLE AND ARE GIVEN FOR THE CONVENIENCE OF THE CONTRACTOR. THE ENGINEER ASSUMES NO RESPONSIBILITY FOR THEIR ACCURACY. PRIOR TO THE START OF ANY DEMOLITION ACTIVITY, THE CONTRACTOR SHALL LOCATE THE EXISTING UTILITIES AND NOTIFY ENGINEER OF ANY CONFLICTS.
 - ALL EXISTING UTILITIES SHOWN ARE NOT TO BE INTERPRETED AS THE EXACT LOCATION, AS THE ONLY OBSTACLES THAT MAY OCCUR ON THE SITE. CONTRACTOR SHALL VERIFY EXISTING CONDITIONS AND PROCEED WITH CAUTION AROUND ANY ANTICIPATED UTILITIES.
 - ELECTRICAL, TELEPHONE, CABLE, WATER, FIBER OPTIC CABLE AND/OR GAS LINES NEEDING TO BE REMOVED SHALL BE COORDINATED WITH THE AFFECTED UTILITY COMPANY.
 - CONTRACTOR MUST PROTECT THE PUBLIC AT ALL TIMES. CONSTRUCTION FENCING SHALL BE PLACED AROUND THE PERIMETERS OF THE PROJECT, ALLOWING ACCESS ON THE ROADWAYS AND PEDESTRIAN PATHS THAT ARE TO REMAIN OPEN. TEMPORARY WAY FINDING SIGNS AND JERSEY BARRIERS SHALL BE USED TO GUIDE VEHICLES AND PEDESTRIANS THRU CONSTRUCTION ZONES. ELECTRONIC SIGN BOARDS SHALL BE USED TO ASSIST IN ROUTING TRAFFIC. OTHER APPROPRIATE BEST MANAGEMENT PRACTICES SHALL BE FOLLOWED.
 - CONTINUOUS ACCESS SHALL BE MAINTAINED FOR SURROUNDING PROPERTIES AT ALL TIMES DURING DEMOLITION.
 - PRIOR TO DEMOLITION OCCURRING, ALL EROSION CONTROL DEVICES ARE TO BE INSTALLED.
 - SHOULD REMOVAL AND/OR RELOCATION ACTIVITIES DAMAGE FEATURES INDICATED TO REMAIN, THE CONTRACTOR SHALL PROVIDE NEW MATERIALS/STRUCTURES IN ACCORDANCE WITH THE CONTRACT DOCUMENTS, EXCEPT FOR MATERIALS DESIGNED TO BE RELOCATED ON THIS PLAN, ALL OTHER CONSTRUCTION MATERIALS SHALL BE NEW.
 - CONTRACTOR MAY LIMIT SAW-CUT AND PAVEMENT REMOVAL TO ONLY THOSE AREAS WHERE IT IS REQUIRED AS SHOWN ON THESE CONSTRUCTION PLANS, HOWEVER IF ANY DAMAGE IS INCURRED ON ANY OF THE SURROUNDING PAVEMENT, ETC. THE CONTRACTOR SHALL BE RESPONSIBLE FOR ITS REMOVAL AND REPAIR.
 - CONTRACTOR SHALL MAINTAIN ALL EXISTING PARKING AREAS, SIDEWALKS, DRIVES, ETC. CLEAR AND FREE FROM ANY CONSTRUCTION ACTIVITY AND/OR MATERIAL TO ENSURE EASY AND SAFE PEDESTRIAN AND VEHICULAR TRAFFIC TO AND FROM THE SITE. CONTRACTOR SHALL COORDINATE/PHASE ALL CONSTRUCTION ACTIVITY WITHIN PROXIMITY OF THE BUILDING AND UTILITY INTERRUPTIONS WITH THE C.O.T.R. TO MINIMIZE DISTURBANCE AND INCONVENIENCE TO FACILITY OPERATIONS.
 - THE CONTRACTOR SHALL COORDINATE WATER MAIN WORK WITH THE FIRE DEPARTMENT AND THE JURISDICTIONAL GOVERNING ENTITY TO PLAN THE PROPOSED IMPROVEMENTS AND TO ENSURE ADEQUATE FIRE PROTECTION IS CONSTANTLY AVAILABLE TO THE FACILITY AND SITE THROUGHOUT THIS SPECIFIC WORK AND THROUGH ALL PHASES OF CONSTRUCTION. CONTRACTOR SHALL BE RESPONSIBLE FOR ARRANGING/PROVIDING ANY REQUIRED WATER MAIN SHUT OFFS WITH THE JURISDICTIONAL GOVERNING ENTITY DURING CONSTRUCTION. ANY COSTS ASSOCIATED WITH WATER MAIN SHUTS OFFS WILL BE THE RESPONSIBILITY OF THE CONTRACTOR AND NO EXTRA COMPENSATION WILL BE PROVIDED.
 - CONTRACTOR SHALL PROVIDE ADEQUATE SITE LIGHTING DURING CONSTRUCTION SO THAT BOTH PEDESTRIANS AND VEHICLES CAN TRAVEL SAFELY THRU THE CONSTRUCTION AREA.
 - CONTRACTOR IS RESPONSIBLE FOR MAINTAINING DRAINAGE ON SITE DURING CONSTRUCTION. SITE DRAINAGE SHALL BE FREE OF ALL BLOCKAGE AND OBSTACLES AT THE END OF EACH DAY.

Revised Per VA Comments	04/18/12
Construction Amendment 1	05/17/12
Revisions	Date

CONSULTANTS:

Cowhey Manhard
A MANHARD CONSULTING DIVISION

Jacobs/Ryan Associates
Landscape Architects

1527 North Sandburg Terrace Chicago, Illinois 60610 (312) 664-3217

STEPSTEIN

ARCHITECT / ENGINEER:

TRAFFIC ANALYSIS & DESIGN, INC.

Drawing Title
KANSAS LOT
DEMOLITION PLAN - PHASE 1

Approved Project Director

Project Title
Edward J. Hines Jr. VA Hospital
Reconfigure Parking Lots-Phase 4

Location
HINES, ILLINOIS

Date
03/29/12

Checked
BJA

Drawn
MPS

Project Number
578-12-090

Building Number
BLDG 221

Drawing Number
C-301

Dwg. of

Office of
Construction
and Facilities
Management

Department of
Veterans Affairs