

one eighth inch = one foot
0 4 8 16
one quarter inch = one foot
0 4 8
one half inch = one foot
0 4
three eighths inch = one foot
0 4
one half inch = one foot
0 4
three quarters inch = one foot
0 4
one inch = one foot
0 6
one and one half inches = one foot
0 6
three inches = one foot
0 6

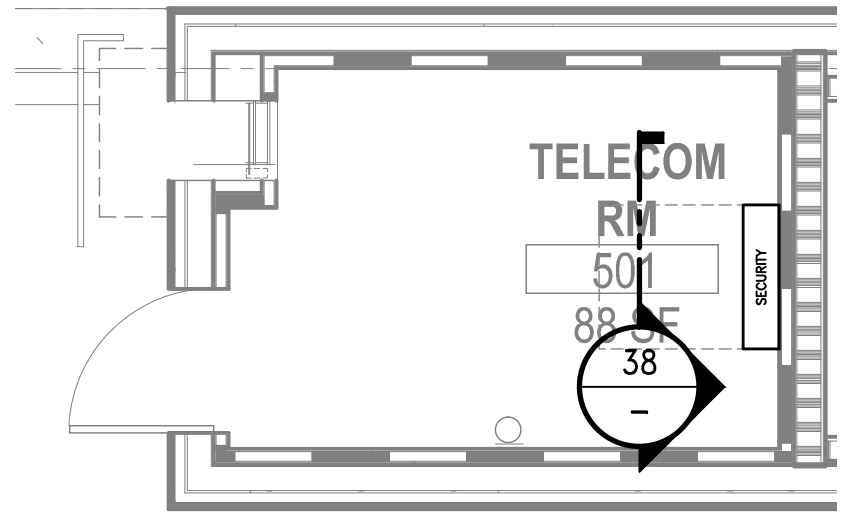

54 SOUTH IDF - ROOM PLAN
SCALE: 1/4" = 1'-0"

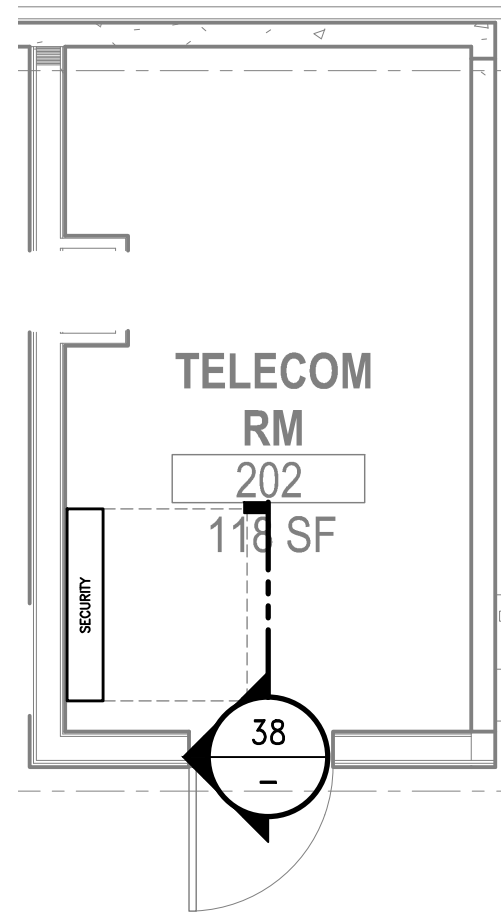

52 NORTH IDF - ROOM PLAN
SCALE: 1/4" = 1'-0"

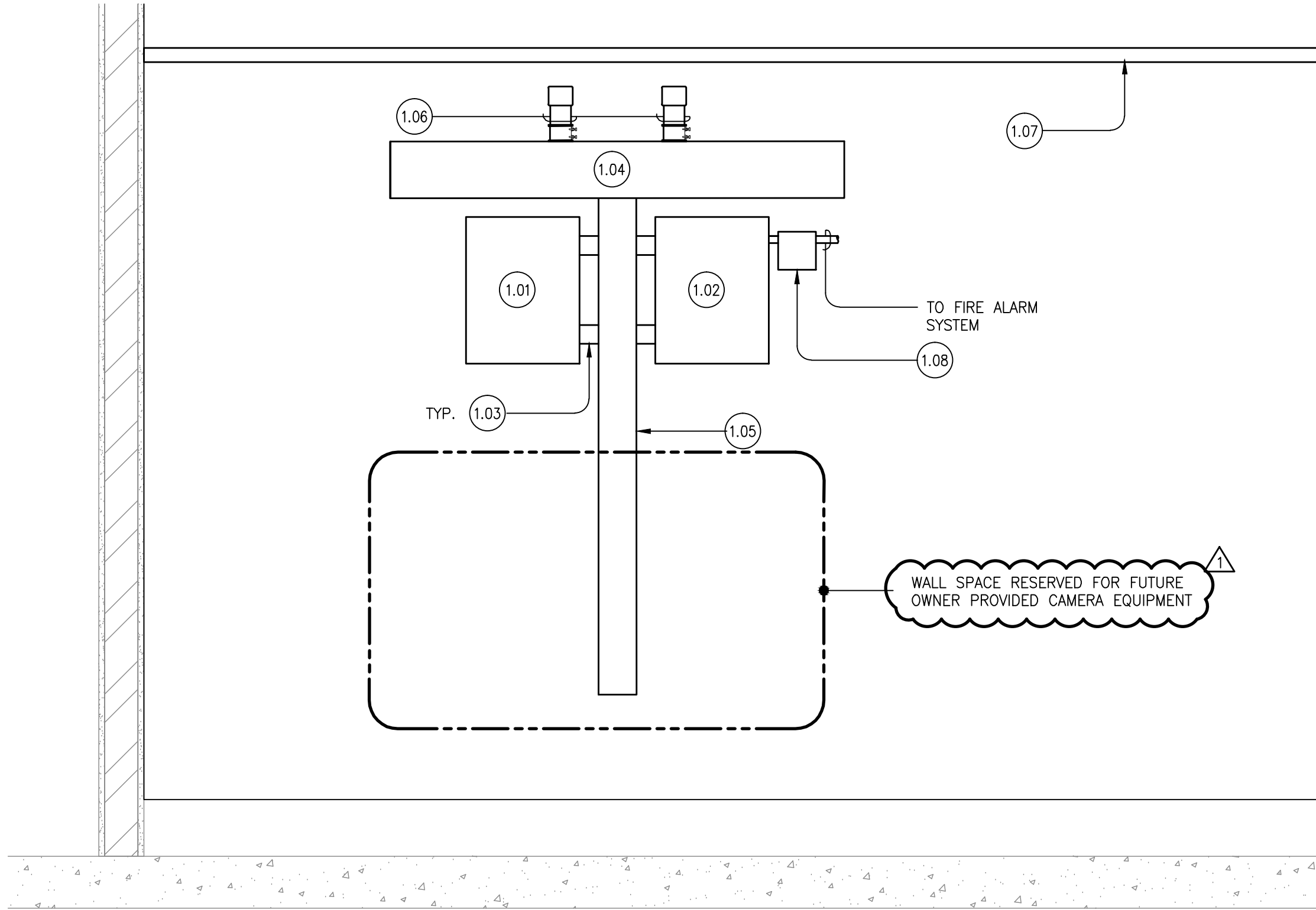

38 EQUIPMENT ELEVATION
SCALE: 1" = 1'-0"

SHEET NOTES

1. HOMERUN CABLE TO EACH EMERGENCY PHONE TO TELECOM ROOMS AND DO NOT DAISY CHAIN.
2. PROVIDE ACU'S AND POWER SUPPLIES AS REQUIRED TO HANDLE THE SECURITY FIELD EQUIPMENT SHOW ON THE FLOOR PLANS.
3. COORDINATE INSTALLATION WITH OTHER TRADES.
4. COORDINATE ROOM EQUIPMENT LAYOUT WITH VE RESIDENT ENGINEER.
5. FIRESTOP PENETRATIONS (SLEEVES AND CONDUITS) THROUGH RATED WALLS AND FLOORS/DECKS TO MATCH RATING.
6. PROVIDE KNOCK-ON BUSHINGS ON CONDUIT AND SLEEVE ENDS.
7. LABEL CONDUITS AT BOTH ENDS. LABEL MUST INDICATE CONDUITS USE FOR SECURITY CABLES ONLY AND LOCATION THE CONDUITS FAR END TERMINATION.
8. REFER TO ELECTRICAL DRAWINGS FOR POWER INFORMATION.

KEYNOTES

- 1.01 ACCESS CONTROL SYSTEM (ACU)
- 1.02 24VDC (LOCK POWER SUPPLY) / 12VDC DEVICE POWER SUPPLY
- 1.03 PROVIDE 2" CHASE NIPPLE BETWEEN SCREW COVER GUTTER WIRE RACEWAY AND SECURITY EQUIPMENT ENCLOSURE.
- 1.04 PROVIDE 36"x6"x6" NEMA-1 SCREW COVER GUTTER WIRE RACEWAY FOR SECURITY CABLING.
- 1.05 PROVIDE 60"x6"x6" NEMA-1 SCREW COVER GUTTER WIRE RACEWAY FOR SECURITY CABLING.
- 1.06 PROVIDE 2" CHASE CONDUITS STUBBED BELOW CABLE LADDER RACEWAY.
- 1.07 OVERHEAD CABLE RUNWAY PROVIDED BY TELECOM. REFER TO TELECOM ROOM PLANS FOR RUNWAY LOCATION.
- 1.08 UTILIZE FIRE INTERFACE RELAY TO CONNECT THE SECURITY SYSTEM TO THE FIRE ALARM SYSTEM.

CONSTRUCTION DOCUMENTS

<div>Revisions:</div> <div>ADDENDUM 1</div> <div>09/18/2013</div> <div>Date</div>	<div>CONSULTANTS:</div> <div><div><div></div><div>TEECOM</div></div><div>1333 BROADWAY STE 601 OAKLAND CA 94612 510-337-2800 510-337-2804 FAX</div><div>TEECOM has undertaken considerable measures to protect the confidentiality of its proprietary information. This document contains information that is the confidential and proprietary property of TEECOM and may not be copied, published, or disclosed to others, or used for any other purpose than review by consent, without the express written consent of an authorized officer of TEECOM. This document must be kept in a file designated as "TEECOM" and kept confidential when not being reviewed as result of consent.</div><div>COPYRIGHT 1997-2012 TEECOM. ALL RIGHTS RESERVED.</div></div>	<div>Seals and Signatures</div> <div><div>REGISTERED PROFESSIONAL ENGINEER No. 17587 LARRY A. ANDERSON ELECTRICAL</div></div>	<div>ARCHITECT/ENGINEERS:</div> <div><div><div>SMITHGROUP</div><div>architecture engineering interiors planning</div></div><div>301 BATTERY STREET, 7TH FLOOR SAN FRANCISCO, CA 94111 T 415.227.0100 F 415.862.7718 www.smithgroup.com</div><div>Associate Architect: The Design Partnership LLP Architects + Planners 1412 VAN NESS AVE., 2ND FLOOR SAN FRANCISCO, CA 94109 T 415.777.3737 F 415.777.3476 www.dpsf.com</div></div>	<div>Drawing Title</div> <div>SECURITY ROOM PLANS AND EQUIPMENT ELEVATION</div> <div>Approved Project Director</div> <div><div>Antonio Brucetius</div></div>	<div>Project Title</div> <div>CENTERS FOR AMBULATORY CARE, POLYTRAUMA AND BLIND REHABILITATION Parking Structure 2</div> <div>Location</div> <div>3801 Miranda Ave., Palo Alto CA</div> <div>Date</div> <div>01 FEB 2013</div> <div>Checked</div> <div>JS</div> <div>Drawn</div> <div>SA</div>	<div>Project Number</div> <div>640-424</div> <div>Building Number</div> <div>701</div> <div>Drawing Number</div> <div>TY4.0.1</div>	<div>Office of Construction and Facilities Management</div> <div>Department of Veterans Affairs</div>