

L:\Server\Project Data\1031\Trng\_VAMC\_V03\09\_Replace\_Physical\_Access\_Security\_System\000\_Dwg\Plan\Plan\_Base.dwg May 07, 2012 - 7:55am

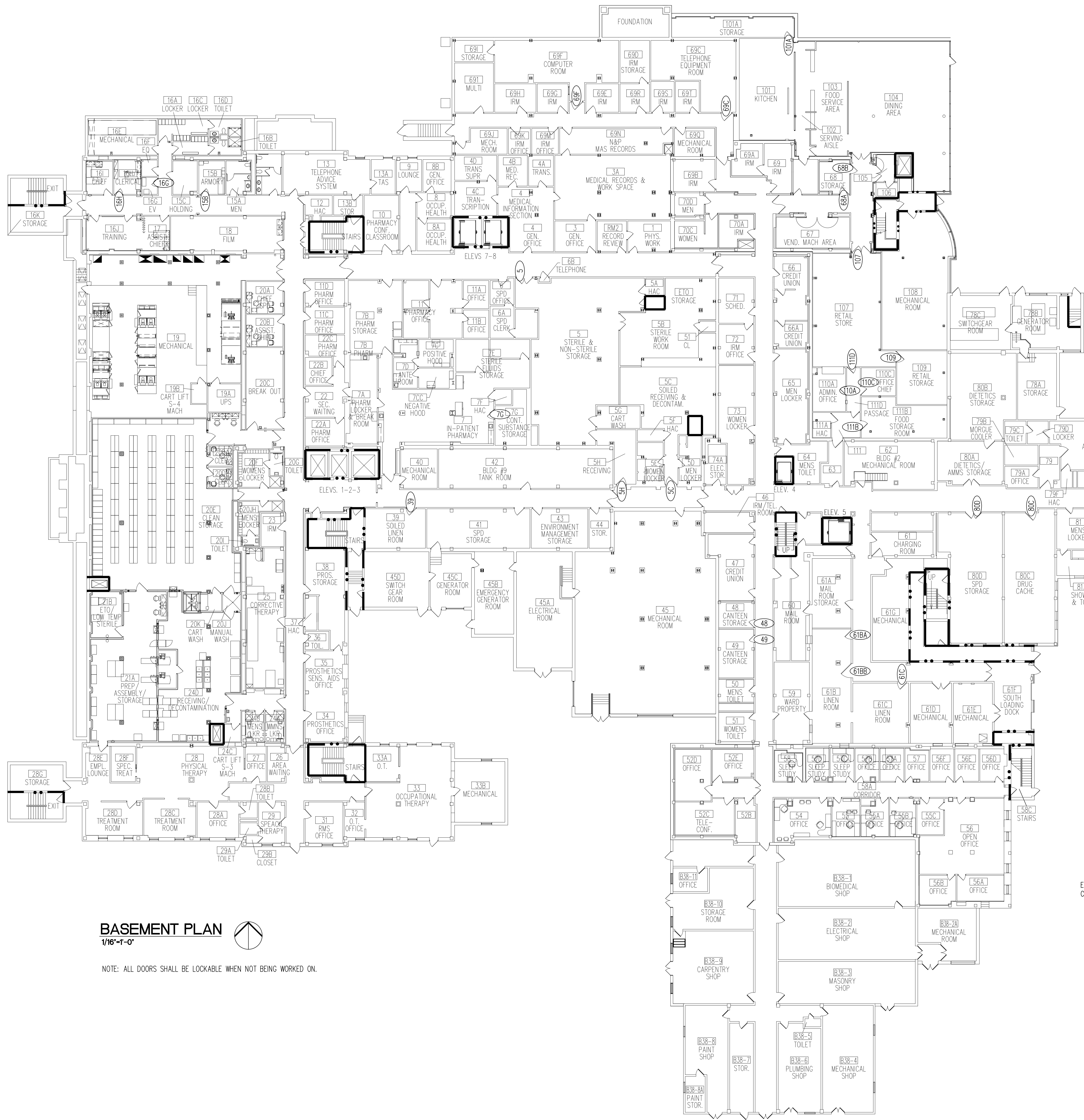

**BASEMENT PLAN**  
1/16"=1'-0"

NOTE: ALL DOORS SHALL BE LOCKABLE WHEN NOT BEING WORKED ON.

**DOOR SCHEDULE**

NO.	ROOM	SIZE	TYPE		FRAME ELEV		FRAME DETAIL		HDMR GROUP	LABEL	WIRING METHOD	REMARKS
			EXIST	NEW	EXIST	NEW	EXIST	NEW				
5	STERILE & NON-STERILE STORAGE	(2) 3'-0" X 7'-0" X 1 3/4"	G	NEW	HM1	NEW	II		3		(2)	
5C	SOILED RECEIVING & DECONTAMINATION	4'-0" X 7'-0" X 1 3/4"	A		HM1		VII SIM.		1S		(2)	
5H	RECEIVING	3'-6" X 7'-0" X 1 3/4"	A		HM1		VIII		1S		(2)	
7C	CONT. SUBSTANCE STORAGE	VAULT DOOR	G		G		VIII		1S		(2)	
15B	ARMORY	3'-0" X 7'-0" X 1 3/4"	H		H		V		1S		(2)	
16G	EVIDENCE	3'-0" X 7'-0" X 1 3/4"	B		HM2		V		1S		(2)	
16H	CLERICAL	3'-0" X 7'-0" X 1 3/4"	B		HM2		II		1S		(2)	
39	SOILED LINEN ROOM	3'-6" X 7'-0" X 1 3/4"	B		HM1		III		1S		(2)	
48	CANTEEN STORAGE	2'-8" X 7'-0" X 1 3/4"	(1)	B	(1)	HM2	VI		34S		(2)	
49	CANTEEN STORAGE	2'-8" X 7'-0" X 1 3/4"	(1)	B	(1)	HM2	VI		34S		(2)	
61BA	LINEN ROOM	3'-0" X 7'-0" X 1 3/4"	A		HM2		IX		1S		(2)	
61BB	LINEN ROOM	4'-0" X 7'-0" X 1 3/4"	A		HM1		IX		1S		(2)	
61C	LINEN ROOM	3'-0" X 7'-0" X 1 3/4"	A		HM2		IX		1S		(2)	
68A	STORAGE	3'-6" X 7'-0" X 1 3/4"	F		HM1		II		1S		(2)	
68B	STORAGE	3'-6" X 7'-0" X 1 3/4"	F		HM1		II		1S		(2)	
69C	TELEPHONE EQUIPMENT ROOM	4'-0" X 7'-0" X 1 3/4"	B		HM1		II		1S		(2)	
69F	COMPUTER ROOM	4'-0" X 7'-0" X 1 3/4"	B		HM1		II		1S		(2)	
80C	DRUG CACHE	4'-0" X 7'-0" X 1 3/4"	A		HM2		IX		1S		(2)	
80D	SPD STORAGE	(2) 3'-0" X 7'-0" X 1 3/4"	A		HM3		IX		1S		(2)	
101A	STORAGE	3'-0" X 7'-0" X 1 3/4"	F		HM1		II		1S		(2)	
107	RETAIL STORE	(2) 3'-4" X 7'-0" X 1 3/4"	E		HM1		II		2		(2)	
109	RETAIL STORAGE	4'-0" X 7'-0" X 1 3/4"	B		HM1		II		1S		(2)	
110A	ADMINISTRATION OFFICE	3'-0" X 7'-0" X 1 3/4"	B		HM1		II		1S		(2)	
110C	OFFICE CHIEF	3'-0" X 7'-0" X 1 3/4"	B		HM1		II		1S		(2)	
111B	FOOD STORAGE ROOM	3'-6" X 7'-0" X 1 3/4"	B		HM1		II		1S		(2)	
111D	PASSAGE	3'-0" X 7'-0" X 1 3/4"	E		HM1		II		1S		(2)	

- ① REMOVE EXISTING.  
② AT NEW CONCEALED CONDUIT.  
PATCH TO MATCH EXISTING FINISHES. V.F.Y. FINISHES.  
CONDUIT MAY BE EXPOSED INSIDE THIS ROOM.  
NO EXPOSED CONDUIT ON OUTSIDE OF ROOM.  
NO EXPOSED WIRING ALLOWED.

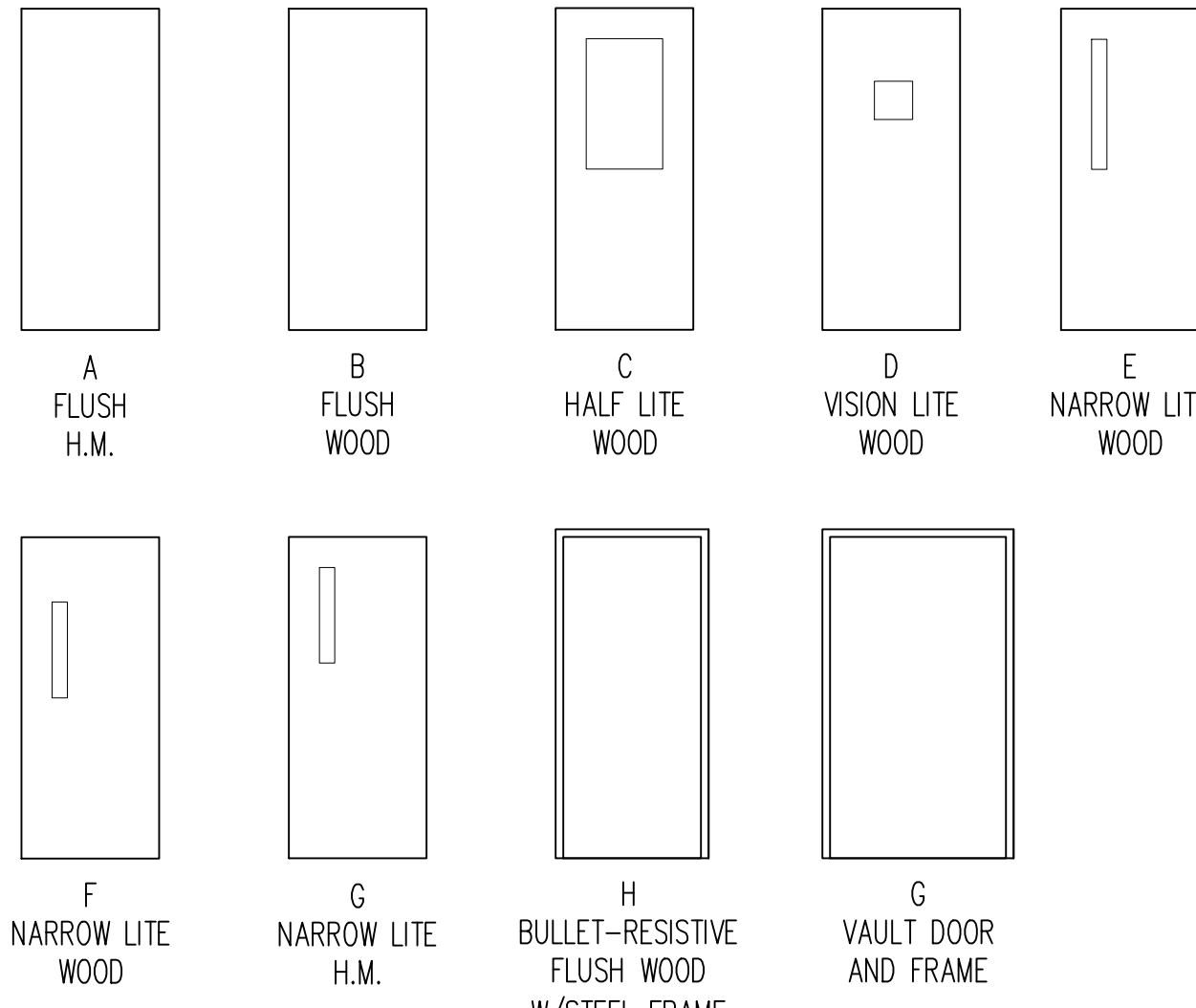

**DOOR ELEVATIONS**  
1/4"=1'-0"

NOTE: VERIFY DOOR TYPE FOR EXISTING OR NEW ON SCHEDULE.

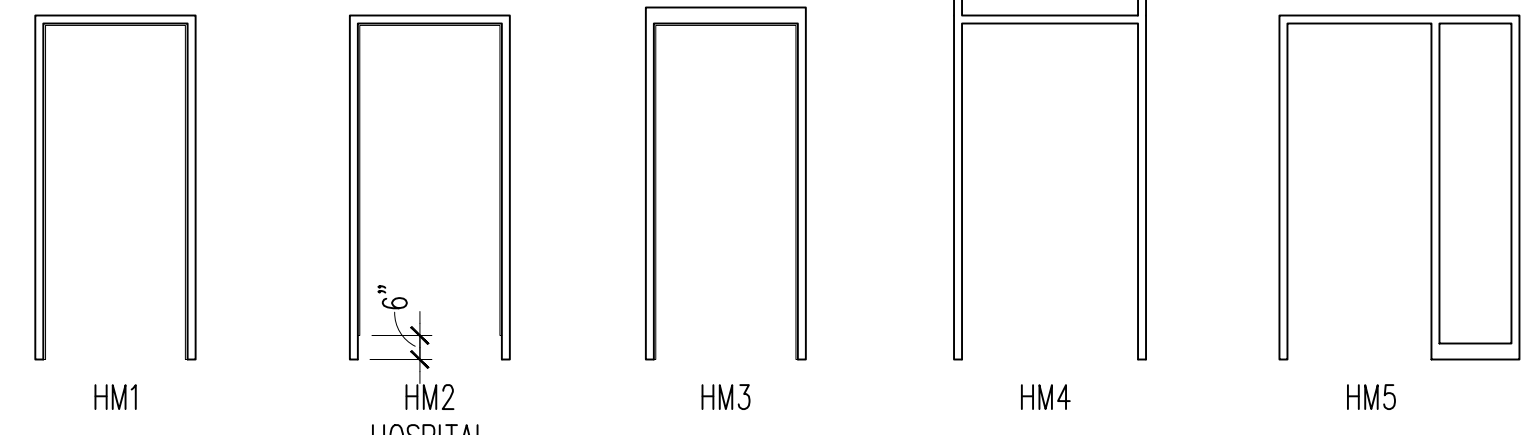

**FRAME ELEVATIONS**  
1/4"=1'-0"

NOTE: VERIFY FRAME TYPE FOR EXISTING OR NEW ON SCHEDULE.

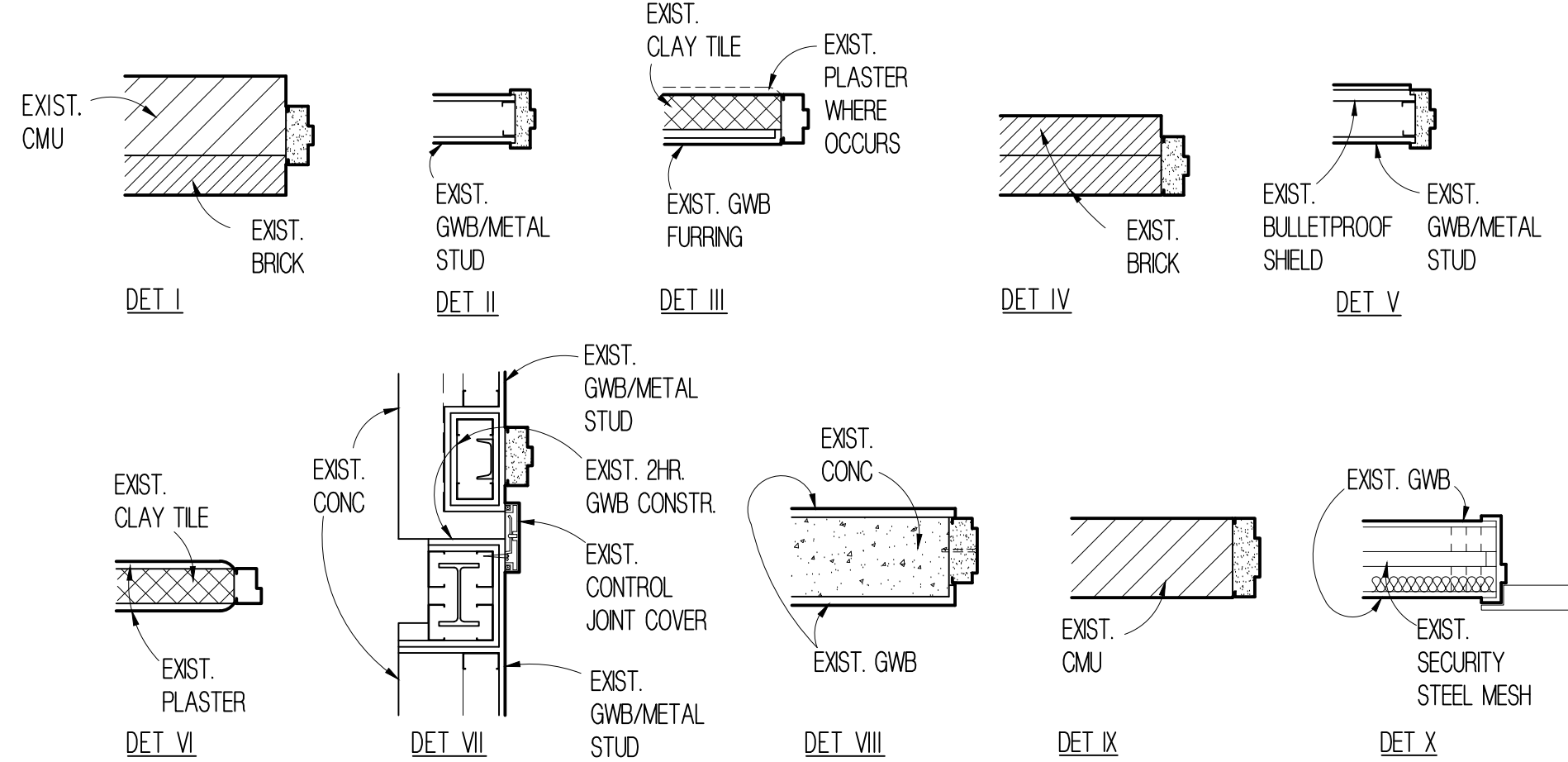

**FRAME DETAILS**  
3/4"=1'-0"

NOTE: PATCH TO MATCH EXISTING FINISHES WHERE DAMAGED DUE TO WORK UNDER THIS PROJECT.



Dept. of Veterans Affairs  
Medical Center  
2101 Elm Street North  
Fargo, ND 58102



IMAGE GROUP INC.  
403 CENTER AVENUE, SUITE 300  
MOORHEAD, MN 56560

IMAGE GROUP INC., Architecture & Interiors  
MEN ENGINEERING, Electrical Engineers

I hereby certify that this plan specification, or report was prepared by me or under my direct supervision, and that I am duly Registered Architect under the laws of the State of North Dakota

Date 5/4/2012 Reg. No. 378

Drawing Title  
**BASEMENT PLAN**

VA Project No.  
**437-12-105**

Building No.  
**1, 9, 46**

Contract No.  
**VA263-P-1217**  
**VA263-C-**

AutoCAD File Name  
**PLAN\_BASED.DWG**

Project Title  
**VA MEDICAL CENTER  
REPLACE PHYSICAL ACCESS  
SECURITY SYSTEM**

Designed By  
**RM**

Checked By  
**RM**

Drawn By  
**KS**

Location  
**VA MEDICAL CENTER  
FARGO, ND**

Date  
**MAY 4, 2012**

Scale  
**AS SHOWN**

Drawing No.  
**A1**

Dwg. 2 of 9





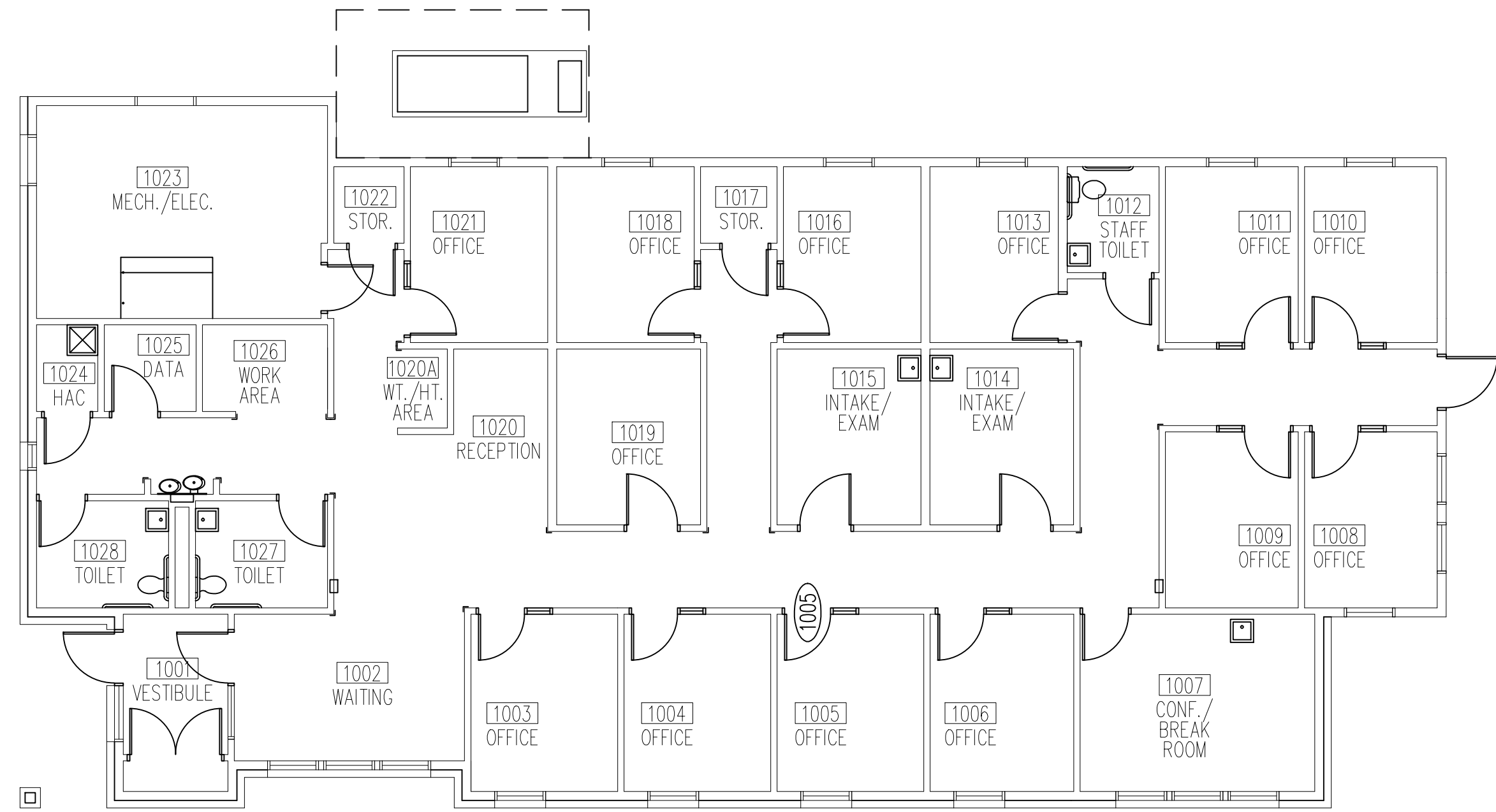

**FIRST FLOOR PLAN BUILDING 51**  
**1/8"=1'-0"**  
**ALTERNATE NO. 2**

NOTE: ALL DOORS SHALL BE LOCKABLE WHEN NOT BEING WORKED ON.

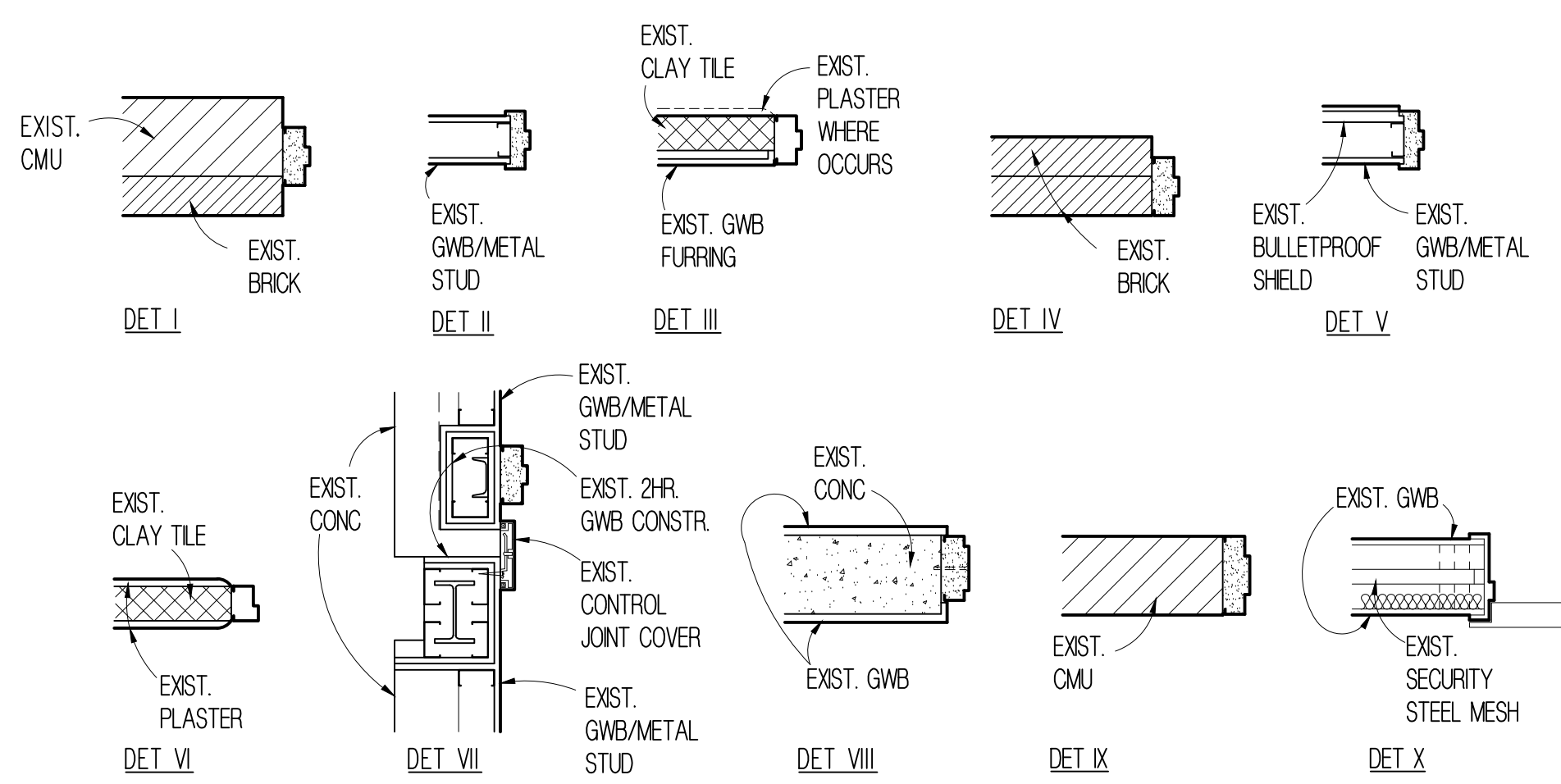

**FRAME DETAILS**  
**3/4"=1'-0"**

NOTE: PATCH TO MATCH EXISTING FINISHES WHERE DAMAGED DUE TO WORK UNDER THIS PROJECT.

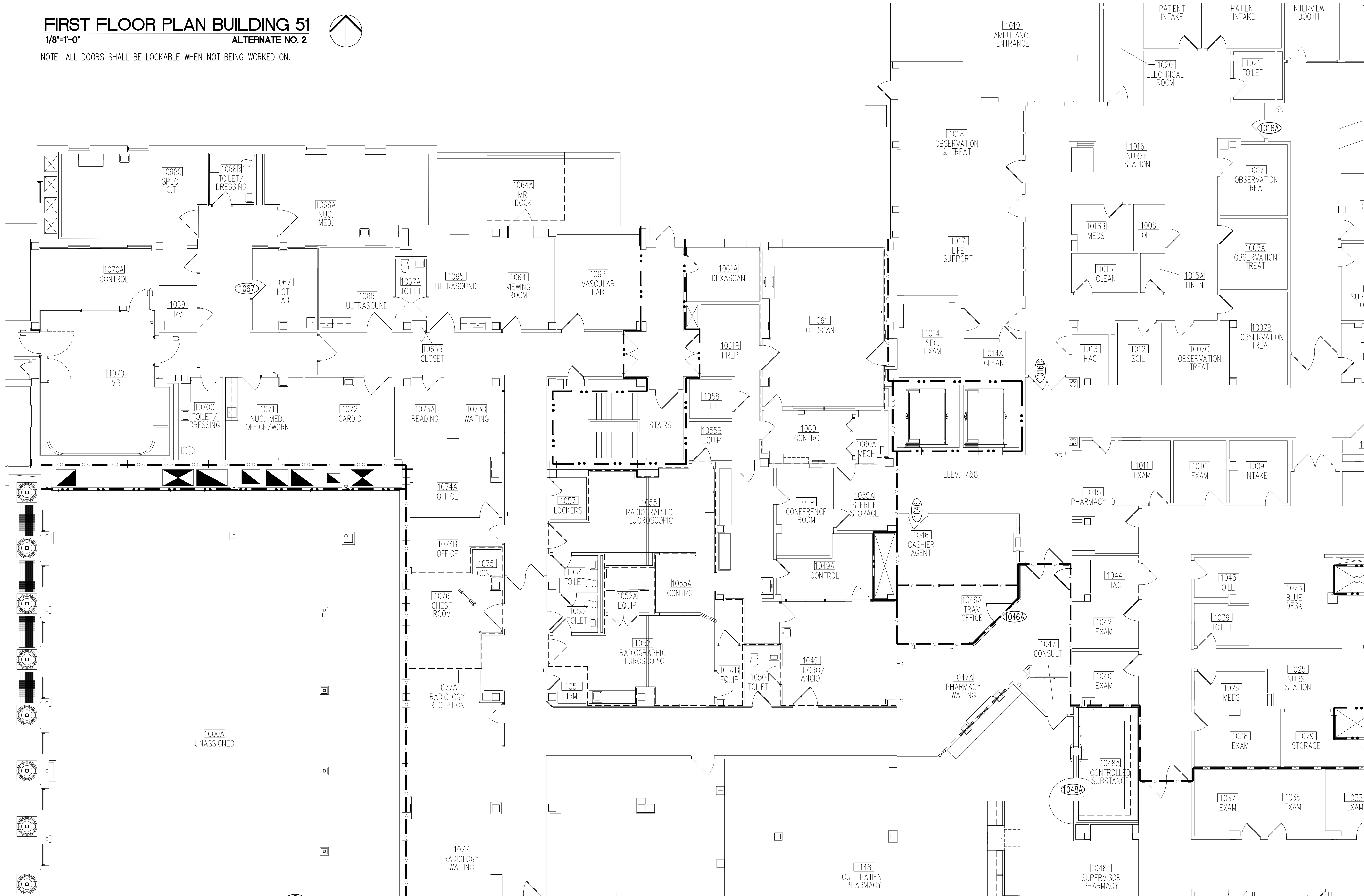

**FIRST FLOOR PLAN BUILDING 9**  
**1/8"=1'-0"**  
**ALTERNATE NO. 2**

NOTE: ALL DOORS SHALL BE LOCKABLE WHEN NOT BEING WORKED ON.

## DOOR SCHEDULE

DOOR				FRAME ELEV		FRAME DETAIL		HDWR GROUP	LABEL	WIRING METHOD	REMARKS
NO.	ROOM	SIZE	TYPE		EXIST	NEW	EXIST				
BUILDING 9											
1016A	COORDIDOR	4'-0" X 7'-0" X 1 3/4"	C		HM1		II		4		② ALT. NO. 2
1016B	COORDIDOR	(2) 3'-0" X 7'-0" X 1 3/4"	B		HM1		II		4S		② ALT. NO. 2
1046	CASHIER AGENT	3'-0" X 7'-0" X 1 3/4"	B		HM2		II		1S		② ALT. NO. 2
1046A	TRAVEL OFFICE	4'-0" X 7'-0" X 1 3/4"	B		HM1		II		1S		② ALT. NO. 2
1048A	CONTROLLED SUBSTANCE	VAULT DOOR & FRAME	G		G		X		1S		② ALT. NO. 2
1067	HOT LAB	3'-0" X 7'-0" X 1 3/4"	B		HM1		II		1		② ALT. NO. 2
BUILDING 39											
39A	SWITCHGEAR BUILDING	3'-8" X 6'-8" X 1 3/4"	A		HM4		I		1S		③ ALT. NO. 1
39B	SWITCHGEAR BUILDING	3'-8" X 6'-8" X 1 3/4"	A		HM4		I		1S		③ ALT. NO. 1
BUILDING 51											
1005	OFFICE	3'-0" X 7'-0" X 1 3/4"	B		HM5		II		1S		② ALT. NO. 2

- ① REMOVE EXISTING.  
② AT NEW CONCEALED CONDUIT.  
③ PATCH TO MATCH EXISTING FINISHES, V.F.Y. FINISHES.  
CONDUIT MAY BE EXPOSED INSIDE THIS ROOM.  
NO EXPOSED CONDUIT ON OUTSIDE OF ROOM.  
NO EXPOSED WIRING ALLOWED.

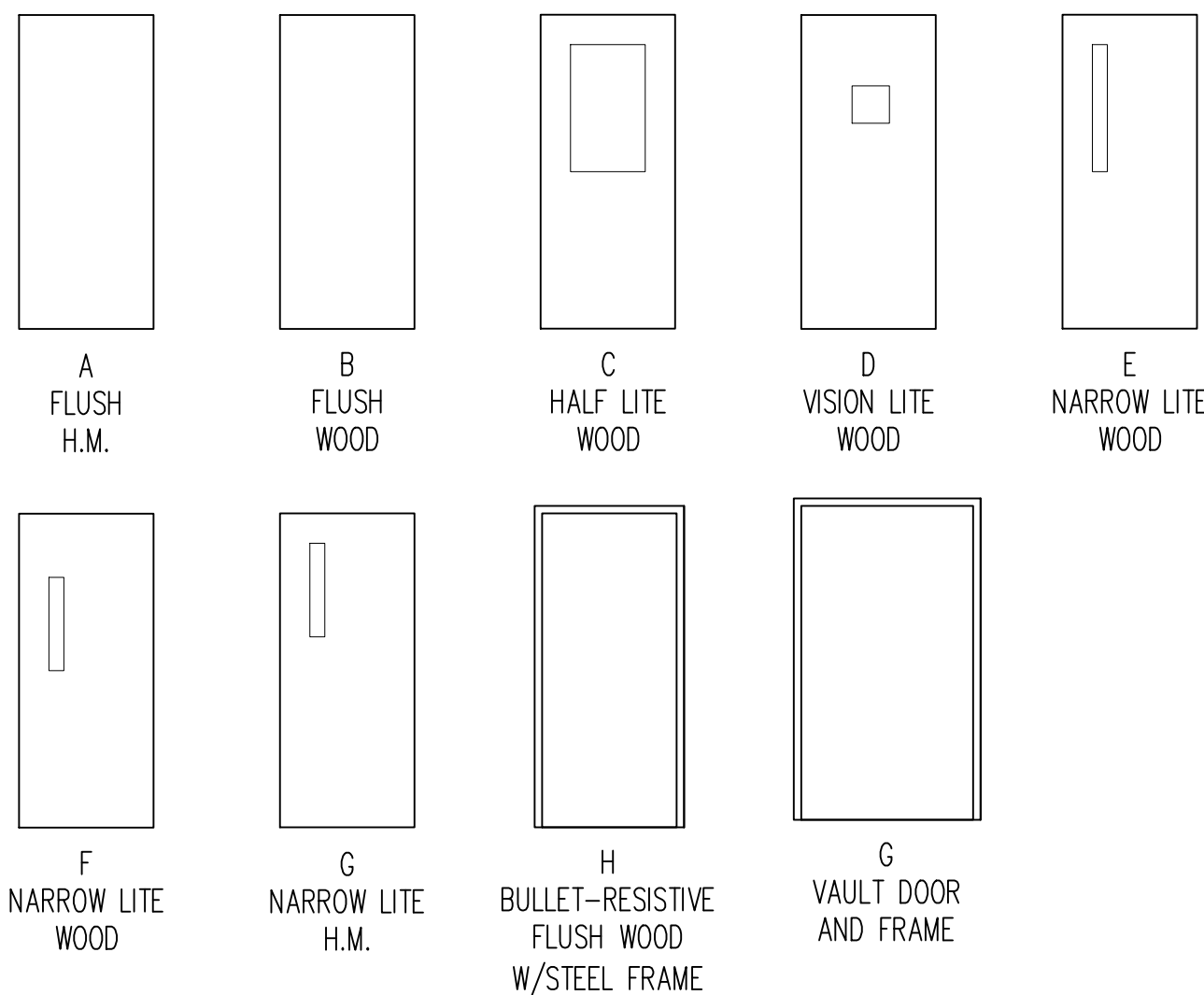

**DOOR ELEVATIONS**  
**1/4"=1'-0"**

NOTE: VERIFY DOOR TYPE FOR EXISTING OR NEW ON SCHEDULE.

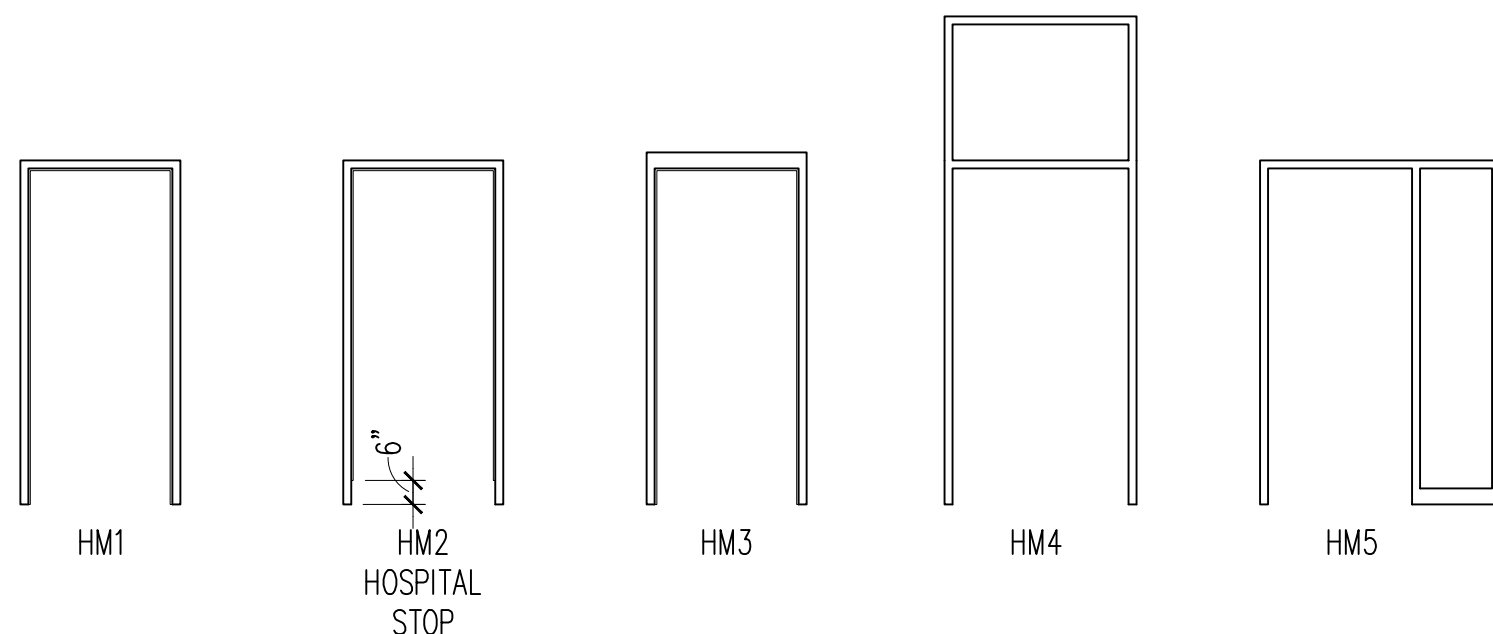

**FRAME ELEVATIONS**  
**1/4"=1'-0"**

NOTE: VERIFY FRAME TYPE FOR EXISTING OR NEW ON SCHEDULE.

**FIRST FLOOR PLAN BUILDING 39**  
**1/8"=1'-0"**  
**ALTERNATE NO. 1**

NOTE: ALL DOORS SHALL BE LOCKABLE WHEN NOT BEING WORKED ON.



Dept. of Veterans Affairs  
Medical Center  
2101 Elm Street North  
Fargo, ND 58102



IMAGE GROUP INC.  
403 CENTER AVENUE, SUITE 300  
MOORHEAD, MN 56560

IMAGE GROUP INC., Architecture & Interiors  
MEN ENGINEERING, Electrical Engineers

I hereby certify that this plan specification, or report was prepared by me or under my direct supervision, and that I am duly Registered Architect under the laws of the State of North Dakota.

Date: 5/4/2012 Reg. No. 378

Drawing Title

FIRST FLOOR PLANS -  
BUILDINGS 9, 39 AND 51

VA Project No.

437-12-105

Building No.

9, 39, 51

Contract No.

VA263-P-1217  
VA263-C-

AutoCAD File Name

FIRST\_9\_39\_51DWG

Project Title

VA MEDICAL CENTER  
REPLACE PHYSICAL ACCESS  
SECURITY SYSTEM

Designed By

RM

Checked By

RM

Location

VA MEDICAL CENTER  
FARGO, ND

Drawn By

KS

Drawing No.

A2

Dwg. 3 of 9

Date

MAY 4, 2012

Scale

AS SHOWN

Drawing No.

A2

Dwg. 3 of 9







DOOR SCHEDULE																
DOOR				FRAME ELEV		FRAME DETAIL		HWR GROUP	LABEL	WIRING METHOD	REMARKS					
NO.	ROOM	SIZE	TYPE		EXIST	NEW	EXIST	NEW	EXIST	NEW						
BUILDING 12																
12A	DOCK	3'-0" X 7'-0" X 1 3/4"	A				HM3		I		1S		(3)		ALT. NO. 1	
12B	DOCK	8'-0" X 9'-0" X 1 3/4"	OH DOOR										(3)		ALT. NO. 1	
12C	DOCK	8'-0" X 9'-0" X 1 3/4"	OH DOOR										(3)		ALT. NO. 1	
12D	DOCK	3'-0" X 7'-0" X 1 3/4"	A				HM3		I		1S		(3)		ALT. NO. 1	
BUILDING 13																
13A	ISSUE	2'-8" X 7'-0" X 1 3/4"	(1)	A	(1)	HM3		IV	33SW				(3)		ALT. NO. 3	
13B	ISSUE	5'-0" X 7'-0" X 1 3/4"	OH DOOR										(3)		ALT. NO. 3	
13C	RECEIVING	3'-0" X 7'-0" X 1 3/4"	(1)	A	(1)	HM3		IV	33SW				(3)		ALT. NO. 3	
	RECEIVING	8'-0" X 7'-0" X 1 3/4"	OH DOOR										(3)		ALT. NO. 3	

- 
- A  
FLUSH  
H.M.
- B  
FLUSH  
WOOD
- C  
HALF LITE  
WOOD
- D  
VISION LITE  
WOOD
- E  
NARROW LITE  
WOOD
- F  
NARROW LITE  
WOOD
- G  
NARROW LITE  
H.M.
- H  
BULLET-RESISTIVE  
FLUSH WOOD  
W/STEEL FRAME
- I  
VAULT DOOR  
AND FRAME

$$1/4^* = 1^* - 0^*$$
$$1/4' = 1' - 0'$$

The floor plan of the 12th floor is a large, rectangular space. It features a central area with several long, rectangular tables or counters arranged in a row. To the right of this central area, there are several smaller rooms, some of which contain desks and chairs. The bottom of the plan shows a long corridor with four circular labels: 12A, 12B, 12C, and 12D. The plan also includes various doors, windows, and other architectural details.



**IMAGE**  
GROUP



Department of  
Veterans Affairs