



TOTAL 9(NINE) 2X2 LIGHT FIXTURES
TOTAL 63(SIXTY THREE) 2X4 LIGHT FIXTURES

SECOND FLOOR LIGHTING PLAN
SCALE: 1/16" = 1' - 0"

GENERAL NOTES

- 1. Coordinate all replacement work with Contracting Officer's Representative
- 2. Contractor shall remove and dispose of all existing fixtures and lamps identified
- 3. Contractor shall install new fixture in same location and in same mounting method as existing fixture except where noted.
- 4. All existing 2'x2' fixtures shown shall be replaced with fixture LF1
- 5. All existing 2'x4' fixtures shown shall be replaced with fixture LF2

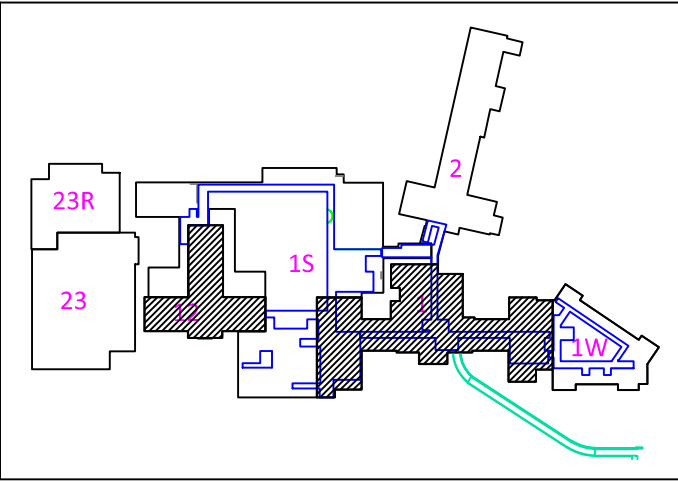

KEY PLAN
SCALE: NTS

| UNITED STATES DEPARTMENT OF VETERANS AFFAIRS VA MEDICAL CENTER - 1540 SPRING VALLEY DRIVE - HUNTINGTON WV 25704 | | | |
|--|---------------------------|---|------------------------------|
| DRAWING TITLE: SECOND FLOOR LIGHTING | | PROJECT TITLE: REPLACE LIGHTING PHASE 2 | |
| APPROVED: CHRISTOPHER ECKLES ASS'T CHIEF, ENGINEERING SERVICE | BUILDING: 1, 12 | PROJECT NUMBER: 581-12-109 | DRAWING NUMBER: E3 |
| APPROVED: JOHN KLIM CHIEF, ENGINEERING SERVICE | DRAWN: KAZI HOSSAIN | DATE: MAY '12 | DWG. 4 OF 8 |