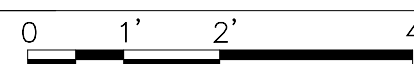
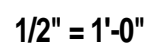
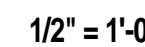
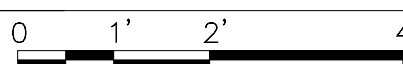
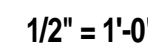

$$1/2" = 1'-0"$$

KEY PLAN B0531 EC
NOT TO SCALE

Department of
Veterans Affairs

1. TRANSFORMER T-6 B0531 EC:
FURNISH AND INSTALL 500 KVA TRANSFORMER, 480-120/208 VOLT.
2. EMERGENCY DISCONNECT SWITCH (EDS) T-6 B0531 EC:
FURNISH AND INSTALL DISCONNECT SWITCH AND ASSOCIATED
CONDUIT AND WIRING/CABLING.
3. DISTRIBUTION PANELBOARD DL-805-2:
FURNISH AND INSTALL REPLACEMENT BREAKERS:
5-300 AMP, 4-200 AMP, 2-400 AMP AND 1-100 AMP.

AG AB EM



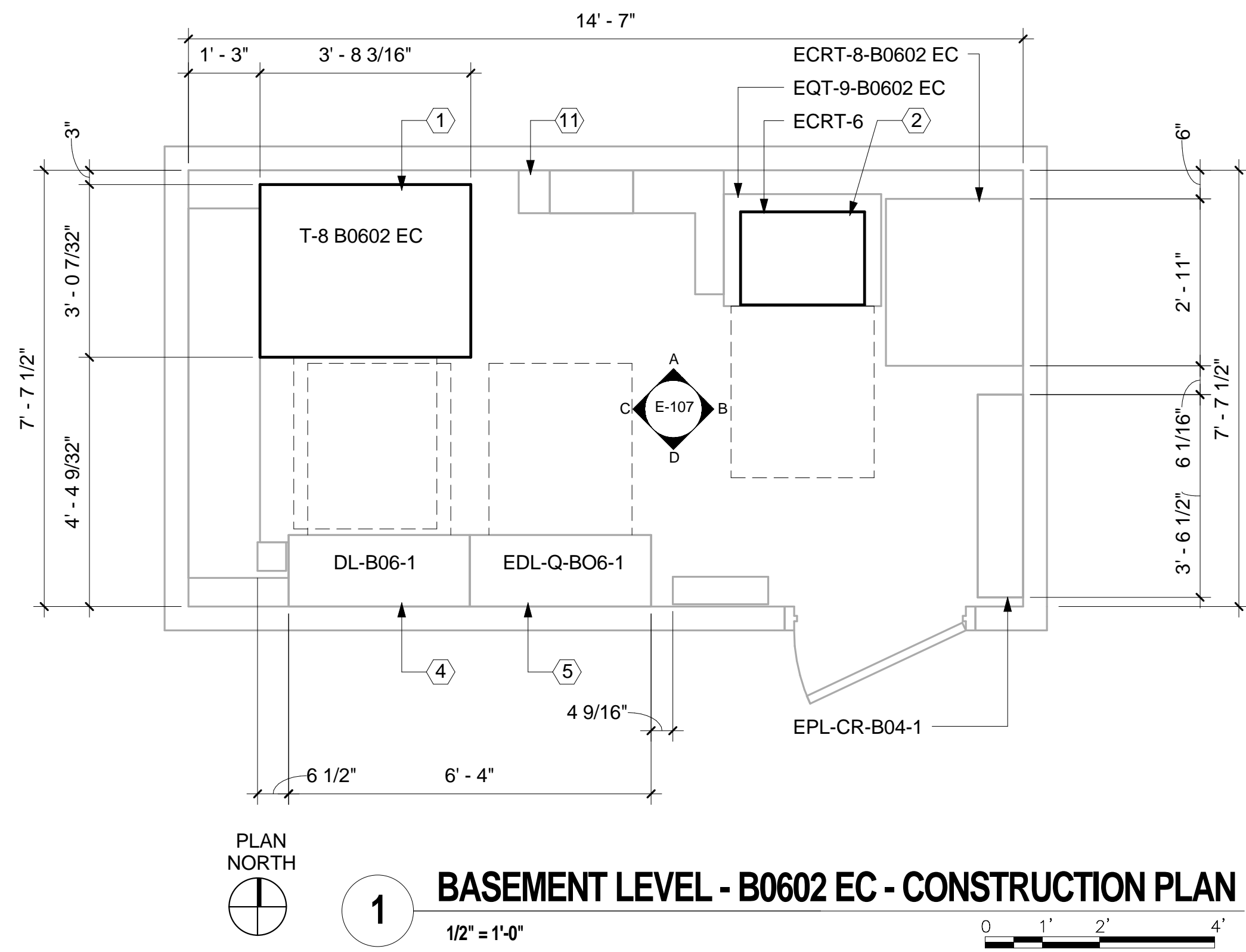

1 BASEMENT LEVEL - B0602 EC - CONSTRUCTION PLAN

1/2" = 1'-0"

0 1' 2' 4'

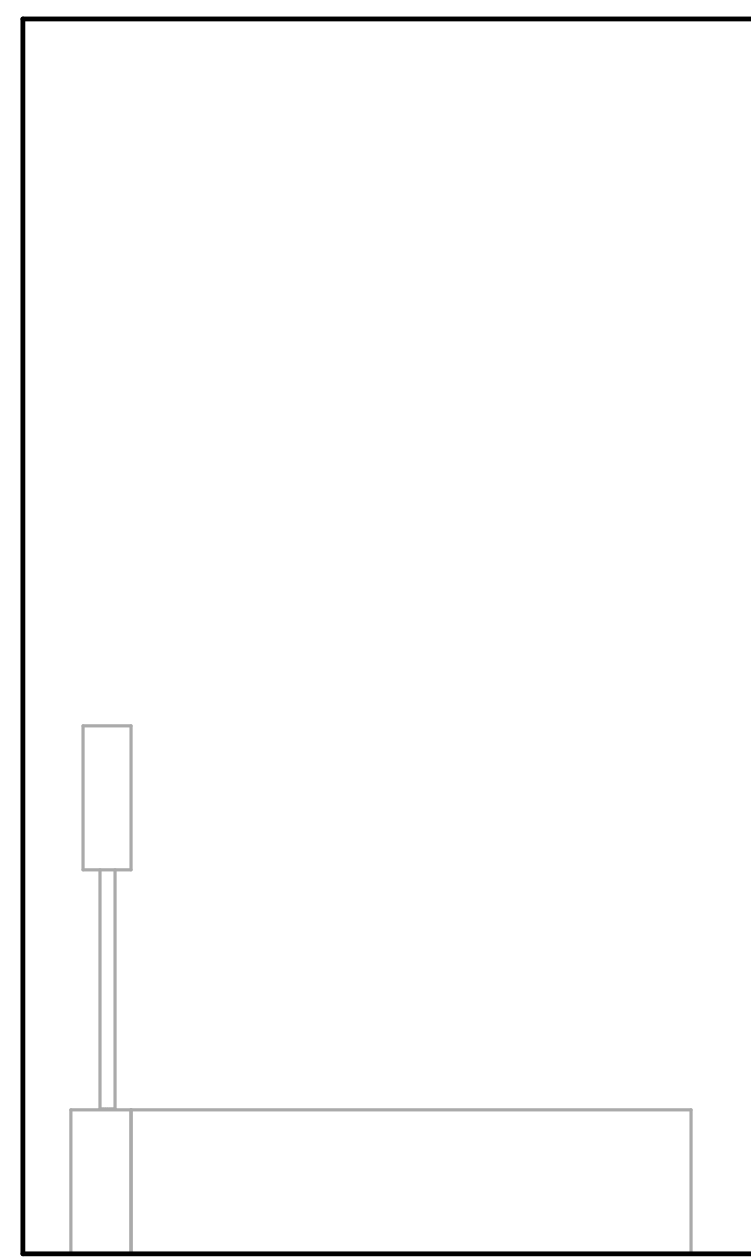

C B0602 EC - CONSTRUCTION ELEVATION C

1/2" = 1'-0"

0 1' 2' 4'

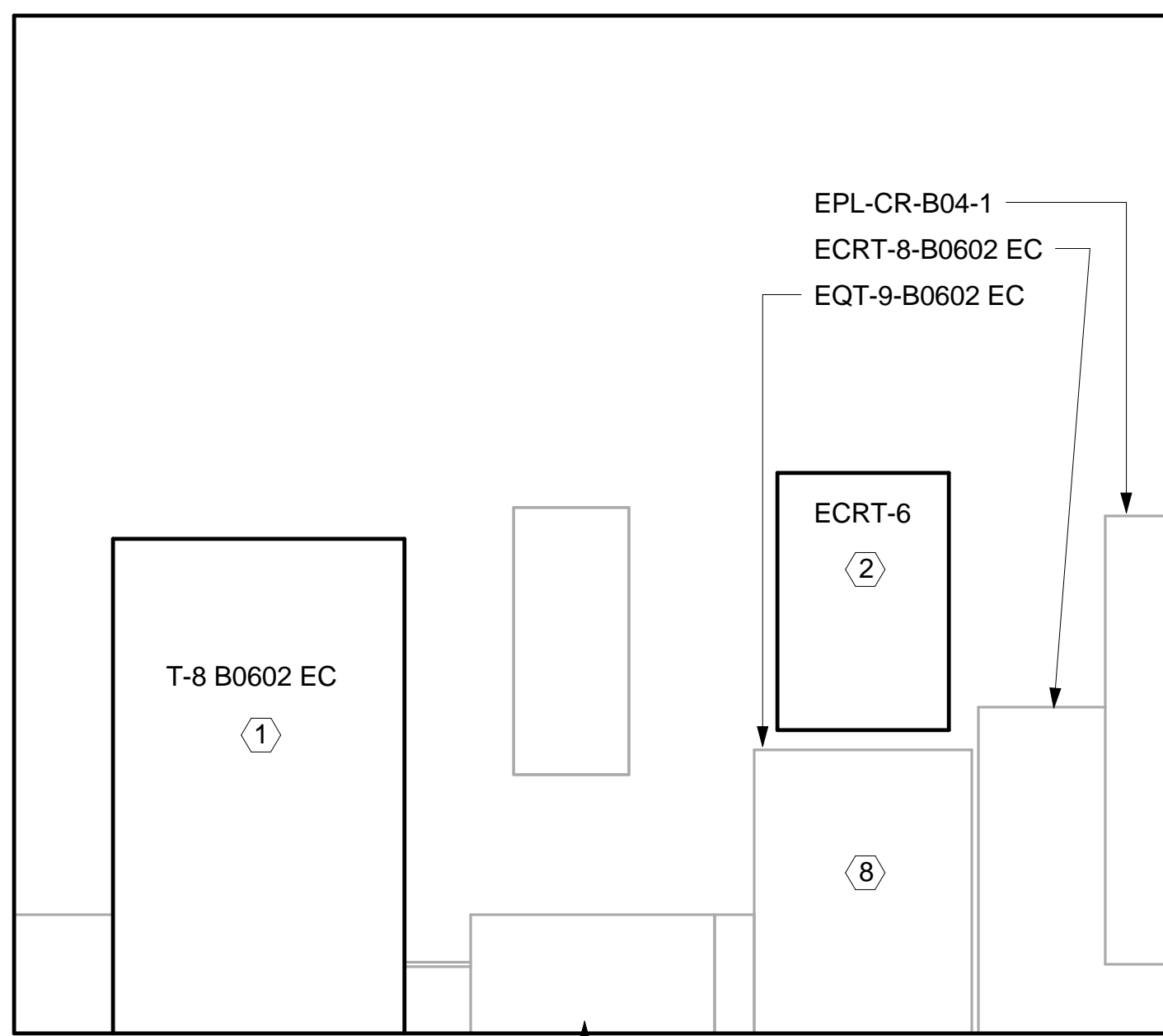

A B0602 EC - CONSTRUCTION ELEVATION A

1/2" = 1'-0"

0 1' 2' 4'

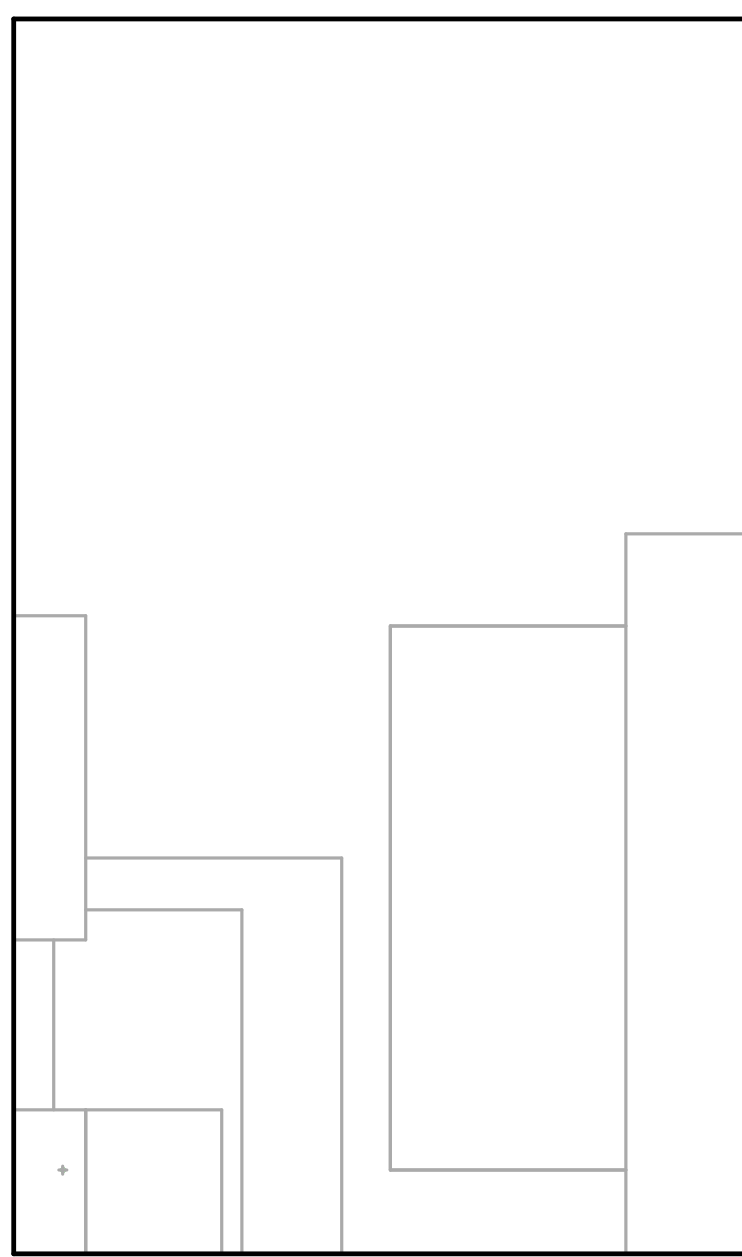

B B0602 EC - CONSTRUCTION ELEVATION B

1/2" = 1'-0"

0 1' 2' 4'

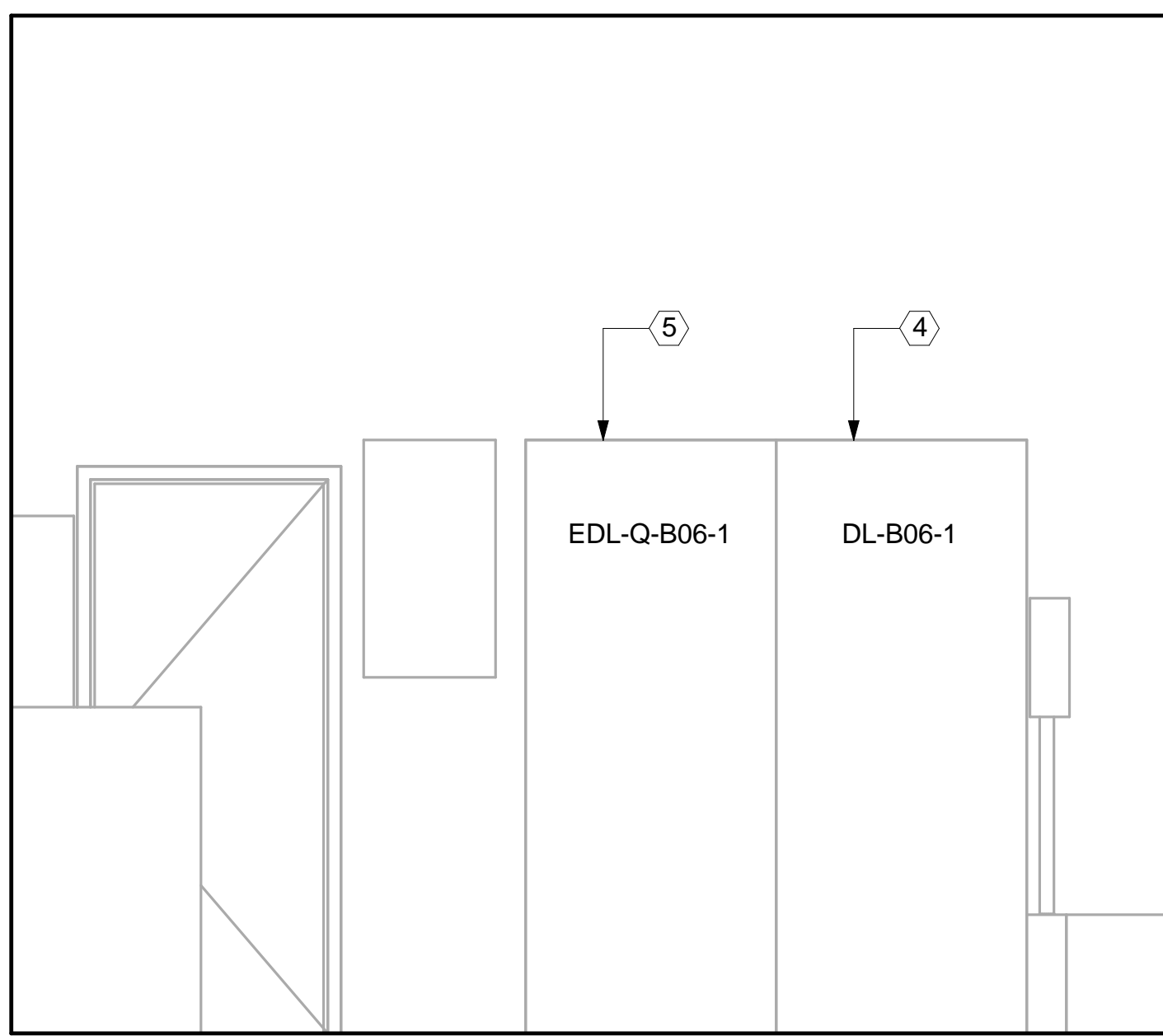

D B0602 EC - CONSTRUCTION ELEVATION D

1/2" = 1'-0"

0 1' 2' 4'

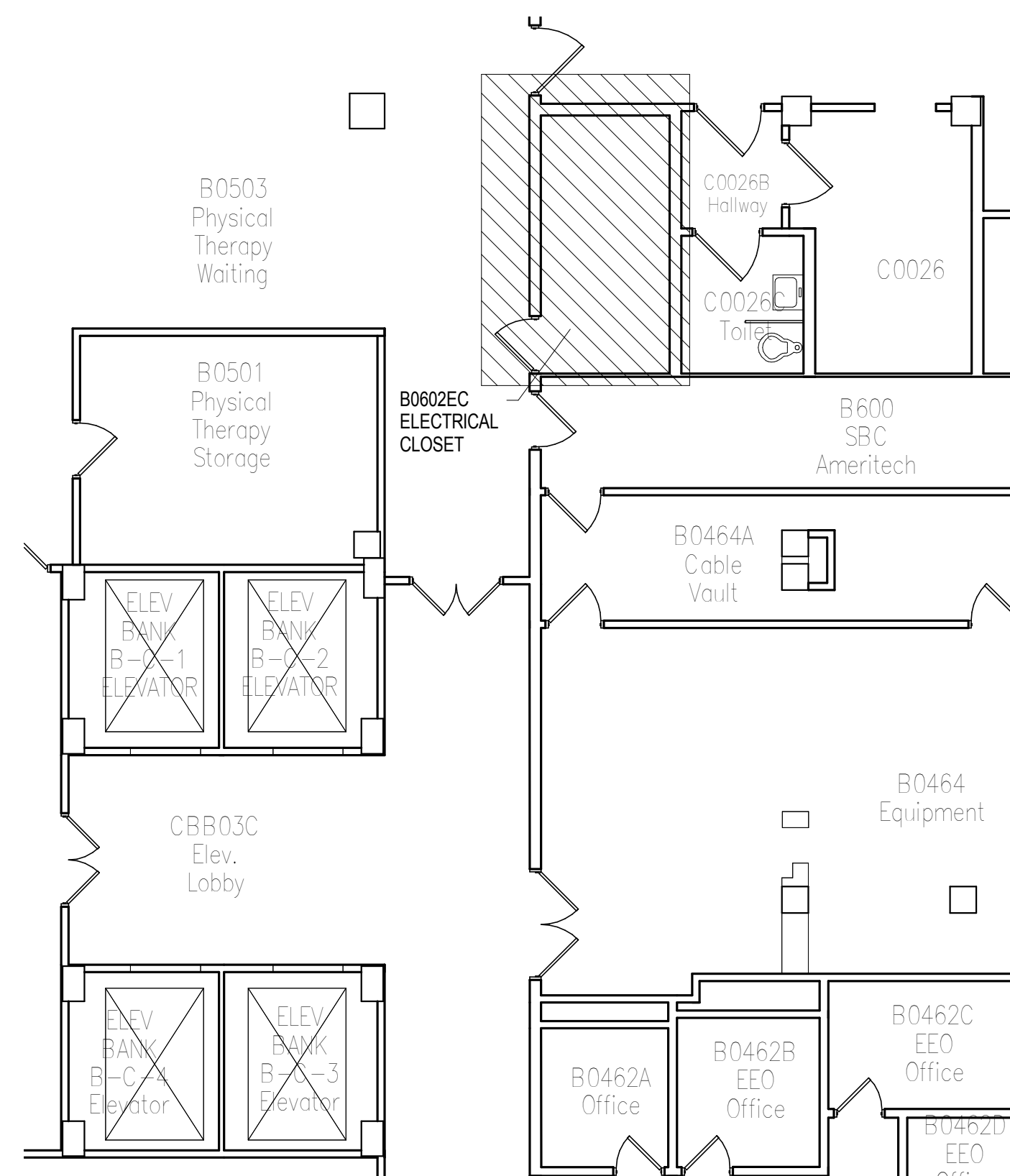

2 KEY PLAN B0602 EC

NOT TO SCALE

B0602 EC

VA CONTRACT NO. VA69D-15-J-1908

Revisions:	Date
FINAL CONSTRUCTION DOCUMENT BID SET	01/13/2017
95% CONSTRUCTION DOCUMENT SUBMITTAL	10/13/2016
65% CONSTRUCTION DOCUMENT SUBMITTAL	08/02/2016
35% SCHEMATIC DESIGN SUBMITTAL	04/28/2016

CONSULTANTS:

ARCHITECT/ENGINEERS:

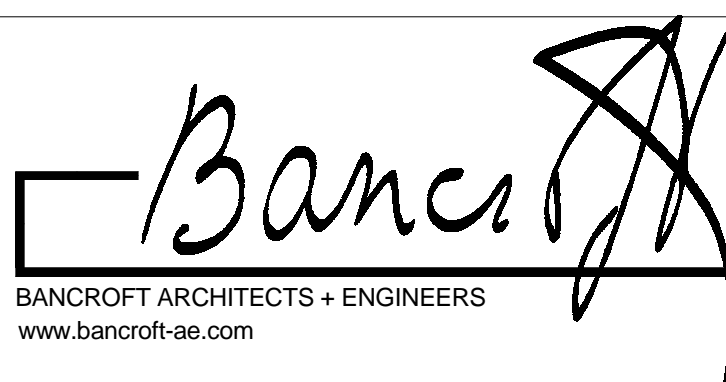

700 Nicholas Blvd. Suite 300
Elk Grove Village, IL 60007
T: 847.952.9362 F: 847.952.9403

Bancroft AE No. 14-101

Drawing Title
ROOM B0602 EC - ELECTRICAL
CONSTRUCTION PLAN

Approved: Project Director
-
VAPAHCS PLANNING AND ENGINEERING

Project Title
UPGRADE W PANELS

Location
5000 W. NATIONAL AVE.
MILWAUKEE, WI 53295

Date
01/13/2017

Checked
LF

Drawn
AG AB EM

Project Number
695-16-108

Building Number
111

Drawing Number
E-107

Office of
Construction
and Facilities
Management





A

B

C

D

E

F

A

B

C

D

E

F

three inches = one foot

one and one half inches = one foot

one inch = one foot

three quarters inch = one foot

one half inch = one foot

three eighths inch = one foot

one quarter inch = one foot

one eighth inch = one foot

C:\Users\agm\Documents\01 FIRST FLOOR LEVEL - ELECTRICAL\agm.dgn

VA FORM 08-6231

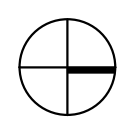
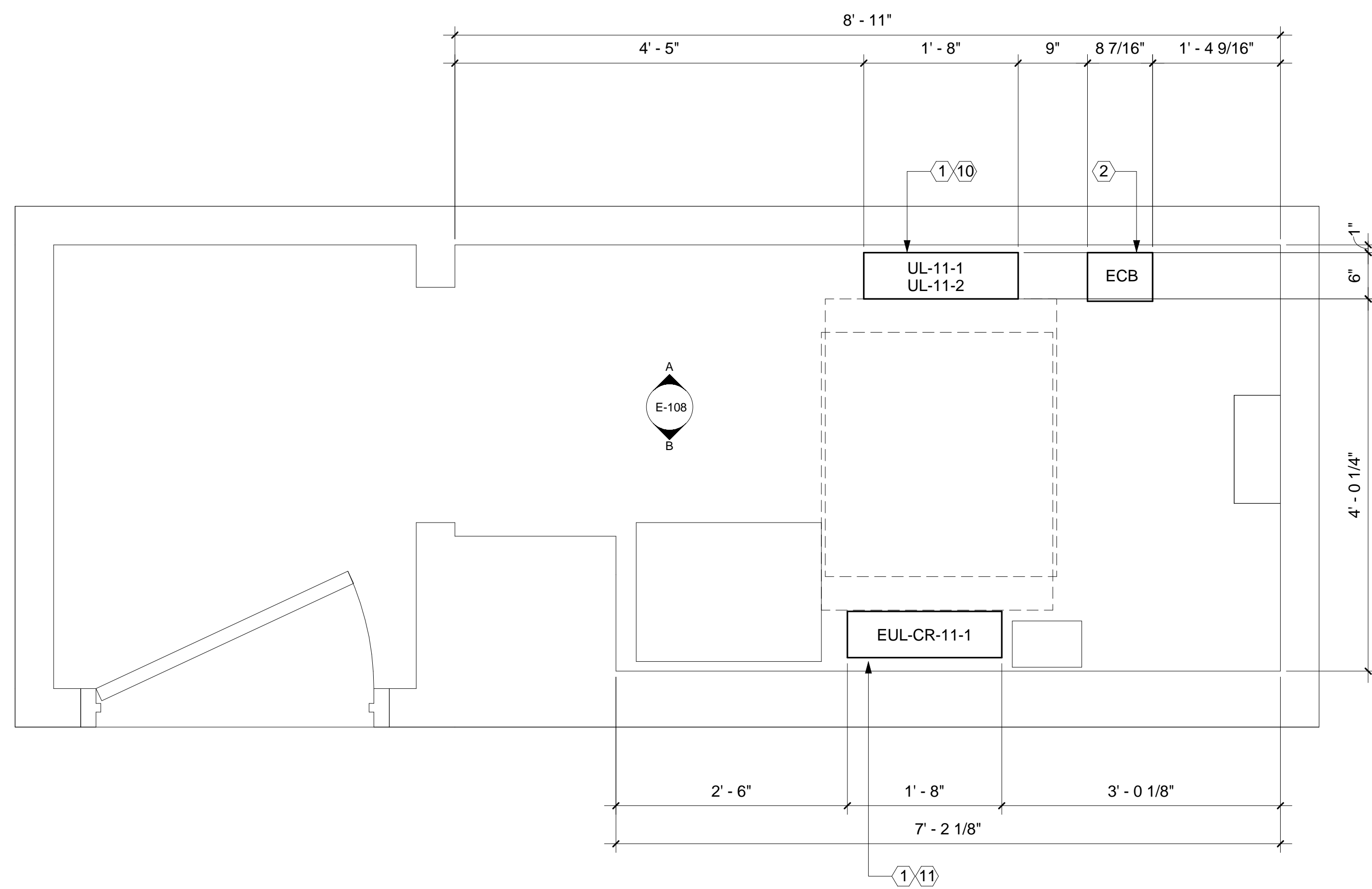

1

FIRST FLOOR LEVEL - 1107 EC - CONSTRUCTION PLAN

1" = 1'-0"

0 1/2' 1' 2'

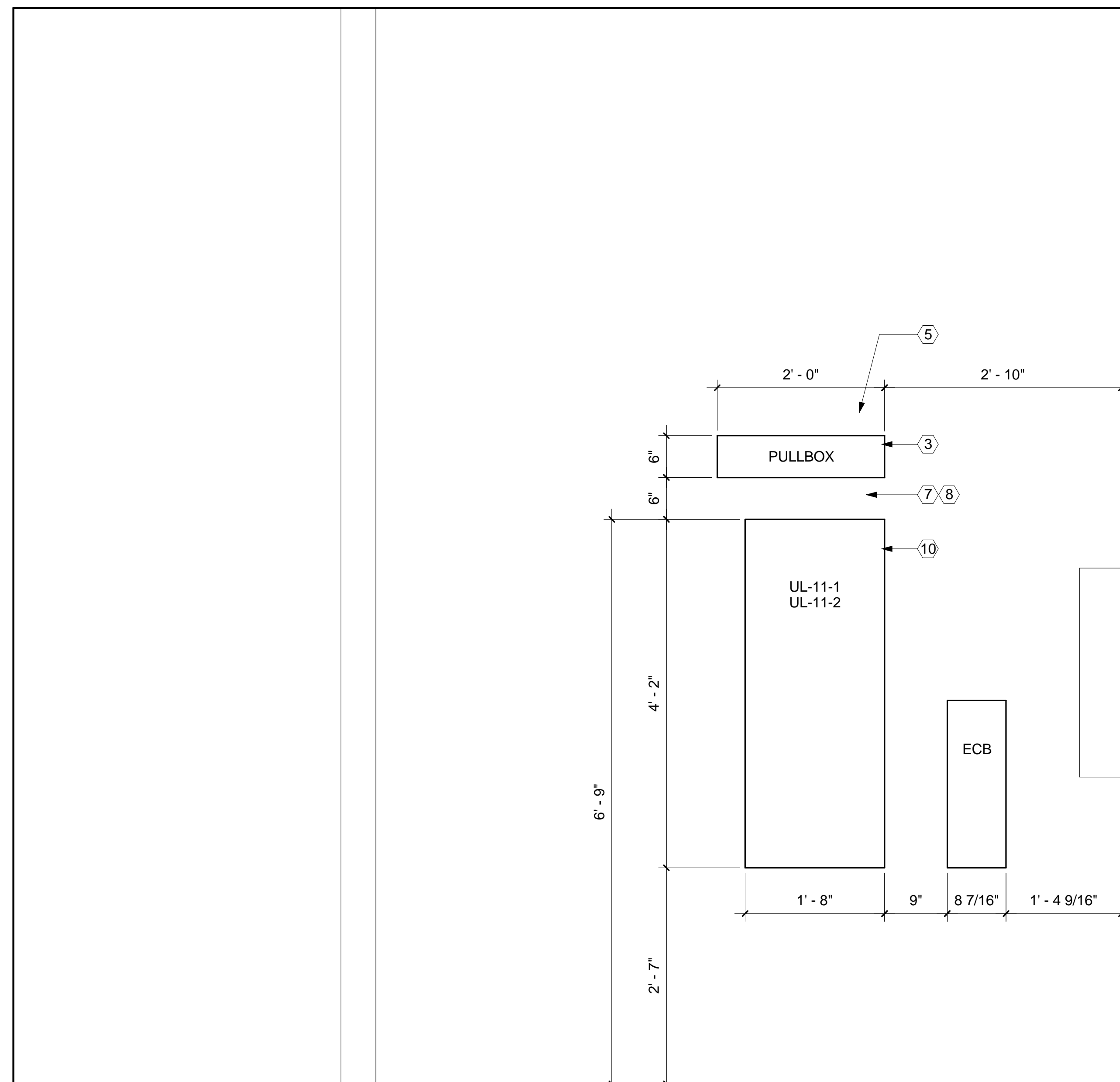

A

1107 EC - CONSTRUCTION ELEVATION A

1" = 1'-0"

VA CONTRACT NO. VA69D-15-J-1908

0 1/2' 1' 2'

B

1107 EC - CONSTRUCTION ELEVATION B

1" = 1'-0"

0 1/2' 1' 2'

ARCHITECT/ENGINEERS:

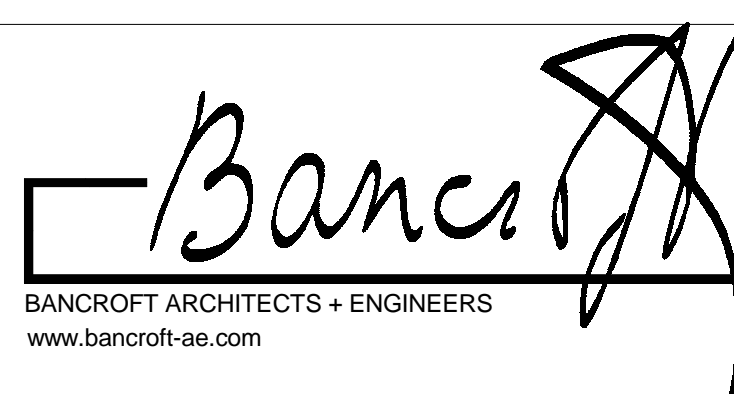
700 Nicholas Blvd., Suite 300
Elk Grove Village, IL 60007
T: 847.952.9362 F: 847.952.9403

Bancroft AE No. 14-101

Drawing Title

ROOM 1107 EC - ELECTRICAL
CONSTRUCTION PLAN

Approved: Project Director

-

VAPAHCS PLANNING AND ENGINEERING

Project Title

UPGRADE W PANELS

Location
5000 W. NATIONAL AVE.
MILWAUKEE, WI 53295

Date

01/13/2017

Checked

LF

Drawn

AG AB EM

Project Number

695-16-108

Building Number
111

Drawing Number

E-108

Office of
Construction
and Facilities
Management

GENERAL NOTES

- REFER TO ARCHITECTURAL CONSTRUCTION DRAWINGS FOR ADDITIONAL INFORMATION.
- REFER TO DRAWING E-601 FOR TYPICAL NEW PANELBOARD DETAILS.
- REFER TO DRAWING E-602 FOR TYPICAL NEW ENCLOSED CIRCUIT BREAKER DETAILS.

X

ELECTRICAL KEYED NOTES

- FURNISH AND INSTALL FEEDER CONDUIT AND CABLING. CONNECT FEEDER CABLES TO EXISTING RISER CABLE AT METAL PULL BOX LOCATION.
- FURNISH AND INSTALL CONDUITS, CABLING AND ENCLOSED CIRCUIT BREAKER.
- FURNISH AND INSTALL METAL RACEWAY/PULL BOX AT PANELBOARD TOP SECTION.
- FURNISH AND INSTALL METAL RACEWAY/PULL BOX AT PANELBOARD BOTTOM SECTION.
- CONNECT EXISTING CONDUITS AT PANELBOARD TOP SECTION INTO METAL RACEWAY/PULL BOX.
- CONNECT EXISTING CONDUITS AT PANELBOARD BOTTOM SECTION INTO METAL RACEWAY/PULL BOX.
- FURNISH AND INSTALL CONDUITS FROM TOP AND BOTTOM METAL RACEWAYS/PULL BOXES AND CONNECT TO PANELBOARDS.
- FURNISH AND INSTALL BRANCH WIRING FOR BRANCH CIRCUITS THAT ARE ROUTED AT PANELBOARD TOP SECTIONS. FURNISH AND INSTALL WIRE SPLICING OF EXISTING AND NEW WIRES WITHIN METAL RACEWAY/PULL BOX.
- FURNISH AND INSTALL BRANCH WIRING FOR BRANCH CIRCUITS THAT ARE ROUTED AT PANELBOARD BOTTOM SECTIONS. FURNISH AND INSTALL WIRE SPLICING OF EXISTING AND NEW WIRES WITHIN METAL RACEWAY/PULL BOX.
- UL-11-1 UL-11-2:
FURNISH AND INSTALL PANELBOARD, 84 CIRCUIT PANELBOARD.
- EUL-CR-11-1:
FURNISH AND INSTALL PANELBOARD, 30 CIRCUIT PANELBOARD.
- FURNISH AND INSTALL DUPLEX GFI OUTLET, CONDUIT AND WIRING. REFER TO DRAWING E-601 FOR NOTES REGARDING GFI OUTLET MOUNTING LOCATION.

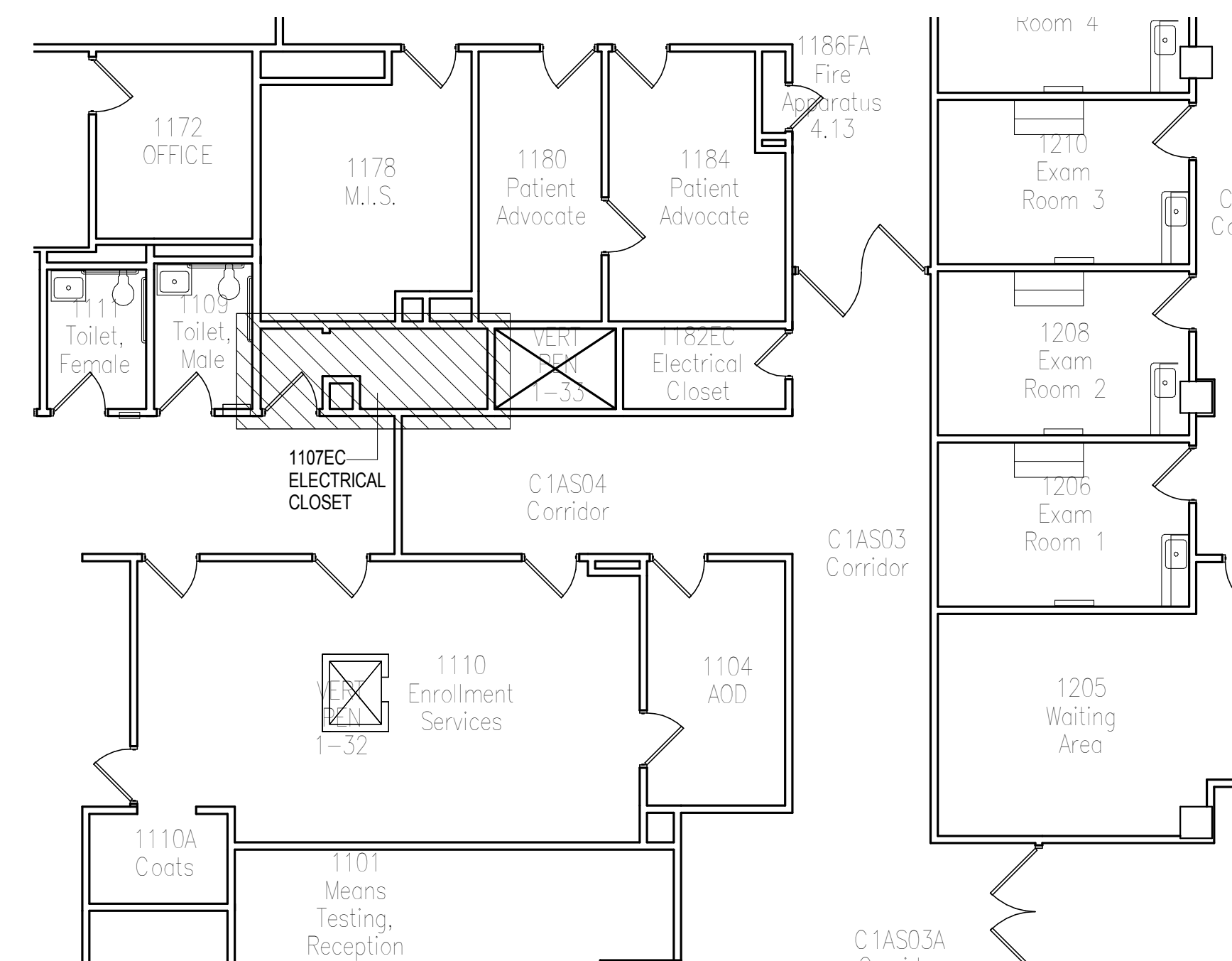



Office of
Construction
and Facilities
Management

-  ELECTRICAL KEYED NOTES

1. DEMOLISH EXISTING PANELBOARD EUL-CR-12-5. EXISTING PANELBOARD IS 30 CIRCUIT PANELBOARD. DEMOLISH FEEDER CABLES AND RESPECTIVE CONDUITS. DEMOLISH BRANCH WIRING AND CONDUITS.
2. DEMOLISH EXISTING PANELBOARD EUL-CR-12-6. EXISTING PANELBOARD IS 42 CIRCUIT PANELBOARD. DEMOLISH FEEDER CABLES AND RESPECTIVE CONDUITS. DEMOLISH BRANCH WIRING AND CONDUITS.
3. EXISTING PANELBOARD EUL-CR-12-5 AND EUL-CR-12-6 ARE SCHEDULED TO BE COMBINED INTO A NEW 84 CIRCUIT PANELBOARD.
4. DEMOLISH EXISTING DUPLEX OUTLET.
5. DEMOLISH EXISTING SURFACE MOUNTED LIGHT FIXTURE, WIRING, AND CONDUIT.
6. EXISTING SURFACE MOUNTED LIGHT SWITCH SHALL REMAIN. DEMOLISH WIRING FROM EXISTING SWITCH TO EXISTING LIGHT FIXTURE.

VA CONTRACT NO. VA69D-15-J-1908	
FINAL CONSTRUCTION DOCUMENT BID SET	01/13/2017
95% CONSTRUCTION DOCUMENT SUBMITTAL	10/13/2016
65% CONSTRUCTION DOCUMENT SUBMITTAL	08/02/2016
95% SCHEMATIC DESIGN SUBMITTAL	04/28/2016
Revisions:	Date

CONSULTANTS:

ARCHITECT/ENGINEERS:



700 Nicholas Blvd. Suite 300
Elk Grove Village, IL 60007
T:847.952.9362 F:847.952.9403

Drawing Title	ROOM 1258 EC - ELECTRICAL DEMOLITION PLAN
---------------	--

Approved: Project Director

VAPAHCS PLANNING AND ENGINEERING

Project Title	UPGRADE W PANELS
---------------	------------------

Location
5000 W. NATIONAL AVE
MILWAUKEE, WI 53295

☐ Checked

Drawn	
-------	--

Project Number
695-16-108Building Number
111

Drawing Number
ED-109

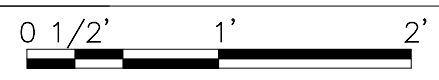
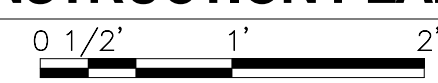

1. FURNISH AND INSTALL FEEDER CONDUIT AND CABLEING. CONNECT FEEDER CABLES TO EXISTING RISER CABLE AT METAL PULL BOX LOCATION.
2. FURNISH AND INSTALL CONDUITS, CABLEING AND ENCLOSED CIRCUIT BREAKER.
3. FURNISH AND INSTALL METAL RACEWAY/PULL BOX AT PANELBOARD TOP SECTION.
4. FURNISH AND INSTALL METAL RACEWAY/PULL BOX AT PANELBOARD BOTTOM SECTION.
5. CONNECT EXISTING CONDUITS AT PANELBOARD TOP SECTION INTO METAL RACEWAY/PULL BOX.
6. CONNECT EXISTING CONDUITS AT PANELBOARD BOTTOM SECTION INTO METAL RACEWAY/PULL BOX.
7. FURNISH AND INSTALL CONDUITS FROM TOP AND BOTTOM METAL RACEWAYS/PULL BOXES AND CONNECT TO PANELBOARDS.
8. FURNISH AND INSTALL BRANCH WIRING FOR BRANCH CIRCUITS THAT ARE ROUTED AT PANELBOARD TOP SECTIONS. FURNISH AND INSTALL WIRE SPLICING OF EXISTING AND NEW WIRES WITHIN METAL RACEWAY/PULL BOX.
9. FURNISH AND INSTALL BRANCH WIRING FOR BRANCH CIRCUITS THAT ARE ROUTED AT PANELBOARD BOTTOM SECTIONS. FURNISH AND INSTALL WIRE SPLICING OF EXISTING AND NEW WIRES WITHIN METAL RACEWAY/PULL BOX.
10. EUL-CR-12-5 EUL-CR-12-6:
FURNISH AND INSTALL PANELBOARD, 84 CIRCUIT PANELBOARD.
11. FURNISH AND INSTALL DUPLEX GFI OUTLET, CONDUIT AND WIRING. REFER TO DRAWING E-601 FOR NOTES REGARDING GFI OUTLET MOUNTING LOCATION.
12. FURNISH AND INSTALL SURFACE MOUNTED LIGHT FIXTURE.

FINAL CONSTRUCTION DOCUMENT (CD) BID SET

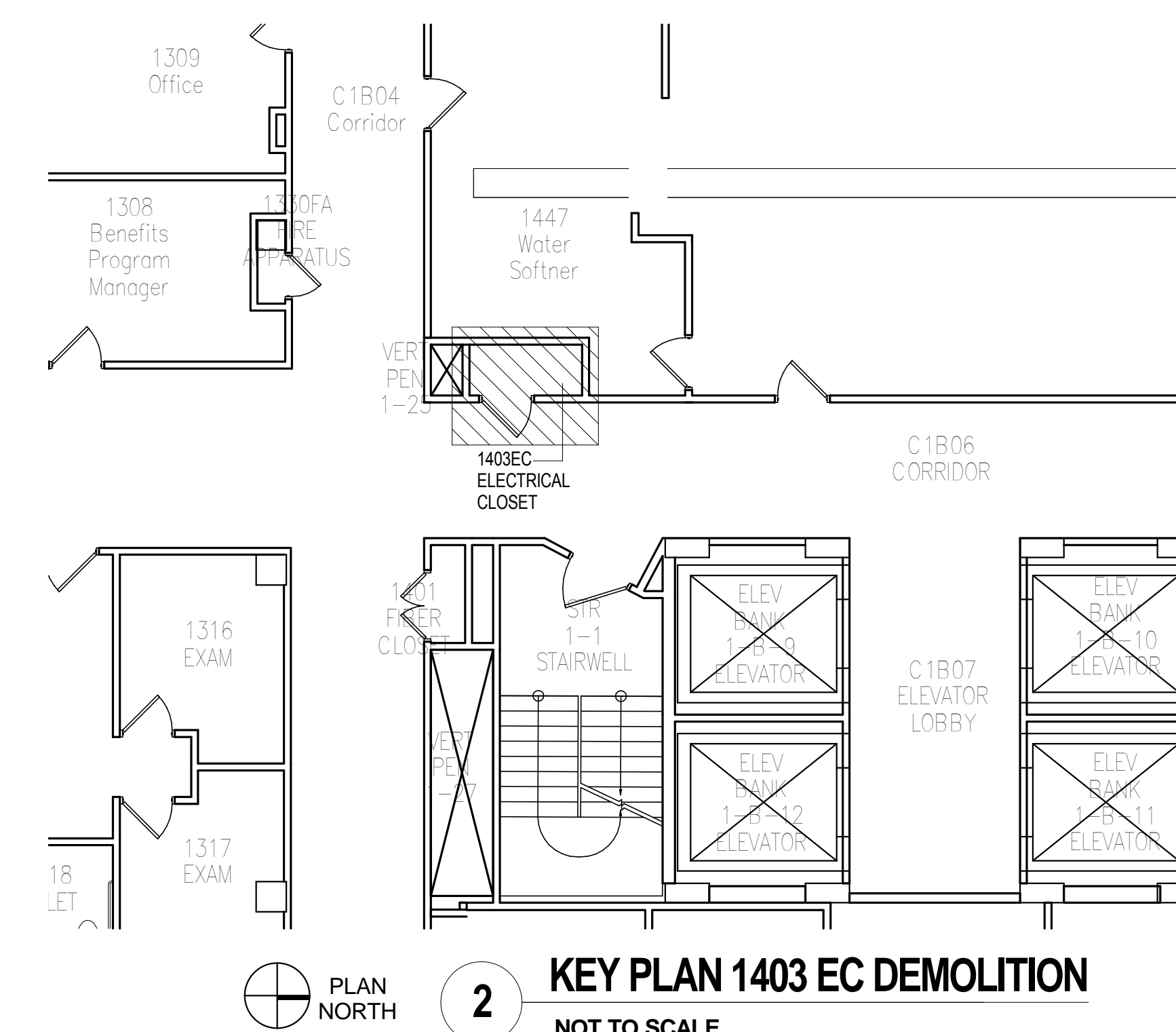

1403 EC

FINAL CONSTRUCTION DOCUMENT BID SET	01/13/2017
95% CONSTRUCTION DOCUMENT SUBMITTAL	10/13/2016
65% CONSTRUCTION DOCUMENT SUBMITTAL	08/02/2016
35% SCHEMATIC DESIGN SUBMITTAL	04/28/2016
Revisions:	Date

CONSULTANTS:

ARCHITECT/ENGINEERS:

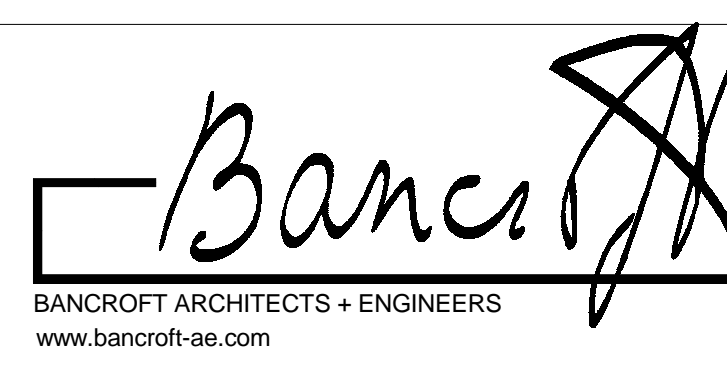

700 Nicholas Blvd. Suite 300
Elk Grove Village, IL 60007
T:847.952.9362 F:847.952.9400

Drawing Title	ROOM 1403 EC - ELECTRICAL DEMOLITION PLAN
---------------	--

Approved: Project Director

VAPAHCS PLANNING AND ENGINEERING

Project Title	UPGRADE W PANELS
---------------	------------------

Location	5000 W. NATIONAL AVE MILWAUKEE, WI 53295
----------	---

Date

	Checked
--	---------

Project Number	695-16-108
----------------	------------

Building Number
111Drawing Number
FD-11

Drawn

Office of
Construction
and Facilities
Management





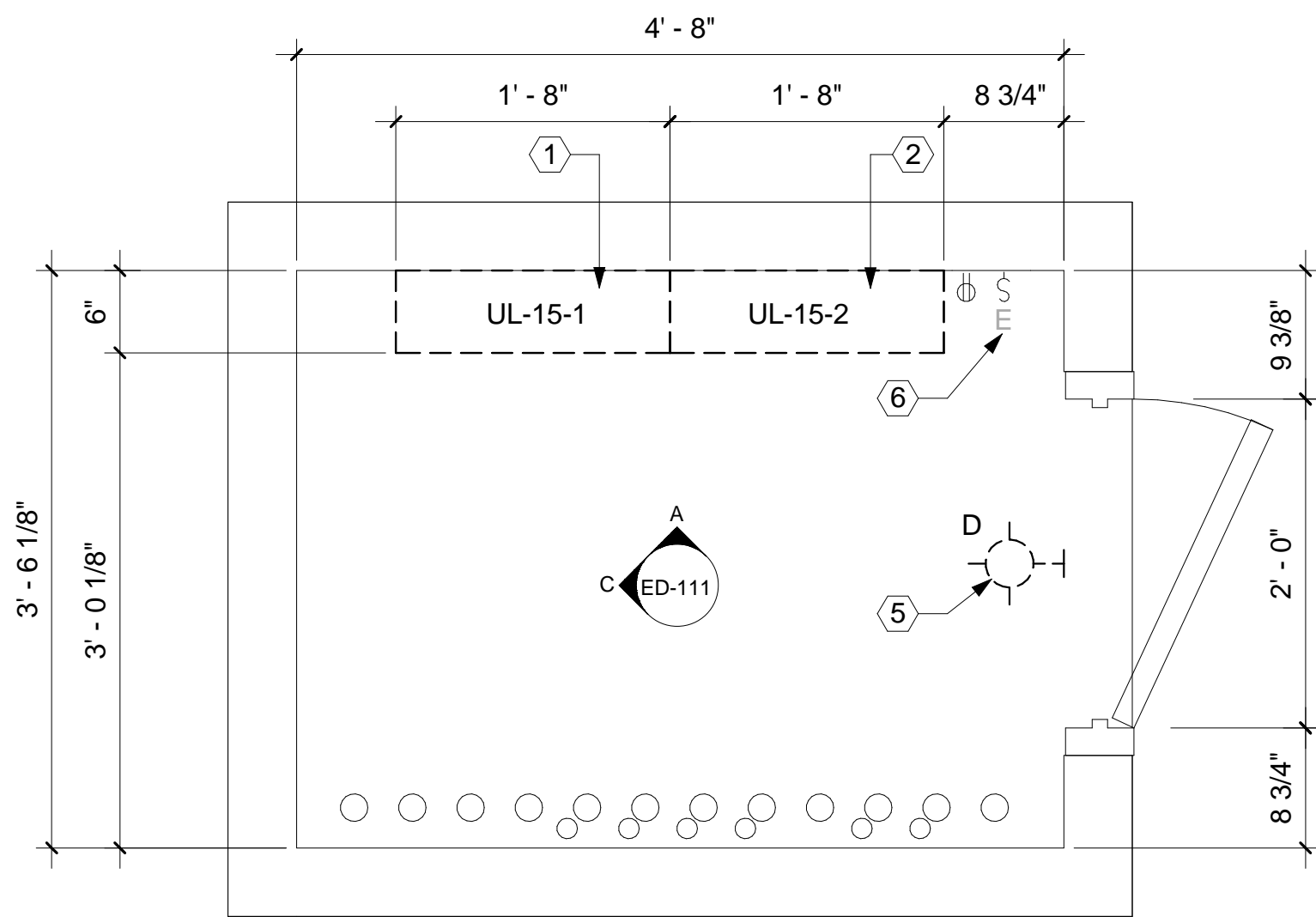

1 FIRST FLOOR LEVEL - 1502 EC - DEMOLITION PLAN
1" = 1'-0" 0 1/2' 1' 2'

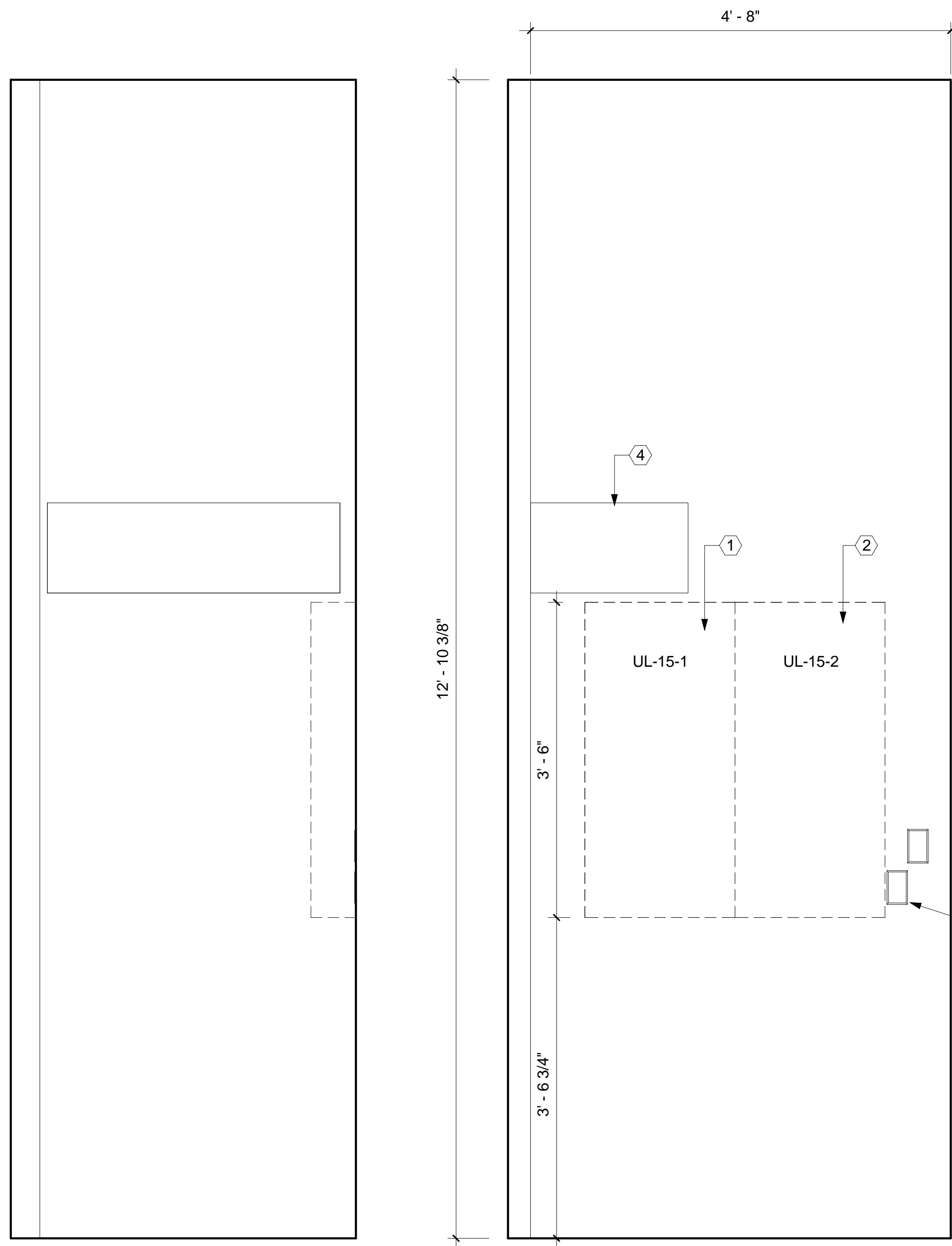

C 1502 EC - DEMOLITION ELEVATION C
1" = 1'-0" 0 1/2' 1' 2'

A 1502 EC - DEMOLITION ELEVATION A
1" = 1'-0" 0 1/2' 1' 2'

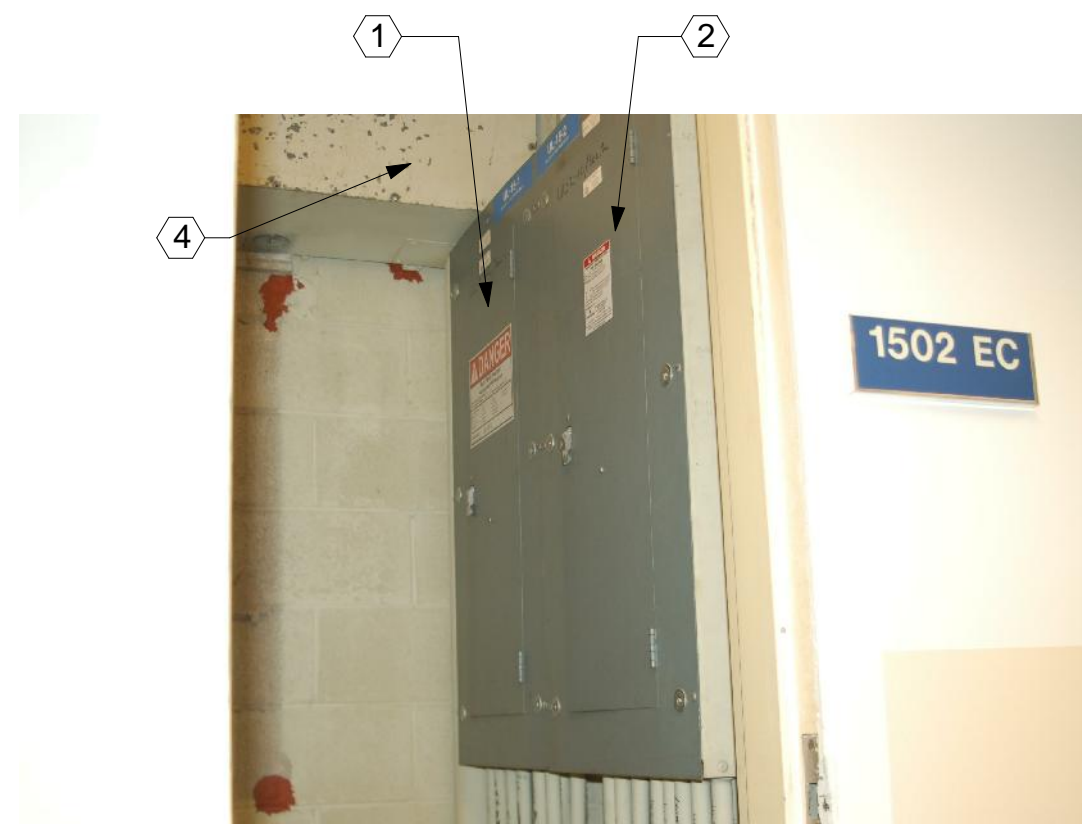

P1 1502 EC - PHOTO 1
NOT TO SCALE



P2 1502 EC - PHOTO 2
NOT TO SCALE

GENERAL NOTES

- REFER TO DRAWING ED-601 FOR DEMOLITION DETAIL OF TYPICAL EXISTING PANELBOARD.
- REFER TO SPECIFICATIONS, VOLUME 2, APPENDIX B - PHOTO DOCUMENTATION - EXISTING ELECTRICAL CLOSETS FOR INTERIOR PHOTOS OF PANELBOARDS.

ELECTRICAL KEYED NOTES

- DEMOLISH EXISTING PANELBOARD UL-15-1. EXISTING PANELBOARD IS 42 CIRCUIT PANELBOARD. DEMOLISH FEEDER CABLES AND RESPECTIVE CONDUITS. DEMOLISH BRANCH WIRING AND CONDUITS.
- DEMOLISH EXISTING PANELBOARD UL-15-2. EXISTING PANELBOARD IS 42 CIRCUIT PANELBOARD. DEMOLISH FEEDER CABLES AND RESPECTIVE CONDUITS. DEMOLISH BRANCH WIRING AND CONDUITS.
- DEMOLISH EXISTING DUPLEX OUTLET.
- EXISTING METAL RACEWAY/PULL BOX TO REMAIN.
- DEMOLISH EXISTING SURFACE MOUNTED LIGHT FIXTURE, WIRING, AND CONDUIT.
- EXISTING SURFACE MOUNTED LIGHT SWITCH SHALL REMAIN. DEMOLISH WIRING FROM EXISTING SWITCH TO EXISTING LIGHT FIXTURE.

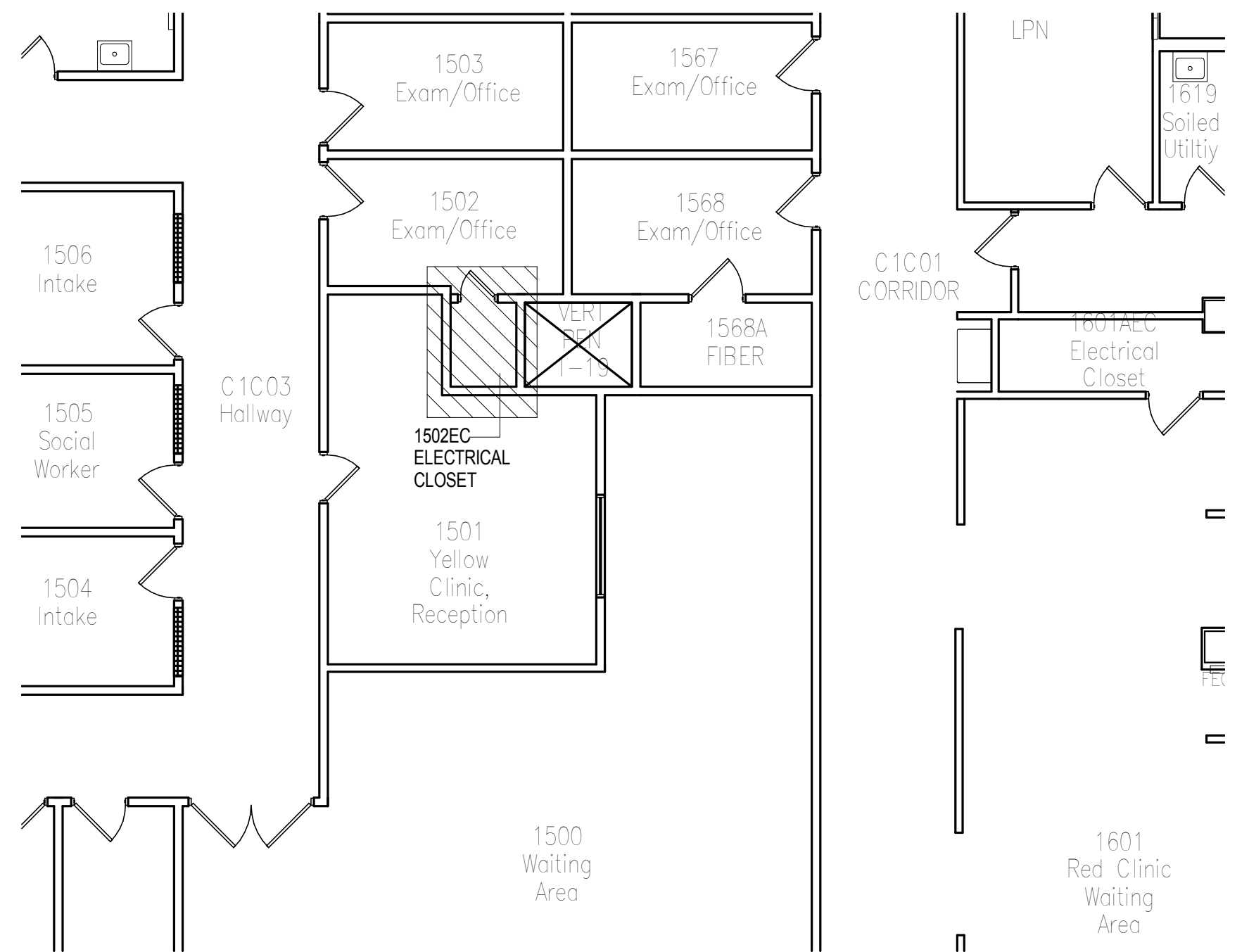

2 KEY PLAN 1502 EC DEMOLITION
NOT TO SCALE

1502 EC

VA CONTRACT NO. VA69D-15-J-1908

Revisions:	Date
FINAL CONSTRUCTION DOCUMENT BID SET	01/13/2017
95% CONSTRUCTION DOCUMENT SUBMITTAL	10/13/2016
65% CONSTRUCTION DOCUMENT SUBMITTAL	08/02/2016
35% SCHEMATIC DESIGN SUBMITTAL	04/28/2016

CONSULTANTS:

ARCHITECT/ENGINEERS:

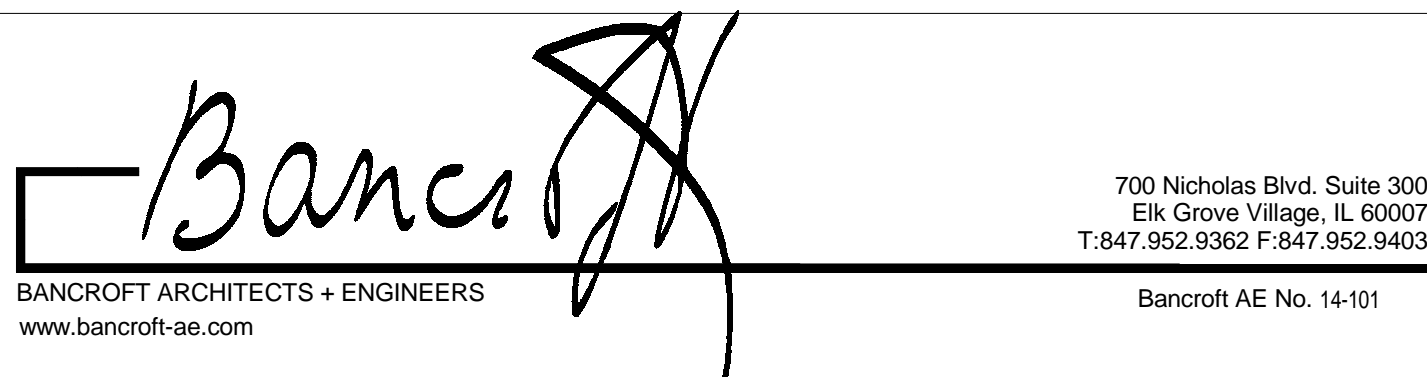

Drawing Title
ROOM 1502 EC - ELECTRICAL
DEMOLITION PLAN

Approved: Project Director
-
VAPAHCS PLANNING AND ENGINEERING

Project Title
UPGRADE W PANELS

Location
5000 W. NATIONAL AVE.
MILWAUKEE, WI 53295

Date
01/13/2017

Checked
LF

Drawn
AG AB EM

Project Number
695-16-108

Building Number
111

Drawing Number
ED-111

Office of
Construction
and Facilities
Management

