

SYMBOL LEGEND:

	EXISTING MANHOLE		EXISTING WATER SERVICE VALVE
	EXISTING STORM INLET		EXISTING OUTLET POST
	EXISTING STORM CLEANOUT		EXISTING GUARD POST
	EXISTING SANITARY CLEANOUT		EXISTING FLAG POLE
	EXISTING ELECTRIC MANHOLE		EXISTING UNDERGROUND POWER LINE
	EXISTING GATE VALVE		EXISTING SANITARY SEWER LINE
	EXISTING FIRE HYDRANT		EXISTING IRRIGATION LINE
	EXISTING LIGHT POLE		EXISTING STORM SEWER LINE
	EXISTING TRANSFORMER		EXISTING WATERMAIN LINE
	EXISTING TREE		EXISTING CHILLED WATER LINE
	EXISTING TREE		EXISTING GAS LINE
	EXISTING SHRUB		EXISTING UNDERGROUND TELEPHONE LINE
	EXISTING POWER POLE		EXISTING OVERHEAD POWER LINE
	EXISTING POWER POLE WITH RISER		EXISTING UNDERGROUND TELEVISION
	EXISTING POWER POLE ANCHOR		EXISTING UNDERGROUND FIBER OPTIC
	EXISTING TELEPHONE PEDESTAL		EXISTING CHAIN LINK FENCE
	EXISTING TELEVISION PEDESTAL		REMOVE EXISTING CONCRETE PAVEMENT
	EXISTING STREET SIGN		REMOVE EXISTING ASPHALT PAVEMENT
			REPAIR EXISTING FAULT SLIP W/ GEOGRID (REFER TO SPEC SECTION 31 3419 GEOGRID SOIL)

PLAN NOTES:

- CONTRACTOR SHALL LOCATE ALL UTILITIES PRIOR TO CONSTRUCTION. NORTH DAKOTA ONE CALL WILL ONLY LOCATE THEIR MAINS AND WILL NOT LOCATE PRIVATE UTILITIES ON THIS SITE. THE VA IS NOT RESPONSIBLE FOR LOCATING ANY ON SITE UTILITIES.
- CONTRACTOR SHALL FIELD VERIFY LOCATION AND ELEVATION OF ALL EXISTING/PROPOSED UTILITY CROSSINGS, AND WHERE EXISTING UTILITIES CONNECT INTO NEW UTILITY MAINS.
- ALL PAVEMENT MARKED FOR DEMOLITION SHALL BE FULL DEPTH SAW CUT PRIOR TO REMOVAL.
- CONTRACTOR SHALL KEEP ACCESS OPEN TO ALL EXISTING DOORS, FIRE EXITS, AND LOADING DOCKS DURING ALL PHASES OF CONSTRUCTION. IF TEMPORARY CLOSURES ARE REQUIRED, COORDINATE WITH VA ADMINISTRATION A MINIMUM OF 2 WEEKS IN ADVANCE.
- CONTRACTOR IS REQUIRED TO MAINTAIN ONE DRIVING LANE OPEN AT ALL TIMES. IF ROAD CLOSURE IS REQUIRED, COORDINATE WITH VA ADMINISTRATION A MINIMUM OF 2 WEEKS IN ADVANCE.
- CONTRACTOR IS RESPONSIBLE FOR GENERAL TRAFFIC CONTROL TO ALLOW FOR PUBLIC ACCESS THROUGH THE PROJECT SITE. CONTRACTOR SHALL PROVIDE ADEQUATE SIGNS FOR PUBLIC SAFETY AND TRAFFIC CONTROL. CONTRACTOR IS RESPONSIBLE TO KEEP ACCESS TO THE EAST & NORTH LOADING DOCK OPEN FOR DAILY DELIVERIES & COORDINATE ANY RESTRICTIONS WITH THE VA ADMINISTRATION.
- CONTRACTOR SHALL MAINTAIN 7.5' BURY DEPTH OVER ALL NEW WATERMAIN.
- CONTRACTOR SHALL PROTECT THE EXISTING WATERMAIN AND ENSURE THAT VA MEDICAL CAMPUS HAS NO DISRUPTION OF SERVICE. NEW WATERMAIN SHALL BE INSTALLED AND OPERATIONAL BEFORE ANY DISCONNECTION OF EXISTING WATER SERVICE. COORDINATE ANY REQUIRED LOSS OF SERVICE WITH VA ADMINISTRATION PRIOR TO WORK.
- CONTRACTOR WILL BE RESPONSIBLE FOR PROVIDING A TEMPORARY WATER SERVICE TO THE AFFECTED VA BUILDINGS. THE METHOD OF PROVIDING THE TEMPORARY WATER SERVICE SHALL BE AN OPTION OF THE CONTRACTOR SUBJECT TO THE APPROVAL OF THE ENGINEER. ALL TEMPORARY WATER MAINS AND SERVICES SHALL BE DISINFECTED IN ACCORDANCE WITH THE SPECIFICATIONS. ONE WATER SAMPLE PER SERVICE CONNECTION WILL BE TAKEN AFTER THE TEMPORARY WATER LINE IS FLUSHED. THE SAMPLE SHALL SHOW THE ABSENCE OF BACTERIA BEFORE CONNECTIONS ARE ALLOWED.
- THE CONTRACTOR SHALL INSTALL A TEMPORARY BYPASS TO MAINTAIN UNINTERRUPTED SEWER SERVICE ON SEWER RECONSTRUCTION WHERE WORK WILL INTERFERE WITH SEWAGE FLOW IN THE EXISTING SEWER. THE BYPASS SHALL BE MADE BY DIVERTING THE EFFLUENT FLOW AT AN UPSTREAM ACCESS MANHOLE AND PUMPING IT THROUGH A SEPARATE CONDUIT TO A DOWNSTREAM REENTRY POINT OR TO AN ADJACENT SEWER SYSTEM. THE PUMP AND BYPASS CONDUIT SHALL BE OF ADEQUATE SIZE AND CAPACITY TO HANDLE THE FLOW. THE EFFLUENT LEVEL IN THE BYPASS PUMPING MANHOLE SHALL NOT BE ALLOWED TO RISE MORE THAN 1 FOOT ABOVE THE CROWN OF THE INCOMING SEWER PIPE. BYPASS PUMPING SHALL BE INCIDENTAL TO THE SEWER WORK.
- CONTRACTOR SHALL PROVIDE AND INSTALL ANY ADDITIONAL FITTINGS, PIPING, AND OFFSETS TO ACCOUNT FOR UTILITY LOCATIONS AND CROSSINGS NOT INDICATED ON THE PLANS.
- CONTRACTOR SHALL RELOCATE ANY EXISTING UTILITIES THAT CONFLICT WITH THE INSTALLATION OF THE NEW SANITARY SEWER, STORM SEWER, AND WATERMAIN. ADDITIONAL WORK AND MATERIALS SHALL BE INSTALLED AT NO COST TO THE PROJECT.
- ALL GRASSED AREAS DISTURBED BY CONSTRUCTION SHALL HAVE TOPSOIL (6" DEPTH), GRADED, SEEDED, AND HYDRO-MULCHED.

BENCHMARKS:

- BM #1: THE SOUTHEAST FLANGE BOLT OF THE FIRE HYDRANT LOCATED IN THE NORTHWEST CORNER OF THE INTERSECTION OF ELM STREET & 21ST AVENUE NORTH. ELEVATION = 902.46 (NAVD 88)
- BM#2: THE SOUTHEAST FLANGE BOLT OF THE FIRE HYDRANT LOCATED IN THE SOUTH PARKING LOT. ELEVATION = 891.74 (NAVD 88)

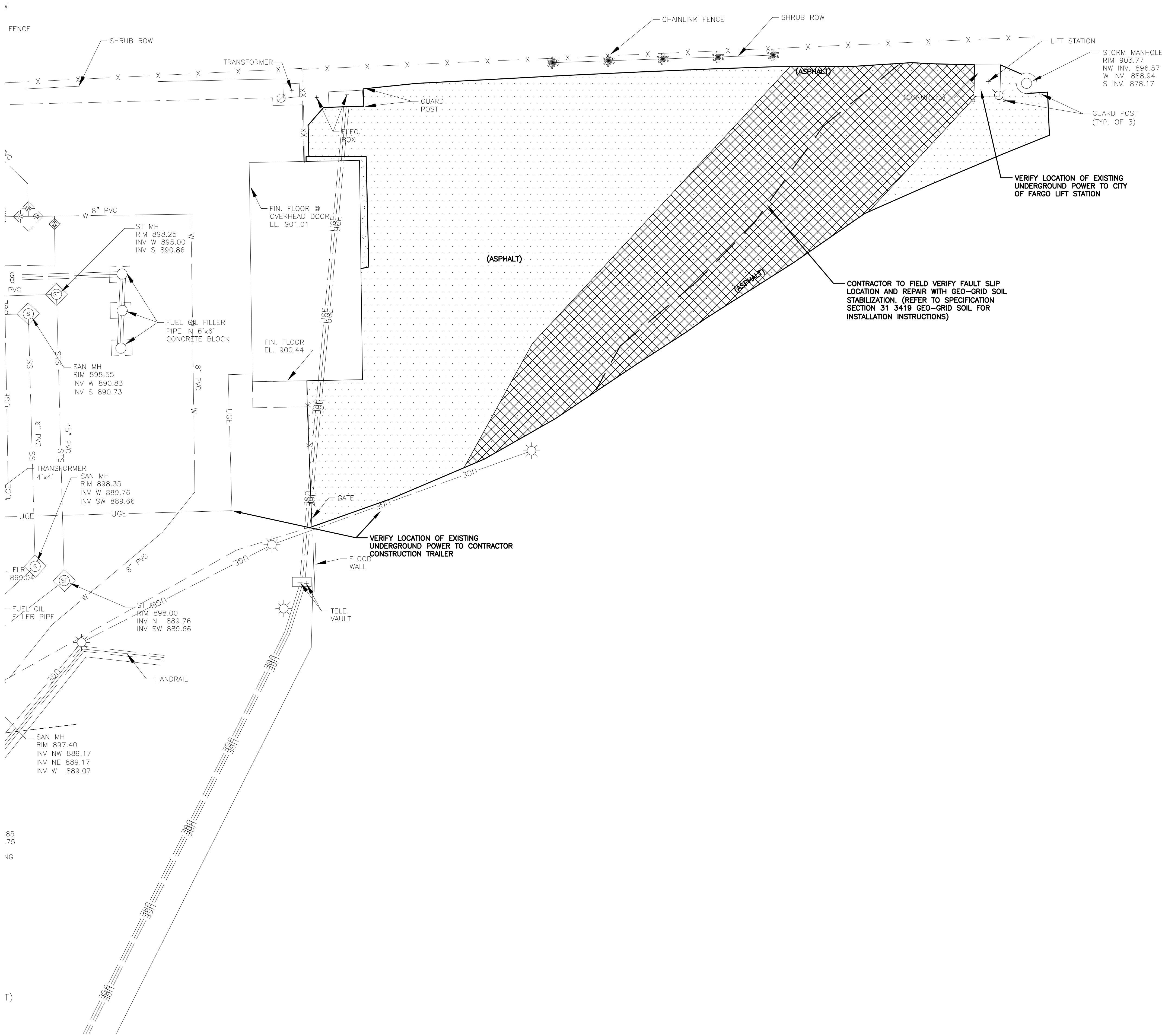

	Dept. of Veterans Affairs Medical Center 2101 Elm Street North Fargo, ND 58102		IMAGE GROUP INC., Architecture & Interiors MBN ENGINEERING, Civil Engineers			Drawing Title PHASE 9 - DEMOLITION PLAN		Project Title VA MEDICAL CENTER REPLACE UTILITY MAINS AND ASPHALT		Date MAY 17, 2012		Department of Veterans Affairs
						Contract No. VA263-P-1217 VA263-C-		Designed By TE	Checked By JM	Drawn By TE	Drawing No. C9.1	
Revisions		Date		Building No. SITE		AutoCAD File Name 11-10 C9.1.DWG		Location VA MEDICAL CENTER FARGO, ND		Dwg. 41 of 45		



○



- ## BENCHMARKS:

- \SPHALT)



Department of
Veterans Affairs



- BENCHMARKS:

1. BM #1: THE SOUTHEAST FLANGE BOLT OF THE FIRE HYDRANT LOCATED IN THE NORTHWEST CORNER OF THE INTERSECTION OF ELM STREET & 21ST AVENUE NORTH.
ELEVATION = 902.46 (NAVD 88)
2. BM#2: THE SOUTHEAST FLANGE BOLT OF THE FIRE HYDRANT LOCATED IN THE SOUTH PARKING LOT.
ELEVATION = 891.74 (NAVD 88)



Dept. of Veterans Affairs
Medical Center
2101 Elm Street North
Fargo, ND 58102

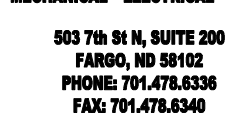

IMAGE GROUP INC., Architecture & Interiors
MBN ENGINEERING, Civil Engineers

Department of
Veterans Affairs