

three eighths inch = one foot
0 4 8 16
one eighth inch = one foot
0 4 8 16
one quarter inch = one foot
0 4 8 16
three eighths inch = one foot
0 4 8 16
one half inch = one foot
0 4 8 16
one inch = one foot
0 4 8 16
three quarters inch = one foot
0 4 8 16
one and one half inches = one foot
0 4 8 16
one and one half inches = one foot
0 4 8 16
three inches = one foot
0 4 8 16

GENERAL ASBESTOS ABATEMENT NOTES:

1. CONTRACTOR SHALL BE RESPONSIBLE FOR THE COMPLETION OF ASBESTOS MATERIAL REMOVAL AS DEFINED IN THE CONTRACT DOCUMENTS. CONTRACTOR SHALL BE RESPONSIBLE FOR ALL MEANS, METHODS, COORDINATION, SUPERVISION, MANAGEMENT, AND SEQUENCING TO COMPLETE THE WORK. CONTRACTOR SHALL MAKE ALL EFFORTS TO COOPERATE AND COORDINATE WORK WITH COR, OTHER CONTRACTORS, AND THEIR REPRESENTATIVES. COORDINATE BUILDING/POWER/HVAC ISOLATION WITH COR.
2. ALL MATERIAL REMOVAL AND DISPOSAL SHALL BE IN ACCORDANCE WITH THE PROJECT SPECIFICATIONS.
3. ALL PROPOSED DECONTAMINATION CHAMBER LOCATIONS, POWER AND WATER SOURCES, AND STAGING AREAS SHALL BE SUBMITTED BY THE CONTRACTOR AND APPROVED BY THE COR.
4. THIS CONTRACT INCLUDES THE REMOVAL AND DISPOSAL OF ASBESTOS CONTAINING MATERIAL WITHIN UTILITY CHASES. QUANTITIES AND LOCATIONS OF MATERIALS TO BE REMOVED INDICATED ON THESE DRAWINGS ARE ESTIMATES ONLY. THIS INFORMATION IS PROVIDED FOR GUIDANCE ONLY. THE CONTRACTOR SHALL VERIFY QUANTITIES AND LOCATIONS. AT A MINIMUM, MATERIALS IDENTIFIED ON THESE DRAWINGS ARE TO BE REMOVED AND DISPOSED OF IN A LEGAL MANNER.
5. CONTRACTOR TO COORDINATE SCHEDULE OF ASBESTOS ABATEMENT WORK WITH THE COR.
6. FIRE DETECTION AND PROTECTION SYSTEMS SHALL REMAIN IN SERVICE. REQUIRED SHUT DOWNS SHALL BE COORDINATED 24 HOURS PRIOR WITH THE COR.
7. PROVIDE FIRE EVACUATION PLAN FOR WORK AREAS - POST AT DECON.
8. THESE DRAWINGS DO NOT SHOW ALL PIPING, EQUIPMENT AND MOVABLE OBJECTS WITHIN THE BUILDING. THE CONTRACTOR SHALL VERIFY EXISTING CONDITIONS OF WORK AND COORDINATE RELOCATION OF ANY ITEMS WITH THE COR.
9. THE ASBESTOS CONTRACTOR MAY NOT USE APPLICABLE VARIANCES FROM INDUSTRIAL CODE RULE 56 TO PERFORM ASBESTOS REMOVAL WORK WITHOUT PRIOR APPROVAL TO UTILIZE A SITE SPECIFIC VARIANCE. THE ASBESTOS CONTRACTOR SHALL SUBMIT TO THE COR FOR APPROVAL OF THE PROCEDURES TO BE UTILIZED FOR ASBESTOS REMOVAL; THE COR MAY DISAPPROVE THE USE OF ANY SITE SPECIFIC VARIANCE OR ELEMENTS THEREOF THAT MAY CONFLICT WITH THE TECHNICAL SPECIFICATIONS OR DRAWINGS.
10. THE ASBESTOS CONTRACTOR SHALL CONSTRUCT THE PERSONNEL AND WASTE DECONTAMINATION ENCLOSURE UNITS IN CONFORMANCE WIT THE APPLICABLE REGULATIONS. COORDINATE LOCATION OF THE WASTE LOAD OUT ROUTE AND WASTE CONTAINER WITH THE COR.

LEGEND:

- ① SUSPECTED ACM CONTAINING PIPE CHASE. CONTRACTOR TO VERIFY AND ABATE EXISTING ASBESTOS CONTAINING MATERIALS.
- APPROXIMATE LOCATION OF ASBESTOS CONTAINING THERMAL SYSTEM INSULATION.
- APPROXIMATE LOCATION OF ASBESTOS CONTAINING FLOOR TILE.

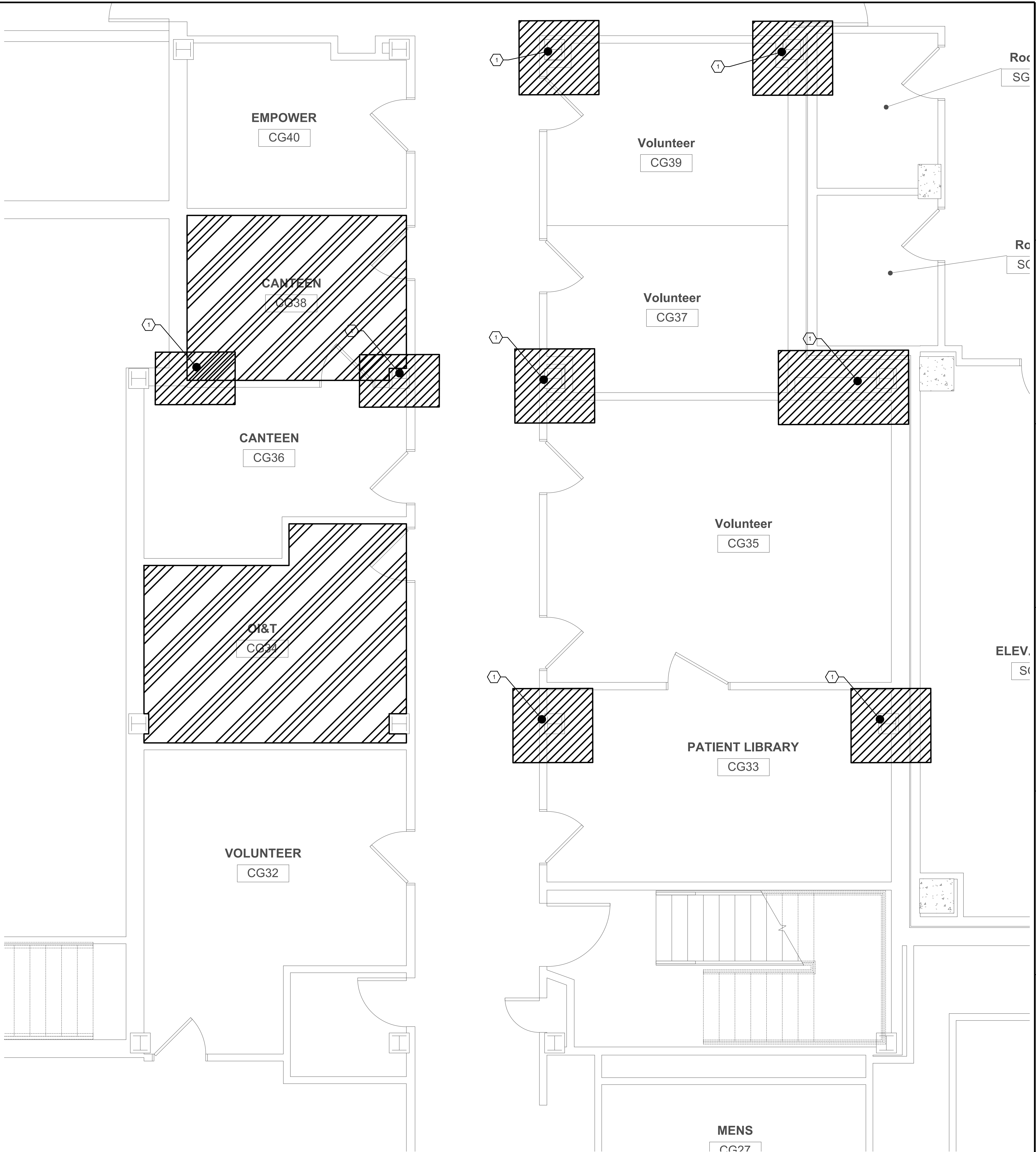

AMENDMENT #2	05/11/17
OUT TO BID	04/27/2017
ISSUED	DATE

REVISIONS	DATE

DRAWING TITLE	GROUND FLOOR ASBESTOS ABATEMENT PLAN
APPROVED PROJECT DIRECTOR	CHRISTOPHER FRANI, CHIEF

PROJECT TITLE	4TH FLOOR, 3RD FLOOR, BASEMENT AND SUBBASEMENT ASBESTOS ABATEMENT
PROJECT NUMBER	528A7-17-0706
BUILDING NUMBER	BUILDING 1
DRAWING NUMBER	HA-103
DATE	04/18/2017
CHECKED	CA
DRAWN	ALB
DWG 4 OF 6	

SYRACUSE VA MEDICAL CENTER ENGINEERING DEPARTMENT
