

PARKING SPACES

| LOT # | REGULAR | HANDI | CAP | TOTAL |
|-------|---------|-------|-----|-------|
| 1 | 605 | 88 | | 693 |
| 1A | 62 | 0 | | 62 |
| 1B | 24 | 0 | | 24 |
| 2 | 44 | 2 | | 46 |
| 3 | 5 | 2 | | 7 |
| 4 | 109 | 4 | | 113 |
| 5 | 20 | 0 | | 20 |
| 6 | 176 | 4 | | 180 |
| 7 | 81 | 3 | | 84 |
| 8 | 81 | 2 | | 83 |
| 10 | 35 | 0 | | 35 |
| 11 | 86 | 7 | | 93 |
| 12 | 27 | 0 | | 27 |
| 14 | 21 | 2 | | 23 |
| 15 | 27 | 0 | | 27 |
| 16 | 28 | 2 | | 30 |
| 17 | 357 | 4 | | 361 |
| 18 | 10 | 29 | | 39 |
| 19 | 10 | 29 | | 39 |
| 20 | 352 | 25 | | 377 |
| 21 | 135 | 5 | | 140 |
| 22 | 345 | 0 | | 345 |
| 23 | 25 | 8 | | 33 |
| 24 | 121 | 5 | | 126 |
| 25 | 43 | 14 | | 57 |
| 26 | 17 | 4 | | 21 |
| 27 | 49 | 2 | | 51 |
| 28 | 30 | 0 | | 30 |
| COV | 39 | 3 | | 42 |
| | 2,964 | 217 | | 3,181 |

PARKING LOTS
28.0 ACRES

V.A. OWNED LAND
81,993 ACRES

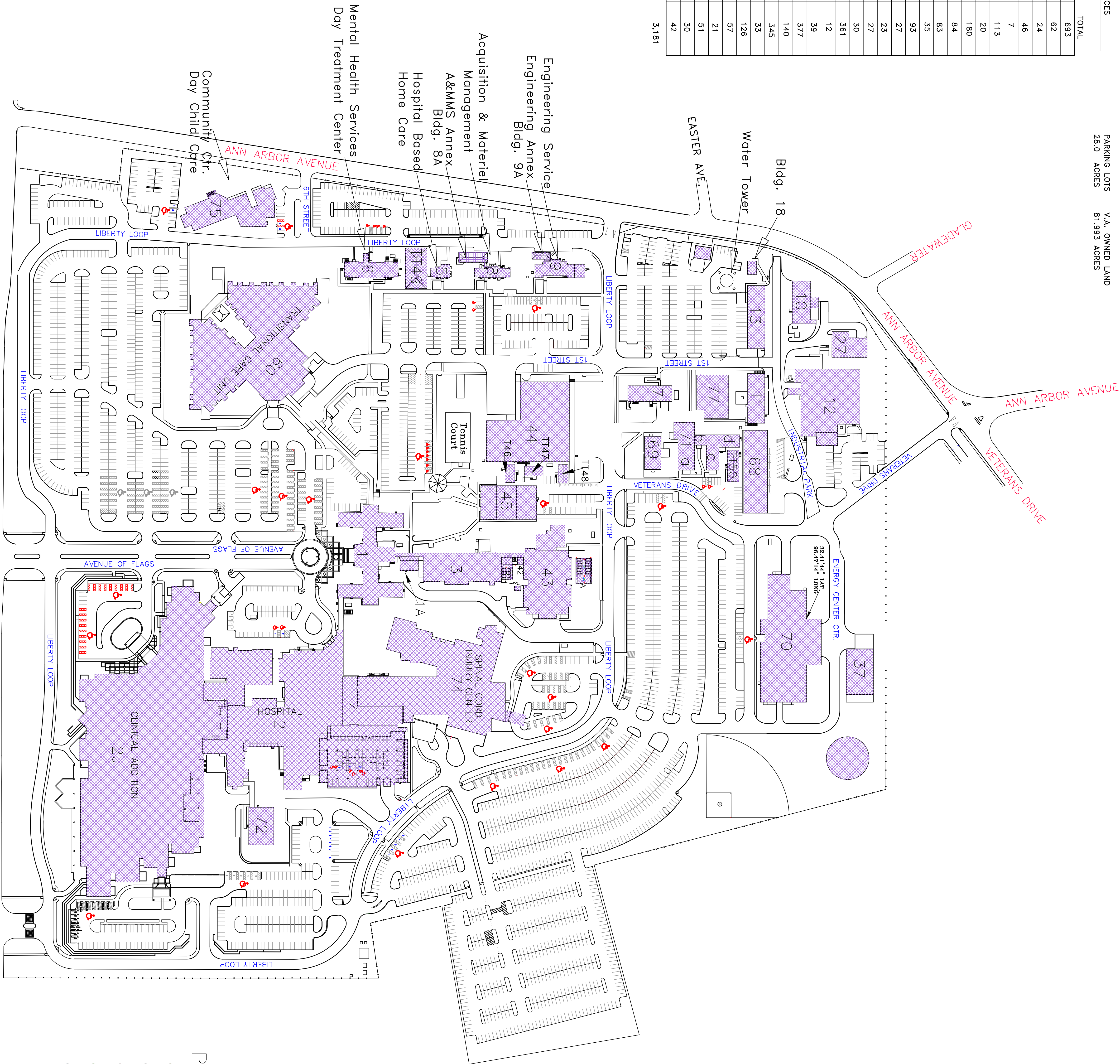

V.A.
North Texas Health
Care System

Dallas Veterans Affairs
Medical Center
4500 S. Lancaster Rd.
Dallas, Texas 75216
(214)742-8387
1-800-849-3597

Building Locator

March 15, 2006

- | | | |
|-------|--|-----------|
| 1. | HOSPITAL BUILDING | 102,042 |
| 1A. | UNION OFFICE | 1,480 |
| 2. | MAIN HOSPITAL BUILDING | 441,649 |
| 2J. | CLINICAL ADDITION | 1,212,934 |
| 3. | RESEARCH LABORATORIES | 23,581 |
| 4. | CHAPEL AND CLINICAL AREA | 38,550 |
| 5. | HOSPITAL BASED HOME CARE | 3,419 |
| 6. | MENTAL HEALTH SERVICES(DAY TREATMENT CENTER) | 12,702 |
| 7. | TEXAS TECH UNIVERSITY HEALTH SCIENCE CENTER | 24,882 |
| 8. | ACQUISITION & MATERIEL MGMT.(ADMIN) | 6,665 |
| 8A. | ACQUISITION & MATERIEL MGMT.SVC. SUPPORT STAFF | 1,623 |
| 9. | ENGINEERING SERVICE(SUPPORT STAFF | 4,818 |
| 9A. | ENGINEERING SERVICE(SUPPORT STAFF | 1,141 |
| 10. | BOILER PLANT(CLOSED) | 3,858 |
| 11. | ENGINEERING SHOPS | 5,506 |
| 12. | LAUNDRY | 29,511 |
| 13. | GARAGE, & ENGINEERING SHOPS | 6,388 |
| 15. | WATER TOWER | 710 |
| 18. | PUMP AND METER HOUSE | 4,619 |
| 27. | ENGINEERING STORAGE | |
| 37. | AC COOLING TOWER | |
| 146. | V.A. POLICE(ADMIN) | 1,055 |
| TT47. | FISCAL SERVICE | 1,059 |
| TT49. | ENVIRONMENTAL MANAGEMENT SVC.(ADMIN) | 5,096 |
| TT49. | QUALITY MANAGEMENT (SAFETY)/M.A.S. | 1,033 |
| TT50. | VETERANS INDUSTRIES (CWT) | 2,077 |
| 42. | RADIATION SAFETY STORAGE | 272 |
| 43. | RESEARCH AND EDUCATION BUILDING | 52,327 |
| 44. | WAREHOUSE | 30,642 |
| 45. | RECREATION & FISCAL & MCCR SVC.'S | 10,671 |
| 46. | ANIMAL INCINERATOR | |
| 58. | GAZEBO | |
| 60. | TRANSITIONAL CARE UNIT(T.C.U.) | 60,047 |
| 68. | ENGINEERING SUPPLY AND A&MM STORAGE | 8,136 |
| 69. | READJUSTMENT COUNSELING SVC. | 3,075 |
| 70. | ENERGY CENTER | 34,726 |
| 71A. | VETERANS INDUSTRIES (CWT) | 4,987 |
| 71(B | MENTAL HEALTH | 1,440 |
| C&D) | OUTPATIENT SERVICES | 3,291 |
| 72. | MRI BUILDING | 11,608 |
| 74. | SPINAL CORD INJURY (SCI) | 76,561 |
| 75. | COMMUNITY CTR./CHILD DAY CARE | 15,565 |
| 76. | AMB. CARE HEALTH SCREENING STORAGE | 1,213 |
| 77. | CENTRAL DENTAL LABORATORIES(C.D.L.) | 9,516 |
| "A" | KENNEL A | 2,301 |
| "B" | KENNEL B | 1,383 |

Parking DesignationInterior Legend

- | | |
|---------------------|----------------------------|
| ● Patient Parking | ○ Main Corridor |
| ● Staff Parking | → Building Entrances |
| ● General Parking | ■ Designated Smoking Areas |
| ● Volunteer Parking | ● Storm Manhole |
| ● Physician Parking | ○ C1 thru C8 |
| ● Handicap Parking | |
| P Police Parking | |

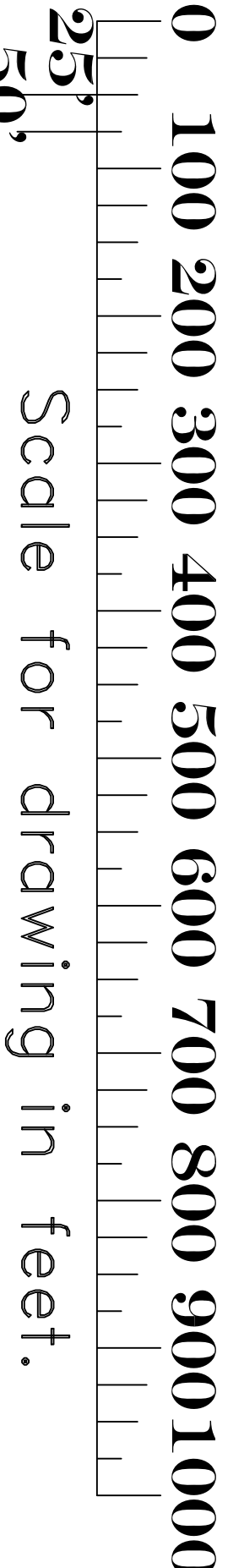

Scale for drawing in feet.

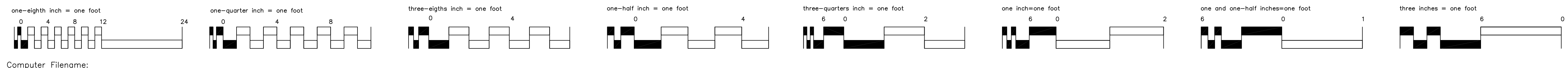

Computer Filename: Z:\Engineering\AutoCad_Eng\CadDrawings\VA SITE DWG\DallasSite.dwg | Release: 17.2s (LMS Tech)

Revisions: None, Station: whontktrk, 02/23/09 13:01, Plotting Scale: 1=8

VA FORM 08-6237A, JAN 1990

Project Title: Site Plan Drawing

Building Number: 4500 S. Lancaster Rd., Location: Dallas, Texas 75216

Checked: LDG, Drawn: LDG, Date: 6/18/98, Project No.: 2,268,795

North Texas Health System logo

VANTHCS Dallas, Texas