

NUMBERED NOTES ☒

1. DEMOLISH (E) TERMINAL UNIT. DEMOLISH (E) INLET AND OUTLET DUCTWORK AS REQUIRED FOR INSTALLATION OF NEW TERMINAL UNIT. DEMOLISH (E) VALVES. CAP (E) HHW PIPING TEMPORARILY. DEMOLISH (E) THERMOSTAT. DEMOLISH (E) PNEUMATIC TUBING BACK TO (E) TCP IN ROOM SB-160.
2. BASE BID: DEMOLISH (E) TERMINAL UNIT. DEMOLISH (E) INLET AND OUTLET DUCTWORK AS REQUIRED FOR INSTALLATION OF NEW TERMINAL UNIT. DEMOLISH (E) VALVES. CAP (E) HHW PIPING TEMPORARILY. DEMOLISH (E) THERMOSTAT. DEMOLISH (E) PNEUMATIC TUBING BACK TO (E) TCP IN ROOM SB-160.
3. BASE BID: DEMOLISH (E) SUPPLY DIFFUSER AND TRANSITION DUCT.

GENERAL NOTES

1. NOT ALL EXISTING UTILITIES LOCATED IN THE CEILING SPACE ARE SHOWN ON THE PLANS. UTILITIES NOT SHOWN INCLUDE BUT ARE NOT LIMITED TO POWER AND COMMUNICATIONS WIRING, AND CONDUIT, CABLE TRAYS, MEDICAL GAS, PLUMBING SERVICES, ETC. A CERTAIN QUANTITY OF THE EXISTING UTILITIES WILL HAVE TO BE RELOCATED AND/OR DEMOLISHED IN ORDER TO INSTALL THE NEW WORK. THE CONTRACTOR SHALL SURVEY THE SITE PRIOR TO BID AND INCLUDE IN HIS PROPOSAL A NECESSARY SUM AS REQUIRED FOR THE RELOCATION AND OR DEMOLITION OF EXISTING UTILITIES. ANY EXISTING UTILITIES WHICH ARE NO LONGER IN SERVICE (AS APPROVED BY THE VA) SHALL BE COMPLETELY DEMOLISHED IN THE AREA OF WORK.
2. SEE SHEETS GI-2 FOR ADDITIONAL WORK REQUIRED BY CONSTRUCTION PHASING.
3. PROVIDE INFECTION CONTROL MEASURES DURING ALL WORK IN THIS AREA. SEE SHEET GI2 "CONSTRUCTION DIRECTIVES."

PHASING

1. ALL WORK ON THIS SHEET IS PHASE 4.

SYMBOLS

- ☒ DEDUCTIVE BID ITEM INDICATOR

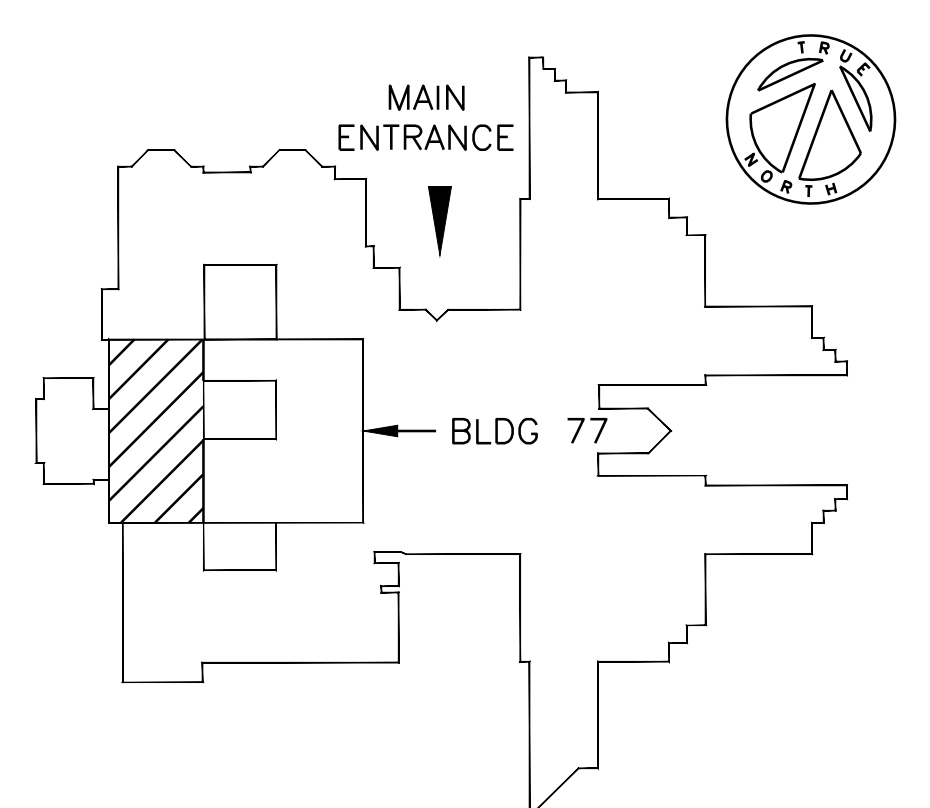

KEY PLAN
NOT TO SCALE

SECOND FLOOR PLAN
1/8" = 1'-0"

DATE	REVISIONS
5/7/12	REVISION 1
5/29/12	REVISION 2

Entek III
812 Grayson Road
Pleasant Hill, CA 94523
(925) 947-1400
entekiii@comcast.net
BRANCH OFFICE
1000 Parkwood Circle, St. 140
Atlanta, GA 30339
(800) 326-6063



Approved : Project Engineer	Approved : Associate Director
Approved : Supervisory Engineer	Approved : Director
Approved : VP FMS	Approved :

Drawing Title:
DEMOLITION - 2ND FLOOR

Project Title: REPLACE AIR HANDLER UNITS BUILDING 77	Date: 4/24/12
Drawn: BMA	Building Number: 77
Checked: PM	Location: JAMES H. QUALEN VA MEDICAL CENTER MOUNTAIN HOME, TN
Project No.: 621-11-127	Drawing No.: 77-D1
Dwg 3 of 20	

