

- | | | | |
|-----|---|-----|---|
| DE1 | REMOVE LIGHT AND ASSOCIATED WIRES, CONDUIT AND ANCHORS. | DE5 | REMOVE DOME LIGHT AND ALL ASSOCIATED WIRES AND CONDUIT BACK TO SOURCE. |
| DE2 | REMOVE LIGHT SWITCHES AND ASSOCIATED WIRES, CONDUIT AND GANG BOX BACK TO SOURCE | DE6 | REMOVE EMPTY GANG BOX AND ASSOCIATED CONDUIT |
| DE3 | REMOVE ELECTRICAL OUTLET STRIP AND ASSOCIATED WIRES AND CONDUIT BACK TO SOURCE | DE7 | REMOVE NURSE CALL SWITCH AND ASSOCIATED WIRES AND CONDUIT. SAVE SWITCH FOR REINSTALLATION |
| DE4 | REMOVE FLORESCENT LIGHT STRIP AND ASSOCIATED WIRES AND CONDUIT BACK TO SOURCE | DE8 | SUPPORT EXISTING NURSE CALL HEAD END EQUIPMENT DURING DEMOLITION - TO BE REINSTALLED |

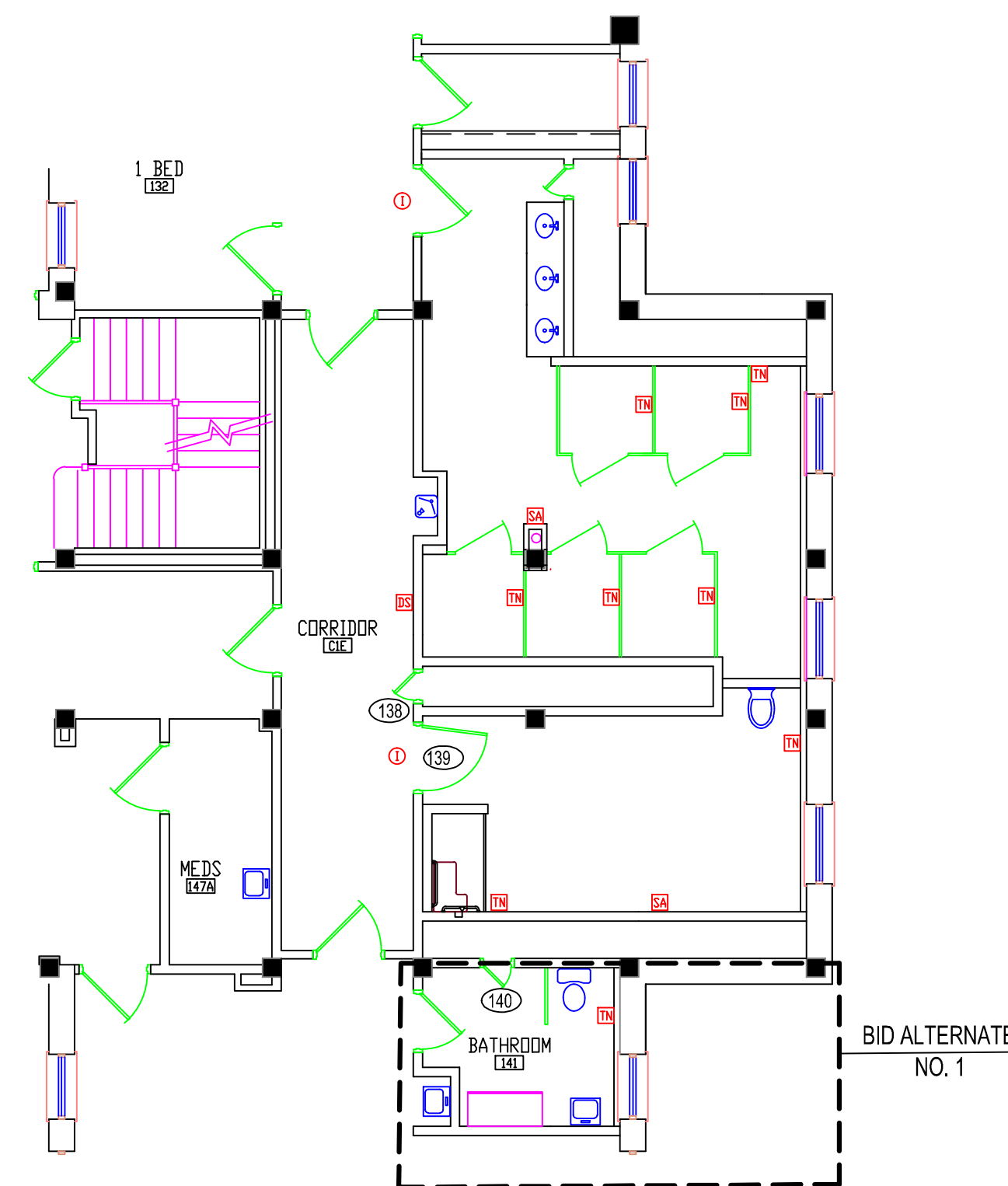

1. NURSE CALL MUST REMAIN FUNCTIONAL IN ALL AREAS NOT UNDER CONSTRUCTION.
2. HEAD END EQUIPMENT MUST BE PROTECTED AND SUPPORTED APPROPRIATELY DURING DEMOLITION AND CONSTRUCTION
3. PROVIDE NEW CONNECTIONS FROM PULL/CALL LOCATIONS TO CEILING MOUNTED LIGHTS, HEAD END EQUIPMENT AND MAIN NURSE PANEL.
4. PROVIDE WATER PROOF NURSE CALL EQUIPMENT IN BATHROOM AND TUB/SHOWER LOCATIONS.
5. ALL EQUIPMENT IS TO BE INSTALLED PER SPECIFICATIONS AND MANUFACTURERS RECOMMENDATIONS
6. NEW EQUIPMENT IS TO MATCH EXISTING. CONTRACTOR TO VERIFY REQUIREMENTS OF EXISTING RAULAND RESPONDER 4000 SYSTEM

-
- 1 BED
(130)
- CORRIDOR
(130)
- METER
(130)
- BATHING
(130)
- NOT TO BE USED
LIGHTS AND ARE TO UTILIZE CIRCUITS WHEN DISCONNECTED
DEMOLITION
CIRCUITS AS F
- BID ALTERNATE
NO. 1

- | | | | |
|----|---|----|---|
| E1 | PROVIDE NEW 24" x 48" LIGHT FIXTURE ACCORDING TO SPECIFICATIONS | E5 | PROVIDE: RECEPTACLE FOR DRYER |
| E2 | PROVIDE NEW 24" x 48" MOISTURE RESISTANT LIGHT FIXTURE PER SPECIFICATIONS | E6 | PROVIDE GFI OUTLET ABOVE COUNTER TOP HEIGHT |
| E3 | PROVIDE NEW 24" x 24" MOISTURE RESISTANT LIGHT FIXTURE PER SPECIFICATIONS | E7 | PROVIDE ELECTRICAL CONNECTION TO EXHAUST FAN, COORDINATE WITH MECHANICAL CONTRACTOR FOR SPECIFICATIONS ON FAN |
| E4 | PROVIDE GFI DUPLEX RECEPTACLE FOR WASHING MACHINE | E8 | PROVIDE 120V 20AMP CIRCUIT FOR APOLLO TUB - CONTRACTOR TO COORDINATE WITH VA. |



St. Cloud VA
Health Care System
Brainerd | Montevideo | Alexandria

RENOVATE BUILDING 48 ADHC BATHROOMS