

**PLUMBING - WATER/ WASTE/ VENT**  
1 DEMOLITION PLAN - THIRD FLOOR

**CONTRACTOR EXISTING UTILITIES NOTE:**

CONTRACTOR IS TO ALLOCATE MONEY IN THE FINAL PRICE AS REQUIRED TOWARD THE RE-WORKING OF EXISTING UTILITIES AND INSTALLATION OF NEW UTILITIES COMING IN AND GOING OUT OF ALL EXISTING CHASES AND COORDINATE RE-WORKING AND INSTALLATION OF UTILITIES WITH OTHER TRADES.

- KEY NOTES**
- 1 DEMOLISH EXISTING WASTE AND WATER LINES SERVING LABORATORY BENCH. SERVICES SHALL BE CAPPED IN THE CEILING OF THE FLOOR BELOW.
  - 2 DEMOLISH EXISTING FLOOR DRAIN. REPAIR/FILL FLOOR SLAB AS REQUIRED.
  - 3 DEMOLISH EXISTING WATER SERVICE AND VENT PIPING SERVING LABORATORY SINK/HOOD.
  - 4 NOT USED.
  - 5 DEMOLISH EXISTING HORIZONTAL COLD, HOT AND HOT WATER RE-CIRCULATION PIPING. DEMOLITION OF PIPING SHALL INCLUDE HANGERS AND OTHER ASSOCIATED DEVICES.
  - 6 DEMOLISH EXISTING HORIZONTAL COLD AND HOT WATER PIPING. DEMOLITION OF PIPING SHALL INCLUDE HANGERS AND OTHER ASSOCIATED DEVICES.
  - 7 DEMOLISH EXISTING RO WATER PIPING. DEMOLITION OF PIPING SHALL INCLUDE HANGERS AND OTHER ASSOCIATED DEVICES.
  - 8 DEMOLISH EXISTING VENT PIPING. DEMOLITION OF PIPING SHALL INCLUDE HANGERS AND OTHER ASSOCIATED DEVICES.
  - 9 DEMOLISH EXISTING BENCH SERVICE PIPING. PIPING IS ROUTED HORIZONTALLY IN LABORATORY CASEWORK.
  - 10 DEMOLISH EXISTING RO WATER SERVICE PIPING TO VERTICAL RISER.
  - 11 DEMOLISH EXISTING HORIZONTAL RO WATER SERVICE PIPING AS SHOWN FOR INSTALLATION OF NEW FLOOR LOOP. REFER TO NEW WORK PLANS.
  - 12 DEMOLISH EXISTING FLOOR MOUNTED ICE MACHINE AND CONNECTED SERVICES.
  - 13 DEMOLISH EXISTING WATER PURIFIER AND CONNECTED SERVICES.
  - 14 DEMOLISH EXISTING WATER SERVICE AND VENT PIPING SERVING LABORATORY SINK.
  - 15 DEMOLISH EXISTING HOOD AND CONNECTED SERVICES.
  - 16 DEMOLISH EXISTING COPPER PIPE THRU WALL.
  - 17 DEMOLISH EXISTING EQUIPMENT AND ASSOCIATED PIPING.
  - 18 DEMOLISH EXISTING PLUMBING FIXTURE ONLY. SERVICES TO FIXTURE ARE TO REMAIN FOR THE PURPOSE OF CONNECTING NEW FIXTURE TO THE EXISTING SERVICES. REFER TO SHEET 1-PL3.03 FOR THE NEW FIXTURE P&S AND REFER TO THE JOB SPECIFICATION BOOK FOR THE FIXTURE SPECIFICATION INFORMATION. THIS WORK IS TO BE PRICED AS PART OF DEDUCTIVE ALTERNATE #3.
  - 19 DEMOLISH EXISTING PLUMBING FIXTURE. DEMOLISH CONNECTED PIPING TO ABOVE CEILING AND CAP.
  - 20 DEMOLISH EXISTING VERTICAL RO RISER FOR INSTALLATION OF NEW VERTICAL RO RISER. REFER TO NEW WORK FLOOR PLANS FOR ADDITIONAL NEW RISER INFORMATION.
  - 21 DEMOLISH EXISTING WASTE AND VENT STACK LOCATED IN TOILET CHASE WALL FROM 3RD FLOOR CEILING DOWN INTO SECOND FLOOR CEILING FOR THE PURPOSES OF REPLACING EXISTING PIPING DUE TO PIPE DETERIORATION. REFER TO SHEET 1-PL3.03-357 FOR ADDITIONAL INFORMATION.

**WALL LEGEND**

---	EXISTING PARTITION
----	EXISTING ONE HOUR FIRE BARRIER
=====	EXISTING TWO HOUR FIRE BARRIER
- - - - -	PARTITION TO BE DEMOLISHED
----	NEW TYPICAL PARTITION
=====	NEW 1-HR. RATED FIRE PARTITION
=====	NEW 2-HR. RATED FIRE PARTITION

Revisions	Date
1 AMENDMENT #4	5/24/12



**Tennessee Valley Healthcare System**  
NASHVILLE CAMPUS

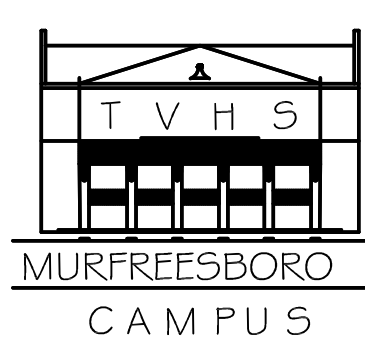

**Tennessee Valley Healthcare System**  
MURFREESBORO CAMPUS

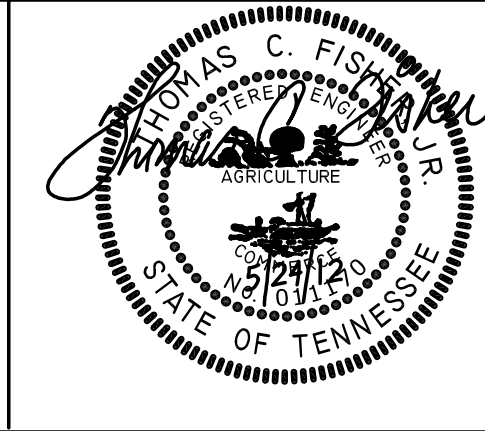

**PHOENIX DESIGN GROUP**  
104 Woodmont Blvd. #218  
Nashville, TN 37205

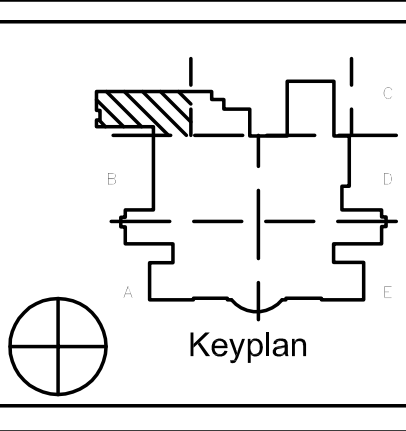

Project Title: VA Renovation Research Lab Phase 3	
Drawing Title: DEMOLITION PLAN - THIRD FLOOR - PLBG - WATER/ WASTE/ VENT	
Designed By: [Signature]	
Approved By: [Signature]	
Building Number: 1	Floor: 3
Checked By: RSM	Drawn By: BDA

Date: 3-5-2012
Project No.: 626-11-101
Drawing No.: 1-PL1.03.1-357
Draw: 60 OF 92

Department of Veterans Affairs

**FULLY SPRINKLERED**