

1 CHANGE TO NOTE, REVISED ON 6.4.12

NEW WORK NOTES

①	PROVIDE AND INSTALL AUTOMATIC METAL SLING DOORS (1 1/2 HOUR FIRE DOORS), WIRING, AND ALL HARDWARE TO MAKE IT OPERATIONAL. NEW DOORS ARE TO HAVE PUSH BUTTONS ON BOTH SIDES OF THE DOORS MOUNTED ON THE WALL AND PAINC BARS ON THE DOORS. USE EXISTING METAL DOOR FRAME. DOORS WILL BE PAINTED USING SHERWIN WILLIAMS, DTM ACRYLIC PAINT 2-COATS. PISH BUTTONS ALONG WITH THE WIRING WILL BE EMBEDDED INTO THE RED CLAY BRICK WALL.
②	PROVIDE AND INSTALL NEW ROOM WALLS SHALL HAVE 5/8 SHEETROCK (BOTH SIDES) WITH METAL STUDS. NEW WALL WILL BE FROM FLOOR TO 6" ABOVE THE CEILING (SEE LOCATION ON PLANS). TAPE AND FLOAT NEW WALLS AND PREPARE FOR PAINT. TAPE, FLOAT AND PAINT ALL NEW WALLS 1-COAT PRIMER, 2-COATS SHERWIN WILLIAMS HARMONY SEM-GLOSS PAINT. COLOR TO BE DETERMINED BY THE VA. PROVIDE AND INSTALL NEW CEILING TILES AS NEEDED FOR THE NEW ROOM. CEILING TILES TO MATCH QUALITY AND TYPE OF ROOM 473 AND 475. PROVIDE AND INSTALL NEW 6" COVE BASE ALONG ALL THE NEW WALLS BOTH INSIDE AND OUTSIDE THE NEW ROOM. PROVIDE AND INSTALL ONE NEW FIRE SPRINKLER AND ALL MATERIALS WITHIN THE NEW ROOM. FIRE SPRINKLER QUALITY AND TYPE TO MATCH THE EXISTING FIRE SPRINKLER IN ROOM 473 OR RA 475. LOCATION OF THE NEW SPRINKLER TO BE COORDINATED WITH THE CODE. PROVIDE AND INSTALL TWO 110V RECEPTILES WITHIN THE NEW ROOM. ALL WIRING, AND METAL FACE PLATE COVER. (CONTRACTOR CAN UTILIZE THE TWO DEDICED RECEPTILES. SEE DEMO). PROVIDE AND INSTALL ONE NEW LIGHT SWITCH WITHIN THE NEW ROOM. WIRING, METAL FACE PLATE COVER. PROVIDE AND INSTALL TWO 6" RECESSED LED LIGHT FIXTURES AND ALL HARDWARE.
③	PROVIDE AND INSTALL A NEW WOOD DOOR, DOOR FRAME, AND ALL HARDWARE (SEE LOCATION ON PLANS). PAINT THE NEW DOOR AND FRAME WITH SHERWIN WILLIAMS HARMONY SEM GLOSS PAINT OR EQUIVALENT.
④	PROVIDE AND INSTALL HVAC DROP, DUCTING, AND SUPPLY VENT. CONTRACTOR WILL TEST AND BALANCE TO ENSURE NEW ROOM IS NEGATIVE TO ROOM 473.
⑤	PROVIDE AND INSTALL NEW CEILING TILES IN ROOM 473, 477, 471, 472, 476 AND IN THE CORRIDOR TO MATCH THE QUALITY AND TYPE IN ROOM 473 (APPROX. 1550 SQUARE FT.).
⑥	PROVIDE AND INSTALL ONE NEW POCKET DOOR AND ALL HARDWARE. SEE BOTH LOCATIONS ON THE PLANS. PAINT THE NEW POCKET DOORS AND FRAMES WITH 2-COATS SHERWIN WILLIAMS HARMONY SEM-GLOSS PAINT. COLOR TO BE DETERMINED BY THE VA.
⑦	PROVIDE AND INSTALL ONE 18"W X 60"L STAINLESS STEEL BENCH. BENCH NEEDS TO SUPPORT A WEIGHT OF 400 LBS.
⑧	PROVIDE AND INSTALL ONE NEW ISOLATION MONITOR BRAND: TRATEX FM 1600 SERIES OR NEW SERIES.
⑨	NOT USED
⑩	NOT USED
⑪	NOT USED

DEMO NOTES

DEMO NOTES	
(12)	CUT THE EXISTING CABINET ALONG THE SOUTH WALL OF RM. 473 (APPROX. 48"). REMOVE THE STEEL CABINET FROM THE WALL. RELOCATE THE 48" OUT-OFF CABINET TO THE SOUTH WALL OF RM. 475 AND MOUNT TO THE WALL. REPAIR THE CUT PORTION OF THE CABINET BEFORE INSTALLING. (CONTRACTOR WILL BE ALLOWED TO REPAIR CABINET OFF-SITE BEFORE RETURNING).
(13)	DEMO EXISTING WALL FROM FLOOR TO CEILING TO ALLOW FOR INSTALL OF THE NEW DOOR. DEMO OF THE EXISTING FLOOR FOR THE NEW DOOR WILL BE NEEDED. REPAIR THE FLOOR AND ALL WALLS FOR A NEW FINISH. PROVIDE AND INSTALL A TRANSITION STRIP OR EQUAL TO CREATE A PROFESSIONAL FINISH.
(14)	USE EXISTING DOOR FRAME, DOUBLE EGRESS DOOR
(15)	REMOVE EXISTING LIGHT IN CONFLICT WITH CONSTRUCTION OF THE NEW ROOM.
(16)	DEMO EXISTING DOOR AND FRAME (ROOM 478). PROVIDE AND INSTALL A NEW WALL AT THE LOCATION OF THE REMOVED DOOR. TAPE AND FLOAT THE NEW WALL AND PREP FOR PAINT. PAINT NEW WALL 1-COAT PRIMER, 2-COATS SHERWIN WILLIAMS HARMONY SEM-GLOSS PAINT. PROVIDE AND INSTALL COVE BASE.
(17)	DISCONNECT LAB MEDVATOR AND FILTERS. MOVE MEDVATOR TO THE 2ND FLOOR OF BLDG. 11. CONNECT MEDVATOR AND FILTERS (MOUNT FILTERS TO THE WALL). PROVIDE AND INSTALL ONE 120 VAC, SINGLE PHASE, 60 OUTLET AT THE NEW LOCATION ON 2ND FLOOR OF BLDG. 11. PROVIDE AND INSTALL ONE GANGLER W/HER MINKING VALVE, QTY. 3 - BALL VALVES, 3/4" COPPER TUBING FOR THE HOT AND COLD WATER (APPROX. 6' TOTAL), 1 1/2" COPPER PIPE FOR DRAIN (APPROX. 8' TOTAL). INSTALL OF DRAIN PIPE WILL REQUIRE COPE DRILLING FLOOR TO IE INTO THE EXISTING 2" DRAIN. INSTALL OF THE 3/4" COPPER PIPE WILL INVOLVE CUTTING TWO HOLES THROUGH A 6" PLASTER WALL TO IE INTO THE EXISTING WATER IN THE ADJACENT ROOM.
(18)	BEFORE CONSTRUCTION BEGINS W/ALF MEDVATOR IN PLASTIC TO INSURE NO DUST OR DEBRIS CAN DAMAGE THE MEDVATOR OR FILTERS.
(19)	DEMO EXISTING WALL PAPER THROUGHOUT CORRIDOR (APPROX. 400 SQUARE FEET). PREP WALLS FOR PAINT. PAINT THE WALL AT THE LOCATION OF THE REMOVED WALL PAPER 1-COAT PRIMER, 2-COATS SHERWIN WILLIAMS HARMONY SEM-GLOSS PAINT.
(20)	DEMO THE EXISTING SUPPLY VENT IN CONFLICT WITH THE NEW WALL. PROVIDE AND INSTALL A NEW SUPPLY VENT WITHIN ROOM 473. DEMO ONE THERMOSTAT ON THE WALL IN CONFLICT WITH THE NEW WALL AND PROVIDE AND INSTALL A NEW THERMOSTAT WITHIN RM. 473 AT AN APPROVED LOCATION SPECIFIED BY THE CORP. DEMO TWO EXISTING ELECTRIC OUTLETS IN CONFLICT WITH THE NEW WALL. DEMO ONE TELEPHONE JACK AND RELOCATE AND INSTALL AT A NEW LOCATION WITHIN RM. 473. PATCH AND/OR REPAIR WALL BEHIND THE CABINET THAT IS REMOVED.
(21)	DEMO EXISTING FIRE ALARM STROBE. RELOCATE AND INSTALL EXISTING FIRE ALARM STROBE WITHIN RM. 473. ALONG THE NORTH WALL (UNLESS DAMAGED DURING DEMO). INSTALL WILL REQUIRE ADDITIONAL WIRING. INSTALL SHALL BE COMPLETE AND FUNCTIONING ON THE EXISTING ALARM SYSTEM.
(22)	DEMO ALL WALL TILE IN THE CORRIDOR. REPAIR WALL IF NEEDED. REMOVE EXISTING TERRAZO WALL BASE TO FORM A 90 DEGREE MANGLE. PROVIDE AND INSTALL NEW 4" COVE BASE.

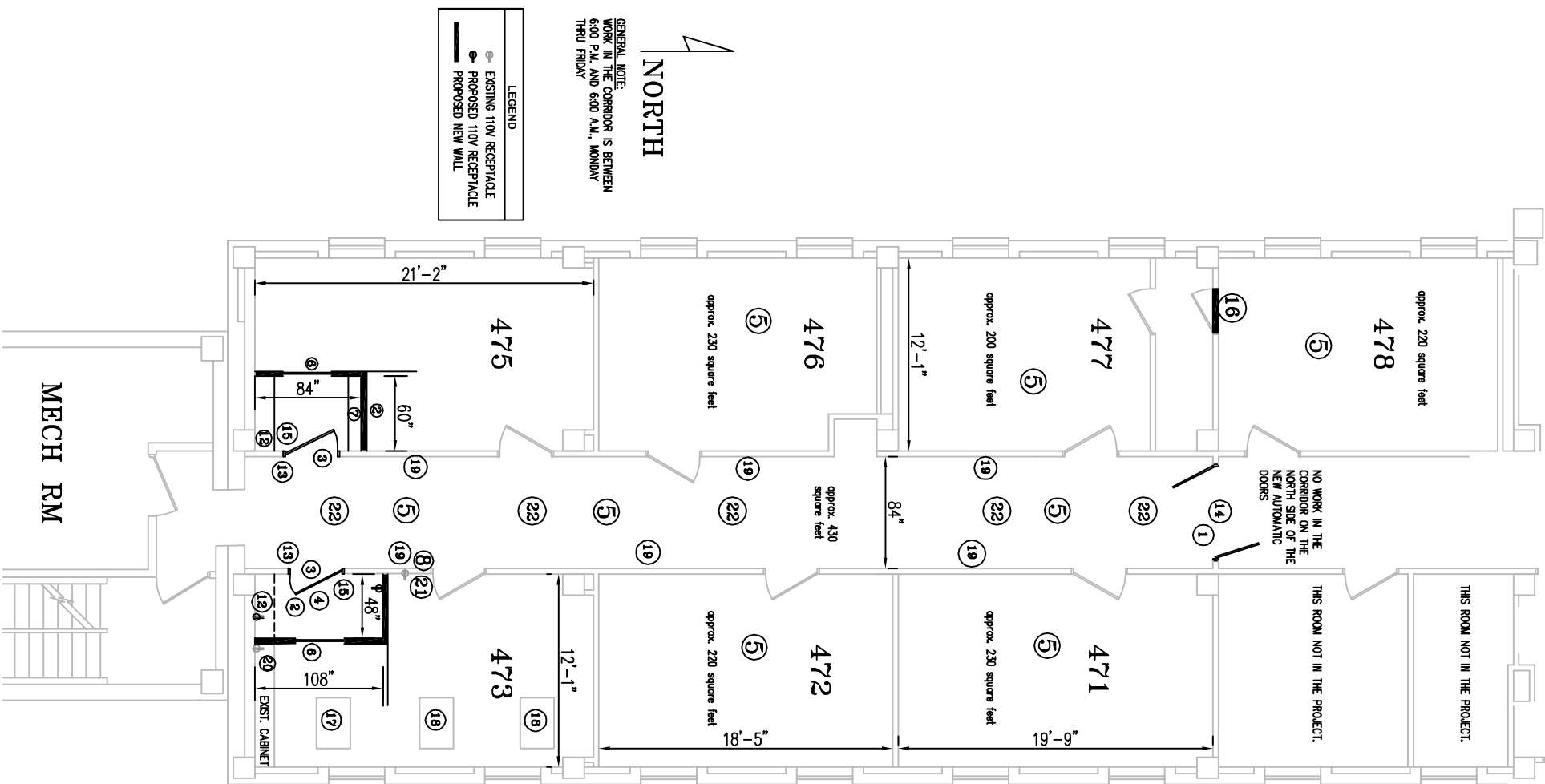

GENERAL NOTE:
WORK IN THE CORRIDOR IS BETWEEN
6:00 P.M. AND 6:00 A.M., MONDAY
THRU FRIDAY

NORTH

LEGEND

EXISTING 110V RECEPTACLE
PROPOSED 110V RECEPTACLE
PROPOSED NEW WALL

MECH RM