



U.S. Department of  
Veterans Affairs

RFP: UPDATE HINES CAPITAL ASSETS INVENTORY RECORDS  
EDWARD HINES, JR. VA HOSPITAL

APPROVED BY: ERIC J. KUTCHE  
BLDG NUMBER: 113  
PROJECT NUMBER: 578-14-012

CAI DEPARTMENT BY LEVEL	
CAI DEPARTMENT	AREA
0P - PENTHOUSE	
ENGINEERING	3,641 SF
VERTICAL SPACE	368 SF
01 - LEVEL 01	
BEDS BLIND REHAB	18,214 SF
COMMON SPACE	7,267 SF
VERTICAL SPACE	582 SF
02 - LEVEL 02	
BEDS BLIND REHAB	19,779 SF
COMMON SPACE	5,876 SF
VERTICAL SPACE	540 SF
BUILDING NET GROSS TOTAL	56,265 SF

1/17/2016 6:57:34 PM



Romanyk Consulting  
Focusing on what matters

01	CAI SPACE PLAN	6/30/2015
NO.	REVISION / DESCRIPTION	ISSUE DATE

1/17/2016 6:57:34 PM

CAI DEPARTMENT

- ENGINEERING
- VERTICAL SPACE
- LEVEL NET GROSS AREA

AREA

- 3,641 SF
- 368 SF
- 4,009 SF

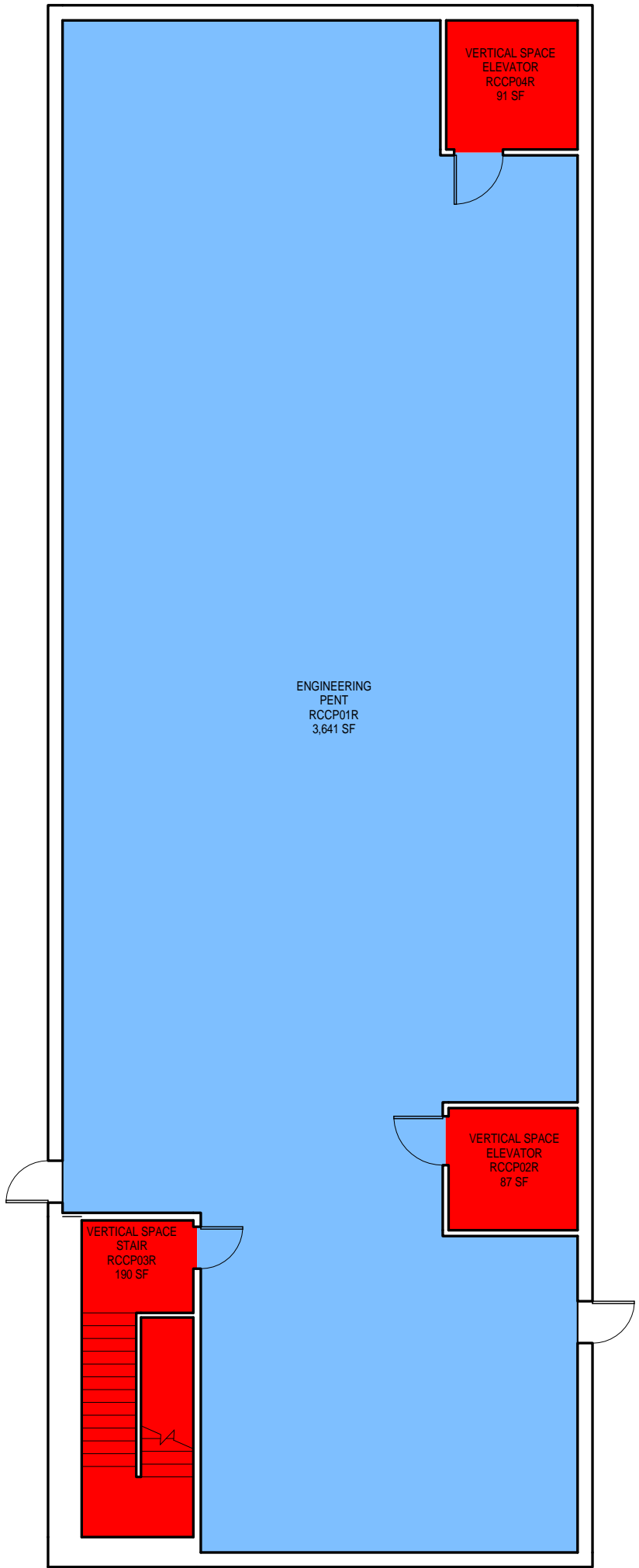

CONTRACTING FIRM:



**Romanyk Consulting**  
Focusing on what matters

CLIENT & PROJECT NAME:

EDWARD HINES, JR. VA HOSPITAL  
RFP: UPDATE HINES CAPITAL ASSETS INVENTORY RECORDS

DRAWING TITLE:

CAI DEPT. FLOOR PLAN - PENTHOUSE

APPROVED BY: ERIC J. KUTCHE

BLDG NUMBER: 113

PROJECT NUMBER: 578-14-012

DRAWING SCALE: 3/32" = 1'-0" | ISSUE DATE: 01/20/2016



**U.S. Department of Veterans Affairs**

1/17/2016 6:57:35 PM

**CAI DEPARTMENT**

 BEDS BLIND REHAB

 COMMON SPACE

 VERTICAL SPACE

LEVEL NET GROSS AREA

**AREA**

18,214 SF



7,267 SF

582 SF

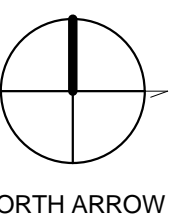
26,063 SF





 BEDS BLIND REHAB  
 COMMON SPACE  
 VERTICAL SPACE  
 LEVEL NET GROSS AREA

19,779 SF  
5,876 SF  
540 SF  
26,194 SF



NORTH ARROW



**Romanyk Consulting**  
Focusing on what matters

EDWARD HINES, JR. VA HOSPITAL  
RFP: UPDATE HINES CAPITAL ASSETS INVENTORY RECORDS  
CAI DEPT. FLOOR PLAN - LEVEL 02

DRAWING SCALE:  $3/32" = 1'-0"$



**U.S. Department of  
Veterans Affairs**