

three inches = one foot  
one and one half inches = one foot  
one inch = one foot  
three quarters inch = one foot  
one half inch = one foot  
three eighths inch = one foot  
one quarter inch = one foot  
one eighth inch = one foot

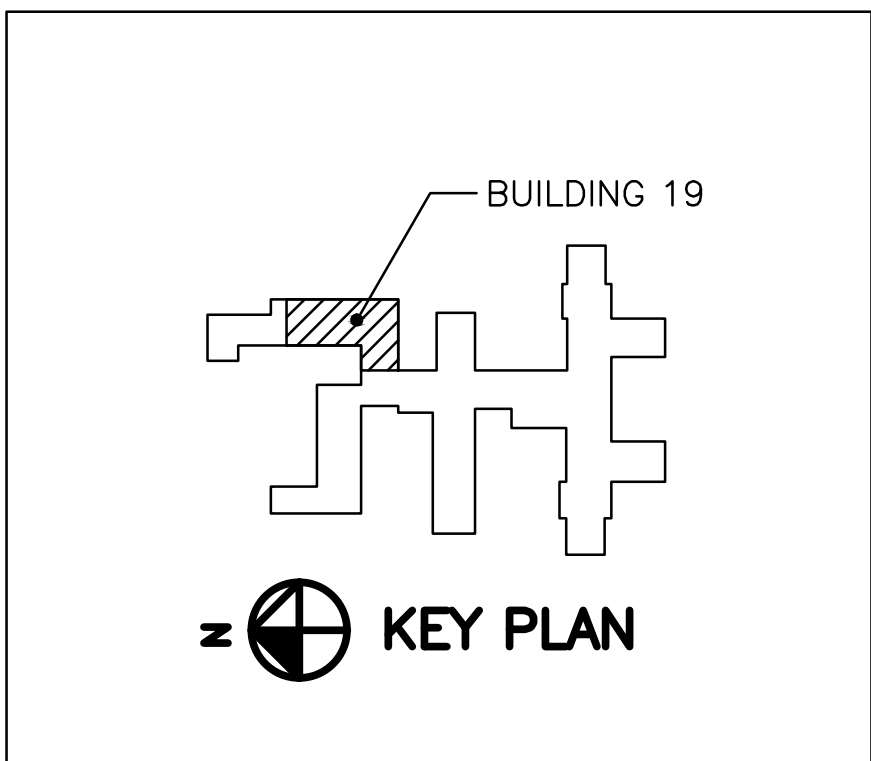

- SYMBOL LEGEND**
- PANELBOARD
  - DRY TYPE TRANSFORMER
  - BRANCH CIRCUIT CONDUCTORS, 3°C MINIMUM UNLESS NOTED OTHERWISE, #12 AWG MINIMUM UNLESS NOTED OTHERWISE.
  - PHASE CONDUCTOR(S)
  - NEUTRAL CONDUCTOR(S)
  - GROUND CONDUCTOR
  - ARROWHEAD DENOTES HOMERUN TO EQUIPMENT AS DESIGNATED.
  - P.S. = PARTIAL CIRCUIT
  - WALL BOX TOGGLE SWITCH, 48" AFF TO CENTER OF BOX.  
BLANK = SINGLE-POLE  
3 = THREE-WAY
  - WALLBOX DIMMER, COMPATIBLE WITH CONNECTED FIXTURES. PROVIDE CONTROL WIRING TO FIXTURES AS REQUIRED.
  - FLOURESCENT TROFFER, 2x4, PRISMATIC LENS, TWO (2) T8 LAMPS.
  - FLOURESCENT TROFFER, 2x4, PRISMATIC LENS, THREE (3) T8 LAMPS.
  - WALL BRACKET FLOURESCENT FIXTURE, PRISMATIC LENSE, ONE (1) T8 LAMP.
  - FLOURESCENT TROFFER
  - OPEN DOWNLIGHT, 28W FLOURESCENT LAMP, CLEAR ALZAK SELF-RIM REFLECTOR, 277V DIMMING BALLAST.
  - EXIT SIGN, 277V, RED LED LETTERING



<b>Revisions:</b> <table><tr><td> </td><td> </td></tr><tr><td> </td><td> </td></tr><tr><td> </td><td> </td></tr><tr><td> </td><td> </td></tr></table>									<b>CONSULTANTS:</b> <table><tr><td> </td><td> </td></tr><tr><td> </td><td> </td></tr><tr><td> </td><td> </td></tr><tr><td> </td><td> </td></tr></table>									<b>ARCHITECT/ENGINEERS:</b> <table><tr><td> </td><td> </td></tr><tr><td> </td><td> </td></tr><tr><td> </td><td> </td></tr><tr><td> </td><td> </td></tr></table>									<b>Drawing Title</b> FIRST FLOOR LIGHTING PLAN	<b>Project Title</b> BUILDING 19	<b>Project Number</b> 	<b>Office of OKC VAMC ENGINEERING PROJECTS</b>  Department of Veterans Affairs
<b>Approved Medical Center Director</b> 	<b>Approved Chief, Engineers</b> 	<b>Location</b> VA MEDICAL CENTER OKLAHOMA CITY, OKLAHOMA	<b>Building Number</b> Bldg. 1	<b>Building Number</b> Bldg. 1																										
<b>Approved Chief, Projects</b> 	<b>Date</b> MAY 2012	<b>Checked</b> 	<b>Drawing Number</b> Dwg. 10 of 16	<b>Drawing Number</b> Dwg. 10 of 16																										
		<b>Drawn</b> 																												