

BAR BENDING AND PLACING										
MARK	B	H	REINFORCING STEEL						MARK	REMARKS
			BOTTOM	TOP		LOC.	STIRRUPS			
				"A"	"B"	⌄	SIZE	SPACING		
8-5B01	40	60	8#11 c 8#11 d	9#11 c 9#11 d		08J	#4D	1@3", CONT. @12" E.E.	8-5B01	a
8-5B02	40	60				08J.3	#4D	1@3", CONT. @12" E.E.	8-5B02	a
8-5B03	40	60	8#11 c 8#11 d	8#9 c 8#9 d		08H	#4D	1@3", CONT. @12" E.E.	8-5B03	a
8-5B04	40	60				08G	#4D	1@3", CONT. @12" E.E.	8-5B04	a
8-5B05	40	60	8#11 c 8#11 d	8#9 c 8#9 d		08F	#4D	1@3", CONT. @12" E.E.	8-5B05	a
8-5B06	40	60				08E	#4D	1@3", CONT. @12" E.E.	8-5B06	a
8-5B07	40	60	8#11 c 8#11 d	8#9 c 8#9 d		08D	#4D	1@3", CONT. @12" E.E.	8-5B07	a
8-5B08	40	60				08C	#4D	1@3", CONT. @12" E.E.	8-5B08	a
8-5B09	40	60	8#11 c 8#11 d	8#9 c 8#9 d		08B	#4D	1@3", CONT. @12" E.E.	8-5B09	a
8-5B10	40	60				08A	#4D	1@3", CONT. @12" E.E.	8-5B10	a
8-5B11	40	60	8#11 c 8#11 d	9#11 c 9#11 d		08J	#4D	1@3", CONT. @12" E.E.	8-5B11	a
8-5B12	40	60				08J.3	#4D	1@3", CONT. @12" E.E.	8-5B11	a
8-5B13	40	60	8#11 c 8#11 d	8#9 c 8#9 d		08H	#4D	1@3", CONT. @12" E.E.	8-5B12	a
8-5B14	40	60				08G	#4D	1@3", CONT. @12" E.E.	8-5B13	a
8-5B15	40	60	8#11 c 8#11 d	8#9 c 8#9 d		08F	#4D	1@3", CONT. @12" E.E.	8-5B14	a
8-5B16	40	25				08E.5	#4D	1@3", CONT. @12" E.E.	8-5B15	a
8-5B17	36	60	8#10 d 6#10 c	6#7		08E	#4D	1@3", CONT. @12" E.E.	8-5B16	a
8-5B18	36	60				08D	#4D	1@3", CONT. @21" E.E.	8-5B17	a,b
8-5B19	36	60	8#10 d 6#10 c	8#10 c 4#10 d		08.7	#4D	1@3", CONT. @21" E.E.	8-5B18	a,b
8-5B20	36	60				08.4	#4D	1@3", CONT. @21" E.E.	8-5B19	a,b
8-5B21	36	60	8#10 d 6#10 c	8#10 c 4#10 d		08.3	#4D	1@3", CONT. @21" E.E.	8-5B20	a,b
8-5B22	36	25				08.2	#4D	1@3", CONT. @21" E.E.	8-5B21	a,b
8-5B23	36	25	8#10	5#9		08.1.5	#4D	1@3", CONT. @21" E.E.	8-5B22	a,b
8-5B24	36	25				08.1	#4D	1@3", CONT. @9" E.E.	8-5B23	a,b
8-5B25	30	25	5#8	6#11		08.7	#4D	1@3", CONT. @9" E.E.	8-5B24	a,b
8-5B26	36	25				08.3	#4D	1@3", CONT. @9" E.E.	8-5B25	a,b
8-5B27	36	25	6#9	5#11		08.3	#4D	1@3", CONT. @9" E.E.	8-5B26	a,b
8-5B28	36	25				5#9	#4D	1@3", CONT. @9" E.E.	8-5B27	a,b
8-5B29	36	25	8#10	5#9		08.1	#4D	1@3", CONT. @9" E.E.	8-5B28	a,b
8-5B30	36	25				6#11	#4D	1@3", CONT. @9" E.E.	8-5B29	a,b
8-5B31	30	25	5#8	5#10		08.2	#4D	1@3", CONT. @9" E.E.	8-5B30	a,b
8-5B32	36	25				5#9	#4D	1@3", CONT. @9" E.E.	8-5B31	a,b
8-5B33	36	25	6#9	7#11		08.3	#4D	1@3", CONT. @9" E.E.	8-5B32	a,b
8-5B34	36	25				5#11	#4D	1@3", CONT. @9" E.E.	8-5B33	a,b
8-5B35	36	25	8#11	5#9		08.2	#4D	1@3", CONT. @9" E.E.	8-5B34	a,b
8-5B36	36	25				5#9	#4D	1@3", CONT. @9" E.E.	8-5B35	a,b
8-5B37	36	25	6#9	5#11		08.3	#4D	1@3", CONT. @9" E.E.	8-5B36	a,b
8-5B38	36	25				5#9	#4D	1@3", CONT. @9" E.E.	8-5B37	a,b
8-5B39	36	25	5#8	4#9		08.2	#4D	1@3", CONT. @9" E.E.	8-5B38	a,b
8-5B40	36	25				6#9	#4D	1@3", CONT. @9" E.E.	8-5B39	a,b
8-5B41	36	25	4#9	5#7		08.1	#4D	1@3", CONT. @9" E.E.	8-5B40	a,b
8-5B42	36	25				5#9	#4D	1@3", CONT. @9" E.E.	8-5B41	a,b
8-5B43	30	25	5#8	5#7		08.7	#4D	1@3", CONT. @9" E.E.	8-5B42	a,b
8-5B44	36	25				5#7	#4D	1@3", CONT. @9" E.E.	8-5B43	a,b
						08.2.5	#4D	1@3", CONT. @9" E.E.	8-5B44	a,b
						08.2	#4D	1@3", CONT. @9" E.E.		

BAR BENDING AND PLACING										
MARK	B	H	REINFORCING STEEL						MARK	REMARKS
			BOTTOM	TOP		LOC.	STIRRUPS			
				"A"	"B"	⌒	SIZE	SPACING		
8-5B45	36	48	8#10 d 4#10 c	6#10 c 4#10 d		08 2.5	#4D	1@3", CONT. @ 21" E.E.	8-5B45	a,b
8-5B46	36	48				08 2	#4D	1@3", CONT. @ 21" E.E.	8-5B46	a,b
8-5B47	30	25	5#5	5#5		08 1	#3S	1@3", CONT. @ 21" E.E.	8-5B47	a
8-5B48	30	25	5#5	5#5			#3S	1@3", CONT. @ 21" E.E.	8-5B48	a
8-5B49	15	25	3#6	3#7		08 B	#3D	1@3", CONT. @ 9" E.E.	8-5B49	a
8-5B50	36	25	5#8	3#7			#3D	1@3", CONT. @ 24" E.E.	8-5B50	a
8-5B51	15	25	3#6	7#7			#3D	1@3", CONT. @ 9" E.E.	8-5B51	a,b
8-5B52	36	25	5#9	7#6			#3D	1@3", CONT. @ 9" E.E.	8-5B52	a
8-5B53	36	25	5#9	3#7		08 J	#3D	1@3", CONT. @ 9" E.E.	8-5B53	a
8-5B54	36	25	5#9	3#7			#3D	1@3", CONT. @ 9" E.E.	8-5B54	a
8-5B55	36	25	5#9	5#7		08 H	#3D	1@3", CONT. @ 9" E.E.	8-5B55	a
8-5B56	36	25	5#9	5#11			#3D	1@3", CONT. @ 9" E.E.	8-5B56	a
8-5B57	36	25	5#9	6#11		08 F	#3D	1@3", CONT. @ 9" E.E.	8-5B57	a
8-5B58	36	25	5#9	5#11		08 E	#3D	1@3", CONT. @ 9" E.E.	8-5B58	a
8-5B59	36	25	5#5	5#11		08 D	#3D	1@3", CONT. @ 9" E.E.	8-5B59	a
8-5B60	36	25	5#9	5#11		08 C	#3D	1@3", CONT. @ 9" E.E.	8-5B60	a
8-5B61	30	25	5#9	5#10		08 B	#3D	1@3", CONT. @ 24" E.E.	8-5B61	a
8-5B62	36	25	5#9	5#7		08 A	#3D	1@3", CONT. @ 9" E.E.	8-5B62	a
8-5B63	36	25	5#9	5#11		08 J	#3D	1@3", CONT. @ 9" E.E.	8-5B63	a
8-5B64	36	25	5#9	5#11		08 H	#3D	1@3", CONT. @ 9" E.E.	8-5B64	a
8-5B65	36	25	5#9	5#10		08 G	#3D	1@3", CONT. @ 9" E.E.	8-5B65	a
8-5B66	36	25	5#5	6#11		08 F	#3D	1@3", CONT. @ 9" E.E.	8-5B66	a
8-5B67	20	25	3#8	5#10		08 E	#3D	1@3", CONT. @ 9" E.E.	8-5B67	a,b
8-5B68	20	25	4#8	5#11		08 D	#3D	1@3", CONT. @ 9" E.E.	8-5B68	a,b
				4#8		08 C	#3D	1@3", CONT. @ 24" E.E.		
				4#8		08 B	#3D	1@3", 11 @ 9" E.E.		
				3#8		08 A	#3D	1@3", 11 @ 9" E.E.		

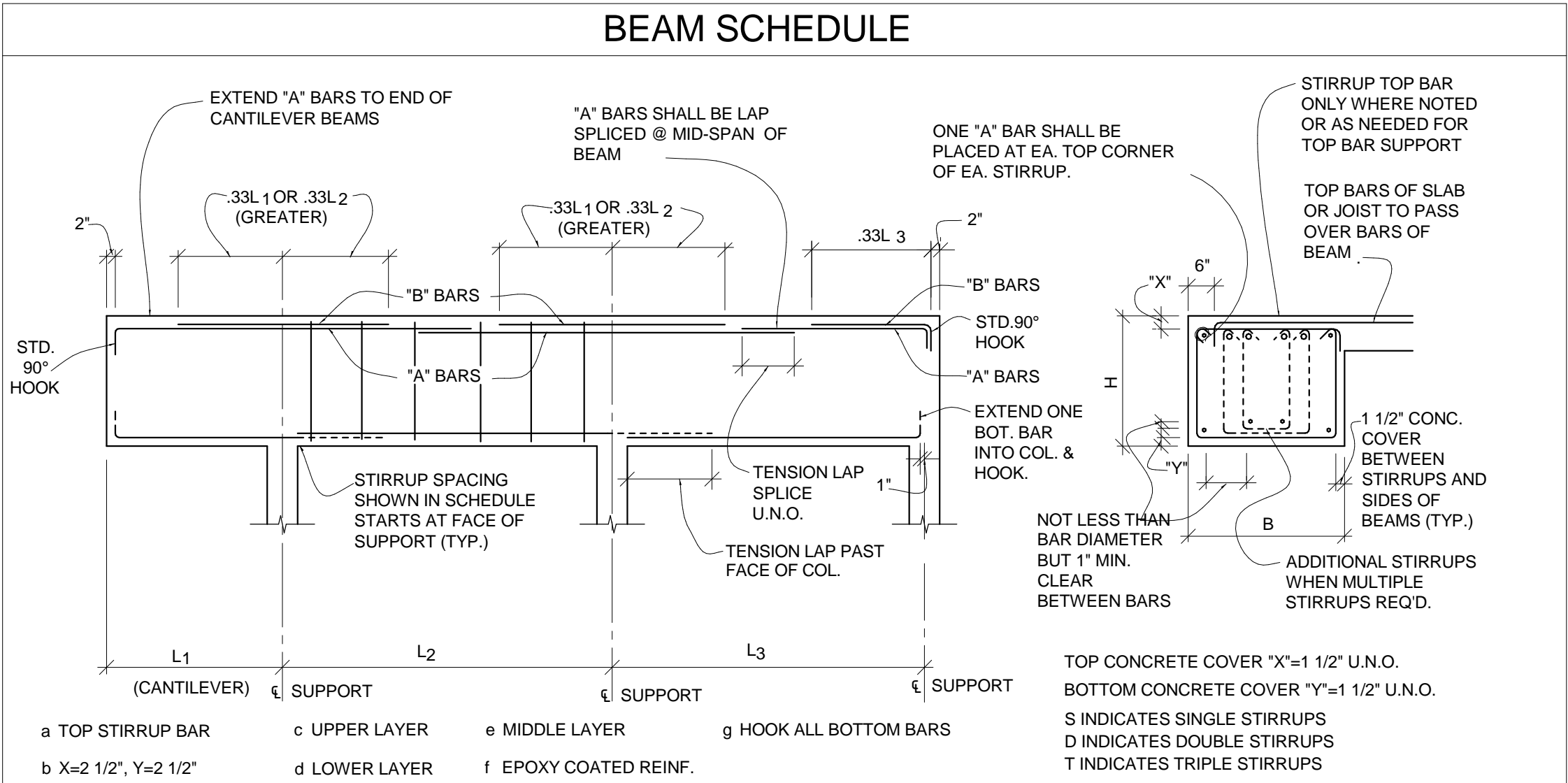

REVISIONS:	DATE	CONSULTANTS:
		DESMAN ASSOCIATES / PARKING
		CODE CONSULTANTS, INC. / CODE CONSULTANT
		THE SEXTANT GROUP / AV & ACOUSTICAL
		HAMMER DESIGN ASSOCIATES / FOOD SERVICE
		PYBURN & ODOM / ABATEMENT
		TATA & HOWARD / TANK CONSULTANT
		I.S.C. GROUP, INC. / IRRIGATION
		DAN EUSER WATER ARCHITECTURE, INC. / WATER FEATURE



ARCHITECT/ENGINEERS:
studio NOVA
SCHRENK & PETERSON CONSULTING ENGINEERS / CIVIL
KORDA/NEMETH ENGINEERING / STRUCTURAL
BR+A CONSULTING ENGINEERS / MECH, ELECT, PLUMBING, LOW VOLTAGE
ARCHITECTURAL ENGINEERING / PLUMBING
SCALES ASSOCIATES / FIRE PROTECTION
COMMUNICATIONS DESIGN GROUP / LOW VOLTAGE

DRAWING TITLE BEAM SCHEDULE	PROJECT TITLE SLVHCS REPLACEMENT MEDICAL CENTER PROJECT	PROJECT NUMBER 629-HS2-401	BUILDING NUMBER 8	OFFICE OF CONSTRUCTION AND FACILITIES MAINTENANCE
APPROVED: PROJECT DIRECTOR 	LOCATION NEW ORLEANS, LOUISIANA	DOCUMENT SET PACKAGE WP_09B	DRAWING NUMBER 8SF603	
	DATE July 16, 2012	CHECKED TMD	DRAWN RJC	