

one-eighth inch = one foot  
one-quarter inch = one foot  
three-eighths inch = one foot  
one-half inch = one foot  
three-quarters inch = one foot  
one inch = one foot  
one and one-half inches = one foot  
two inches = one foot  
three inches = one foot

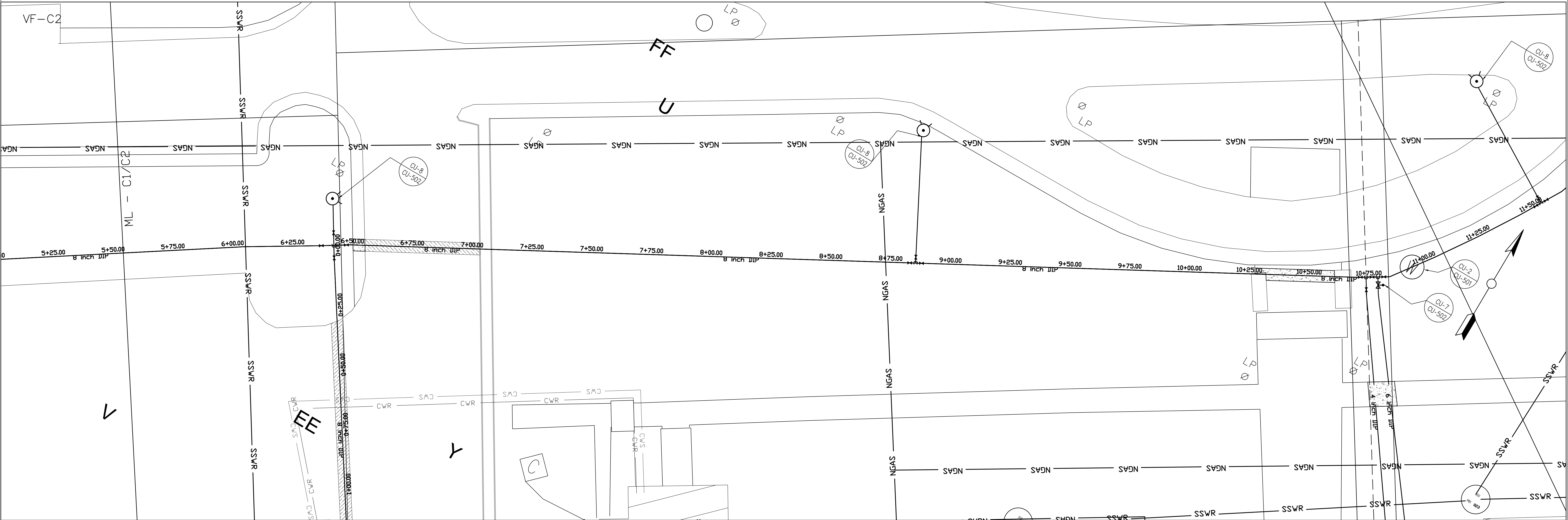
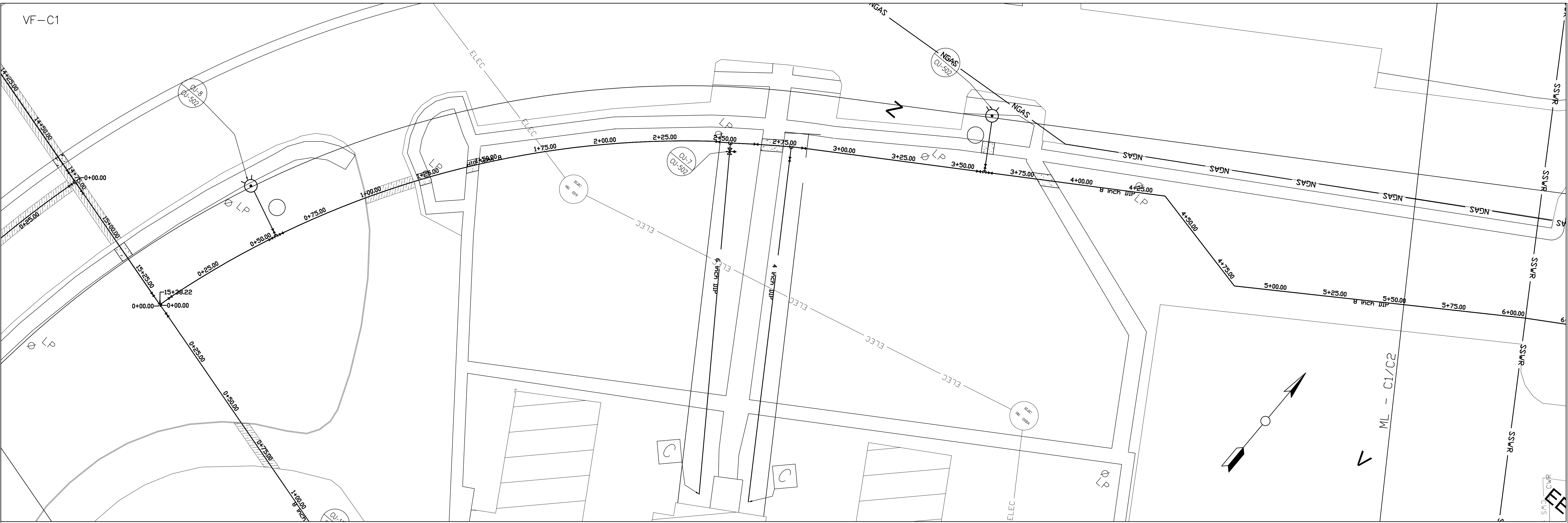

Revisions	Date					Approved: Safety Manager		Drawing Title	CU-106	Project Title	UPGRADE WATER DISTRIBUTION			Date	05-25-12	Veterans Affairs
						Approved: GEMS COORDINATOR		PIPELINE ALIGNMENT C				Project No.	658-12-104			
						Approved: Infection Control Officer	Approved: Chief of Staff	Approved: Chief of Facility Management Svc.	Building Number	Checked	Drawn	DRAWING NO.	2559			
						Approved: ENERGY ENGINEER	Approved: Associate Director	Approved: Medical Center Director	Location	VAMC SALEM, VA.				Sheet 9 of 25		