

one-eighth inch = one foot  
one-quarter inch = one foot  
three-eighths inch = one foot  
one-half inch = one foot  
three-quarters inch = one foot  
one inch = one foot  
one and one-half inches = one foot  
two inches = one foot  
three inches = one foot

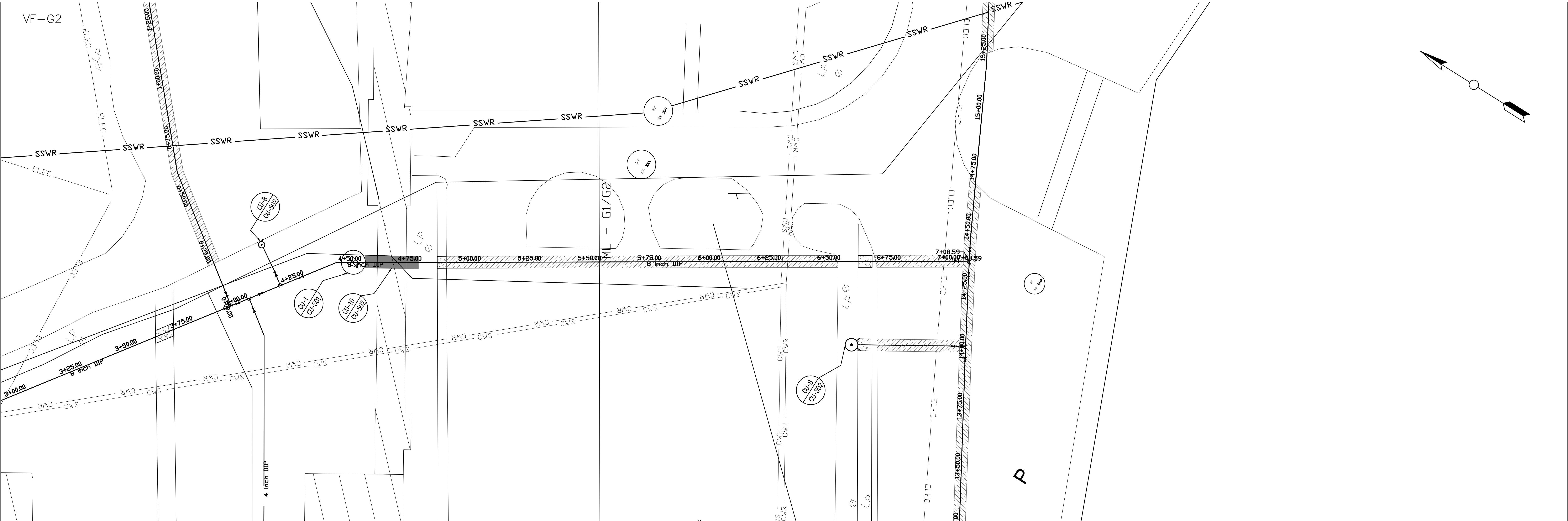
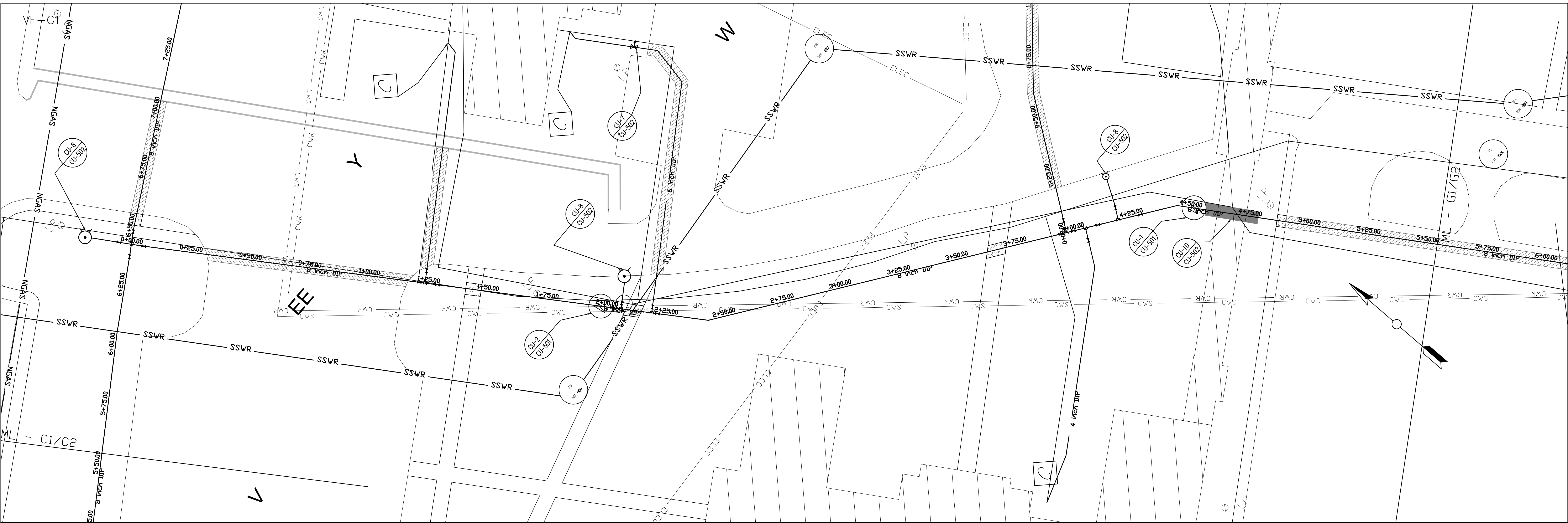

Revisions		Date	Approved: Safety Manager		Drawing Title	Project Title		Date	Veterans Affairs
			Approved: GEMS COORDINATOR		CU-112	UPGRADE WATER DISTRIBUTION		05-25-12	
			Approved: Infection Control Officer		PIPELINE ALIGNMENT G	Building Number		Project No.	
			Approved: ENERGY ENGINEER		Sta 0+00 to Sta 7+08.59	Checked		658-12-104	
			Approved: Associate Director			Drawn		DRAWING NO.	
			Approved: Chief of Staff			EBC		2559	
			Approved: Chief of Facility Management Svc.			Location		Sheet 15 Of 25	
			Approved: Medical Center Director			VAMC SALEM, VA.			