

- SHEET NOTES:
1. FOR GENERAL NOTES, SEE SHEET S-001.
2. THIRD TIER PLAN IS INDICATED TO REPRESENT THE TYPICAL TIER PLAN.
3. TYP. DIVIDER BEAM W10X19, SEE DETAIL F7/S-443 FOR CONNECTION DETAIL.
4. SEE ARCH. DWGS FOR DIMENSIONS AND OTHER INFORMATION NOT SHOWN.
5. SEE SHEET S-443 FOR BEAM SCHEDULE.

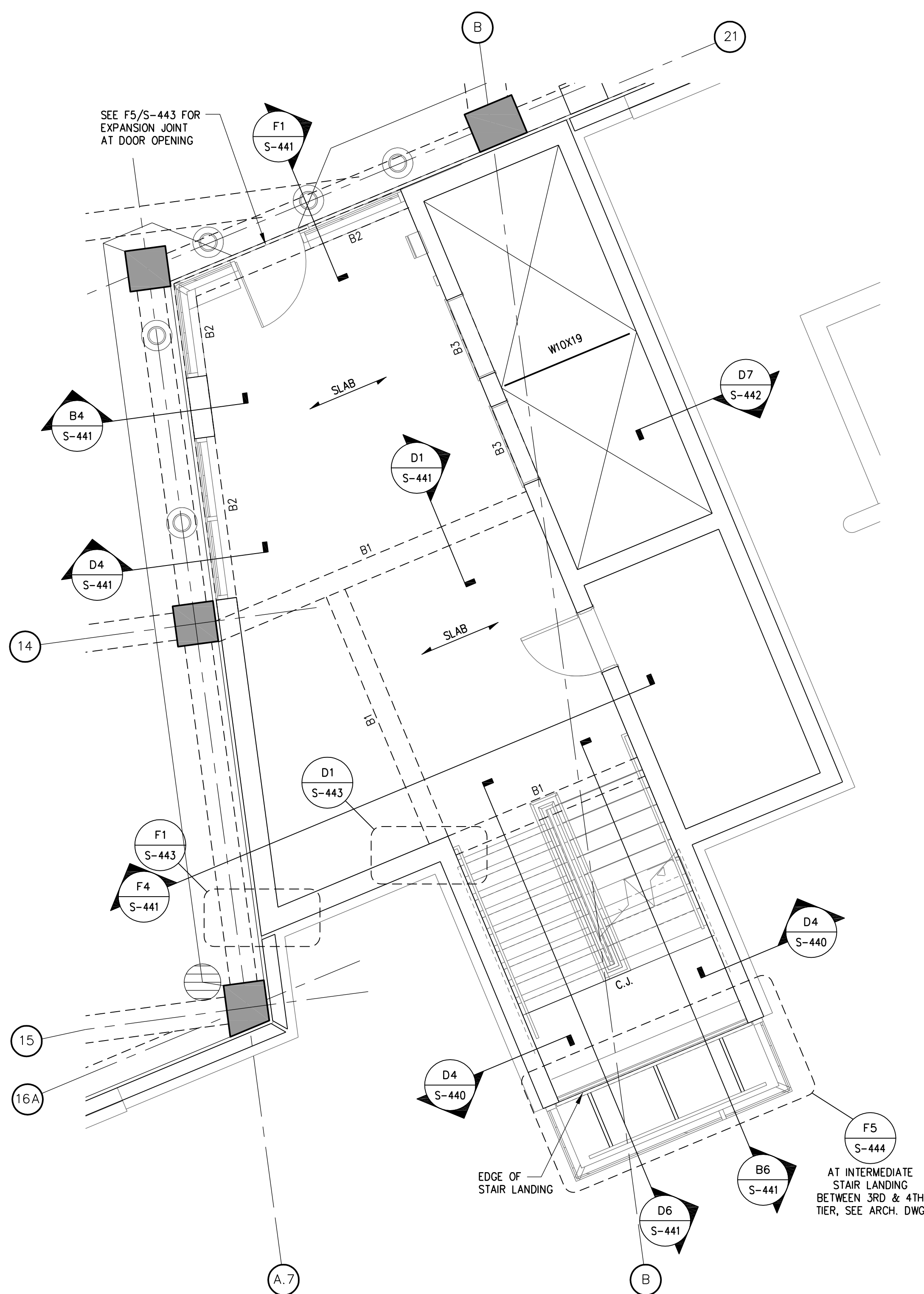

E1 SE STAIR/ELEV. THIRD TIER PLAN

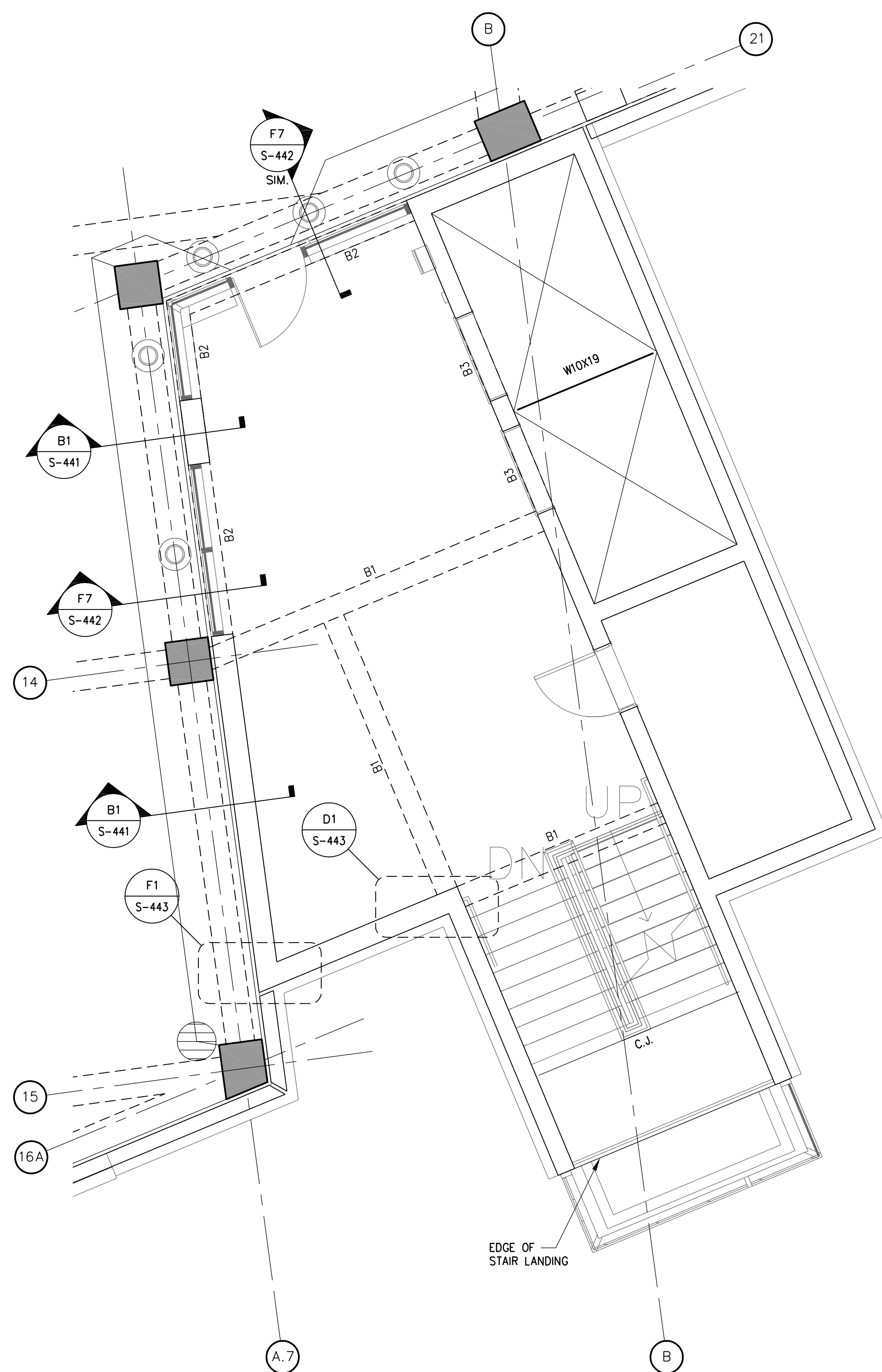

E4 SE STAIR/ELEV. FOURTH TIER PLAN

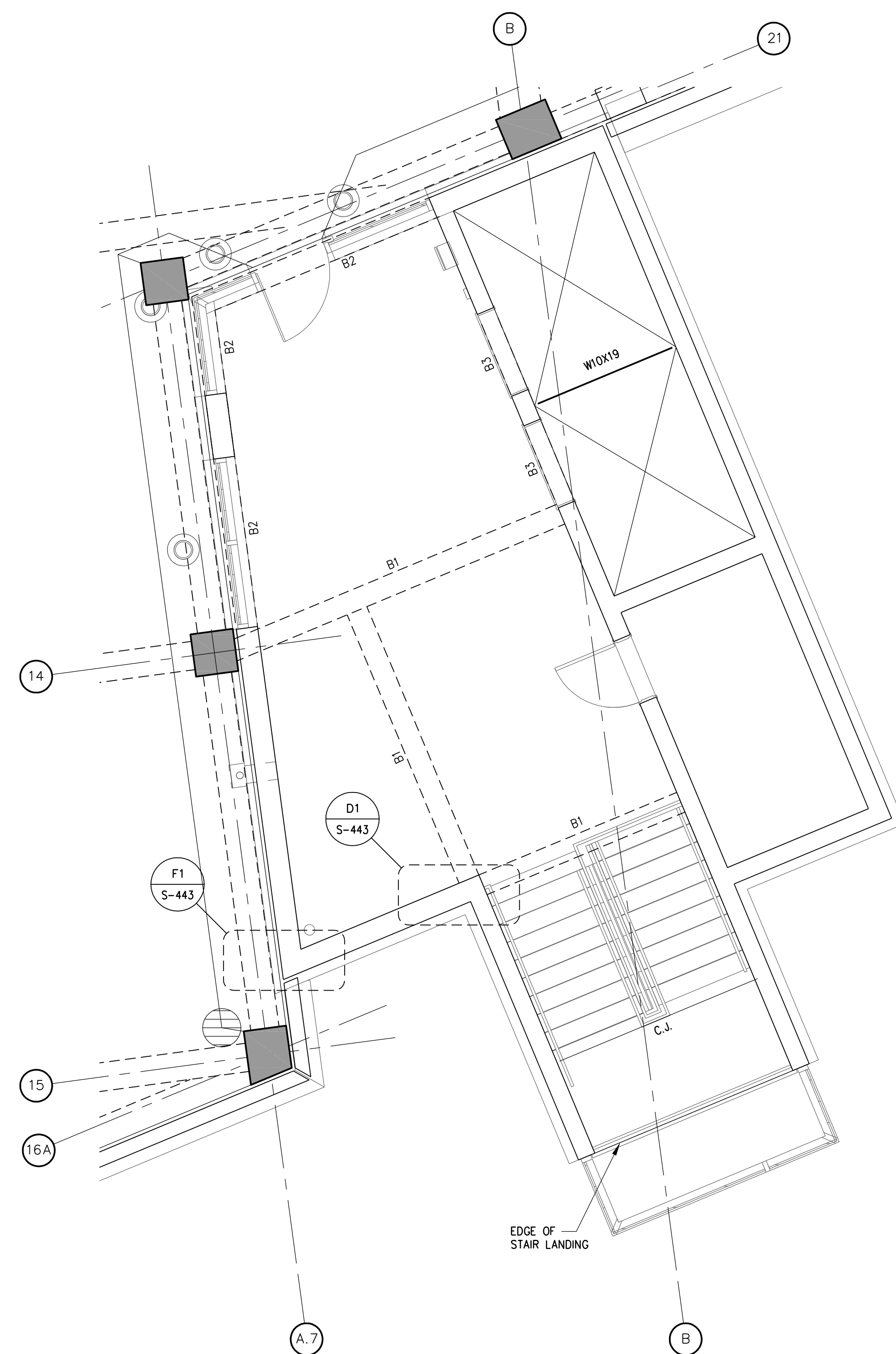

E7 SE STAIR/ELEV. TOP TIER PLAN

CONSULTANTS/ENGINEERS:

KJWW ENGINEERING CONSULTANTS
Mechanical/Electrical/Plumbing Engineer

623 26TH AVENUE
ROCK ISLAND, ILLINOIS 61201
309.788.0673 Telephone
309.786-5967 Fax

TERRACON
Geotechnical Engineer

2640 12TH STREET SW
CEDAR RAPIDS, IOWA 52404
319.366.8321 Telephone
319.366.0032 Fax

GRAF
Civil Engineer/Landscape Architect

332 SOUTH MICHIGAN, SUITE 1400
CHICAGO, ILLINOIS 60604-4367
312.582.2020 Telephone
312.939.7014 Fax

WALKER PARKING CONSULTANTS
Structural Engineer

305 DAVIS ROAD
ELGIN, ILLINOIS 60123
847.697.2640 Telephone
847.697.7439 Fax

FAITHFUL+GOULD
Cost Management

222 SOUTH RIVERSIDE PLAZA, SUITE 2240
CHICAGO, ILLINOIS 60606
312.612.6319 Telephone
312.655.9037 Fax

ARCHITECT:

Loebl Schlossman & Hackl
Architecture • Planning • Interiors

Copyright © 2012 Loebl Schlossman & Hackl Inc.

233 North Michigan Avenue
Suite 3000
Chicago, Illinois 60601

312.565.1800 Telephone
312.565.5912 Facsimile
www.lshdesign.com

Drawing Title

SE STAIR/ELEVATOR PLANS

Approved: Project Director

Iowa City VA Healthcare System
Department of Veterans Affairs Medical Center

Project Title

400 CAR PARKING GARAGE

Location

IOWA CITY, IA

Date

06/10/2011

Checked

BFN

Drawn

MJK

Project Number

636-402

Building Number

43

Drawing Number

S-411

Dwg. 96 of 152

Office of
Construction
and Facilities
Management

Department of
Veterans Affairs