

three inches = one foot
one and one half inches = one foot
one inch = one foot
three quarters inch = one foot
one half inch = one foot
three eighths inch = one foot
one quarter inch = one foot
one eighth inch = one foot
one eighth inch = one foot

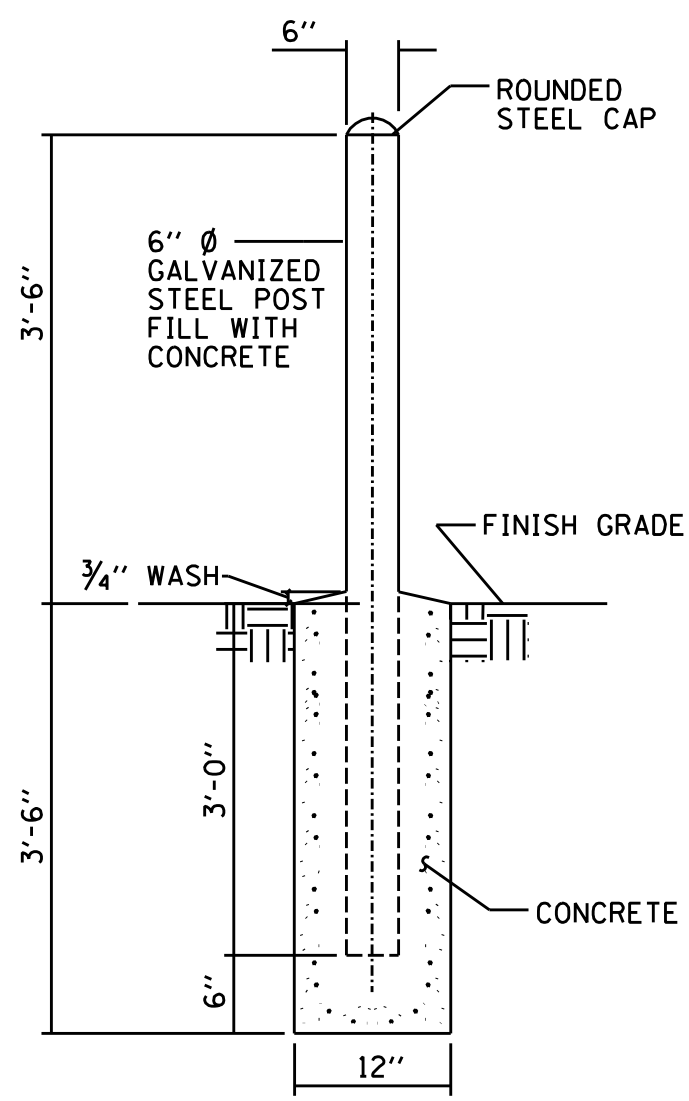

① PIPE BOLLARD
N.T.S.
SEE SHEET 43-L7 FOR LOCATIONS

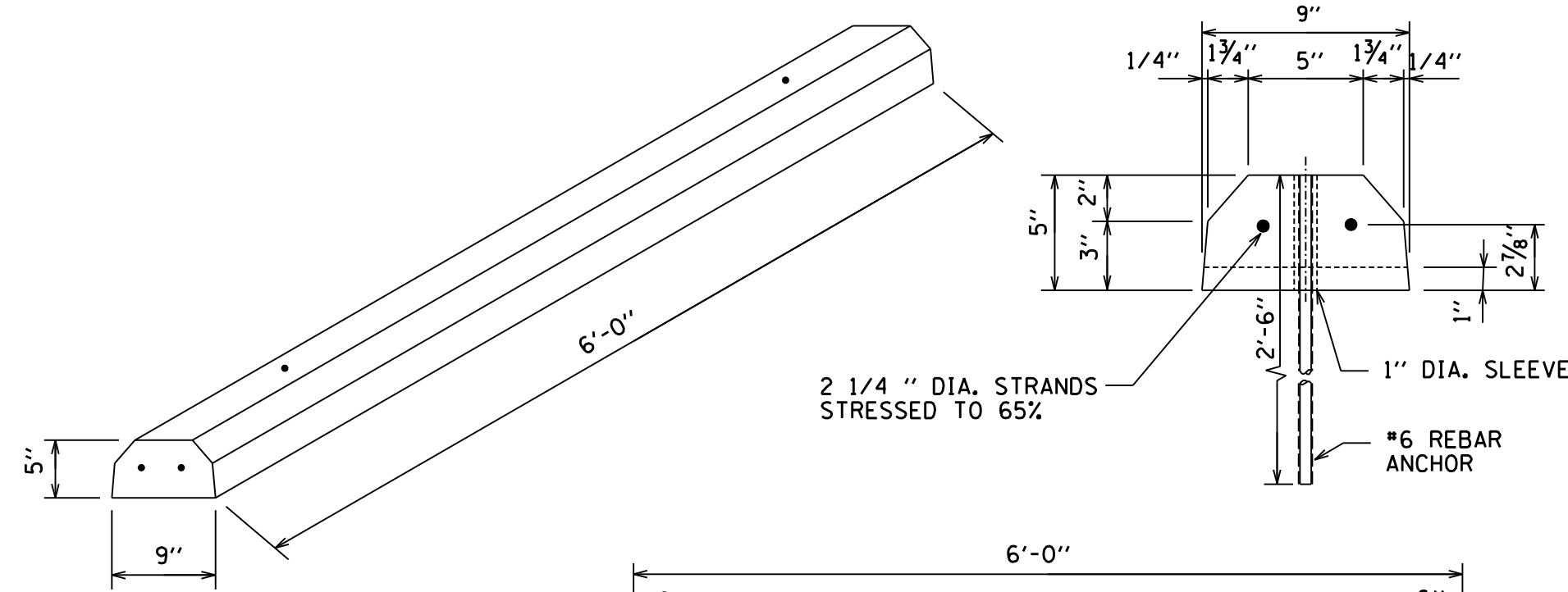

② CONCRETE PARKING BUMPER
N.T.S.

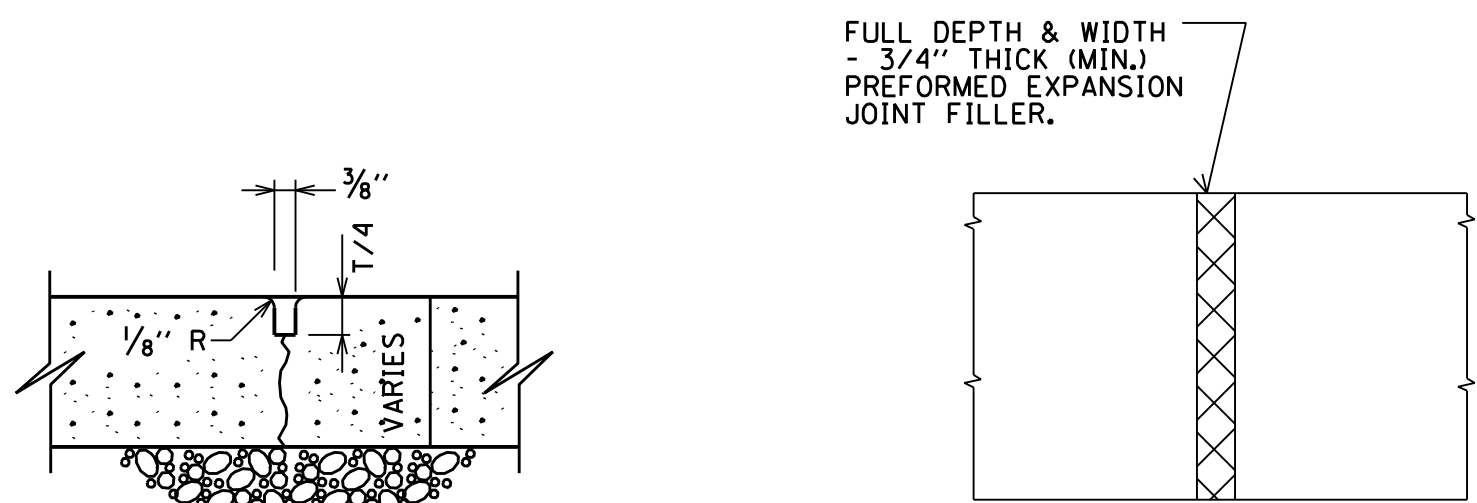

③ TOOLED CONTRACTION JOINT
N.T.S.

⑦ EXPANSION JOINT
N.T.S.

NOTES:
THESE DETAILS APPLY TO SIDEWALK ONLY. PLACE TOOLED CONTRACTION JOINTS AT MAXIMUM 8' INTERVALS, OR AS INDICATED. PLACE EXPANSION JOINTS AT MAXIMUM 60' INTERVALS, AND BETWEEN PAVING COMPONENTS, STRUCTURES, AND FOUNDATIONS.

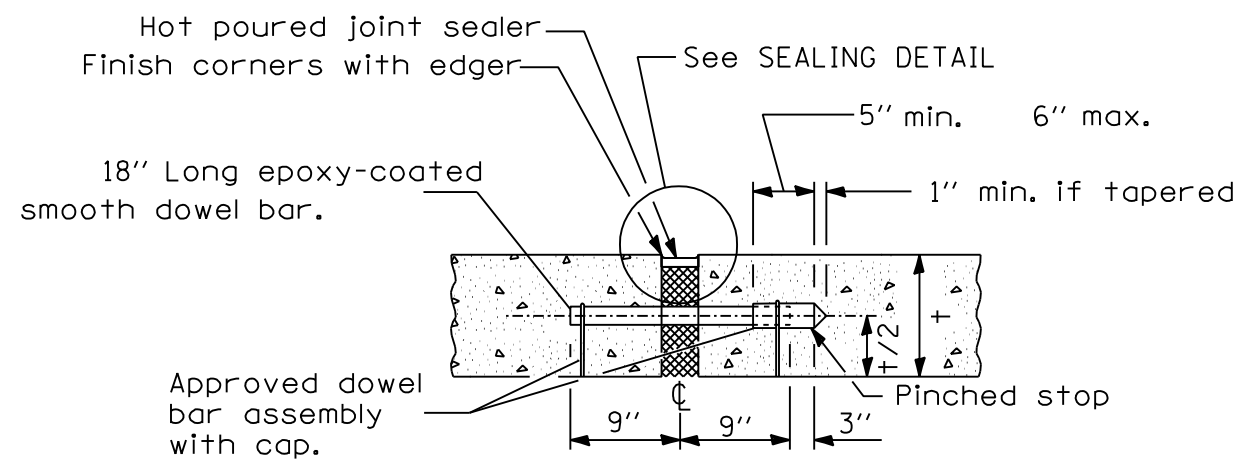

⑧ EXPANSION JOINT
N.T.S.

FOR USE AT 8" CONCRETE PAVEMENT

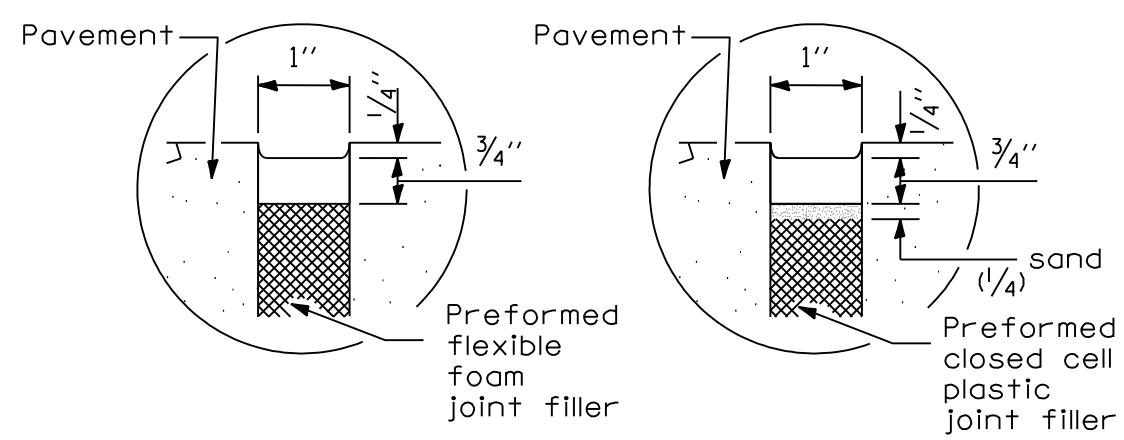

⑨ EXPANSION JOINT SEALING DETAIL
N.T.S.
FOR USE AT 8" CONCRETE PAVEMENT

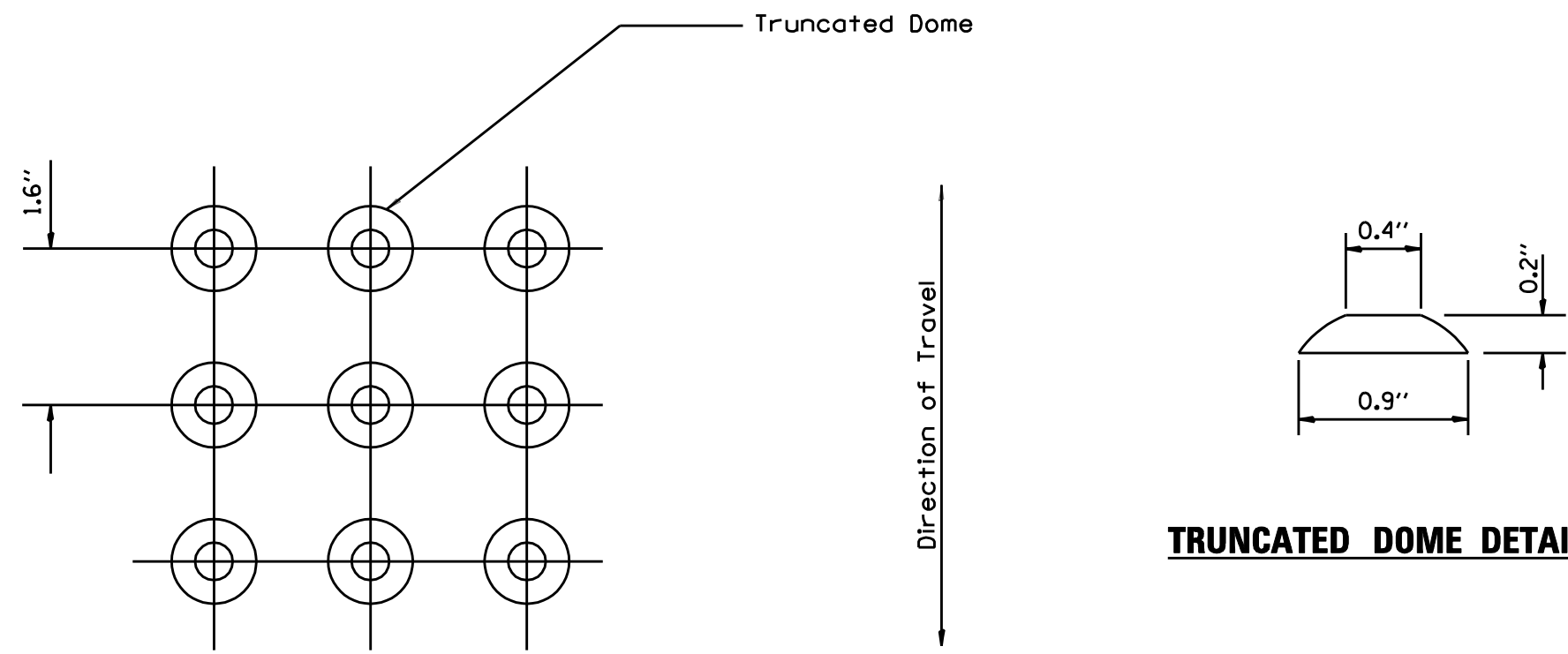

SQUARE PATTERN
(Parallel Alignment)

⑩ DETECTABLE WARNING DETAILS
N.T.S.

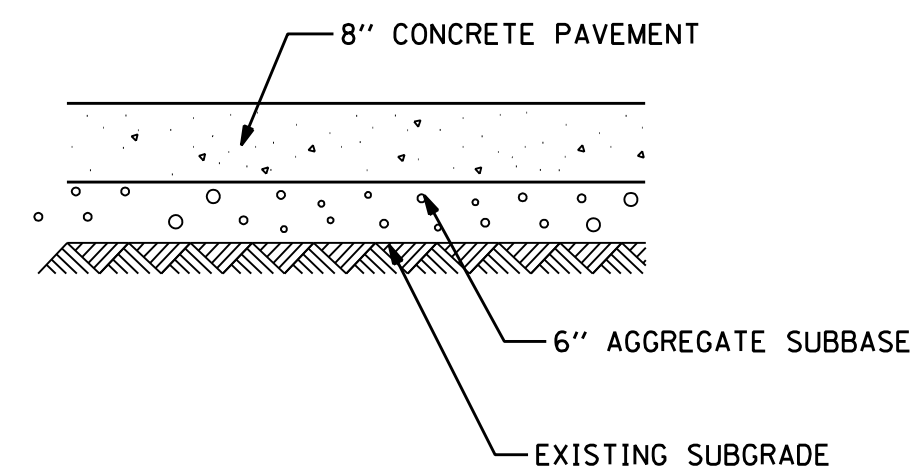

③ CONCRETE PAVEMENT SECTION
N.T.S.

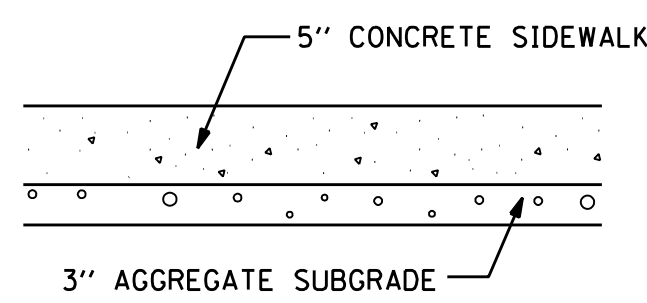

④ CONCRETE PAVEMENT SECTION
N.T.S.

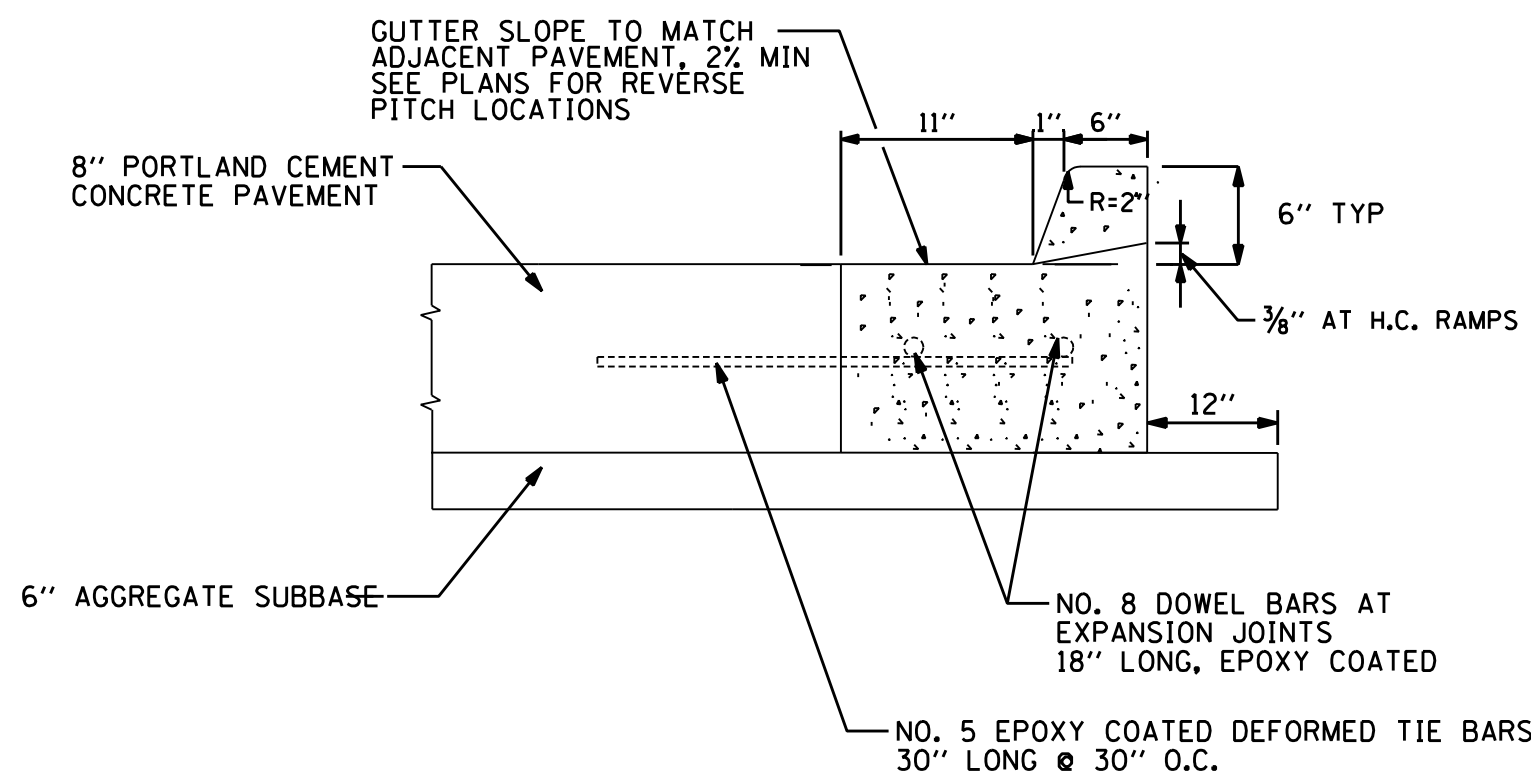

⑤ CURB AND GUTTER ADJACENT TO CONCRETE PAVEMENT
N.T.S.

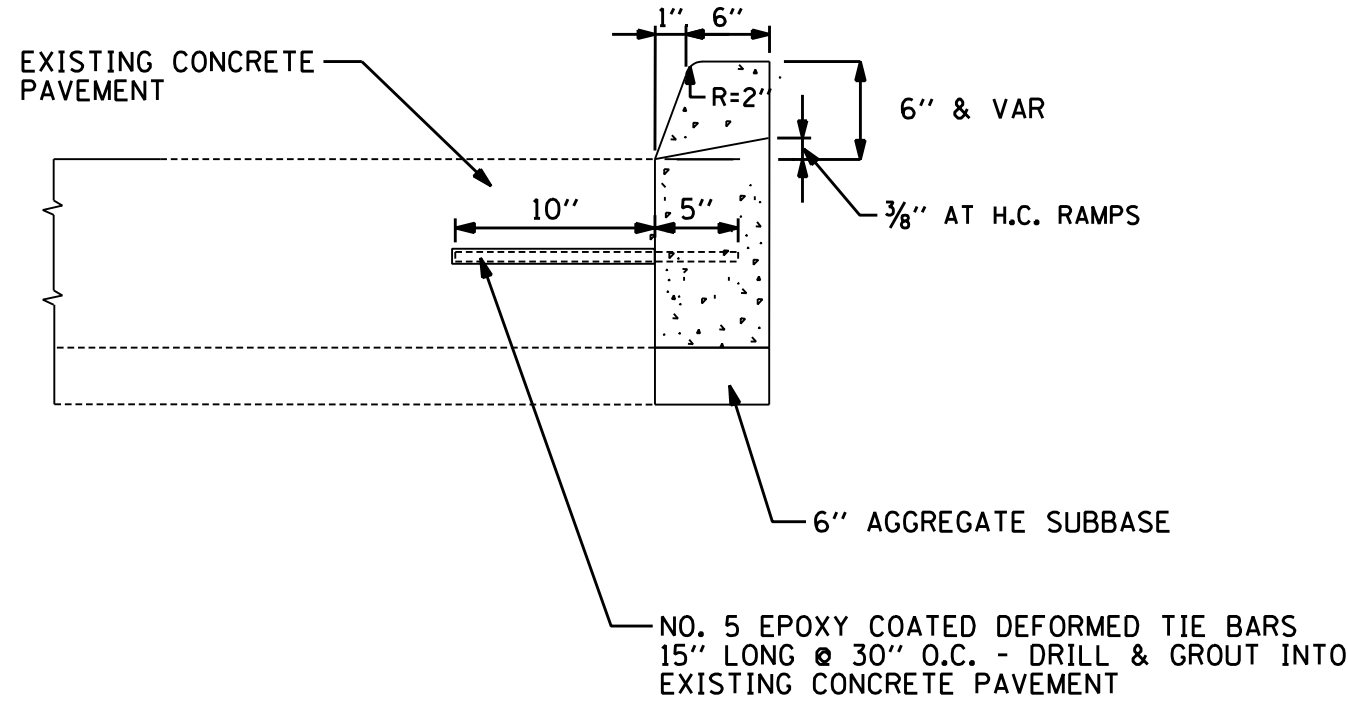

⑤A CURB ADJACENT TO CONCRETE PAVEMENT
N.T.S.

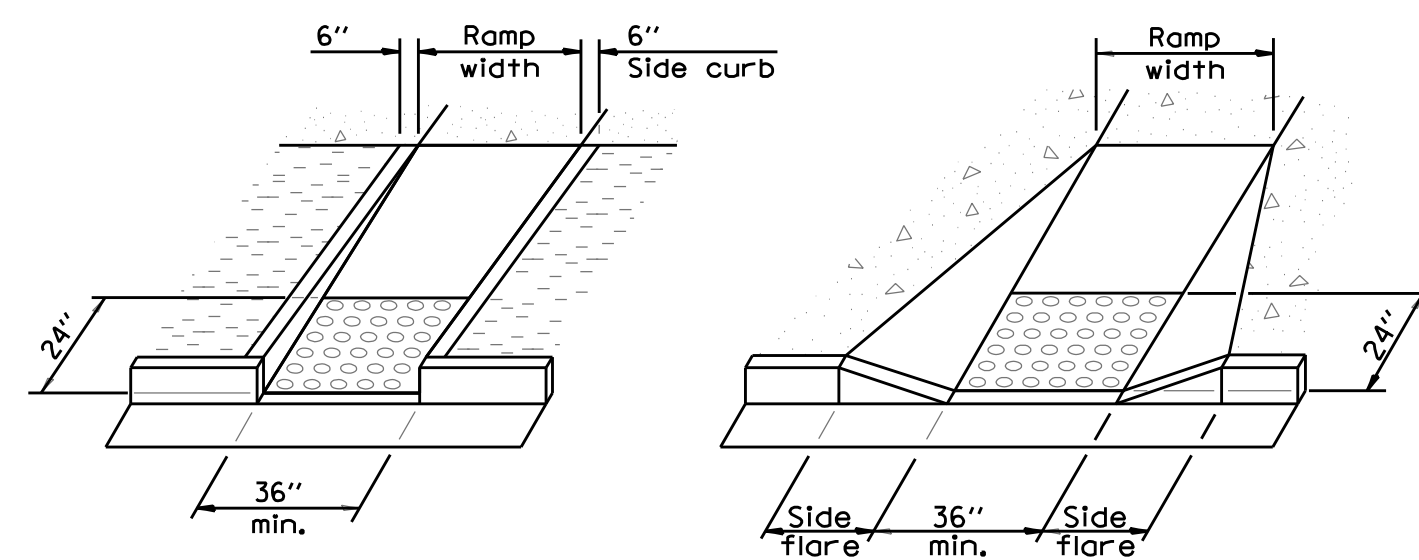

TYPE A

TYPE B

DETAILS OF RAMPS

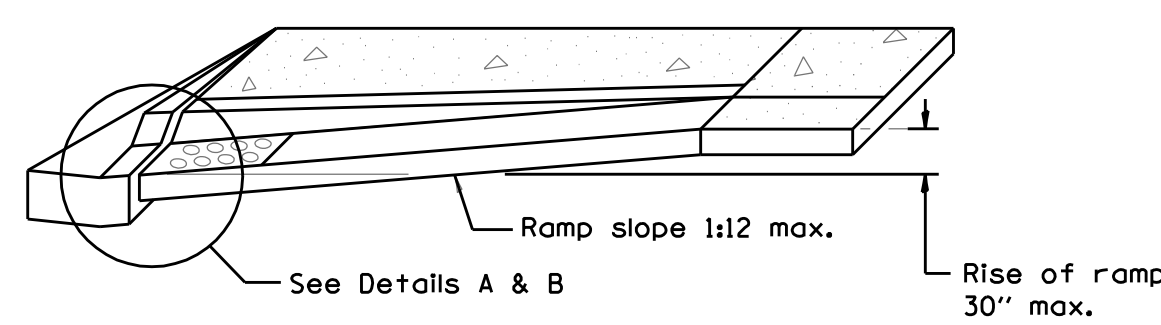

RAMP PROFILE

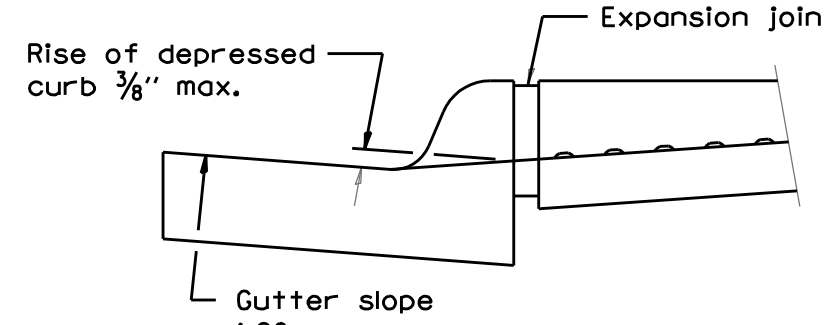

DETAIL A

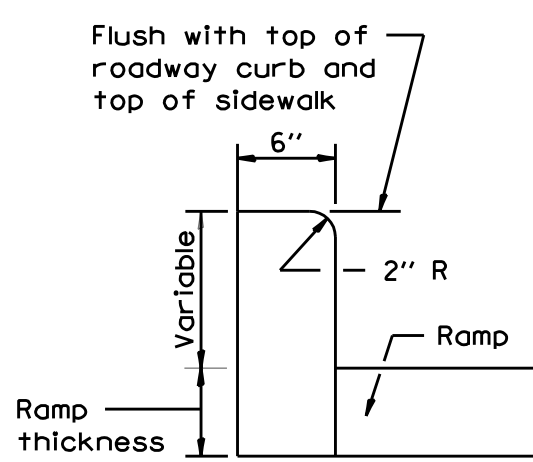

DETAIL OF SIDE CURB
(Side curb may be constructed monolithically with ramp)

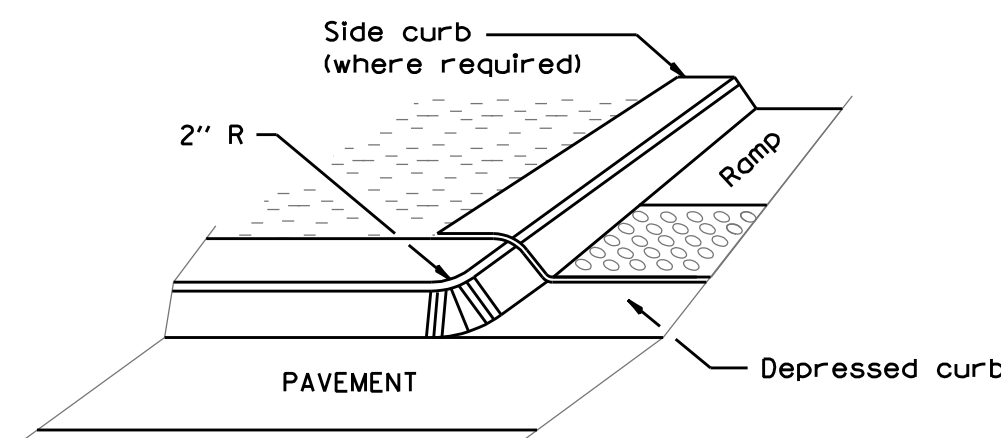

DETAIL B

LEGEND

- Sidewalk
- Ramp
- Detectable Warnings
- Non walking area

⑪ H.C. RAMP DETAILS
N.T.S.

FINAL CONSTRUCTION DOCUMENTS	06/10/11
100% REVIEW SUBMISSION (NOT FOR CONSTRUCTION)	04/11/11
75% REVIEW SUBMISSION (NOT FOR CONSTRUCTION) - COST ESTIMATE	02/03/11
75% REVIEW SUBMISSION (NOT FOR CONSTRUCTION) - COST ESTIMATE	01/19/11
35% REVIEW SUBMISSION (NOT FOR CONSTRUCTION)	11/22/10
Revisions:	Date

CONSULTANTS/ENGINEERS:

KJWW ENGINEERING CONSULTANTS
Mechanical/Electrical/Plumbing Engineer
623 26TH AVENUE
ROCK ISLAND, ILLINOIS 61201
309.786.0673 Telephone
309.786.5967 Fax

TERRACON
Geotechnical Engineer
2640 12TH STREET SW
CEDAR RAPIDS, IOWA 52404
319.366.8321 Telephone
319.366.0032 Fax

GRAEF
Civil Engineer/Landscape Architect
332 SOUTH MICHIGAN, SUITE 1400
CHICAGO, ILLINOIS 60604-4367
312.582.2020 Telephone
312.939.7014 Fax

WALKER PARKING CONSULTANTS
Structural Engineer
306 DAVIS ROAD
ELGIN, ILLINOIS 60123
847.697.2640 Telephone
847.697.7439 Fax

FAITHFUL+GOULD
Cost Management
222 SOUTH RIVERSIDE PLAZA, SUITE 2240
CHICAGO, ILLINOIS 60606
312.612.6319 Telephone
312.655.9037 Fax

ARCHITECT:

Loebl Schlossman & Hackl
Architecture • Planning • Interiors

233 North Michigan Avenue
Suite 3000
Chicago, Illinois 60601

312.565.1800 Telephone
312.565.5912 Facsimile
www.lshdesign.com

Drawing Title

SITE DETAILS

Approved: Project Director

Iowa City VA Healthcare System
Department of Veterans Affairs Medical Center

Project Title

400 CAR PARKING GARAGE

Location

IOWA CITY, IA

Date

06/10/2011

Checked

MAY

Drawn

IN

Project Number

636-402

Building Number

43

Drawing Number

43-L13.1

Dwg. 20 of 152

Office of
Construction
and Facilities
Management

Department of
Veterans Affairs