

three inches = one foot
one and one half inches = one foot
one inch = one foot
three quarters inch = one foot
one half inch = one foot
three eighths inch = one foot
one quarter inch = one foot
one eighth inch = one foot

SEE SHEET 43-L6, MASTER SITE PLAN
FOR HORIZONTAL CONTROL POINTS

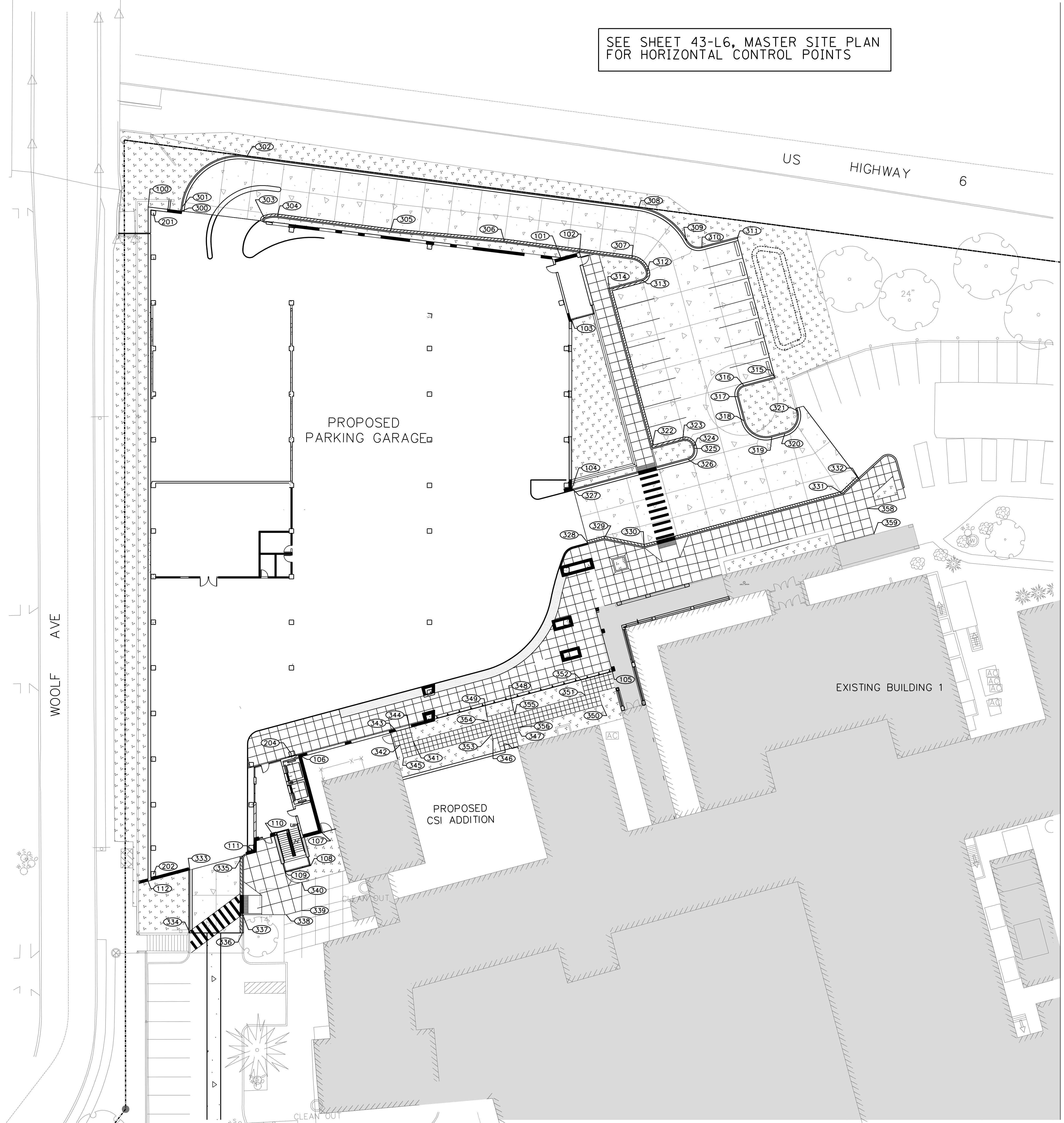

SITE COORDINATE TABLE				
POINT	NORTHING	EASTING	LABEL	DESCRIPTION
100	612455.55	2173284.37	BUILDING CORNER	
101	612465.35	2173465.20	BUILDING CORNER	
102	612435.53	2173473.41	BUILDING CORNER	
103	612405.97	2173469.97	BUILDING CORNER	
104	612331.74	2173469.96	BUILDING CORNER	
105	612251.89	2173487.79	BUILDING CORNER	
106	612214.63	2173351.62	BUILDING CORNER	
107	612181.27	2173360.55	BUILDING CORNER	
108	612166.83	2173355.62	BUILDING CORNER	
109	612163.81	2173344.35	BUILDING CORNER	
110	612179.77	2173339.50	BUILDING CORNER	
111	612172.74	2173331.83	BUILDING CORNER	
112	612160.02	2173284.35	BUILDING CORNER	
201	612452.94	2173286.67	C/L COLUMN	CL A1
202	612163.01	2173286.65	C/L COLUMN	CL A16
204	612215.81	2173347.15	C/L COLUMN	CL B21
300	612453.73	2173299.15	FACE OF CURB	
301	612455.66	2173299.39	FACE OF CURB	PC
302	612477.40	2173327.43	FACE OF CURB	PT
303	612450.69	2173335.24	FACE OF CURB	PC
304	612451.43	2173341.01	FACE OF CURB	PT
305	612444.96	2173390.59	FACE OF CURB	
306	612440.47	2173440.43	FACE OF CURB	
307	612433.17	2173496.35	FACE OF CURB	PC
308	612434.99	2173499.20	FACE OF CURB	PC
309	612440.55	2173520.20	FACE OF CURB	PCC
310	612437.61	2173527.03	FACE OF CURB	PT
311	612441.80	2173542.65	FACE OF CURB	
312	612427.31	2173503.05	FACE OF CURB	PCC
313	612423.39	2173500.69	FACE OF CURB	PT
314	612419.51	2173486.50	FACE OF CURB	
315	612380.94	2173558.95	FACE OF CURB	
316	612377.32	2173545.43	FACE OF CURB	PC
317	612374.42	2173542.60	FACE OF CURB	PC
318	612361.80	2173545.44	FACE OF CURB	PC
319	612354.73	2173557.69	FACE OF CURB	PT
320	612356.26	2173563.42	FACE OF CURB	PC
321	612366.14	2173569.05	FACE OF CURB	PT
322	612349.96	2173505.13	FACE OF CURB	
323	612353.59	2173518.66	FACE OF CURB	PC
324	612350.76	2173523.55	FACE OF CURB	PT
325	612349.79	2173523.81	FACE OF CURB	PC
326	612344.89	2173520.98	FACE OF CURB	PT
327	612331.46	2173470.85	FACE OF CURB	
328	612308.28	2173477.06	FACE OF CURB	
329	612310.19	2173484.21	FACE OF CURB	
330	612306.61	2173501.74	FACE OF CURB	
331	612329.90	2173588.67	FACE OF CURB	
332	612336.61	2173595.72	FACE OF CURB	
333	612164.93	2173302.68	FACE OF CURB	
334	612137.33	2173302.68	FACE OF CURB	
335	612171.09	2173325.68	FACE OF CURB	
336	612137.33	2173325.68	FACE OF CURB	
337	612145.83	2173325.68	FACE OF CURB	
338	612145.33	2173344.91	EDGE OF WALK	
339	612147.15	2173351.70	EDGE OF WALK	
340	612159.57	2173351.70	EDGE OF WALK	
341	612221.28	2173400.56	EDGE OF WALK	
342	612219.73	2173394.77	EDGE OF WALK	
343	612225.76	2173393.15	EDGE OF WALK	
344	612227.31	2173398.95	EDGE OF WALK	
345	612213.93	2173396.32	EDGE OF WALK	
346	612222.35	2173435.47	EDGE OF WALK	
347	612225.46	2173447.07	EDGE OF WALK	
348	612235.12	2173444.48	EDGE OF WALK	
349	612232.01	2173432.89	EDGE OF WALK	
350	612237.22	2173483.25	EDGE OF WALK	
351	612241.46	2173475.91	EDGE OF WALK	
352	612248.23	2173474.09	EDGE OF WALK	
353	612224.28	2173434.96	EDGE OF WALK	
354	612230.08	2173433.40	EDGE OF WALK	
355	612233.18	2173445.00	EDGE OF WALK	
356	612247.59	2173446.55	EDGE OF WALK	
358	612323.48	2173599.49	EDGE OF WALK	
359	612312.37	2173602.46	EDGE OF WALK	

SHEET NOTES:
1. ALL COORDINATES ARE TO FACE OF BUILDING, FACE OF CURB, OR PROPERTY LINE UNLESS OTHERWISE NOTED.
2. THIS SHEET IS PROVIDED FOR THE CONTRACTOR'S CONVENIENCE ONLY. CONTRACTOR SHALL VERIFY ALL COORDINATE LOCATIONS WITH SHEET 40, GEOMETRY LAYOUT AND WITH SHEET 43-L7, SITE LAYOUT.

- SHEET LEGEND
- PROPOSED CURB & GUTTER
 - PROPOSED REVERSE PITCH CURB & GUTTER
 - PROPOSED DEPRESSED CURB & GUTTER
 - PROPOSED SIDEWALK
 - PROPOSED CONCRETE PAVEMENT
 - EXISTING BUILDING
 - PROPOSED LANDSCAPE RESTORATION

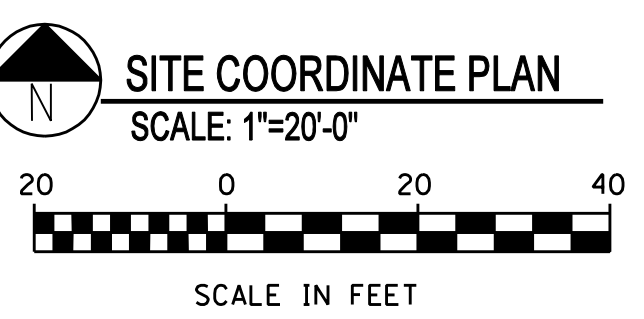

FINAL CONSTRUCTION DOCUMENTS 06/10/11

100% REVIEW SUBMISSION (NOT FOR CONSTRUCTION) 04/11/11

75% REVIEW SUBMISSION (NOT FOR CONSTRUCTION) - COST ESTIMATE 02/03/11

75% REVIEW SUBMISSION (NOT FOR CONSTRUCTION) - COST ESTIMATE 01/18/11

35% REVIEW SUBMISSION (NOT FOR CONSTRUCTION) 11/22/10

Revisions: _____

CONSULTANTS/ENGINEERS:

KJMW ENGINEERING CONSULTANTS
Mechanical/Electrical/Plumbing Engineer
623 26TH AVENUE
ROCK ISLAND, ILLINOIS 61201
309.786.0673 Telephone
309.786.5967 Fax

TERRACON
Geotechnical Engineer
2640 12TH STREET SW
CEDAR RAPIDS, IOWA 52404
319.366.8321 Telephone
319.366.0032 Fax

GRAEF
Civil Engineer/Landscape Architect
332 SOUTH MICHIGAN, SUITE 1400
CHICAGO, ILLINOIS 60604-4367
312.582.2020 Telephone
312.939.7014 Fax

WALKER PARKING CONSULTANTS
Structural Engineer
906 DAVIS ROAD
ELGIN, ILLINOIS 60123
847.697.2640 Telephone
847.697.7439 Fax

FAITHFUL+GOULD
Cost Management
222 SOUTH RIVERSIDE PLAZA, SUITE 2240
CHICAGO, ILLINOIS 60606
312.612.6319 Telephone
312.655.9037 Fax

ARCHITECT:
Loebl Schlossman & Hackl
Architecture • Planning • Interiors
233 North Michigan Avenue
Suite 5000
Chicago, Illinois 60601
312.565.1800 Telephone
312.565.5912 Facsimile
www.lshdesign.com

Drawing Title
SITE COORDINATE PLAN

Approved: Project Director
Iowa City VA Healthcare System
Department of Veterans Affairs Medical Center

Project Title
400 CAR PARKING GARAGE

Location
IOWA CITY, IA

Date
06/10/2011

Checked
MAY

Drawn
IN

Project Number
636-402

Building Number
43

Drawing Number
43-L8
Dwg. 13 of 152

Office of
Construction
and Facilities
Management

Department of
Veterans Affairs

VA FORM 08-6231 1 2 3 4 5 6 7 8 9