

three inches = one foot
one and one half inches = one foot
one inch = one foot
three quarters inch = one foot
one half inch = one foot
three eighths inch = one foot
one quarter inch = one foot
one eighth inch = one foot

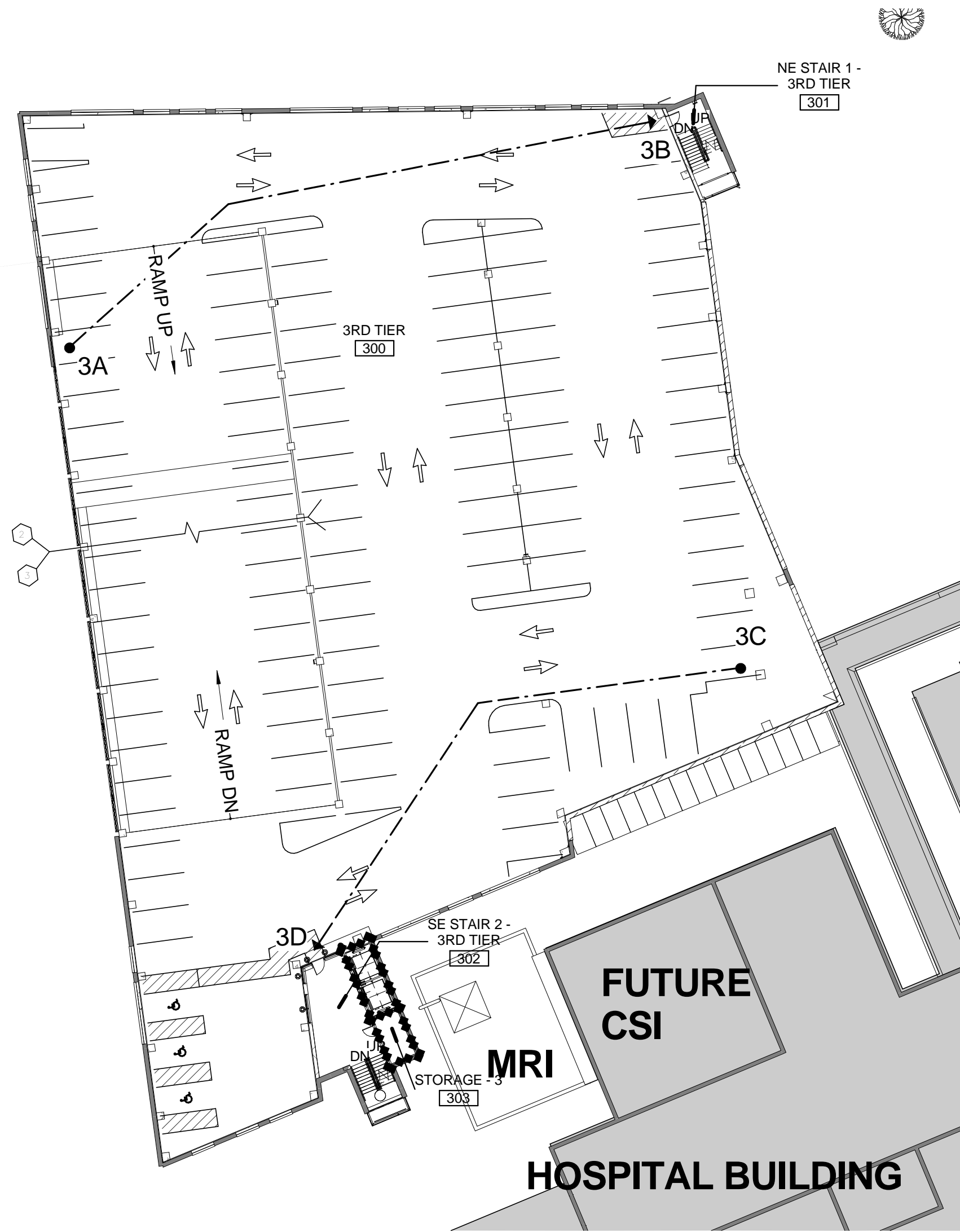

3 THIRD TIER CODE COMPLIANCE PLAN
1" = 30'-0"

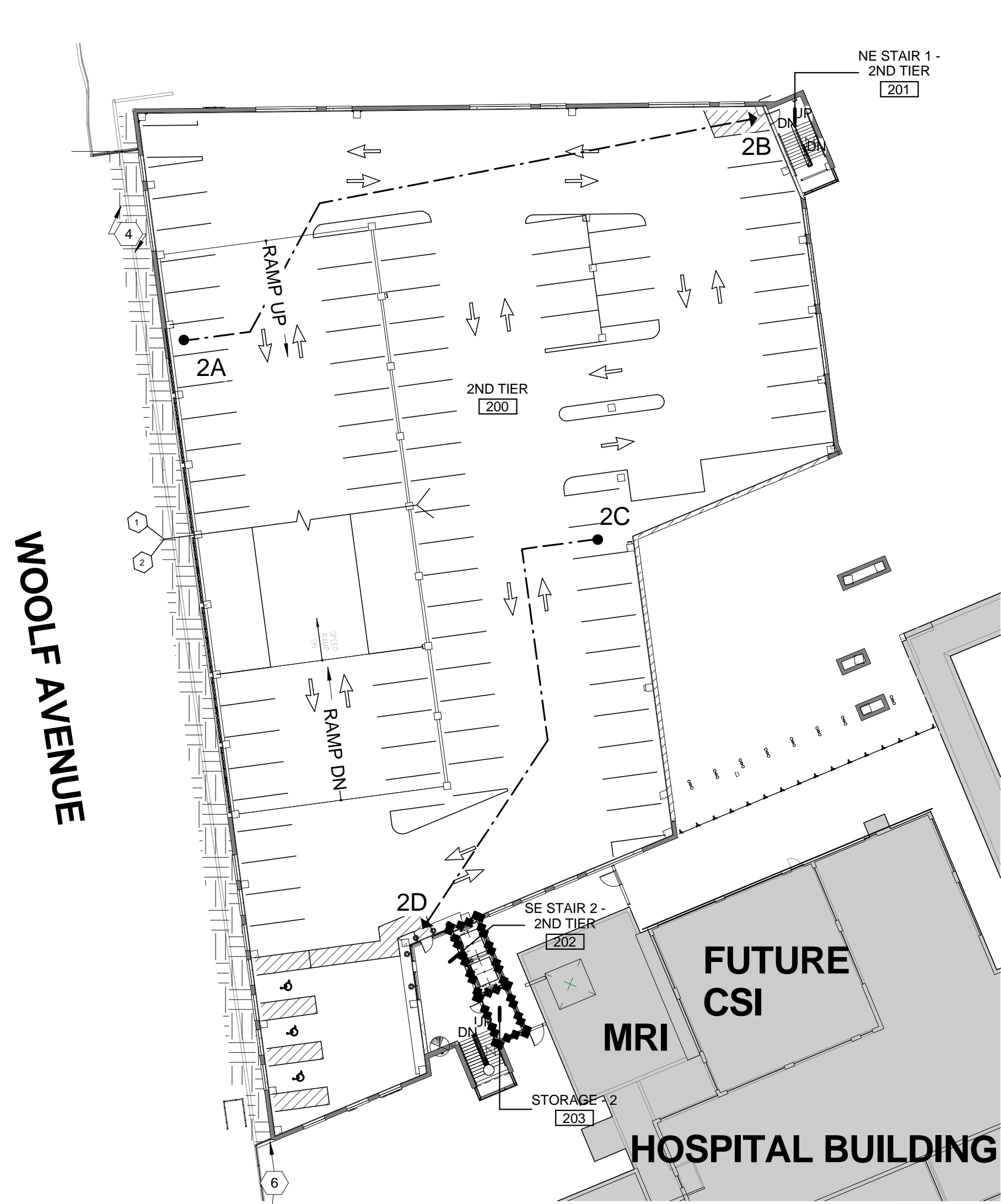

2 2ND TIER CODE COMPLIANCE PLAN
1" = 30'-0"

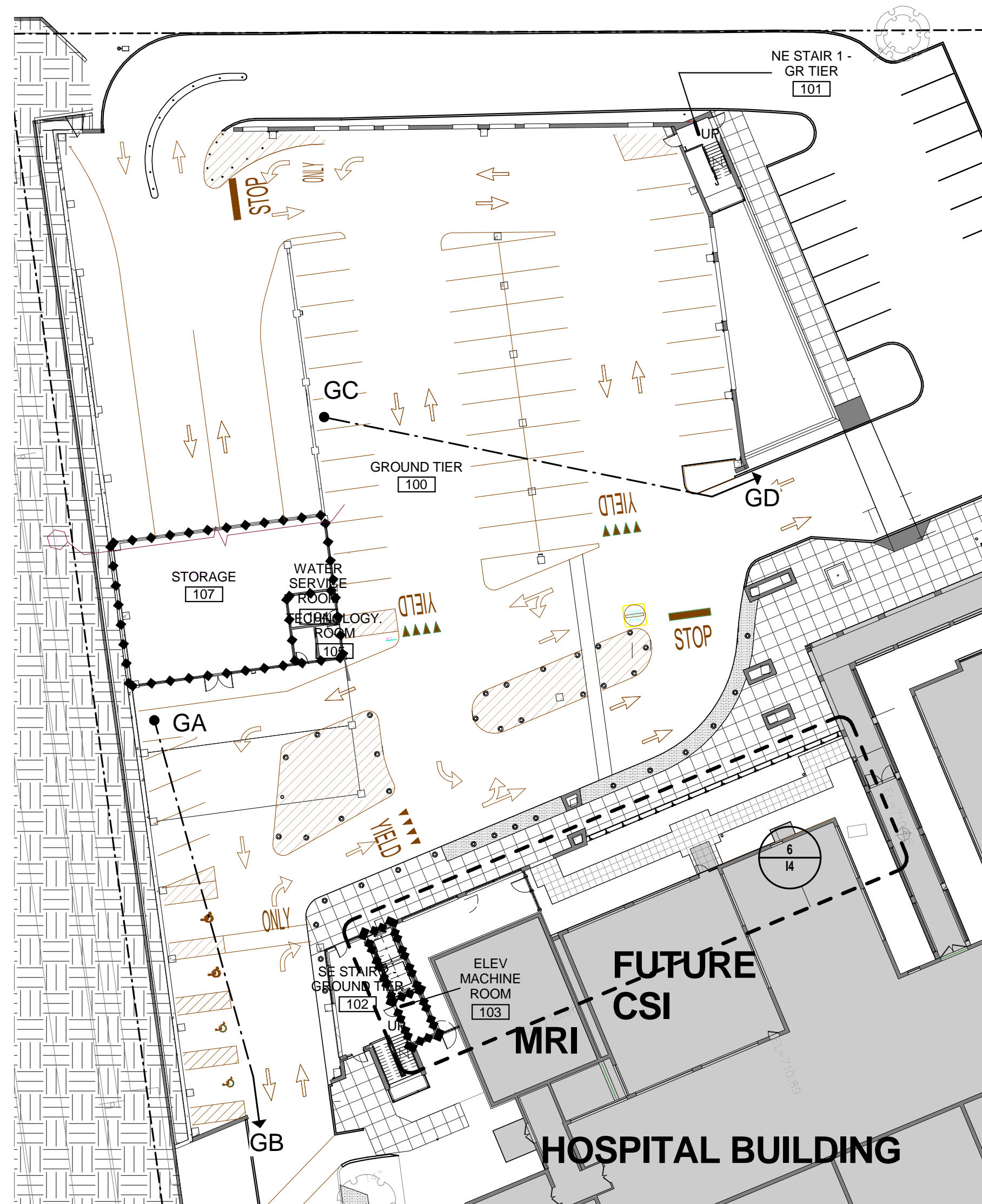

1 GROUND TIER CODE COMPLIANCE PLAN
1" = 30'-0"

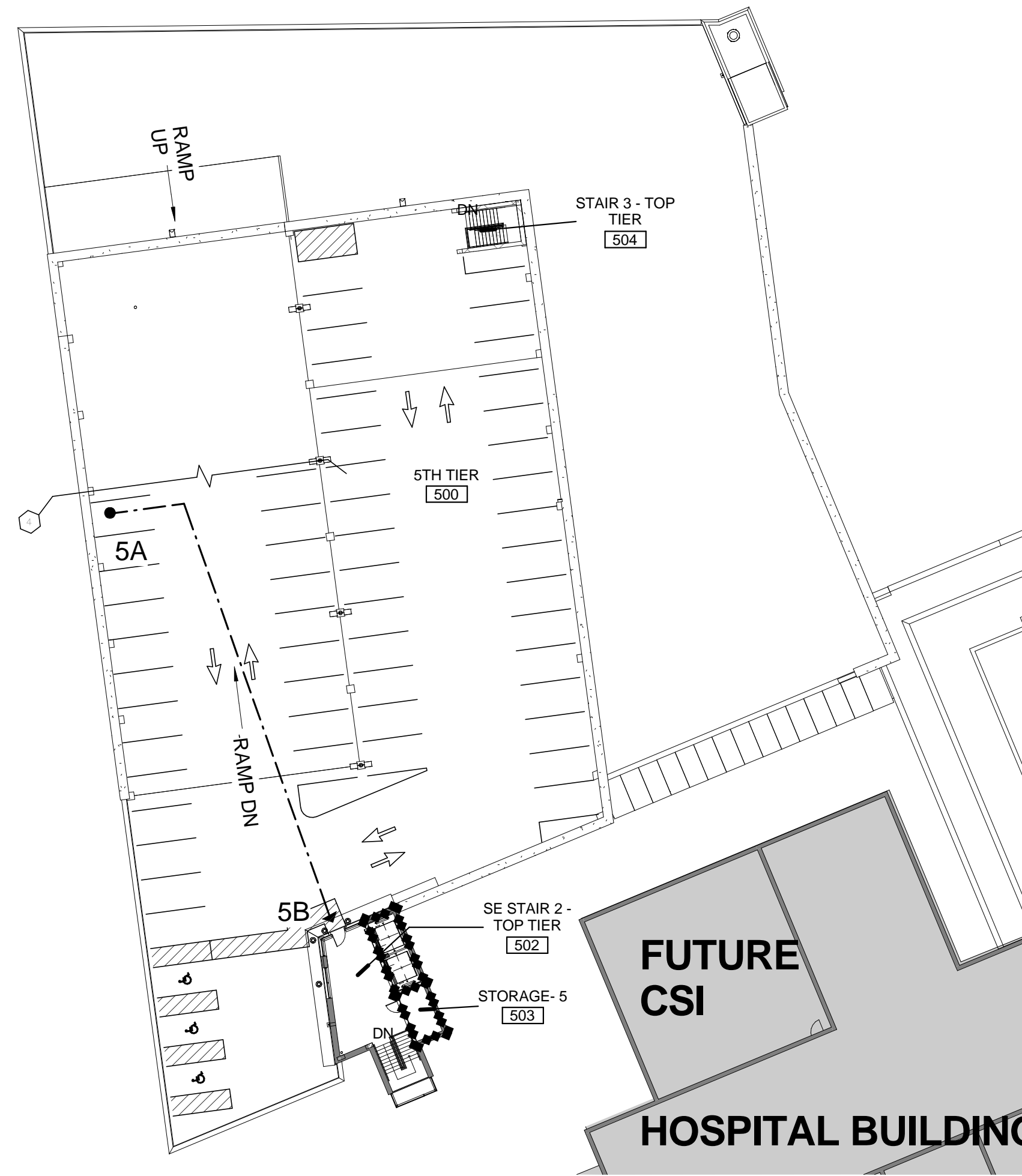

5 TOP TIER CODE COMPLIANCE PLAN
1" = 30'-0"

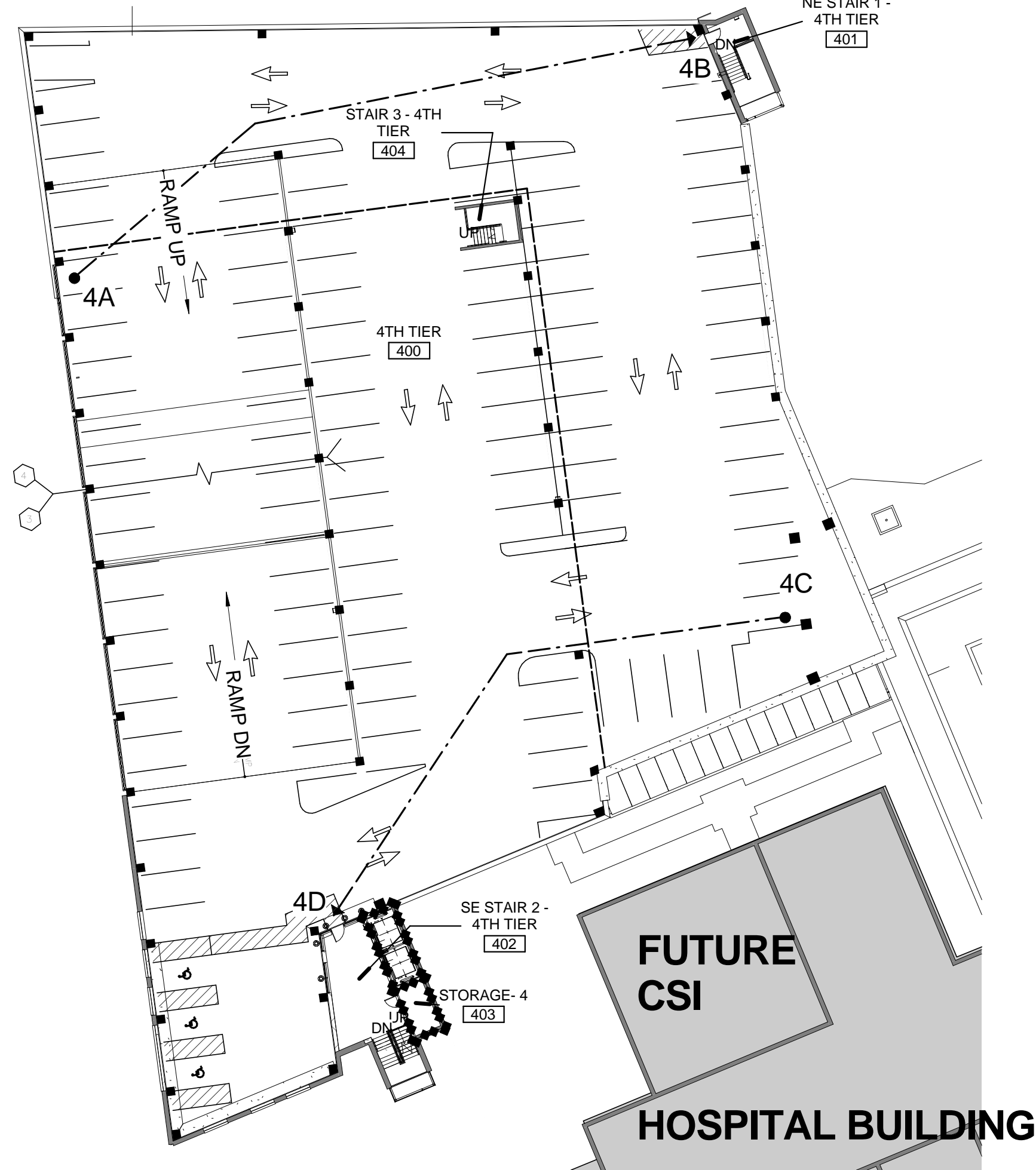

4 FOURTH TIER CODE COMPLIANCE PLAN
1" = 30'-0"

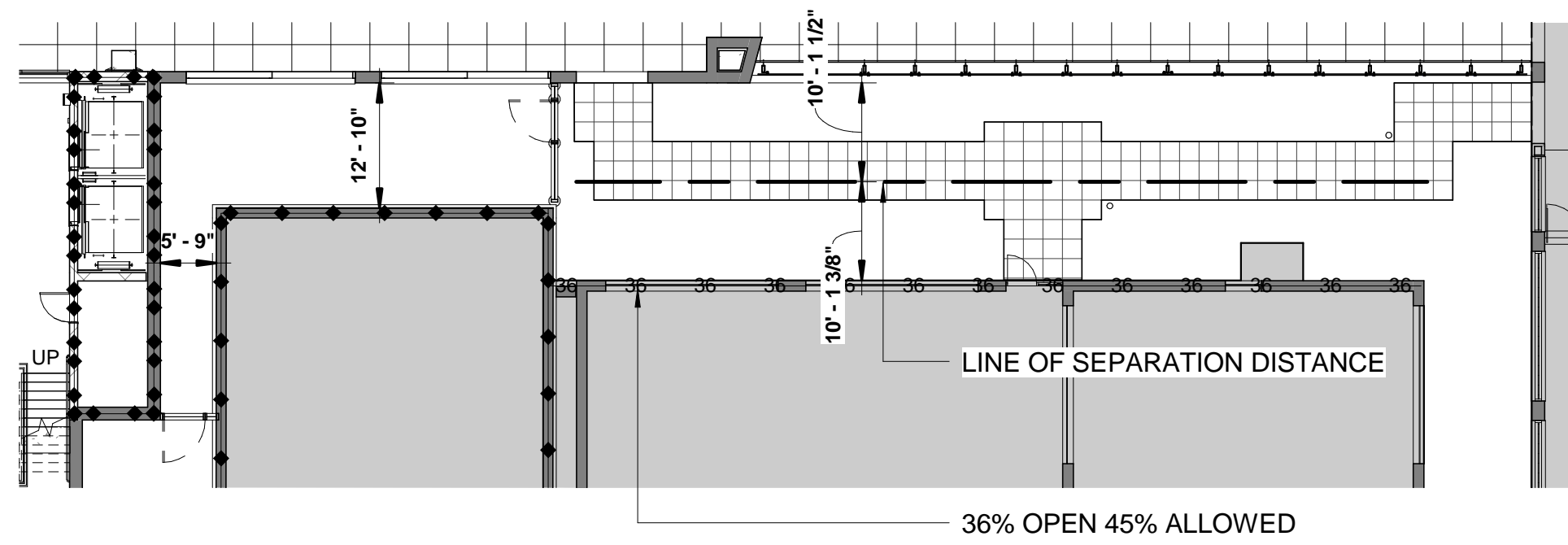

6 SEPARATION DISTANCE DIAGRAM
1/16" = 1'-0"

CODE CONFORMANCE PLAN SYMBOLS	
	NEW DOOR AND FRAME
	EXISTING DOOR TO REMAIN
	NEW WALL SEE PARTITION TYPE TAGS AND DETAILS
	EXISTING WALL
	1 HOUR RATED PARTITION
	2 HOUR RATED PARTITION
	PATH OF TRAVEL
	EXIT
	INTERNATIONAL SYMBOL OF ACCESSIBILITY
	NO WORK IN EXISTING AREA

TRAVEL DISTANCES	
GROUND TIER	
GA TO GB =	120' - 0"
GC TO GD =	125' - 0"
SECOND TIER	
2A TO 2B =	180' - 0"
2C TO 2D =	145' - 0"
THIRD TIER	
3A TO 3B =	180' - 0"
3C TO 3D =	154' - 0"
FOURTH TIER	
4A TO 4B =	180' - 0"
4C TO 4D =	150' - 0"
TOP TIER	
5A TO 5B =	132' - 0"

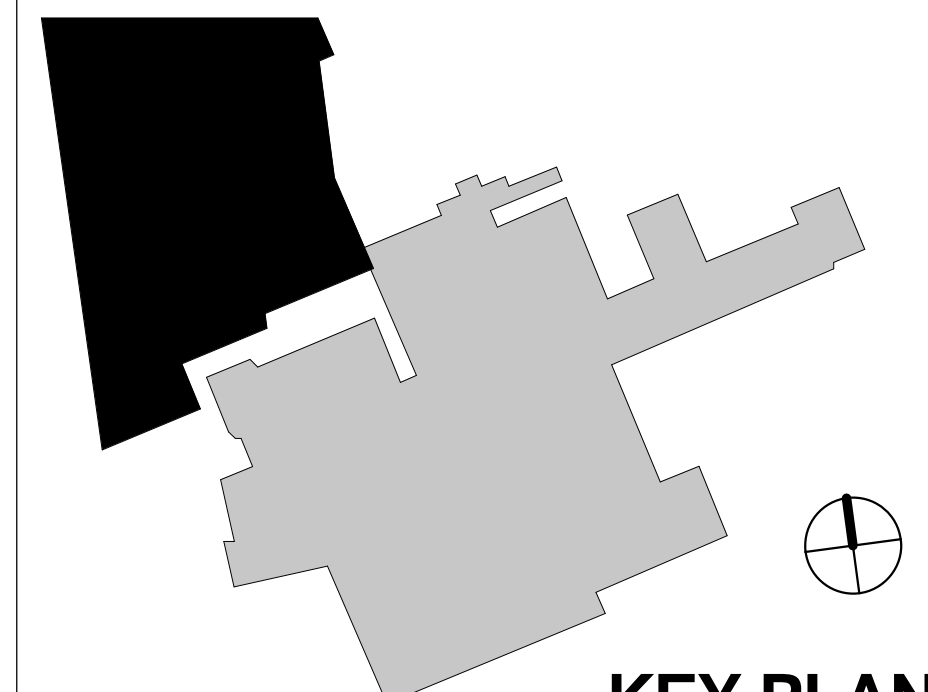

KEY PLAN

Revisions:	Date
FINAL CONSTRUCTION DOCUMENTS	06/10/11
100% REVIEW SUBMISSION (NOT FOR CONSTRUCTION)	04/11/11
75% REVIEW SUBMISSION (NOT FOR CONSTRUCTION)	02/03/11
75% REVIEW SUBMISSION (NOT FOR CONSTRUCTION) - COST ESTIMATE	01/19/11
35% REVIEW SUBMISSION (NOT FOR CONSTRUCTION)	11/22/10

CONSULTANTS/ENGINEERS:

KJWW ENGINEERING CONSULTANTS
Mechanical/Electrical/Plumbing Engineer
632 26TH AVENUE
ROCK ISLAND, ILLINOIS 61201
309.788.0673 Telephone
309.786.5967 Fax

TERRACON
Geotechnical Engineer
2640 12TH STREET SW
CEDAR RAPIDS, IOWA 52404
319.366.8321 Telephone
319.366.0032 Fax

GRAEF
Civil Engineer/Landscape Architect
332 SOUTH MICHIGAN, SUITE 1400
CHICAGO, ILLINOIS 60604-4507
312.582.2020 Telephone
312.939.7014 Fax

WALKER PARKING CONSULTANTS
Structural Engineer
505 DAVIS ROAD
ELGIN, ILLINOIS 60123
847.697.2640 Telephone
847.697.7439 Fax

FAITHFUL+GOULD
Cost Management
222 SOUTH RIVERSIDE PLAZA, SUITE 2240
CHICAGO, ILLINOIS 60606
312.612.6319 Telephone
312.655.9037 Fax

ARCHITECT:

Loebl Schlossman & Hackl
Architecture • Planning • Interiors

Copyright © 2011 Loebl Schlossman & Hackl Inc.

233 North Michigan Avenue
Suite 3000
Chicago, Illinois 60601

312.565.1800 Telephone
312.565.5912 Facsimile
www.lshdesign.com

Drawing Title	CODE COMPLIANCE PLAN
Approved: Project Director	Iowa City VA Healthcare System Department of Veterans Affairs Medical Center

Project Title	400 CAR PARKING GARAGE
Location	IOWA CITY, IA
Date	06/10/2011
Checked	PS/JP
Drawn	DM

Project Number	636-402
Building Number	43
Drawing Number	14
Dwg. 4 of 152	

Office of
Construction
and Facilities
Management

