

one eighth inch = one foot
one quarter inch = one foot
three eighths inch = one foot
one half inch = one foot
three quarters inch = one foot
one inch = one foot
one and one half inches = one foot
two inches = one foot
three inches = one foot

- GENERAL SHEET NOTES**
1. REFER TO 43-P6 FOR DOMESTIC WATER RISER DIAGRAM.
 2. REFER TO 43-P7 FOR STORM WATER RISER DIAGRAM.
 3. COORDINATE INSTALLATION OF DOMESTIC WATER AND STORM PIPE PROTECTION / GUARDING WITH GENERAL CONTRACTOR. REFER TO F7/S-101 FOR PIPE GUARD DETAIL.

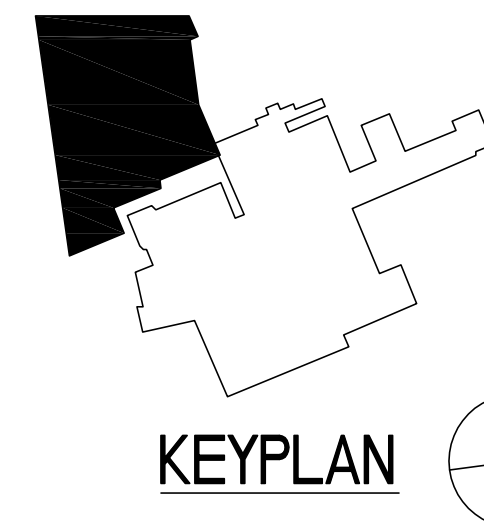
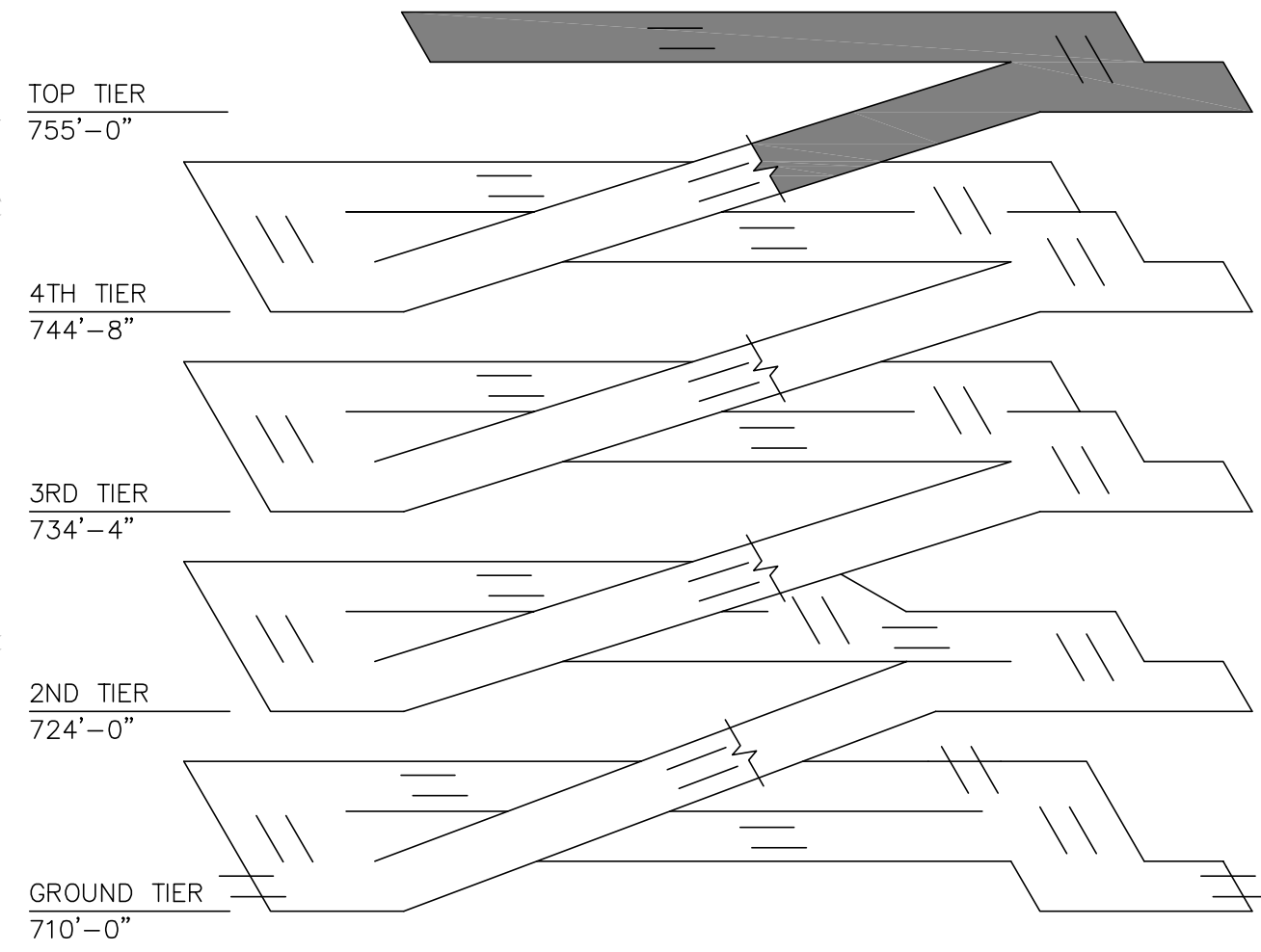

FINAL CONSTRUCTION DOCUMENTS	06/10/11
100% REVIEW SUBMISSION (NOT FOR CONSTRUCTION)	04/11/11
75% REVIEW SUBMISSION (NOT FOR CONSTRUCTION)	02/03/11
75% REVIEW SUBMISSION (NOT FOR CONSTRUCTION) - COST ESTIMATE	01/19/11
35% REVIEW SUBMISSION (NOT FOR CONSTRUCTION)	11/22/10
Revisions:	Date

CONSULTANTS/ENGINEERS:

KJWW ENGINEERING CONSULTANTS
Mechanical/Electrical/Plumbing Engineer
623 26TH AVENUE
ROCK ISLAND, ILLINOIS 61201
309.788.0673 Telephone
309.786-5967 Fax

TERRACON
Geotechnical Engineer
2640 12TH STREET SW
CEDAR RAPIDS, IOWA 52404
319.366.8321 Telephone
319.366.0032 Fax

GRAEF
Civil Engineer/Landscape Architect
332 SOUTH MICHIGAN, SUITE 1400
CHICAGO, ILLINOIS 60604-4367
312.582.2020 Telephone
312.939.7014 Fax

WALKER PARKING CONSULTANTS
Structural Engineer
305 DAVIS ROAD
ELGIN, ILLINOIS 60123
847.697.2640 Telephone
847.697.7439 Fax

FAITHFUL+GOULD
Cost Management
222 SOUTH RIVERSIDE PLAZA, SUITE 2240
CHICAGO, ILLINOIS 60606
312.612.6319 Telephone
312.655.9037 Fax

ARCHITECT:

Loebl Schlossman & Hackl
Architecture•Planning•Interiors

233 North Michigan Avenue
Suite 3000
Chicago, Illinois 60601

312.565.1800 Telephone
312.565.5912 Facsimile
www.lshdesign.com

Drawing Title	TOP TIER PLAN - PLUMBING
Approved: Project Director	
Iowa City VA Healthcare System Department of Veterans Affairs Medical Center	

Project Title	400 CAR PARKING GARAGE
Location	IOWA CITY, IA
Date	06/10/2011
Checked	MATMEA
Drawn	JOSHEA

Project Number	636-402
Building Number	43
Drawing Number	43-P5
Dwg. 128 of 152	

Office of
Construction
and Facilities
Management
 Department of
Veterans Affairs