

one eighth inch = one foot  
 one quarter inch = one foot  
 one half inch = one foot  
 three eighths inch = one foot  
 one inch = one foot  
 three quarters inch = one foot  
 two inches = one foot  
 three inches = one foot  
 four inches = one foot  
 six inches = one foot  
 one and one half inches = one foot  
 two and one half inches = one foot  
 three and one half inches = one foot  
 four and one half inches = one foot  
 five and one half inches = one foot  
 six and one half inches = one foot  
 seven and one half inches = one foot  
 eight and one half inches = one foot  
 nine and one half inches = one foot  
 ten and one half inches = one foot  
 eleven and one half inches = one foot  
 twelve and one half inches = one foot  
 thirteen and one half inches = one foot  
 fourteen and one half inches = one foot  
 fifteen and one half inches = one foot

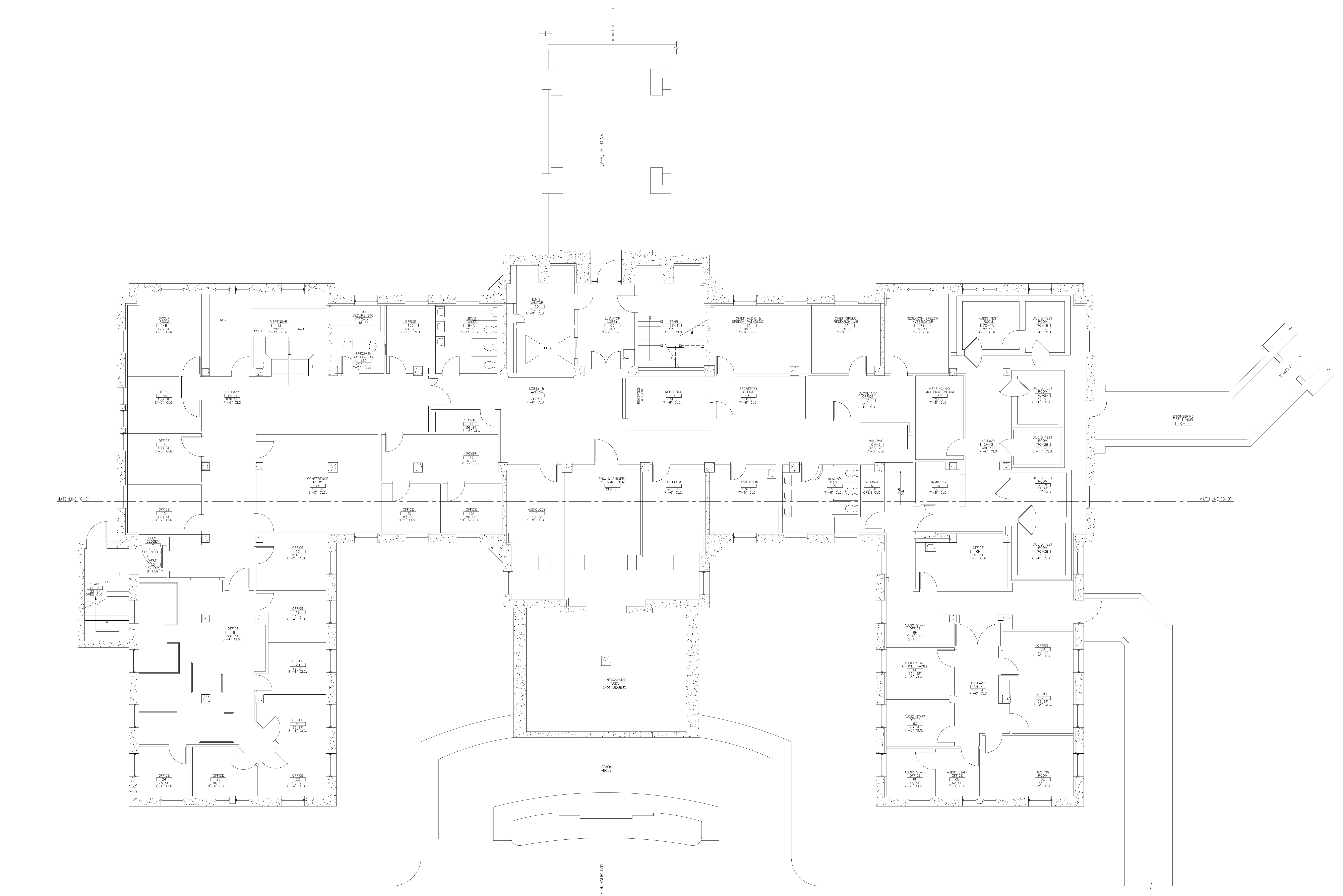

**1 GROUND FLOOR PLAN - BLDG. 1**  
 N.T.S.

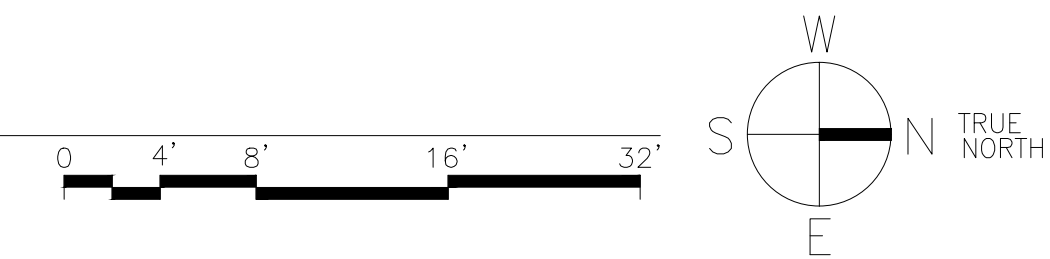

Revisions:	Date

**CONSULTANTS:**

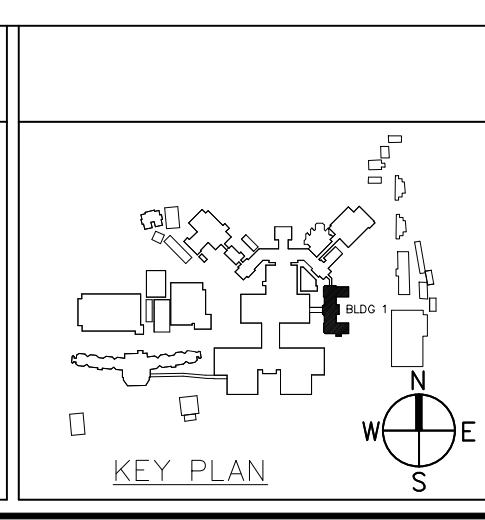

**ARCHITECT/ENGINEERS:**

**Drawing Title**  
 GROUND FLOOR PLAN  
  
**Approved Project Director**

<b>Project Title</b> UPDATE of AUTOCAD FLOOR PLANS and SPACE FILES		<b>Project Number</b> 662-14-207
<b>Location</b> VAMC SAN FRANCISCO CA 94121		<b>Building Number</b> 1
<b>Date</b> 3-31-2015	<b>Checked</b> LAP	<b>Drawn</b> JM
<b>Dwg. 1 of 18</b>		

**Office of Construction and Facilities Management**  
 Department of Veterans Affairs

Scale: As Noted