

9/23/2016 1:37:51 PM
C:\Revit\Local\25628031_VA_Indy_Generators - Bldg 22 Kevin D Harvey.rvt
one-eighth inch = one foot

VA FORM 08-6231

1

2

3

4

5

6

7

8

9

CIVIL SITE NOTES

GENERAL

- CONTRACTOR SHALL COMPLY WITH ALL APPLICABLE LOCAL, STATE, AND FEDERAL LAWS AND REGULATIONS.
- THE CONTRACTOR SHALL BE RESPONSIBLE FOR OBTAINING ALL PERMITS AND APPROVALS AS NECESSARY FROM THE RESPECTIVE CITY, COUNTY, AND STATE AGENCIES PRIOR TO STARTING CONSTRUCTION.
- FOR VIEWING CLARITY OF THESE PLANS, THE PIPES OR STRUCTURES MAY NOT BE DRAWN TO SCALE.
- THE UTILITIES INDICATED ON THESE PLANS MAY NOT BE A COMPLETE INVENTORY OF ALL UTILITIES CURRENTLY ON OR NEAR THE SITE. THE CONTRACTOR SHALL BE RESPONSIBLE FOR OBTAINING PUBLIC AND/OR PRIVATE UTILITY LOCATING SERVICES PRIOR TO STARTING CONSTRUCTION.
- THE SIZE AND LOCATIONS OF THE UTILITIES INDICATED ON THESE PLANS ARE APPROXIMATE. THE CONTRACTOR IS TO DETERMINE AND FIELD VERIFY ALL HORIZONTAL AND VERTICAL LOCATIONS PRIOR TO STARTING CONSTRUCTION ACTIVITIES.
- ANY DISCREPANCIES OR CONFLICTS WHICH BECOME APPARENT BEFORE OR DURING CONSTRUCTION SHALL BE BROUGHT TO THE ATTENTION OF THE ENGINEER OF RECORD AND COR PRIOR TO CONSTRUCTION SO THAT REDESIGN OR CLARIFICATION MAY OCCUR.

DEMOLITION

- ALL DEMOLISHED MATERIAL TO BECOME THE PROPERTY OF THE CONTRACTOR, UNLESS OTHERWISE NOTED, AND SHALL BE LEGALLY DISPOSED OF OFFSITE.
- CONDUCT DEMOLITION AND CONSTRUCTION ACTIVITIES IN SUCH A MANNER TO PROVIDE MINIMUM TRAFFIC DISRUPTIONS. CONTRACTOR TO INSTALL TRAFFIC CONTROL DEVICES PER THE MANUAL ON UNIFORM TRAFFIC CONTROL DEVICES (MUTCD), LATEST EDITION, AS NECESSARY.
- ALL EXISTING TREES TO REMAIN SHALL BE PRESERVED AND PROTECTED.
- CONTRACTOR SHALL COORDINATE ALL WORK ASSOCIATED WITH THE REMOVAL, RELOCATION, AND DEMOLITION OF EXISTING UTILITIES WITH THE RESPECTIVE UTILITY COMPANY.
- EXISTING UNDERGROUND ELECTRIC AND TELEPHONE CABLES THAT ARE SHOWN TO BE ABANDONED IN PLACE MAY BE CUT AS NECESSARY TO FACILITATE CONSTRUCTION ACTIVITIES. THE CONTRACTOR SHALL ENSURE THAT LINES ARE NOT ACTIVE PRIOR TO CUTTING.
- CONTRACTOR TO MAINTAIN PROPER DRAINAGE IN DEMOLITION AREAS.
- CONTRACTOR SHALL BE RESPONSIBLE FOR REPAIRING DAMAGE TO EXISTING BUILDINGS AND/OR SITE ENTITIES THAT ARE TO REMAIN.
- CONCRETE TO BE SAWCUT SHALL BE SAWCUT TO THE NEAREST CONCRETE JOINT BEYOND THE LIMITS ILLUSTRATED.

SITE PLAN

- ALL DIMENSIONS ARE TO THE BACK OF CURB. WHEN CURBS ARE NOT PRESENT, DIMENSION ARE TO THE EDGE OF PAVEMENT.
- ALL PARKING STALLS SHALL BE 9' X 18' UNLESS OTHERWISE NOTED.
- CONTRACTOR SHALL FIELD VERIFY ALL DIMENSIONS ON THE SITE PRIOR TO CONSTRUCTION AND IDENTIFY DISCREPANCIES TO THE ENGINEER OF RECORD AND COR.
- SEE SHEET CS501 FOR PROPOSED SITE IMPROVEMENT DETAILS REFERENCED.
- WHERE WORK IS DONE IN EXISTING AREAS, THE EXISTING FINISHED CONDITIONS ARE TO BE REPAIRED OR REPLACED. THESE FINISHED CONDITIONS ARE TO MATCH EXISTING UNLESS OTHERWISE NOTED.

GRADING

- CONTRACTOR SHALL ENSURE THAT POSITIVE DRAINAGE IN IMPROVED AREAS IS ACHIEVED. CONTRACTOR TO TEST AND CORRECT ANY "BIRD BATH" CONDITIONS.
- ALL SLOPES SHALL BE 3:1 OR FLATTER, UNLESS OTHERWISE SHOWN.
- ALL GRADES AT THE PROJECT BOUNDARY OR PROPERTY LINE SHALL MEET EXISTING GRADES.
- BUILDING PAD AREAS AND PAVED AREAS DESIGNATED FOR FILL SHALL BE CONSTRUCTED OF SUITABLE FILL MATERIAL AND COMPACTED PER SPECIFICATIONS. ALL FILL AREAS ARE TO BE STRIPPED OF TOPSOIL PRIOR TO PLACEMENT OF FILL.
- ANY EXCESS SOIL MATERIAL SHALL BE EXPORTED FROM THE SITE AFTER CONSTRUCTION IS COMPLETE.
- CONTOURS ARE SHOWN AS A REFERENCE TO MEET JURISDICTIONAL REQUIREMENTS. CONTRACTOR SHOULD GRADE SITE PER THE PROPOSED SPOT GRADE ELEVATIONS.

UTILITIES

- CONTRACTOR TO MAINTAIN ALL EXISTING UTILITIES TO STAY IN SERVICE DURING CONSTRUCTION.

- CONTRACTOR SHALL NOTIFY ALL UTILITY COMPANIES 72 HOURS PRIOR TO CONSTRUCTION TO VERIFY UTILITIES THAT MIGHT BE PRESENT ON SITE.
- THE CONTRACTOR IS REQUIRED TO PROVIDE ADEQUATE SHEETING, SHORING, AND DEWATERING IN ALL TRENCHES AND EXCAVATIONS AS NECESSARY IN ACCORDANCE WITH OSHA; AND IS SOLELY RESPONSIBLE FOR THE SAFETY OF SHEETING, SHORING, AND DEWATERING.
- WHEN CONNECTIONS ARE TO BE MADE TO EXISTING PIPING AND STRUCTURES OR WHERE CONSTRUCTION IS IN THE VICINITY OF EXISTING PIPING, THE LOCATION AND ELEVATION OF THE EXISTING PIPING AND STRUCTURES SHALL BE FIELD VERIFIED BY THE CONTRACTOR. IF ANY DISCREPANCIES ARE FOUND, THEN THE ENGINEER AND COR SHALL BE NOTIFIED IMMEDIATELY.
- ALL WORK SHALL BE PERFORMED IN A SAFE MANNER. ALL SAFETY RULES AND GUIDELINES OF O.S.H.A. SHALL BE FOLLOWED. THE CONTRACTOR SHALL BE WHOLLY RESPONSIBLE FOR ANY INJURIES TO HIS EMPLOYEES, AND ANY DAMAGE TO PRIVATE PROPERTY OR PERSONS DURING THE COURSE OF THIS PROJECT.
- REFER TO SHEETS CU501 FOR PROPOSED UTILITY DETAILS REFERENCED.
- WATER MAINS THROUGHOUT THE PROJECT SHALL BE INSTALLED WITH AT LEAST 48 INCHES OF COVER TO PROVIDE PROTECTION FROM FREEZING.
- HORIZONTAL SEPARATION BETWEEN WATER & SEWER SHALL BE 10 FEET.
- VERTICAL SEPARATION BETWEEN WATER & SEWER SHALL BE 18 INCHES.
- WATER MAIN ALIGNMENT SHOWN IS BASED ON STANDARD FITTINGS AVAILABLE FOR DUCTILE IRON PIPE. JOINT DEFLECTIONS SHALL NOT EXCEED 75 PERCENT OF MANUFACTURER'S RECOMMENDED DEFLECTION.
- CONTRACTOR SHALL ADJUST WATER MAIN ALIGNMENT AND DEFLECT JOINTS AS NECESSARY TO ACCOMMODATE THE STANDARD BENDS SHOWN.
- MEASUREMENTS AND SLOPES SHOWN ARE FROM CENTER OF STRUCTURE TO CENTER OF STRUCTURE.
- QUANTITIES PROVIDED ARE ESTIMATES AND SHALL BE CONFIRMED BY THE CONTRACTOR.

EROSION CONTROL

- EROSION AND SEDIMENTATION CONTROL DEVICES TO BE INSTALLED PRIOR TO BEGINNING CONSTRUCTION.
- STABILIZATION MEASURES SHALL BE INITIATED AS SOON AS PRACTICABLE IN PORTIONS OF THE SITE WHERE CONSTRUCTION ACTIVITIES HAVE TEMPORARILY OR PERMANENTLY CEASED, BUT IN NO CASE MORE THAN FOURTEEN (14) DAYS AFTER WORK HAS CEASED, UNLESS ACTIVITY IN THAT PART OF THE SITE WILL RESUME WITHIN TWENTY-ONE (21) DAYS.
- PROVIDE SILT FENCE AND/OR OTHER CONTROL DEVICES, AS MAY BE REQUIRED, TO CONTROL SOIL EROSION DURING UTILITY CONSTRUCTION. ALL DISTURBED AREAS SHALL BE CLEANED, GRADED, AND STABILIZED WITH GRASSING IMMEDIATELY AFTER THE UTILITY INSTALLATION.
- EROSION CONTROL AND SEDIMENTATION CONTROL DEVICES TO BE MAINTAINED SUCH THAT THEY FUNCTION AS INTENDED. AFTER COMPLETION OF THE PROJECT THE CONTRACTOR SHALL REMOVE ALL DEVICES WHERE A GOOD STAND OF GRASS HAS BEEN ESTABLISHED AND EROSION IS NO LONGER EVIDENT. REMOVAL OF THE REMAINING DEVICES SHALL OCCUR AS OTHER AREAS ARE ESTABLISHED.
- EROSION CONTROL MEASURES SHALL BE INSPECTED EVERY SEVEN (7) DAYS OR AFTER EACH RAINFALL OCCURRENCE THAT EXCEEDS ONE-HALF (1/2) INCH. DAMAGED OR INEFFECTIVE DEVICES SHALL BE REPAIRED OR REPLACED IMMEDIATELY.
- ALL AREAS DISTURBED BY GRADING, EXCAVATION, AND GENERAL CONSTRUCTION SHALL BE SEEDED, MULCHED, AND RESTORED IN ACCORDANCE WITH THE SPECIFICATIONS.
- THE CONTRACTOR MUST TAKE NECESSARY ACTION TO MINIMIZE THE TRACKING OF MUD ONTO PAVED ROADWAYS. THE CONTRACTOR SHALL DAILY REMOVE MUD/SOIL FROM PAVEMENT, AS MAY BE REQUIRED.
- SEE SHEET CU501 FOR PROPOSED EROSION AND SEDIMENT CONTROL DETAILS REFERENCED.

CIVIL SITE ABBREVIATIONS

AC	ACRE	MAX	MAXIMUM
ABC	AGGREGATE BASE COURSE	MB	MAIL BOX
ADA	AMERICANS WITH DISABILITIES ACT	MEG	MEET EXISTING GRADE
AGGR	AGGREGATE	MEMO	MEMORANDUM
ALT	ALTERNATE	MFG	MANUFACTURED OR MANUFACTURE
APPROX	APPROXIMATE	MH	MANHOLE
ARV	AIR RELEASE VALVE	MIN	MINIMUM
ASPH	ASPHALT	MISC	MISCELLANEOUS
ASSY	ASSEMBLY	MJ	MECHANICAL JOINT
		MOD	MODIFY
BC	BACK OF CURB	MOT	MAINTENANCE OF TRAFFIC
BFP	BACKFLOW PREVENTER	MULT	MULTIPLE
BLDG	BUILDING	MUNIC	MUNICIPAL
BLT	BUILT	MUTCD	MANUAL ON UNIFORM TRAFFIC CONTROL DEVICES
BM	BENCHMARK	NA	NOT APPLICABLE
BNRY	BOUNDARY	NIC	NOT IN CONTRACT
BO	BLOW OFF	NO	NUMBER
		NOM	NOMINAL
C/C	CENTER TO CENTER	NORM	NORMAL
CB	CATCH BASIN	NRCP	NON-REINFORCED CONCRETE PIPE
CCTV	CLOSED CIRCUIT TELEVISION	NTP	NOTICE TO PROCEED
CFS	CUBIC FEET PER SECOND	NTS	NOT TO SCALE
CHKV	CHECK VALVE	OC	ON CENTER
CI	CAST IRON	PAR	PARALLEL
CJ	CIRCULAR	PAVT	PAVEMENT
	CONSTRUCTION JOINT OR CONTROL JOINT	PB	PULL BOX
CL	CENTER LINE	PC	POINT OF CURVE
CMP	CORRUGATED METAL PIPE	PCC	POINT OF COMPOUND CURVE
CMU	CONCRETE MASONRY UNIT	PCPB	CONCRETE PAVEMENT
CND	CONDUIT	PE	POLYETHYLENE (PLASTIC)
CO	CLEANOUT	PERF	PERFORATED
COMM	COMMUNICATION	PERIM	PERIMETER
CONC	CONCRETE	PERM	PERMANENT
CONST	CONSTRUCT OR CONSTRUCTION	PERP	PERPENDICULAR
COR	CORNER	PG	PROFILE GRADE
CTR	CENTER	PH	PHASE
CTRL	CONTROL	PI	POINT OF INTERSECTION
CTV	CABLE TELEVISION	PIV	POST INDICATOR VALVE
CF	CUBIC FEET	PL	PROPERTY LINE
CY	CUBIC YARD	PP	POWER POLE OR POLYPROPYLENE
CV	CONTROL VALVE	PR	PROPOSED
		PREV	PREVIOUS
DA	DRAINAGE AREA	PRC	POINT OF REVERSE CURVE
DAT	DATUM	PRKG	PARKING
DBL	DOUBLE	PROJ	PROJECT
DDCV	DOUBLE DETECTOR CHECK VALVE	PROP	PROPERTY
DEG	DEGREE	PRV	PRESSURE RELIEF VALVE
DEMO	DEMOLITION	PSI	POUNDS PER SQUARE INCH
DEPT	DEPARTMENT	PSL	PIPE SLEEVE
DIA	DIAMETER	PT	POINT OF TANGENCY
DIFF	DIFFERENCE OR DIFFERENTIAL	PVC	POLYVINYL CHLORIDE (PLASTIC)
DIM	DIMENSION		
DIP	DUCTILE IRON PIPE	R	RADIUS
DIST	DISTANCE	RC	REINFORCED CONCRETE
DOM	DOMESTIC	RCB	REINFORCED CONCRETE BOX
DS	DEPARTMENT OF TRANSPORTATION	RCP	REINFORCED CONCRETE PIPE
DW	DOMESTIC WATER	RD	ROAD OR ROOF DRAIN
EA	EACH	RDC	REDUCER
EC	EDGE OF CURB	REQ	REQUIRE OR REQUIRED
EG	EXISTING GRADE	RFI	REQUEST FOR INFORMATION
EJ	EXPANSION JOINT	ROW	RIGHT OF WAY
ELEV	ELEVATION	RR	RAILROAD
EP	EDGE OF PAVEMENT (PAVING)	RT	RIGHT
EPA	ENVIRONMENTAL PROTECTION	SAN	SANITARY
	AGENCY	SB	SPLASH BLOCK
ESMT	EASEMENT	SCH	SCHEDULE
EO	EQUAL	SD	STORM DRAIN
EQL SP	EQUALLY SPACED	SOL	SADDLE
EQUIP	EQUIPMENT	SECT	SECTION
EQUIV	EQUIVALENT	SEP	SEPARATE
ES	EDGE OF SHOULDER	SF	SQUARE FOOT (FEET)
ESMT	EASEMENT	SGI	SINGLE
EW	END WALL	SHLD	SHOULDER
EX	EXISTING	SOV	SHUT OFF VALVE
EXP	EXPANSION	SPEC	SPECIFICATION
F/F	FACE TO FACE	SF	SQUARE FEET
FES	FLARED END SECTION	SS	SANITARY SEWER
FFE	FINISH FLOOR ELEVATION	STA	STATION
FHA	FIRE HYDRANT ASSEMBLY	STD	STANDARD
FNC	FENCE	STM	STEAM
FOC	FACE OF CURB	SURF	SURFACE
FPM	FEET PER MINUTE	SURV	SURVEY
FPS	FEET PER SECOND	SW	SIDEWALK
FPW	FIRE PROTECTION WATER SUPPLY	SY	SQUARE YARD
FSP	FIRE STANDPIPE		
FT	FEET OR FOOT	T	TELEPHONE
G	NATURAL GAS OR GAS LINE	TBM	TEMPORARY BENCHMARK
GA	GAGE	TB-XX	TEST BORING-XX (E.G., TB-01)
GAL	GALLON	TD	TRENCH DRAIN
GEN	GENERATOR	TE	TOP ELEVATION
GPD	GALLONS PER DAY	TEMP	TEMPORARY
GT	GREASE TRAP	THK	THICKNESS
GV	GATE VALVE	TOB	TOP OF BANK
GUT	GUTTER	TOC	TOP OF CURB
		TOPO	TOPOGRAPHY
HAZ MAT	HAZARDOUS MATERIALS	TOS	TOE OF SLOPE
HB	HOSE BIBB	TP	TELEPHONE POLE
HNC	HANDICAP OR HANDICAPPED	TYP	TYPICAL
HDPE	HIGH DENSITY POLYETHYLENE	TW	TOP OF WALL
HDWL	HEADWALL	UD	UNDERDRAIN
HH	HAND HOLE	UP	UTILITY POLE
HHZ	HORIZONTAL	UTIL	UTILITY
HP	HIGH POINT	USGS	U.S. GEOLOGICAL SURVEY
HT	HEIGHT		
HV	HOSE VALVE	VAR	VARIES
HWY	HIGHWAY	VB	VALVE BOX
HYD	HYDRANT	VC	VERTICAL CURVE
		VERT	VERTICAL
IE	INVERT ELEVATION	VIF	VERIFY IN FIELD
INCL	INCLUDED	VOL	VOLUME
INFO	INFORMATION		
INV	INVERT	W	WATER LINE
IW	IRRIGATION WATER	WM	WATER METER OR WATER MAIN
		WT	WATER TABLE
LAT	LATITUDE	WTR	WATER
LF	LINEAR FEET (FOOT)	WW	WASTE WATER
LOC	LOCATION	WWF	WELDED WIRE FABRIC
LONG	LONGITUDE OR LONGITUDINAL		
LOS	LINE OF SIGHT	XFMR	TRANSFORMER
LP	LOW POINT OR LIGHT POLE		
LT	LEFT		

PROPOSED LEGEND

DIRECTION OF FLOW		TEMPORARY SEEDING	
MATCH EXISTING GRADE		CONCRETE LIMITS	
SPOT ELEVATION		ASPHALT PAVEMENT LIMITS	
TOP OF CURB		BUILDING LIMITS	
EDGE OF PAVEMENT			
PROPOSED MINOR CONTOUR			
PROPOSED MAJOR CONTOUR			
STORM STRUCTURES		LIGHT POLE	
STORM SEWER		SIGN	
SANITARY STRUCTURE		INLET PROTECTION	
SANITARY SEWER		CONCRETE WASHOUT AREA	
UNDERGROUND COMMUNICATIONS		WATER TEE, BENDS	
WATER MAIN		WATER MAIN VALVE	
UNDERGROUND ELECTRIC		CLEANOUT	
ROOF DRAIN		FIRE HYDRANT	
UNDER DRAIN		WATER MAIN REDUCER	
FIBER OPTIC		PARKING BUMPER	
GAS MAIN			
FIRE MAIN			
STORM SEWER MAIN			
SANITARY FORCE MAIN			
CONSTRUCTION FENCE			
TREE PROTECTION			
SILT FENCE			
ELECTRICAL DUCT BANK			
CENTERLINE			
FEMA FLOOD ZONE			
SECTION NAME			
SECTION LOCATED ON SHEET NO.			

DEVELOPER/CONTRACTOR:

ARCHITECT/ENGINEERS:

905 N Captiol Ave, Suite 100
Indianapolis, IN 46204
United States
P: 317 800 6388
F: 317 800 6387
www.GuidonDesign.com

PROJECT PRINCIPAL	STEVE ROBINSON
PROJECT MANAGER	MELISSA COX
PROJECT ARCHITECT	TONY ELLIOTT
LANDSCAPE ARCHITECT	STACEY PAUL
STRUCTURAL ENGINEER	DAVE STEK
MECHANICAL ENGINEER	CASSANDRA DALLER
PLUMBING ENGINEER	CASSANDRA DALLER
ELECTRICAL ENGINEER	MARK FIFER

Drawing Title

GENERAL NOTES

Approved:

Project Title

INSTALL PRIMARY AND EMERGENCY
POWER SYSTEMS

Location

INDIANAPOLIS, INDIANA

Date

09/23/2016

Checked

SLP

Drawn

TPK

Project Number

583-15-102

Building Number

22

Drawing Number

CC001



Department of
Veterans Affairs

9/23/2015 1:37:51 PM
C:\Revit\Local\25252031_VA_Indy_Generators - Bldg 22 Kevin D Harvey.rvt
one-eighth inch = one foot
one-quarter inch = one foot
one-half inch = one foot
one inch = one foot
three-quarters inch = one foot
one inch = one foot
one and one-half inch = one foot
two inches = one foot
three inches = one foot

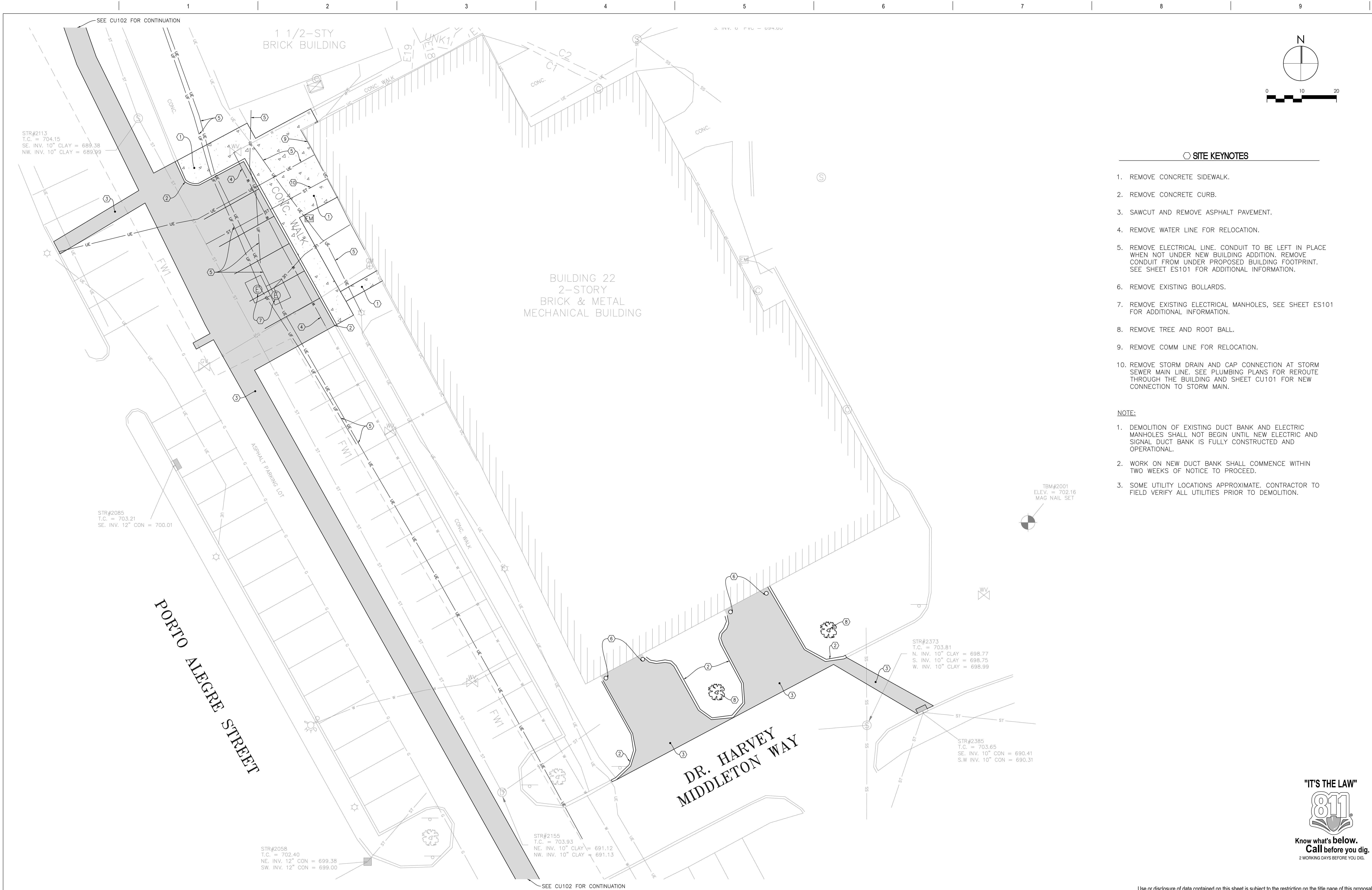

SITE KEYNOTES

1. REMOVE CONCRETE SIDEWALK.
2. REMOVE CONCRETE CURB.
3. SAWCUT AND REMOVE ASPHALT PAVEMENT.
4. REMOVE WATER LINE FOR RELOCATION.
5. REMOVE ELECTRICAL LINE. CONDUIT TO BE LEFT IN PLACE WHEN NOT UNDER NEW BUILDING ADDITION. REMOVE CONDUIT FROM UNDER PROPOSED BUILDING FOOTPRINT. SEE SHEET ES101 FOR ADDITIONAL INFORMATION.
6. REMOVE EXISTING BOLLARDS.
7. REMOVE EXISTING ELECTRICAL MANHOLES, SEE SHEET ES101 FOR ADDITIONAL INFORMATION.
8. REMOVE TREE AND ROOT BALL.
9. REMOVE COMM LINE FOR RELOCATION.
10. REMOVE STORM DRAIN AND CAP CONNECTION AT STORM SEWER MAIN LINE. SEE PLUMBING PLANS FOR REROUTE THROUGH THE BUILDING AND SHEET CU101 FOR NEW CONNECTION TO STORM MAIN.

NOTE:

1. DEMOLITION OF EXISTING DUCT BANK AND ELECTRIC MANHOLES SHALL NOT BEGIN UNTIL NEW ELECTRIC AND SIGNAL DUCT BANK IS FULLY CONSTRUCTED AND OPERATIONAL.
2. WORK ON NEW DUCT BANK SHALL COMMENCE WITHIN TWO WEEKS OF NOTICE TO PROCEED.
3. SOME UTILITY LOCATIONS APPROXIMATE. CONTRACTOR TO FIELD VERIFY ALL UTILITIES PRIOR TO DEMOLITION.

DEVELOPER/CONTRACTOR:			ARCHITECT/ENGINEERS:		Drawing Title DEMOLITION PLAN		Project Title INSTALL PRIMARY AND EMERGENCY POWER SYSTEMS		Project Number 583-15-102		
			905 N Captiol Ave, Suite 100 Indianapolis, IN 46204 United States P: 317 800 6388 F: 317 800 6387 www.GuidonDesign.com		PROJECT PRINCIPAL STEVE ROBINSON PROJECT MANAGER MELISSA COX PROJECT ARCHITECT TONY ELLIOTT LANDSCAPE ARCHITECT STACEY PAUL STRUCTURAL ENGINEER DAVE STEK MECHANICAL ENGINEER CASSANDRA DALLER PLUMBING ENGINEER CASSANDRA DALLER ELECTRICAL ENGINEER MARK FIFER		Location INDIANAPOLIS, INDIANA		Building Number 22		
100% BID DOCUMENTS FOR CONSTRUCTION 09/23/2016		URS PROJECT NO. 25628031		Approved:		Date 09/23/2016		Checked SLP		Drawn TPK	
Revisions:										Drawing Number CD101	

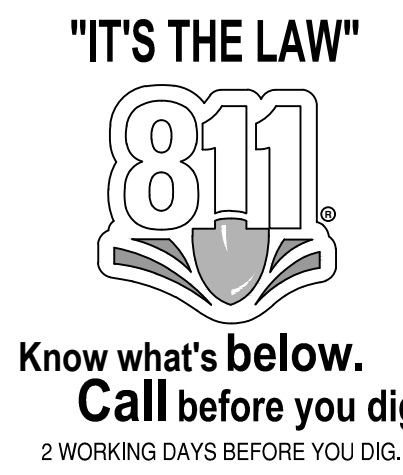

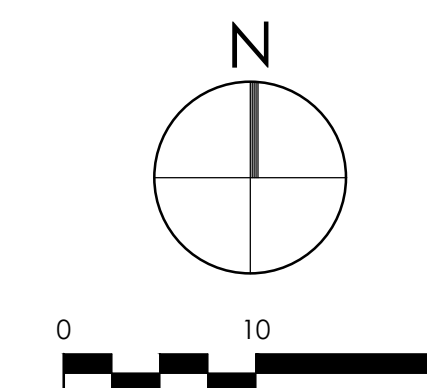

- ## SITE KEYNOTES

SITE LEGEND

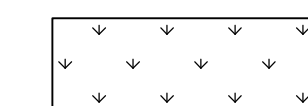
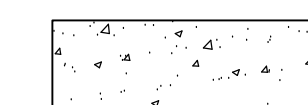

TBM#2001
ELEV. = 702.1
MAG NAIL SF7

BID ALTERNATE #2 : EXCLUDE
FENCE AROUND AST (FUEL
TANK) FROM SCOPE OF WORK

DEVELOPER/CONTRACTOR:

**905 N Captiol Ave, Suite 1000
Indianapolis, IN 46204
United States
P: 317 800 6388
F: 317 800 6387
www.GuidonDesign.com**

Drawing Title	SITE PLAN
---------------	-----------

Project Title	INSTALL PRIMARY AND EMERGENCY POWER SYSTEMS
---------------	---

Project Number	583-15-102
Building Number	22



9/23/2015 1:37:51 PM
C:\RevitLocal\25628031_VA_Indy_Generators - Bldg 22 Kevin D Harvey.rvt
one-eighth inch = one foot
one-quarter inch = one foot
one-half inch = one foot
one inch = one foot
three-quarters inch = one foot
one and one-half inch = one foot
two inches = one foot
three inches = one foot

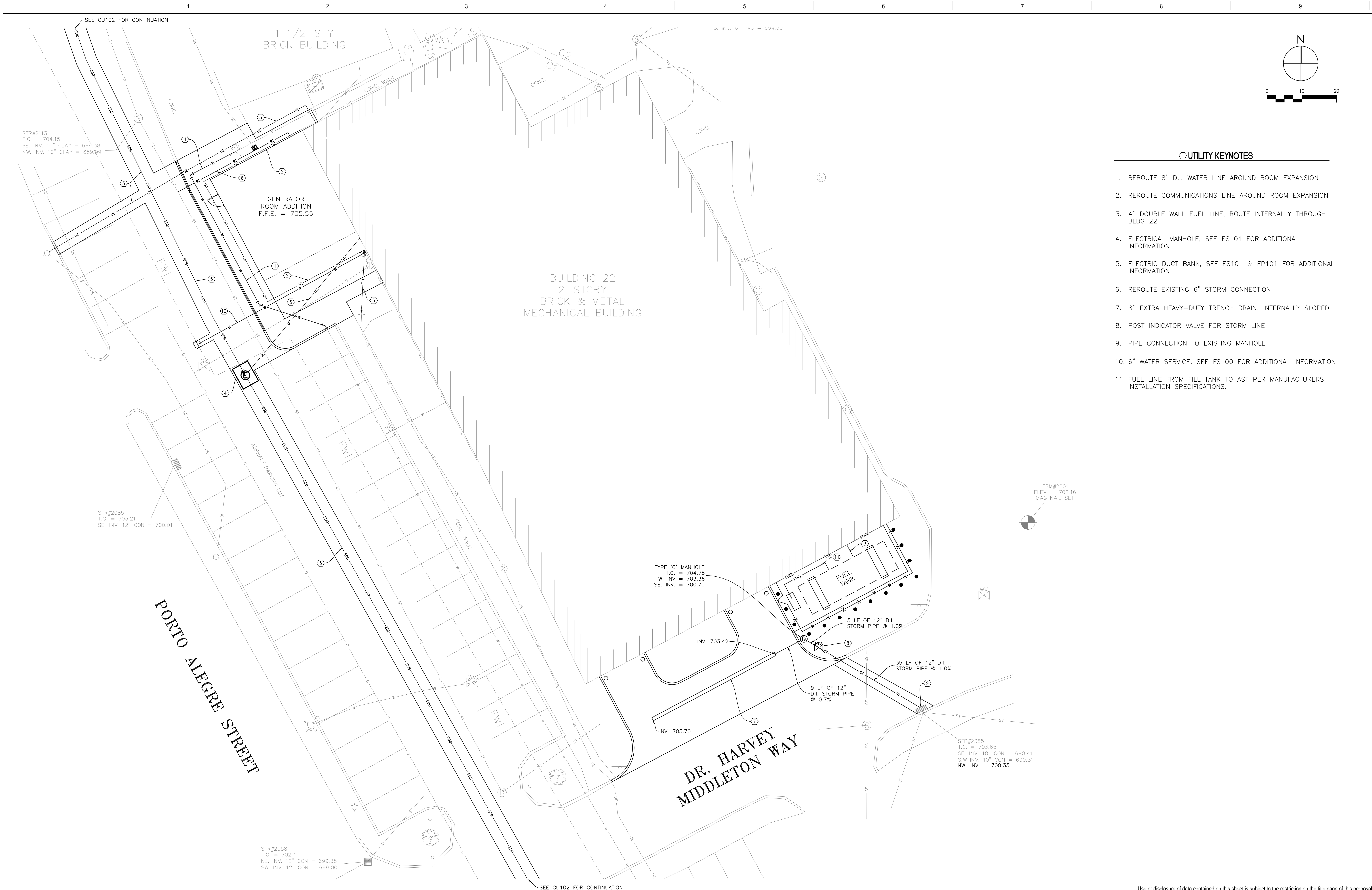

UTILITY KEYNOTES

1. REROUTE 8" D.I. WATER LINE AROUND ROOM EXPANSION
2. REROUTE COMMUNICATIONS LINE AROUND ROOM EXPANSION
3. 4" DOUBLE WALL FUEL LINE, ROUTE INTERNALLY THROUGH BLDG 22
4. ELECTRICAL MANHOLE, SEE ES101 FOR ADDITIONAL INFORMATION
5. ELECTRIC DUCT BANK, SEE ES101 & EP101 FOR ADDITIONAL INFORMATION
6. REROUTE EXISTING 6" STORM CONNECTION
7. 8" EXTRA HEAVY-DUTY TRENCH DRAIN, INTERNALLY SLOPED
8. POST INDICATOR VALVE FOR STORM LINE
9. PIPE CONNECTION TO EXISTING MANHOLE
10. 6" WATER SERVICE, SEE FS100 FOR ADDITIONAL INFORMATION
11. FUEL LINE FROM FILL TANK TO AST PER MANUFACTURERS INSTALLATION SPECIFICATIONS.

100% BID DOCUMENTS FOR CONSTRUCTION 09/23/2016		Revisions: Date	
DEVELOPER/CONTRACTOR:			
ARCHITECT/ENGINEERS:			
905 N Captiol Ave, Suite 100 Indianapolis, IN 46204 United States P: 317 800 6388 F: 317 800 6387 www.GuidonDesign.com			
Drawing Title UTILITY PLAN		Project Title INSTALL PRIMARY AND EMERGENCY POWER SYSTEMS	
Approved:		Location INDIANAPOLIS, INDIANA	
Date 09/23/2016		Checked SLP	
Drawn TPK		Project Number 583-15-102	
Building Number 22		Drawing Number CU101	
Department of Veterans Affairs		Department of Veterans Affairs	



DEVELOPER/CONTRACTOR:



Project Title			Project Number		
INSTALL PRIMARY AND EMERGENCY POWER SYSTEMS			583-15-102		
Location			Building Number		
INDIANAPOLIS, INDIANA			22		
Date		Checked	Drawn		CU501
09/23/2016		SLP	TPK		

