

PROJECT DATA

ALLOWABLE SOIL PRESSURE = 3000 PSF  
SEISMIC IMPORTANCE FACTOR: I=1  
CO-ORDINATES: LATITUDE = 36.77° / LONGITUDE = -119.78°  
SPECTRAL RESPONSE ACCELERATION: S<sub>s</sub> = 0.507 / S<sub>1</sub> = 0.223  
SPECTRAL RESPONSE COEFFICIENTS: S<sub>ds</sub> = 0.41 / S<sub>d1</sub> = 0.290  
SITE COEFFICIENTS: F<sub>o</sub> = 1.394 / F<sub>v</sub> = 1.955  
SEISMIC DESIGN CATEGORY: C  
WIND DESIGN SPEED: 110 MPH – EXP. B

MATERIAL SPECIFICATIONS

ROOF AND SOFFIT PANELS:

PREFINISHED METAL:

ASTM A446--85 Grade C G90 COATING A525-86 CORE STEEL  
OR PREFINISHED GALVALUME – ASTM 792-86 AZ-55

UNFINISHED METAL:

Grade C GALVALUME ASTM 792-86, AZ-55

PURLINS:

ASTM A1011 SS OR HSLAS, CLASS 1, GRADE 55

STRUCTURAL (ROUND) TUBE:

ASTM A500 Gr.B (Fy=42 ksi.)

STRUCTURAL (SQUARE, RECTANGULAR) TUBE:

ASTM A500 Gr.B (Fy=46 ksi.)

BOLTS:

ASTM A307, GRADE A HEX BOLT WITH HEX NUT

WASHERS: TYPE 1 ASTM F436 (IF REQUIRED)

ANCHOR BOLTS: HEX BOLT WITH HEX NUT

PLATE & BASE PLATE:

PLATE ASTM A36, GRADE 50

BASE PLATE SIZES ARE 15"x15"x5/8" THICK UNLESS NOTED

BASE PLATES ARE DESIGNED ASSUMING CONCRETE HAS A  
MINIMUM STRENGTH OF 3000 P.S.I. AT 28 DAYS.

FASTENERS:

ALL SELF-DRILLING AND SELF-TAPPING SHEET METAL SCREWS  
WILL CONFORM TO THE FOLLOWING:

• #10-16x1.5" TEK 2 OR TEK 3 FLAT PHL SCREWS

SELF-DRILL SCREW CONFORMS TO SAE J78-98

• #14x1.5" TEK 2 OR TEK 3 HEX HEAD SELF-DRILL

SCREW CONFORMS TO SAE J78-98

WELD MATERIAL:

E70XX

NOTES:

- [ 8"x3 1/2"x14 Gg PURLIN @ ROOF EDGE
- 8.625"Øx0.188" STEEL COLUMN
- TRUSS #3 – SEE SHEET SF506 FOR TRUSS DETAIL
- RAIN GUTTER AS PER DETAIL
- 1/2" O.S.B. EXPOSURE 1 RATED SHEATHING W/ #10-16 x 1 1/2" FLAT PHL. TEK SCREWS @ 6" O.C. EDGE & 16" O.C. FIELD (TYP) SEE ROOF SHEATHING AND RIB FASTENING PATTERN PLAN FOR MORE INFORMATION
- 24 Gg METAL ROOF OVER TYPE 15 FELT. INSTALL GRACE ICE AND WATER SHIELD MEMBRANE (OR SIMILAR) AT ROOF EDGES AS SHOWN ON DETAIL ABOVE (TYP.)
- 8"x 2 1/2"x16 Gg PURLIN @ 24" O.C. (TYP)
- 24 Gg DRIP FLASHING – SEE DETAILS F/SF506
- DOWNSPOUT AS PER DETAIL (TYP.)

ROOF FRAMING PLAN  
SCALE: 1/4"=1'-0"

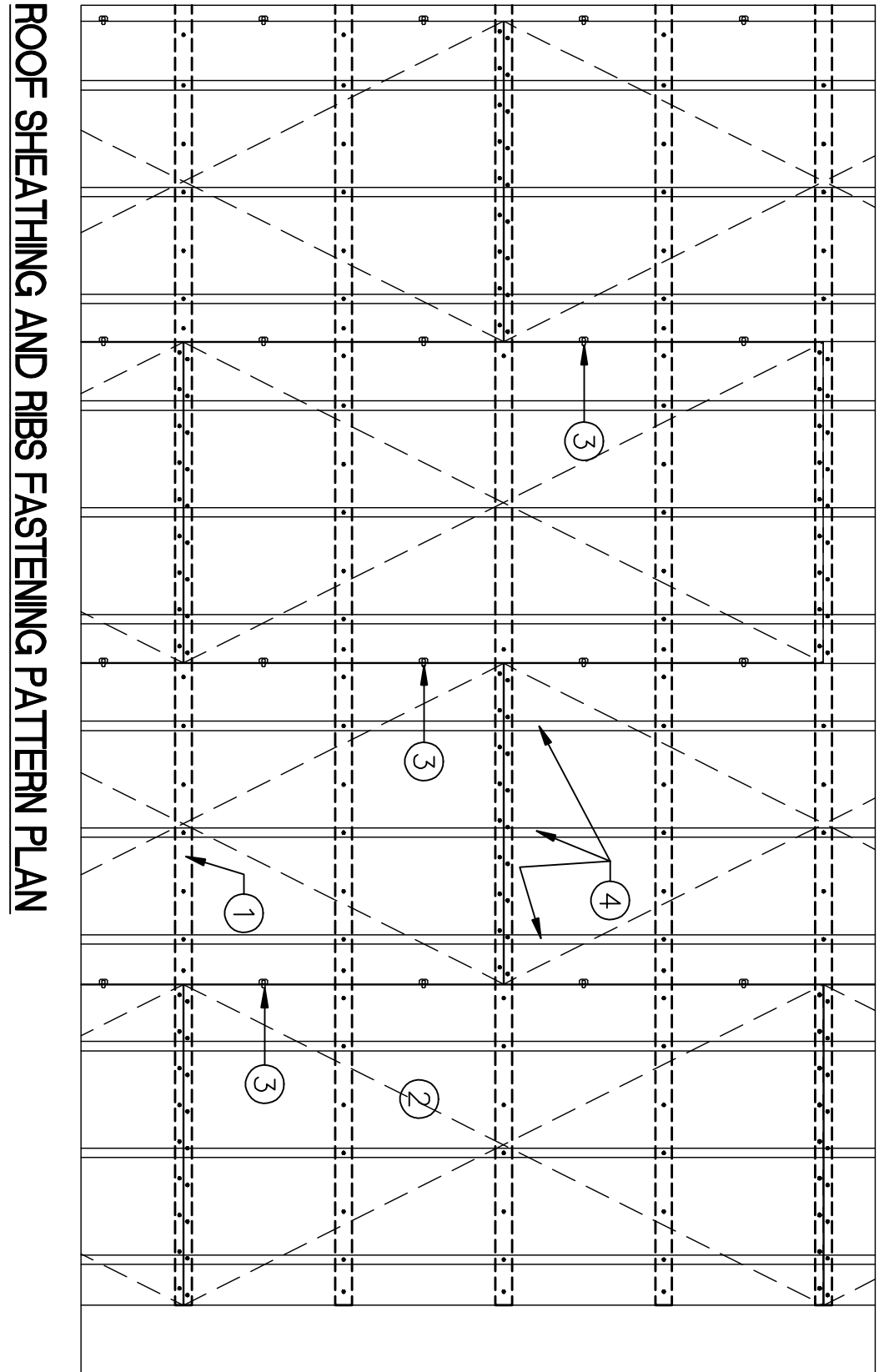
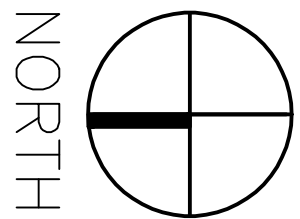

ROOF SHEATHING AND RIBS FASTENING PATTERN PLAN

SCALE: 1/2"=1'-0"

- 1 PURLINS AS PER ROOF FRAMING PLAN
- 2 1/2" O.S.B. EXPOSURE 1 RATED SHEATHING W/ #10-16 x 1 1/2" FLAT PHL. TEK SCREWS @ 6" O.C. EDGE & 16" O.C. FIELD (TYP.) LAY PANELS WITH JOINT STAGGERED WITH EDGE AND ENDS 1/8" AND SREWED OVER BEARING AS ESPECIFIED
- 3 PSC1/2 CLIPS AT SHEATHING UNSUPPORTED EDGES (TYP.)
- 4 CONTINUOUS ZEE-RIB @ 16" O.C. W/ 10-16 X 1 1/2" FLAT PHIL TEK SCREWS @ 24" O.C. (TYP.)

100% SUBMITTAL - FOR CONSTRUCTION

CONSULTANTS:

ARCHITECTS/ENGINEERS:



PAUL L. ENGINEERING, INC.  
944 N. VAN NESS AVE., FRESNO, CA 93728  
PH: (559)237-4408 - FAX: (559)237-4404  
E-MAIL: paulengineering@comcast.net  
www.paulengineering.com

Drawing Title  
WEST PARKING CANOPY  
ROOF FRAMING PLAN

Project Title  
CANOPIES AT ER ENTRANCE AREA  
AND FLAT WORK IMPROVEMENTS

Project Number  
570-11-123  
Building Number  
Building 1

Approved Project Director

Location  
2616 E. Clinton Ave, Fresno, CA  
Date  
06-07-2012

Checked

Drawn

Drawing Number  
SF-102

Office of  
Construction  
and Facilities  
Management  
Department of  
Veterans Affairs

