

A
three inches = one foot
6"

B
one and one half inches = one foot
6"

C
one inch = one foot
6"

D
three quarters inch = one foot
6"

E
one half inch = one foot
6"

F
three eighths inch = one foot
6"

G
one quarter inch = one foot
6"

H
one eighth inch = one foot
6"

I
one sixteenth inch = one foot
6"

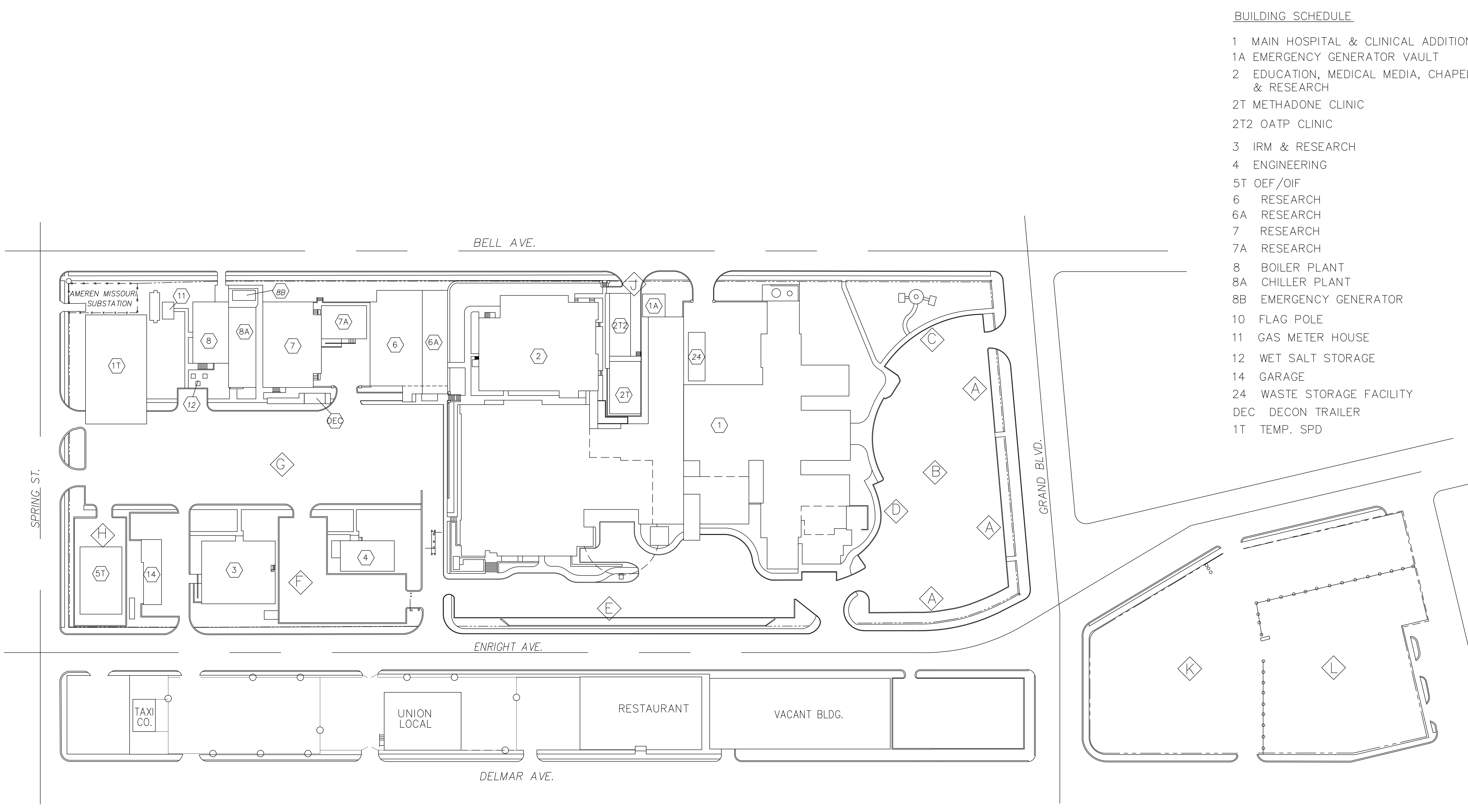

PLOT PLAN

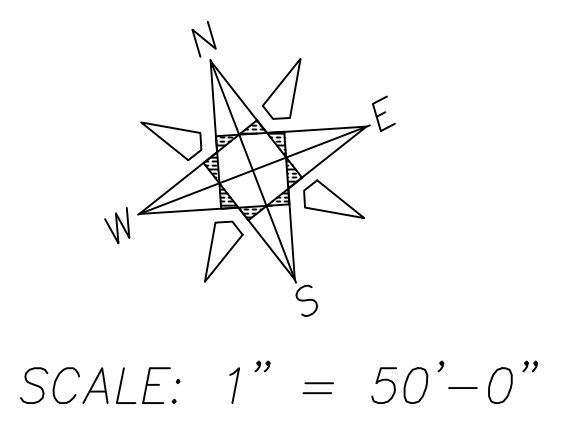

BUILDING SCHEDULE

- 1 MAIN HOSPITAL & CLINICAL ADDITION
- 1A EMERGENCY GENERATOR VAULT
- 2 EDUCATION, MEDICAL MEDIA, CHAPEL & RESEARCH
- 2T METHADONE CLINIC
- 2T2 OATP CLINIC
- 3 IRM & RESEARCH
- 4 ENGINEERING
- 5T OEF/OIF
- 6 RESEARCH
- 6A RESEARCH
- 7 RESEARCH
- 7A RESEARCH
- 8 BOILER PLANT
- 8A CHILLER PLANT
- 8B EMERGENCY GENERATOR
- 10 FLAG POLE
- 11 GAS METER HOUSE
- 12 WET SALT STORAGE
- 14 GARAGE
- 24 WASTE STORAGE FACILITY
- DEC DECON TRAILER
- 1T TEMP. SPD

AS-BUILT

<div>Revisions</div> <table><tr><td> </td><td> </td></tr><tr><td> </td><td> </td></tr><tr><td> </td><td> </td></tr><tr><td> </td><td> </td></tr><tr><td> </td><td> </td></tr></table>											CONSULTANTS:		ARCHITECT/ENGINEERS:		Drawing Title Site Plan		Project Title As-Built Plans		Project Number 000		Office of Construction and Facilities Management Department of Veterans Affairs
								Building Number 00													
						Approved Project Director		Location John Cochran VAHCS		Drawing Number											
								Date June 2012		Checked MH	Drawn KRC										
										G1101 Dwg. # of --											