

TYPICAL CLERESTORY & SOLAR COLLECTORS FRAMING PLAN

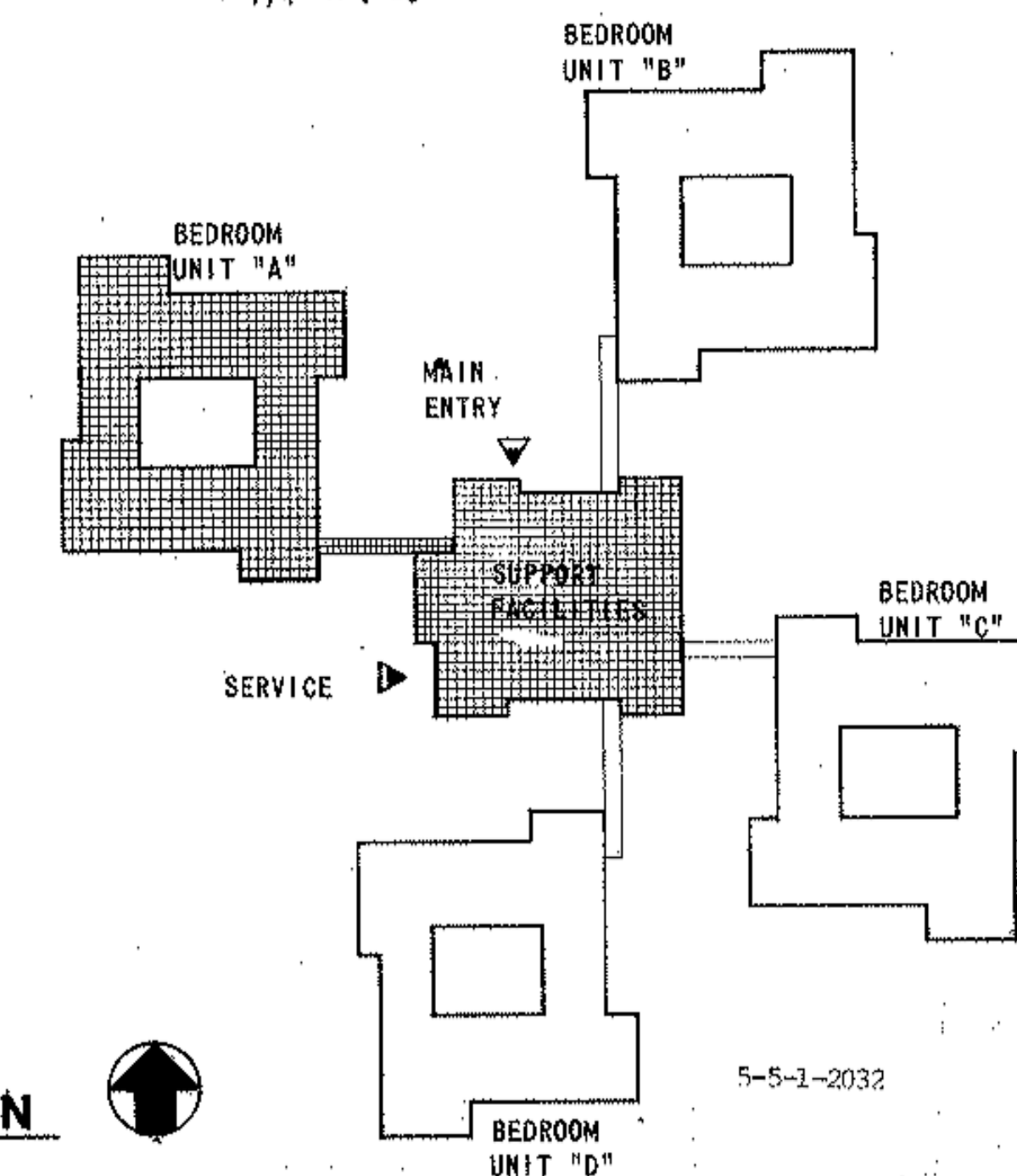

7-17-81 "AS-BUILT"	
NO.	DATE
REVISIONS	
SHEET TITLE	
PROJECT TITLE	
102 200 Bed Domiciliary Building	
DRWN	CHECKED
P.R.L.	K.R.G.
DATE	JUN 19 1978
SHS Associates Inc. Architects, Engineers, Planners	
2600 - 9th Street North St. Petersburg, Florida 33704	
APPROVED	PROJECT NUMBER
102-5	516-053F
VETERANS ADMINISTRATION	
V.A.C. Bay Pines, Florida	

