

# LAYOUT NOTES

1. CONTRACTOR SHALL CONTACT THE CONTRACTING OFFICER'S TECHNICAL REPRESENTATIVE (COTR) REGARDING ANY DISCREPANCIES BETWEEN FIELD CONDITIONS AND PLANS PRIOR TO PROCEEDING WITH WORK. THE WRITTEN DIMENSION SHALL SUPERSEDE THE DRAWN DIMENSION IN CASE OF CONFLICT. ALL FIELD ADJUSTMENTS MUST BE APPROVED BY THE COTR PRIOR TO INSTALLATION.
2. ALL DIMENSIONS ARE TO BACK OF CURB, BACK OF WALK, CENTER LINE, EDGE OF PAVING, UNLESS OTHERWISE NOTED. ALL DIMENSIONS ARE AT 90 DEGREES, UNLESS OTHERWISE NOTED.
3. IN CONSTRUCTING THE NEW CURB AND GUTTER, ALL RADII SHALL BE SMOOTH AND CONTINUOUS AND ALIGNED AS INDICATED.
4. IF DISCREPANCIES BETWEEN FIELD BETWEEN THIS SET OF DRAWINGS AND FIELD CONDITIONS, THE CONTRACTOR SHALL CONTACT THE COTR TO REVIEW PRIOR TO CONSTRUCTION.
5. ALL LANDSCAPE AND SITE AMENITY WORK TO CONFORM TO SPECIFICATIONS.
6. LAYOUT OF SITE ELEMENTS SHALL BE APPROVED BY THE COTR PRIOR TO INSTALLATION.
7. ALL ELEMENTS TO BE INSTALLED PER MANUFACTURER'S RECOMMENDATION.
8. IRRIGATION SLEEVES ARE SHOWN ON THE IRRIGATION PLAN. COORDINATE INSTALLATION OF SLEEVES WITH IRRIGATION WORK.

SECTION NUMBER	"C" CREMAINS SITES 4'X4' (NET)
C1	1,130
TOTAL	1,130

NICHES	1,000
<u>TOTAL</u>	<u>1,000</u>

PHC #3 (Not Shown on this Plan - See Sheet B-1 for Location)  
NORTHERN=778,544.35'  
EASTERN=3,305,031.24'  
ELEVATION=85.80'



Project Title	Date: MARCH 22, 2012
LOUISIANA NATIONAL CEMETERY GRAVESITE EXPANSION PHASE 1B	Project No. 870CM3023B

DRAWING NO.

L-200

Dwg. 16 of 137

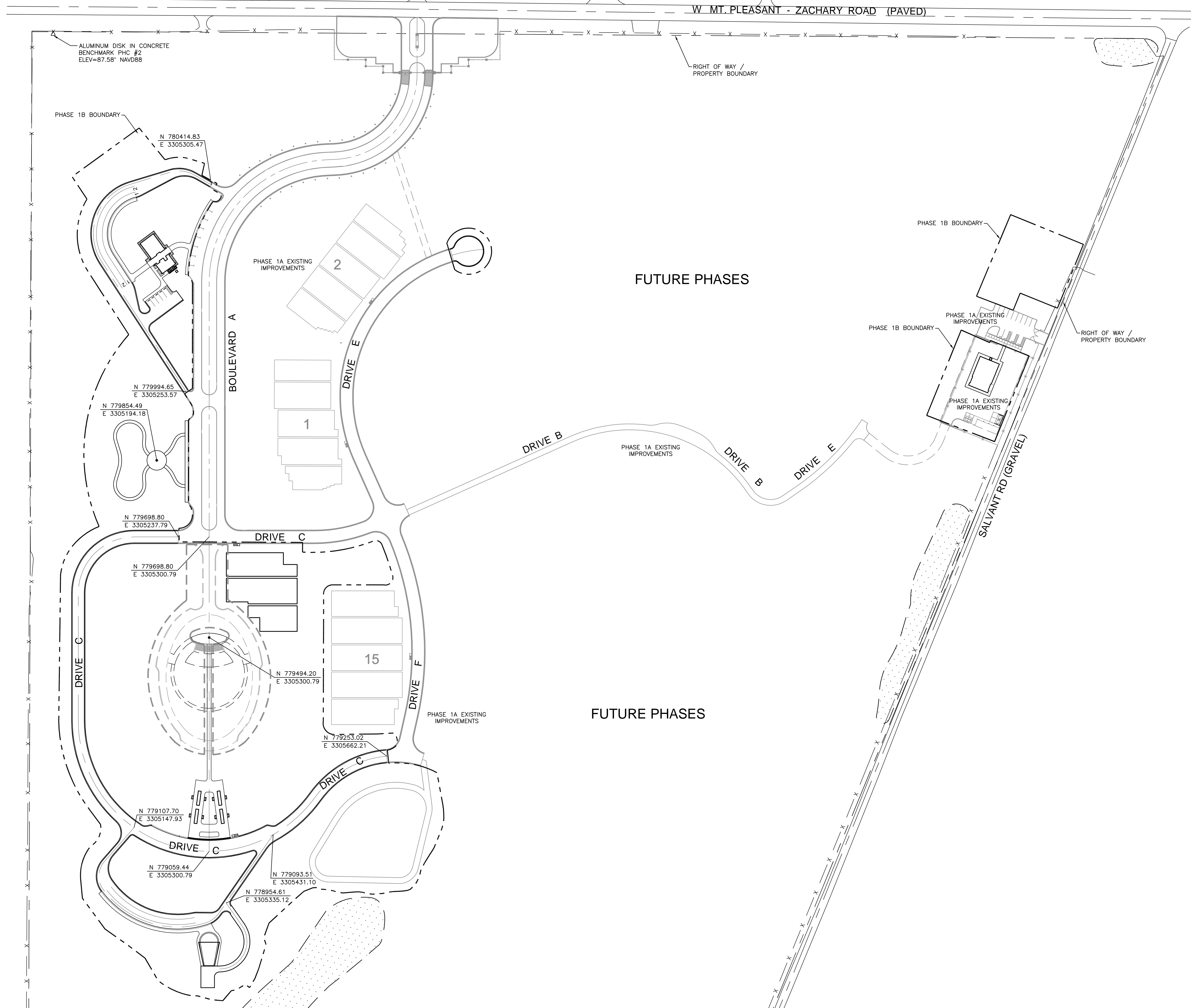

Subcontractor List	
DREYFUSS & BLACKFORD	3540 FOLSOM BOULEVARD, SACRAMENTO, CA 95816 (916) 453-1234
CAPITAL ENGINEERING CONSULTANTS	11020 SUN CENTER DRIVE, RANCHO CORDOVA, CA 95670 (916) 851-3500
ECOM ENGINEERING INC.	1796 TRIBUTE ROAD, SUITE 100 SACRAMENTO, CA (916) 641-5600
BUEHLER & BUEHLER STRUCTURAL ENGINEERS, INC.	600 Q STREET, STE. 200, SACRAMENTO, CA. 95811 (916) 443-0303
W.L. BURLE ENGINEERS, PA	111 S. WALNUT STREET, GREENVILLE, MS 38702 (662) 332-2619
AQUA ENGINEERING, INC.	4803 INNOVATION DRIVE, FORT COLLINS, CO 80525 (970) 229-9668
THE SIERRA WEST GROUP, LLC	2730 GATEWAY OAKS DRIVE, STE. 110 SACRAMENTO, CA. 95833 (916) 925-4000



NATIONAL  
CEMETERY  
ADMINISTRATION

Drawing Title  SITE LAYOUT CONTROL PLAN		Project Title  LOUISIANA NATIONAL CEMETERY GRAVESITE EXPANSION PHASE 1B		Date: MARCH 22, 2012
Approved: Director, Office of Construction Management		Building Number	Checked WMR	Drawn RJMF
Approved: Director, Project Management Service		Location LOUISIANA NATIONAL CEMETERY ZACHARY, LOUISIANA		Project No. 870CM3023B
				DRAWING NO.  L-200  Desg. 16 of 137

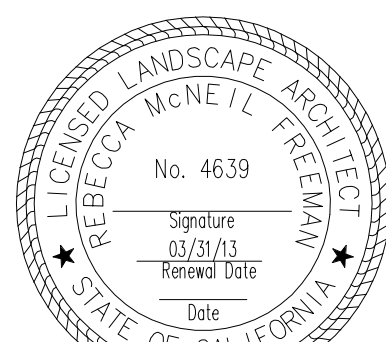

**Carter Burgess**  
A Wholly Owned Subsidiary of Jacobs  
Consultants in Architecture, Engineering,  
Planning, and the Environment  
Sacramento Office  
180 Promenade Circle, Suite 300  
Sacramento, California 95834  
(916) 929-3323 Fax (916) 929-1772