

E1 ADMINISTRATION BUILDING SEPTIC SYSTEM  
1"=20'

F5 MAINTENANCE BUILDING SEPTIC SYSTEM (ADD ALTERNATE #1)  
1"=20'

CONSTRUCTION NOTES

KEY	SITE ELEMENT	DETAIL REFERENCE
A	4" PVC SDR 35 waste line. Length and slope as indicated.	(BT) Y 52 (60) X 60
B	Sanitary sewer cleanout	(R) 2
C	Point of connection to building sewer. Coordinate with plumbing plans.	
D	Remove cap and connect to existing stub.	
E	Enviroserver ES6 Septic effluent storage and treatment tank	
F	Enviroserver ES12 Septic effluent storage and treatment tank	
G	Headworks box and accessories	(F3) R-2
H	Pressure distribution manifold (12" PVC SCH 40)	
I	Return manifold (12" PVC SCH 40)	
J	Performance well (3' of 4" perforated PVC SCH 40)	(F1) R-2
K	Distribution field	
L	Replacement field	
M	1/2" pressurized dripline @ 3' o.c. Cap 4" sewer. Mark with 2"x2" stake painted green.	
O	3" PVC Sleeve	
P	Field selection valve, size to match main. Normally closed where noted "NC".	

LEGEND

●	STORM DRAIN CLEANOUT
○	EXISTING STORM DRAIN CLEANOUT
---	PERFORATED SUBDRAIN
---	EXISTING STORM DRAIN PIPE
---	DOMESTIC WATER PIPE
---	EXISTING DOMESTIC WATER PIPE

NOTES

- PREPARE AND CLEAR AREA AROUND SEPTIC TANK PER MANUFACTURER'S SPECIFICATIONS.
- DO NOT PLANT TREES OR SHRUBS NEAR TANK OR DISPOSAL FIELD.
- ALL MATERIALS USED IN THE SEPTIC SYSTEM MUST BE IAPMO APPROVED AND LISTED.
- SEPTIC TANK TO BE INSTALLED AND MAINTAINED TO PREVENT ENTRANCE OF RAIN, GROUNDWATER, OR SURFACE WATER DRAINAGE.
- ALL SEPTIC TANKS, DISTRIBUTION BOXES, RISERS, SEAMS, JOINTS, AND UNIONS SHALL BE MADE WATERTIGHT.
- TANK SHALL BE PERMANENTLY MARKED WITH CAPACITY AND MANUFACTURER.
- INSPECT TANK PRIOR TO INSTALLATION. TANKS THAT ARE CRACKED, CAVED, OR STRUCTURALLY DEFICIENT SHALL NOT BE ALLOWED.
- AN EFFLUENT FILTER IS REQUIRED AT THE OUTLET OF NEW SEPTIC TANKS.
- PIPES TO HAVE WATERTIGHT JOINTS
- DO NOT COMPACT EARTH WITHIN DISPOSAL AREA
- SCARIFY BOTTOM AND SIDES OF DISPOSAL AREA TRENCHES
- PIPES, JOINTS, AND CONNECTIONS TO MEET MINIMUM STANDARDS OF THE UPC, THE IAPMO, AND THE MANUFACTURER'S SPECIFICATIONS.
- BACKFILL SHALL BE FREE OF LARGE ROCKS AND DEBRIS THAT MAY DAMAGE THE PIPING, JOINTS, AND CONNECTIONS.
- TERMINAL ENDS OF THE PERFORATED PIPE IN THE LEACH LINE SHALL BE CONNECTED TO THE RETURN MANIFOLD.
- ALL CLEANOUTS TO EXTEND TO GRADE AND ALLOW CLEANING IN BOTH DIRECTIONS.
- DO NOT INSTALL SEPTIC SYSTEM DURING SEASONAL WET CONDITIONS.

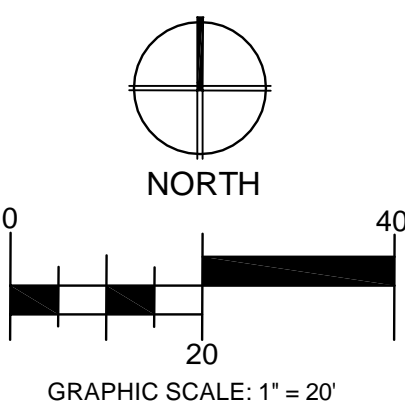

CONSTRUCTION DOCUMENTS

P:\Projects\WUXU0039\Drawings\WUXU0039\UDPA\_CD\A\_PH-BV25-W-1\_Seplic.dwg 3-21-12 11:20:57 AM Greenness

Revisions	Date

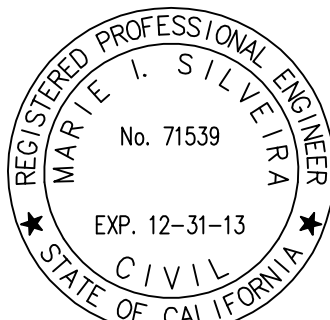

**Carter Burgess**  
A Wholly Owned Subsidiary of Jacobs  
Consultants in Architecture, Engineering,  
Planning, and the Environment  
Sacramento Office  
180 Promenade Circle, Suite 300  
Sacramento, California 95834  
(916) 929-3323 Fax (916) 929-1772

Subconsultant List	
DREYFUSS & BLACKFORD	3540 FOLSOM BOULEVARD, SACRAMENTO, CA 95816 (916) 453-1234
CAPITAL ENGINEERING CONSULTANTS	11020 SUN CENTER DRIVE, RANCHO CORDOVA, CA 95670 (916) 851-3500
ECOM ENGINEERING INC.	1796 TRIBUTE ROAD, SUITE 100 SACRAMENTO, CA (916) 641-5600
BUEHLER & BUEHLER STRUCTURAL ENGINEERS, INC.	600 Q STREET, STE. 200, SACRAMENTO, CA. 95811 (916) 443-0303
W.L. BURLE ENGINEERS, PA	111 S. WALNUT STREET, GREENVILLE, MS 38702 (662) 332-2619
AQUA ENGINEERING, INC.	4803 INNOVATION DRIVE, FORT COLLINS, CO 80525 (970) 229-9668
THE SIERRA WEST GROUP, LLC	2730 GATEWAY OAKS DRIVE, STE. 110 SACRAMENTO, CA. 95833 (916) 925-4000



NATIONAL  
CEMETERY  
ADMINISTRATION

Drawing Title	SEPTIC SYSTEM (BASE BID & ADD-ALTERNATE #1)	
Approved: Director, Office of Construction Management	Building Number	Checked MS
Approved: Director, Project Management Service	Location	Drawn SGA

Project Title	LOUISIANA NATIONAL CEMETERY GRAVESITE EXPANSION PHASE 1B	
Building Number	Checked MS	Drawn SGA
Location	LOUISIANA NATIONAL CEMETERY ZACHARY, LOUISIANA	

Date:	MARCH 22, 2012
Project No.	870CM3023B
DRAWING NO.	W-1
Dwg. 57	Of 137