

IMPORTANT NOTES

1. The ceiling minimum structure capacity must be able to support the load specified on the installation drawing.
2. Electrical power source outlet already available by the facility at a maximum distance of 3 meters from charging station.
3. Any obstructions such as vents, pipes, lights and sprinklers that could possibly be in the path of the ceiling lifts to be removed or relocated by the facility prior to installation.
4. Modifications of door headers by the facility.
5. Arjohuntleigh reserves the right to slightly modify the track layout if necessary.
6. See the "Agreed Conditions for the Installation of Ceiling Lifts" document included with this quote for important installation details.
7. Arjohuntleigh will not be held responsible for any damages, inconvenience, resulting from hitting any non visible conduits during our installation process.
8. Signed drawings are required prior to ordering and installation of ceiling lifts. This signature of each drawings confirms agreement of all the conditions listed above.

MY SIGNATURE BELOW VERIFIES THAT I HAVE:

Reviewed all 7 pages, with a total quantity of 1 rooms, for the approbation of layout for each room and the approbation of structure for each room. I verify that the answers below are accurate to the best of my knowledge and I understand that the quote produced is dependent upon the conditions below as well as this full drawing set.

- Is a load dock available? ☐ YES ☐ NO
- Can facility accept shipment and store until install begins? ☐ YES ☐ NO
- Will a drop trailer be needed? ☐ YES ☐ NO
- Is parking available on site? Is there a fee involved? ☐ YES ☐ NO
- Are there any installation time frame limitations? What are they? ☐ YES ☐ NO
- Is a level of infectious control required? ☐ YES ☐ NO
If YES, then what level _____

CUSTOMER

APPROVAL: _____ DATE: _____

VAMC San Diego 3350 La Jolla Village Drive San Diego, CA 92161

Legend

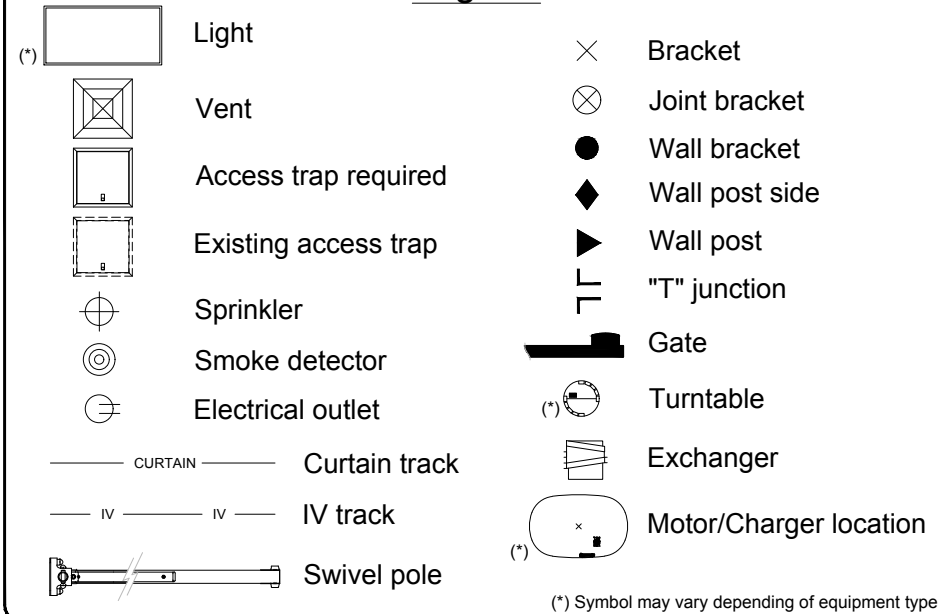

REVISION(S)	DATE(S) (D-M-Y)

INSTALLATION DRAWING

VA SAN DIEGO RADIOLOGY 1813

DISTRIBUTOR :

ARJOHUNTLEIGH

REPRESENTATIVE :

BILL ASHBROOK

DATE (DD-MMM-YYYY) :

19-OCT-2016

REFERENCE # :

QC-10171610

ARJOHUNTLEIGH
GETINGE GROUP

PAGE :

1 / 7

- ALL HARDWARE INCLUDED.
(ACCORDING TO STRUCTURE)

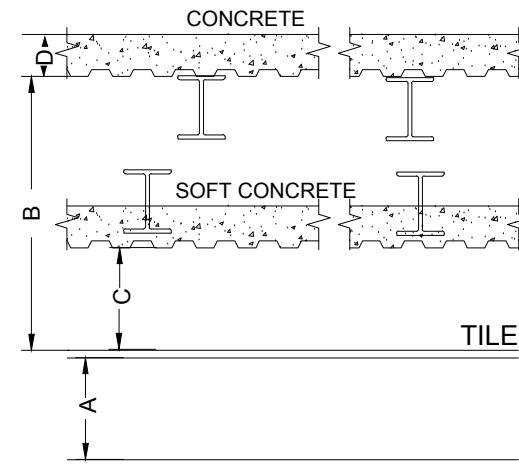
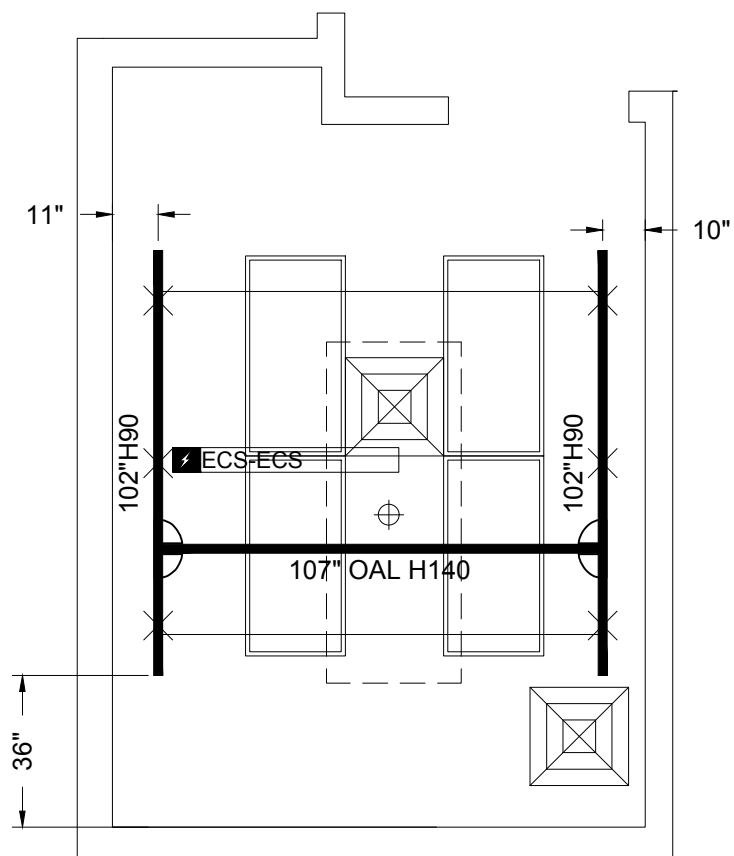

A=108"
B=100"
C=12"
D=5"
F=4"
G=48"
H=4"

ECS SYSTEM

QUANTITY OF ROOMS: 1

LISTING OF ROOM NUMBER(S):
RAD1813

VA SAN DIEGO
RADIOLOGY 1813

SAFE WORKING LOAD BELOW LIFT: 600LBS [272KG]
MINIMUM STRUCTURE CAPACITY: 750LBS [340KG]

DATE CREATED (DD-MMM-YYYY) : 19-OCT-2016

DRAWN BY :
Par

SCALE :
1/4" = 1'

REFERENCE # :
QC-10171610

PAGE :
2 / 7



NOTE: CUTTING OF RAILS ON SITE ONLY

ARJOHUNTLEIGH



Larson

Larson Engineering, Inc.
118 S. Clinton Street, Suite 250
Chicago, Illinois 60661
312.345.0540 Fax: 312.332.1484
www.larsonengr.com
LEI Comm#: 23160004.057

Limited to structural content only
Patient Lift system not by LEI

THIS LAYOUT HAS BEEN PREPARED WITH SUPPLIED DATA.

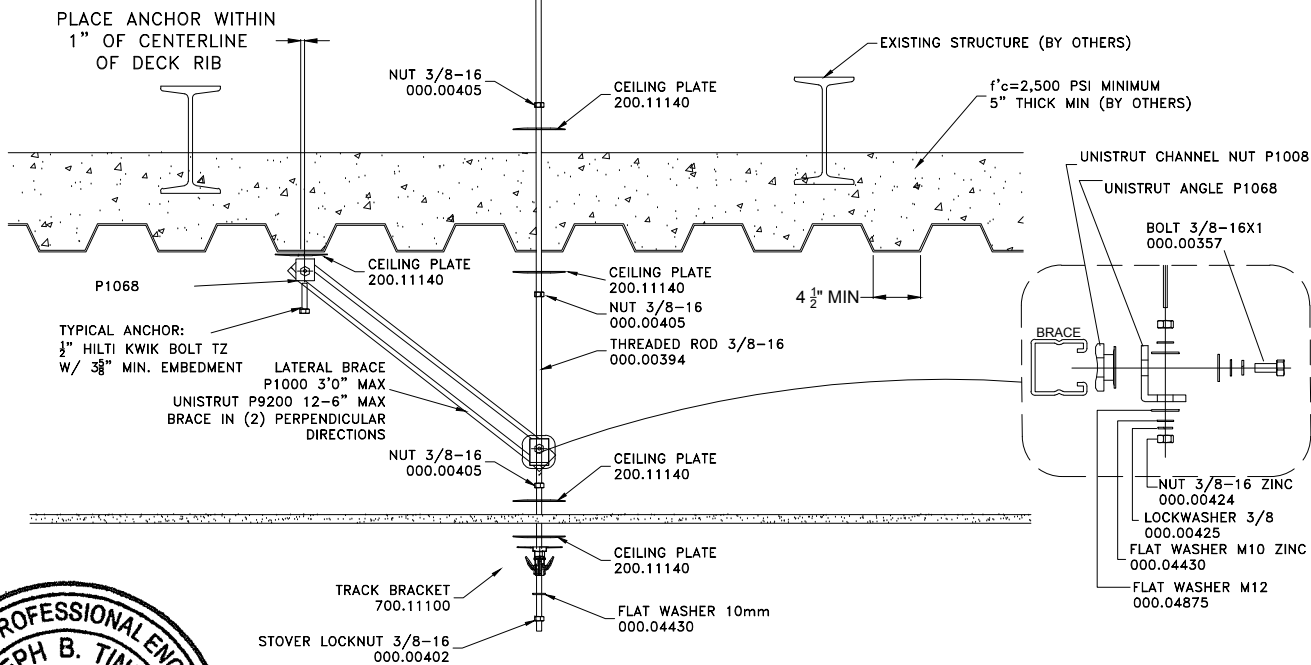
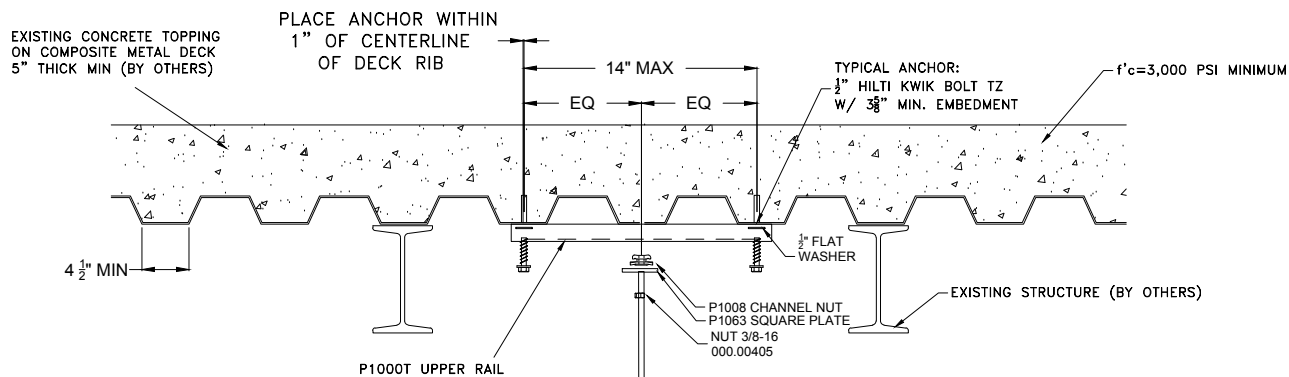

Limited to structural content only
Patient Lift system not by LEI

Larson Engineering, Inc.
118 S. Clinton Street, Suite 250
Chicago, Illinois 60661
312.345.0540 Fax: 312.332.1484
www.larsoneng.com
LEI Comm#: 23160004.057

- ALL HARDWARE INCLUDED.
(ACCORDING TO STRUCTURE)

ALL THREADED RODS SHALL BE ASTM A36 OR BETTER

QUANTITY OF ROOMS: 0

VA SAN DIEGO RADIOLOGY 1813

SAFE WORKING LOAD BELOW LIFT: 600LBS [272KG]
MINIMUM STRUCTURE CAPACITY: 750LBS [340KG]

DATE CREATED (DD-MMM-YYYY): 19-OCT-2016

DRAWN BY:

Par

SCALE:

N/A

REFERENCE #:

QC-10171610

PAGE:

3 / 7

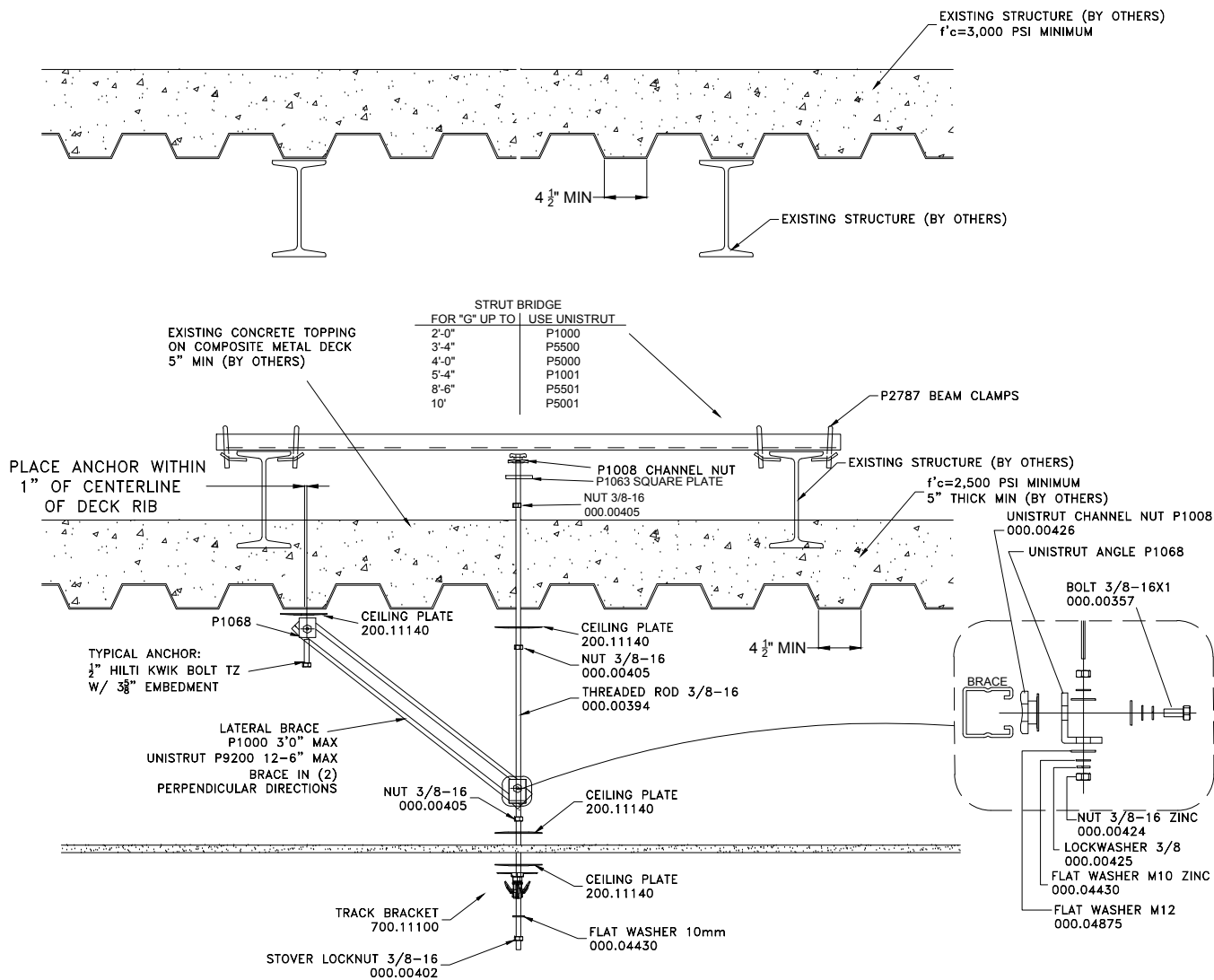

- ALL HARDWARE INCLUDED.
(ACCORDING TO STRUCTURE)
ALL THREADED RODS SHALL BE ASTM A36 OR BETTER

QUANTITY OF ROOMS: 0

VA SAN DIEGO RADIOLOGY 1813

SAFE WORKING LOAD BELOW LIFT: 600LBS [272KG]
MINIMUM STRUCTURE CAPACITY: 750LBS [340KG]

DATE CREATED (DD-MMM-YYYY): 19-OCT-2016

DRAWN BY:	SCALE:
Par	N/A

REFERENCE #:	PAGE:
QC-10171610	4 / 7



Limited to structural content only
Patient Lift system not by LEI

Larson Engineering, Inc.
118 S. Clinton Street, Suite 250
Chicago, Illinois 60661
312.345.0540 Fax: 312.332.1484
www.larsonengr.com
LEI Comm#: 23160004.057

LATERAL BRACE REQUIREMENTS REV-3

- ALL HARDWARE INCLUDED.
(ACCORDING TO STRUCTURE)

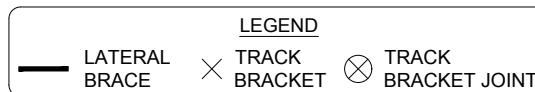
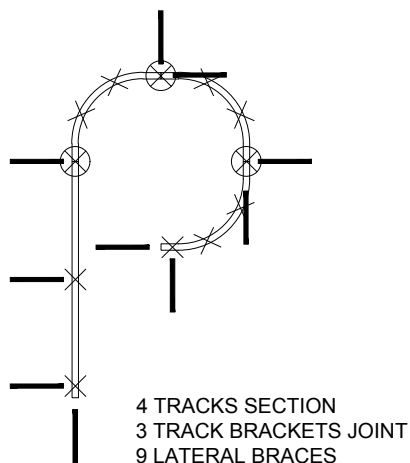
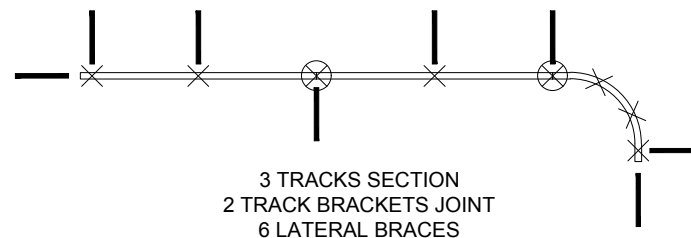
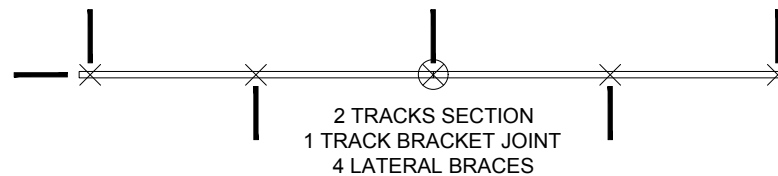
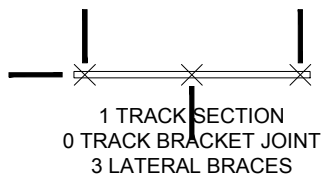

- MINIMUM 3 LATERAL BRACES.
- NUMBER OF LATERAL BRACE = (NUMBER OF TRACK BRACKET JOINT X 2) + 2.

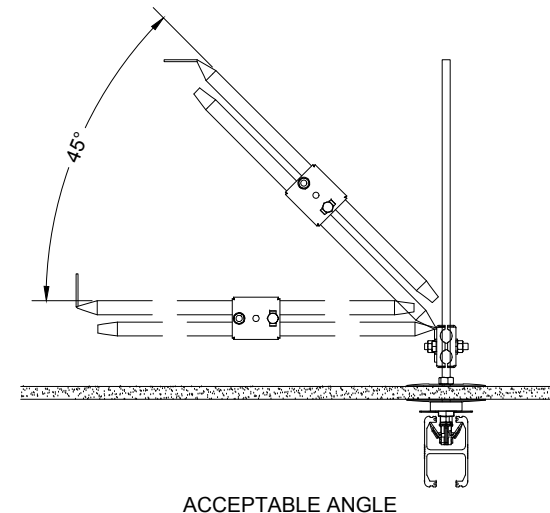

POSSIBLE ANCHOR LATERAL TO THE CEILING OR TO THE WALL

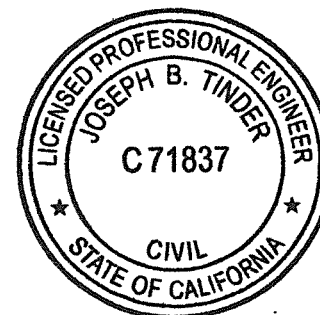
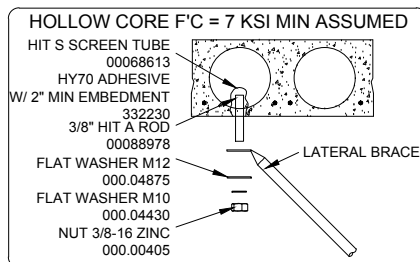
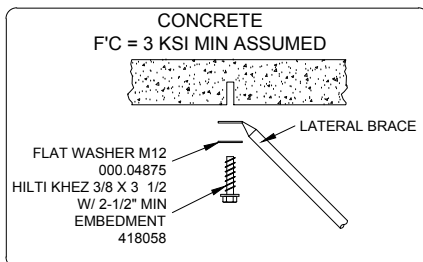
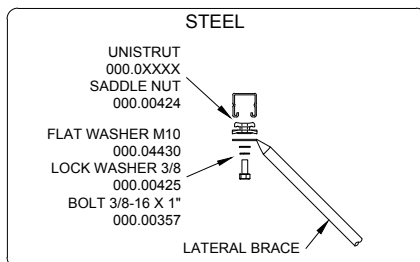
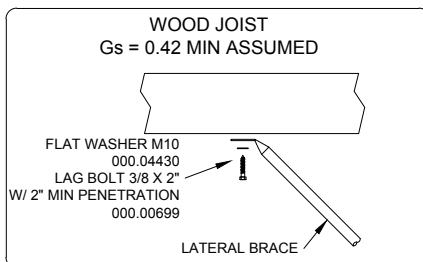

Larson Engineering, Inc.
118 S. Clinton Street, Suite 250
Chicago, Illinois 60661
312.345.0540 Fax: 312.332.1484
www.larsonengr.com
LEI Comm#: 23160004.057

Limited to structural content only
Patient Lift system not by LEI

QUANTITY OF ROOMS:	0
VA SAN DIEGO RADIOLOGY 1813	
SAFE WORKING LOAD BELOW LIFT: 600LBS [272KG]	
MINIMUM STRUCTURE CAPACITY: 750LBS [340KG]	
DATE CREATED (DD-MMM-YYYY) : 19-OCT-2016	
DRAWN BY : Par	SCALE : N/A
REFERENCE # : QC-10171610	PAGE : 5 / 7

BRIDGE DETAIL

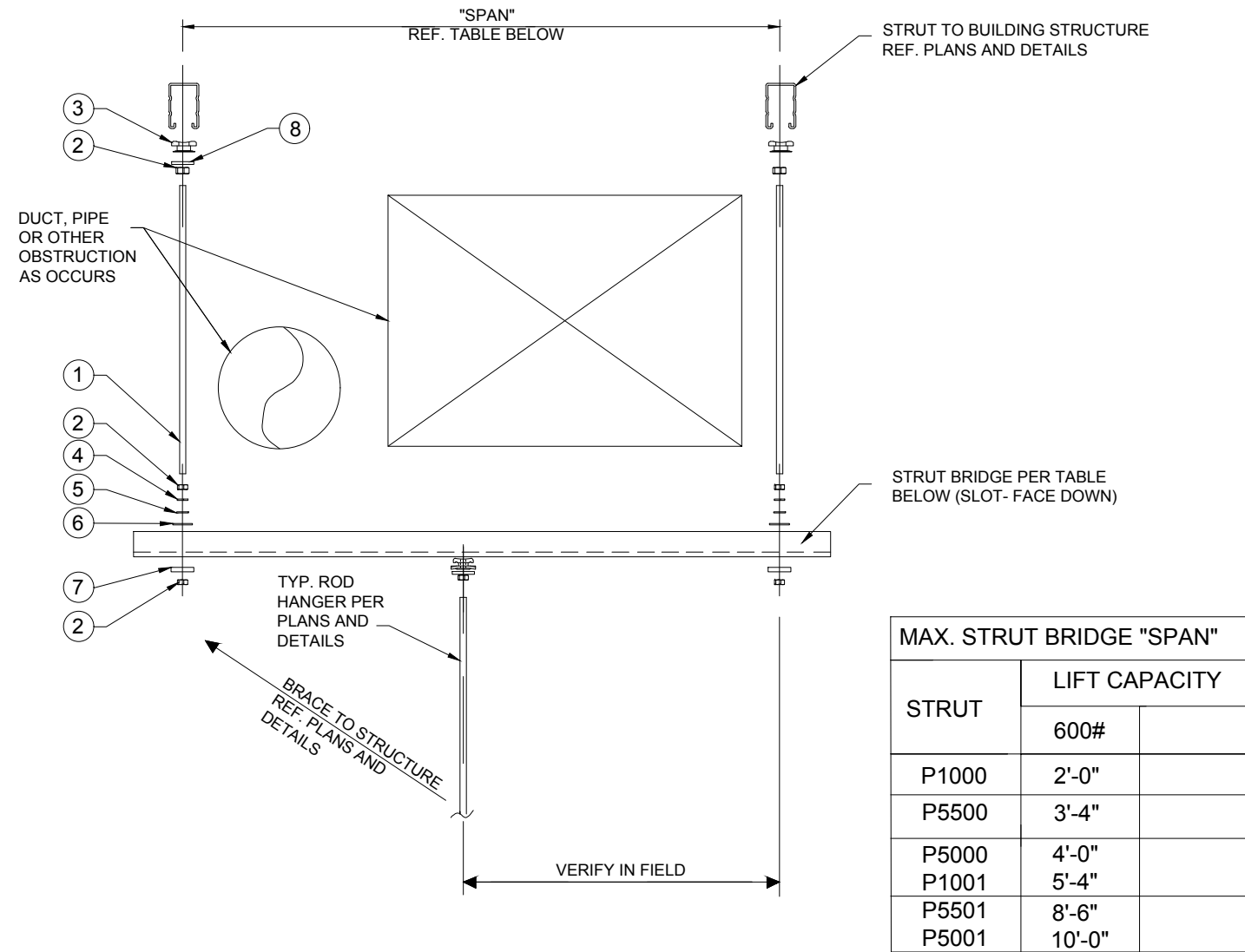

- ALL HARDWARE INCLUDED.
(ACCORDING TO STRUCTURE)

Item #	Part #	Description	Qty
1	000.00394	THREADED ROD 3/8-16 X 10' ZINC	2
2	000.00405	NUT 3/8-16 ZINC	6
3	P1008	CHANNEL NUT 3/8-16	2
4	000.00425	LOCKWASHER 3/8"	2
5	000.04430	FLAT WASHER 3/8" ZINC	2
6	000.04875	FLAT WASHER 3/8"	2
7		1 5/8" SQUARE X 1/4" FLAT PLATE WASHER	2
8	P1063	SQUARE PLATE	2

ALL THREADED RODS SHALL BE ASTM A36 OR BETTER



MAX. STRUT BRIDGE "SPAN"		
STRUT	LIFT CAPACITY	
	600#	
P1000	2'-0"	
P5500	3'-4"	
P5000	4'-0"	
P1001	5'-4"	
P5501	8'-6"	
P5001	10'-0"	

QUANTITY OF ROOMS:	0
VA SAN DIEGO RADIOLOGY 1813	

SAFE WORKING LOAD BELOW LIFT: 600LBS [272KG]
MINIMUM STRUCTURE CAPACITY: 750LBS [340KG]

DATE CREATED (DD-MMM-YYYY) : 19-OCT-2016

DRAWN BY : Par	SCALE : N/A
REFERENCE # : QC-10171610	PAGE : 6 / 7

"NOTE: ARJOHUNTLEIGH GUARANTEES THE STRUCTURAL INTEGRITY OF THE TOTAL LIFT SYSTEM DESIGN, INCLUDING TRACK, BRACING, HANGERS, AND ALL CONNECTIONS TO THE BUILDING STRUCTURE. OUR DESIGN IS BASED ON THE REQUIREMENTS OF THE CURRENT INTERNATIONAL BUILDING CODE (IBC) AND THE SESMIC LOADS OF THE REGION. THE FACILITY MUST VERIFY THE ADEQUACY OF THE BUILDING STRUCTURE TO SUPPORT THE LOADS IMPOSED BY THE LIFT SYSTEM."



Larson

Larson Engineering, Inc.
118 S. Clinton Street, Suite 250
Chicago, Illinois 60661
312.345.0540 Fax: 312.332.1484
www.larsonengr.com
LEI Comm#: 23160004.057

Limited to structural content only
Patient Lift system not by LEI

ECS - ECS CHARGING

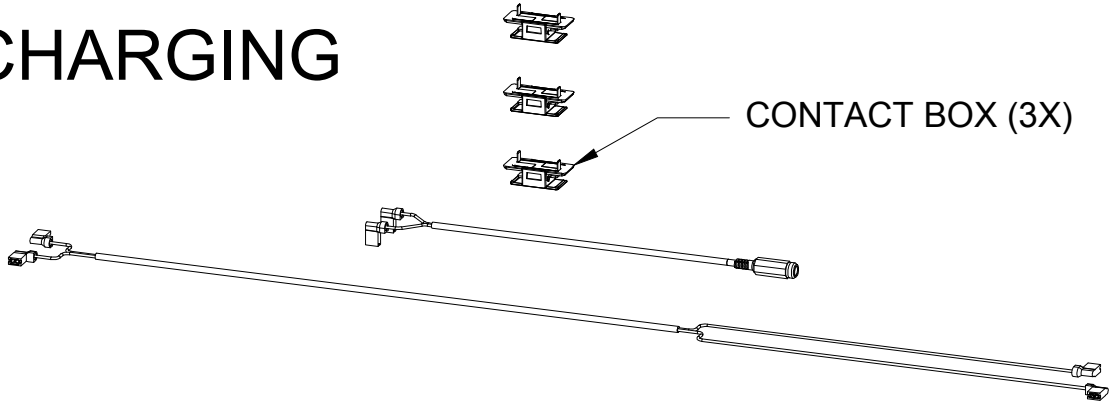

700-11228 - ECS to ECS wiring kit

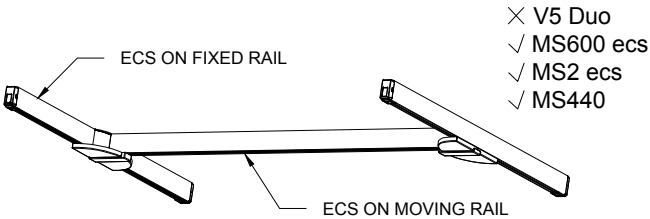

FLUSH X-Y CONFIG.

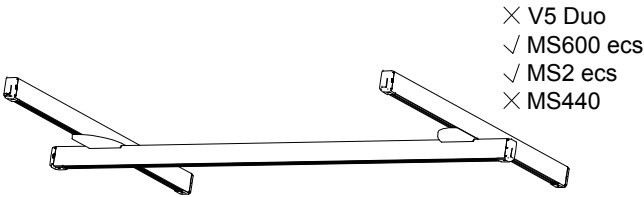

STANDARD X-Y CONFIG.

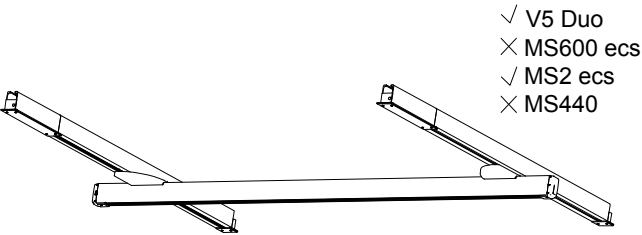

EMBEDDED X-Y CONFIG.



WALL MOUNTED X-Y CONFIG.

QUANTITY OF ROOMS: **Z**

**VA SAN DIEGO
RADIOLOGY 1813**

SAFE WORKING LOAD BELOW LIFT: 600LBS [272KG]
MINIMUM STRUCTURE CAPACITY: 750LBS [340KG]

DATE CREATED (DD-MMM-YYYY) : 19-OCT-2016

DRAWN BY :
Par

SCALE :
N/A

REFERENCE # :
QC-10171610

PAGE :
7 / 7