

A

three inches = one foot

B

one and one half inches = one foot

C

one inch = one foot

D

three quarters inch = one foot

E

one half inch = one foot

F

three eighths inch = one foot

one quarter inch = one foot

one eighth inch = one foot

### EQUIPMENT SCHEDULE - BUILDING 1

| ROOM NO. | ROOM NAME                   | QUANTITY | DESCRIPTION                           | MANUFACTURER | RESPONSIBILITY |      |      |      | UTILITY REQUIRED |       |      | REMARKS |         |
|----------|-----------------------------|----------|---------------------------------------|--------------|----------------|------|------|------|------------------|-------|------|---------|---------|
|          |                             |          |                                       |              | CFCI           | OFCI | OFOI | OFVI | MECH             | PLUMB | ELEC |         |         |
| B1000    | ITS Service Center Workshop | 1        | PHYSICAL ACCESS CONTROL SYSTEM (PACS) |              | ●              |      |      |      |                  |       |      | ●       | 1 5 6 7 |
|          |                             | 1        | CCTV CAMERA                           |              | ●              |      |      |      |                  |       |      | ●       | 3 5 6 7 |
| B121     | Dietary Kitchen Entrance    | 1        | PHYSICAL ACCESS CONTROL SYSTEM (PACS) |              | ●              |      |      |      |                  |       |      | ●       | 1 5 6 7 |
| B122     | Dietary Kitchen Entrance    | 1        | PHYSICAL ACCESS CONTROL SYSTEM (PACS) |              | ●              |      |      |      |                  |       |      | ●       | 1 5 6 7 |
| B125B    | Dietary Kitchen Entrance    | 1        | PHYSICAL ACCESS CONTROL SYSTEM (PACS) |              | ●              |      |      |      |                  |       |      | ●       | 1 5 6 7 |
| B128     | Dietary Kitchen Entrance    | 1        | PHYSICAL ACCESS CONTROL SYSTEM (PACS) |              | ●              |      |      |      |                  |       |      | ●       | 1 5 6 7 |
| B239     | Morgue                      | 1        | PHYSICAL ACCESS CONTROL SYSTEM (PACS) |              | ●              |      |      |      |                  |       |      | ●       | 1 5 6 7 |
| B251     | Mechanical Room             | 1        | PHYSICAL ACCESS CONTROL SYSTEM (PACS) |              | ●              |      |      |      |                  |       |      | ●       | 1 5 6 7 |
| B165     | Telephone Switch Room       | 1        | PHYSICAL ACCESS CONTROL SYSTEM (PACS) |              | ●              |      |      |      |                  |       |      | ●       | 1 5 6 7 |
|          |                             | 1        | CCTV CAMERA                           |              | ●              |      |      |      |                  |       |      | ●       | 3 5 6 7 |
| B217B    | Escort                      | 1        | PHYSICAL ACCESS CONTROL SYSTEM (PACS) |              | ●              |      |      |      |                  |       |      | ●       | 1 5 6 7 |
| B135     | Basement West               | 1        | PHYSICAL ACCESS CONTROL SYSTEM (PACS) |              | ●              |      |      |      |                  |       |      | ●       | 1 5 6 7 |
| B108A    | Canteen Storage Area        | 1        | PHYSICAL ACCESS CONTROL SYSTEM (PACS) |              | ●              |      |      |      |                  |       |      | ●       | 1 5 6 7 |
| B172     | Warehouse Storage           | 1        | PHYSICAL ACCESS CONTROL SYSTEM (PACS) |              | ●              |      |      |      |                  |       |      | ●       | 1 5 6 7 |
| B223     | New Linen Storage           | 1        | PHYSICAL ACCESS CONTROL SYSTEM (PACS) |              | ●              |      |      |      |                  |       |      | ●       | 1 5 6 7 |
| B233A    | New Linen Storage           | 1        | PHYSICAL ACCESS CONTROL SYSTEM (PACS) |              | ●              |      |      |      |                  |       |      | ●       | 1 5 6 7 |
| B194     | Radiation                   | 1        | PHYSICAL ACCESS CONTROL SYSTEM (PACS) |              | ●              |      |      |      |                  |       |      | ●       | 1 5 6 7 |
| B177     | IT Room                     | 1        | PHYSICAL ACCESS CONTROL SYSTEM (PACS) |              | ●              |      |      |      |                  |       |      | ●       | 1 5 6 7 |

#### LEGEND:

|      |  |
|------|--|
| CFI  | CONTRACTOR FURNISHED CONTRACTOR INSTALLED  |
| OFI  | OWNER FURNISHED CONTRACTOR INSTALLED       |
| OFI  | OWNER FURNISHED OWNER INSTALLED            |
| OFI  | OWNER FURNISHED VENDOR INSTALLED           |
| PACS | PHYSICAL ACCESS CONTROL SYSTEM             |
| CCTV | CLOSED CIRCUIT TELEVISION CAMERA           |
| DSPI | DURESS, SECURITY PHONES, & INTERCOM SYSTEM |
| IDS  | INTRUSION DETECTION SYSTEM                 |

#### EQUIPMENT NOTES:

- PACS – CONTRACTOR SHALL VERIFY WITH OWNER THAT PACS EQUIPMENT IS COMPATIBLE WITH EXISTING SECURITY SUBSYSTEMS USING DIRECT HARDWARE OR COMPUTER INTERFACE. PACS SHALL HAVE THE CAPABILITY TO BE INTEGRATED WITH CARD READERS, KEYPADS, BIOMETRICS, ELECTROMAGNETIC LOCKS AND STRIKES, AND THE VA SECURITY MANAGEMENT SYSTEM.
- ALARM SYSTEM – CONTRACTOR SHALL VERIFY WITH OWNER THAT INTRUSION & PANIC ALARM EQUIPMENT IS COMPATIBLE WITH OTHER SECURITY SUBSYSTEMS USING DIRECT HARDWARE OR COMPUTER INTERFACE. INTRUSION DETECTION & INTERCOM SYSTEMS SHALL HAVE THE CAPABILITY TO BE INTEGRATED WITH DSPI, PACS, AND CCTV SYSTEMS.
- CCTV – CONTRACTOR SHALL VERIFY WITH OWNER THAT CCTV CAMERA EQUIPMENT IS COMPATIBLE WITH THE EXISTING VA IP MEGAPIXEL CAMERAS, SERVERS, AND ENCODERS AND TIE INTO EXISTING CAMERA SUBSYSTEMS. THE CCTV SYSTEM INCLUDES CAMERAS, MONITORS, CONTROLLING & RECORDING EQUIPMENT, AND CENTRALIZED MANAGEMENT & OPERATION OF THE SYSTEM.
- DRUG CABINET –CONTRACTOR SHALL PROVIDE ANCHORAGE TO FLOOR AS NECESSARY AND RECOMMENDED BY EQUIPMENT MANUFACTURER.
- ALL EQUIPMENT SHALL BE FROM BASIS OF DESIGN "OR EQUAL".
- TYPE: CONTRACTOR SHALL COORDINATE EQUIPMENT PROGRAMMING & TESTING W/VA 'PROJECT' PHYSICAL SECURITY SPECIALIST.
- TYPE: CONTRACTOR SHALL VERIFY EXISTING POWER SUPPLY IS SUFFICIENT FOR PACS, CCTV, DSPI & IDS SYSTEM,S; AND INSTALL ADDITIONAL POWER SYSTEMS AS NEEDED.

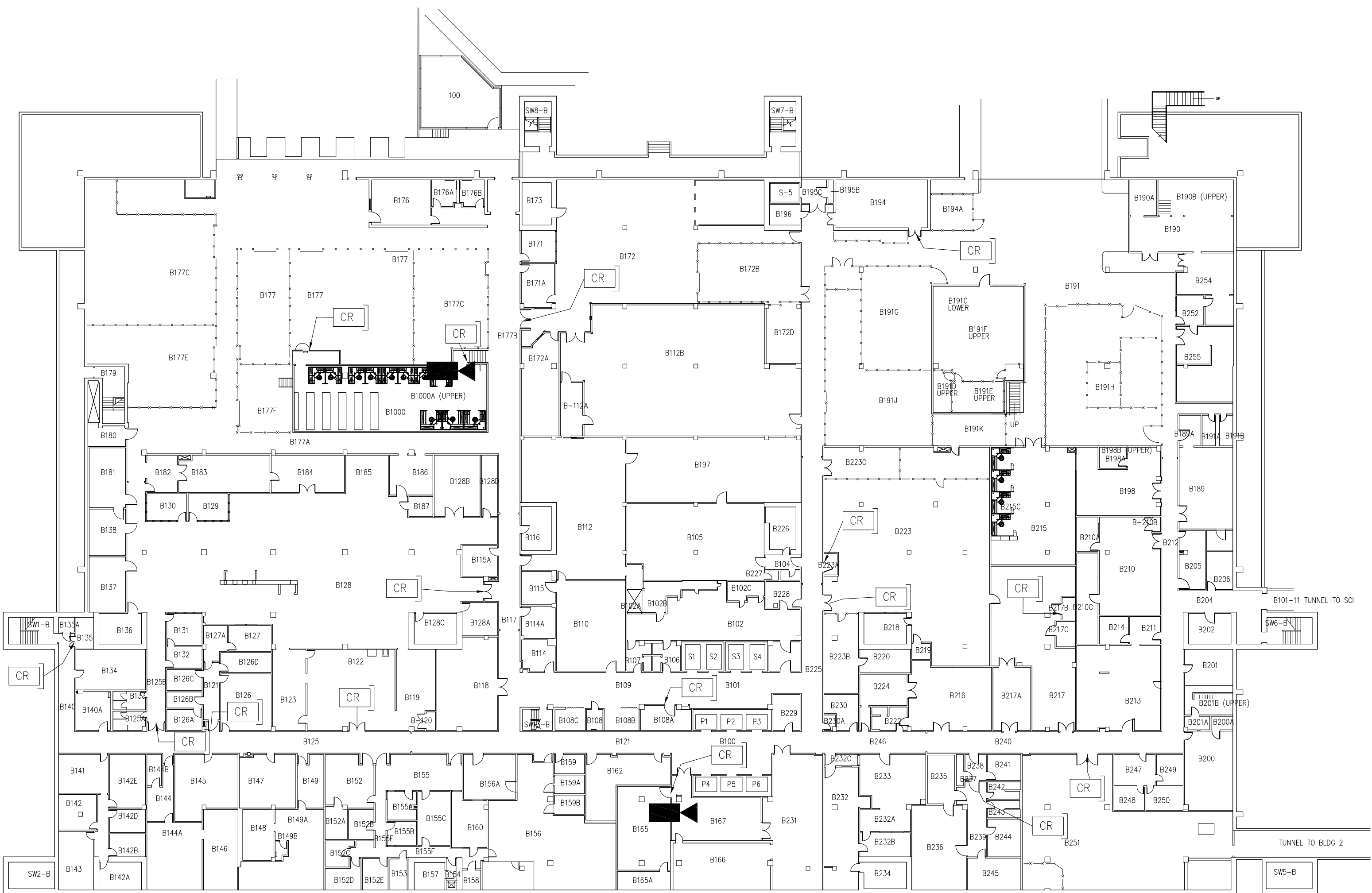

### NOTES

### LEGEND

- NEW FIXED CCTV CAMERA IN HOUSING (CCTV)
- CARD READER / PIV / (PACS) (SEE 1/GN-002)

NOTE: CONTRACTOR SHALL FIELD VERIFY ALL EXISTING CONDITIONS AND DIMENSIONS PRIOR TO CONSTRUCTION. COORD. W/ VA ENGINEERING SERVICES IN THE EVENT OF A DISCREPANCY. EXECUTION OF THE WORK SHALL INDICATE ACCEPTANCE OF THE EXISTING CONDITIONS.

### KEY PLAN

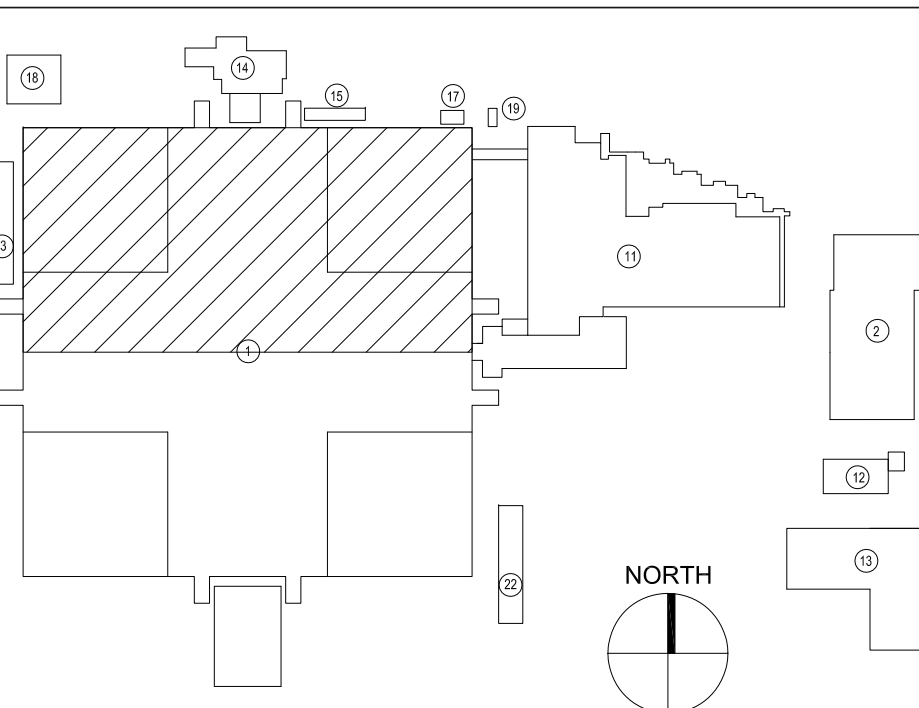

1 EQUIPMENT SCHEDULE

2 BASEMENT FLOOR PLAN

SCALE: 1/8" = 1'-0"

| Number | Revisions | Date |
|--------|-----------|------|
|        |           |      |
|        |           |      |
|        |           |      |
|        |           |      |
|        |           |      |
|        |           |      |
|        |           |      |
|        |           |      |
|        |           |      |
|        |           |      |

CONTRACTOR:

ARCHITECT/ENGINEERS:



Drawing Title  
BUILDING 1 BASEMENT FLOOR PLAN

Approved: Project Director

Project Title  
CONTROLLED ACCESS  
VA SAN DIEGO

Location  
SAN DIEGO, CA

Date  
05/04/2017

Checked

Drawn

YNP

664-17-405

Building Number

1

Drawing Number

AE-100

Dwg 3 of 12

Office of  
Construction  
and Facilities  
Management

