

## STEEL CASEWORK BASE CABINETS - STANDING HEIGHT

### Open Units



Width	Item Number
15"	1910000
18"	1110000
24"	1210000
30"	1310000
36"	1410000
42"	1810000
48"	1510000
513mm	1610000
1000mm	1710000



### Full Door Units



up to 24" wide



30" and wider

Width	Right Hinged	Left Hinged	# of Doors
12"	1010011	1010211	1
15"	1910011	1910211	1
18"	1110011	1110211	1
24"	1210011	1210211	1
30"	1310011	-	2
36"	1410011	-	2
42"	1810011	-	2
48"	1510011	-	2
513mm	1610011	1610211	1
1000mm	1710011	-	2

### Door/Drawer Units



up to 24" wide



30" and wider

Width	Right Hinged	Left Hinged	# of Doors
12"	1010022	1010222	1
15"	1910022	1910222	1
18"	1110022	1110222	1
24"	1210022	1210222	1
30"	1310022	-	2
36"	1410022	-	2
42"	1810022	-	2
48"	1510022	-	2
513mm	1610022	1610222	1
1000mm	1710022	-	2



up to 24" wide



30" and wider

Width	Right Hinged	Left Hinged	# of Doors
15"	1910033	1910233	1
18"	1110033	1110233	1
24"	1210033	1210233	1
30"	1310033	-	2
36"	1410033	-	2
42"	1810033	-	2
48"	1510033	-	2
513mm	1610033	1610233	1
1000mm	1710033	-	2

## STEEL CASEWORK BASE CABINETS - STANDING HEIGHT

### Door/Drawer Units



Width	Item Number
30"	1310093
36"	1410093
42"	1810093
48"	1510093
1000mm	1710093



Width	Item Number
30"	1310096
36"	1410096
42"	1810096
48"	1510096
1000mm	1710096



Width	Left Hand	Right Hand
30"	1310023	1310032
36"	1410023	1410032
42"	1810023	1810032
48"	1510023	1510032
1000mm	1710023	1710032

- Left hand Door/Drawer Unit shown.
- Right hand Door/Drawer Units are reverse of what is shown.



Width	Left Hand	Right Hand
30"	1310012	1310021
36"	1410012	1410021
42"	1810012	1810021
48"	1510012	1510021
1000mm	1710012	1710021

- Left hand Door/Drawer Unit shown.
- Right hand Door/Drawer Units are reverse of what is shown.



Width	Left Hand	Right Hand
30"	1310013	1310031
36"	1410013	1410031
42"	1810013	1810031
48"	1510013	1510031
1000mm	1710013	1710031

- Left hand Door/Drawer Unit shown.
- Right hand Door/Drawer Units are reverse of what is shown.

## STEEL CASEWORK BASE CABINETS - STANDING HEIGHT

### Door/Drawer Units



Width	Left Hand	Right Hand
30"	1310037	1310073
36"	1410037	1410073
42"	1810037	1810073
48"	1510037	1510073
1000mm	1710037	1710073

- Left hand Door/Drawer Unit shown.
- Right hand Door/Drawer Units are reverse of what is shown.



Width	Left Hand	Right Hand
30"	1310038	1310083
36"	1410038	1410083
42"	1810038	1810083
48"	1510038	1510083
1000mm	1710038	1710083

- Left hand Door/Drawer Unit shown.
- Right hand Door/Drawer Units are reverse of what is shown.
- If locks are required, the lowest drawer of the cabinet will require a slot in the bottom of the drawer body to accommodate the lock cam.

### Drawer Units



up to 24" wide



30" and wider

Width	Item Number
12"	1010090
15"	1910090
18"	1110090
24"	1210090
30"	13100NN
36"	14100NN
42"	18100NN
48"	15100NN
513mm	1610090
1000mm	17100NN



up to 24" wide



30" and wider

Width	Item Number
12"	1010044
15"	1910044
18"	1110044
24"	1210044
30"	1310044
36"	1410044
42"	1810044
48"	1510044
513mm	1610044
1000mm	1710044

## STEEL CASEWORK BASE CABINETS - SITTING HEIGHT

### Open Units



Width	Item Number
15"	1920000
18"	1120000
24"	1220000
30"	1320000
36"	1420000
42"	1820000
48"	1520000
513mm	1620000
1000mm	1720000

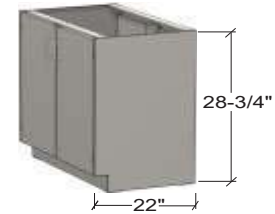

### Full Door Units



up to 24" wide



30" and wider

Width	Right Hinged	Left Hinged	# of Doors
12"	1020011	1020211	1
15"	1920011	1920211	1
18"	1120011	1120211	1
24"	1220011	1220211	1
30"	1320011	-	2
36"	1420011	-	2
42"	1820011	-	2
48"	1520011	-	2
513mm	1620011	1620211	1
1000mm	1720011	-	2

### Door/Drawer Units



up to 24" wide



30" and wider

Width	Right Hinged	Left Hinged	# of Doors
12"	1020022	1020222	1
15"	1920022	1920222	1
18"	1120022	1120222	1
24"	1220022	1220222	1
30"	1320022	-	2
36"	1420022	-	2
42"	1820022	-	2
48"	1520022	-	2
513mm	1620022	1620222	1
1000mm	1720022	-	2



up to 24" wide



30" and wider

Width	Right Hinged	Left Hinged	# of Doors
15"	1920033	1920233	1
18"	1120033	1120233	1
24"	1220033	1220233	1
30"	1320033	-	2
36"	1420033	-	2
42"	1820033	-	2
48"	1520033	-	2
513mm	1620033	1620233	1
1000mm	1720033	-	2

## STEEL CASEWORK BASE CABINETS - SITTING HEIGHT

### Door/Drawer Units



Width	Left Hand	Right Hand
30"	1320014	1320041
36"	1420014	1420041
42"	1820014	1820041
48"	1520014	1520041
1000mm	1720014	1720041

- Left hand Door/Drawer Unit shown.
- Right hand Door/Drawer Units are reverse of what is shown.



Width	Left Hand	Right Hand
30"	1320015	1320051
36"	1420015	1420051
42"	1820015	1820051
48"	1520015	1520051
1000mm	1720015	1720051

- Left hand Door/Drawer Unit shown.
- Right hand Door/Drawer Units are reverse of what is shown.



Width	Left Hand	Right Hand
30"	1320016	1320061
36"	1420016	1420061
42"	1820016	1820061
48"	1520016	1520061
1000mm	1720016	1720061

- Left hand Door/Drawer Unit shown.
- Right hand Door/Drawer Units are reverse of what is shown.



Width	Left Hand	Right Hand
30"	1320924	1320942
36"	1420924	1420942
42"	1820924	1820942
48"	1520924	1520942
1000mm	1720924	1720942

- Left hand Door/Drawer Unit shown.
- Right hand Door/Drawer Units are reverse of what is shown.



Width	Left Hand	Right Hand
30"	1320024	1320042
36"	1420024	1420042
42"	1820024	1820042
48"	1520024	1520042
1000mm	1720024	1720042

- Left hand Door/Drawer Unit shown.
- Right hand Door/Drawer Units are reverse of what is shown.

## STEEL CASEWORK SUSPENDED CABINETS

### Open Units

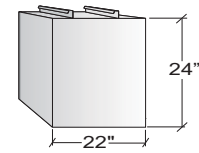
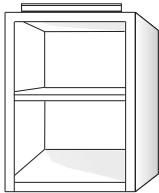

**Note:** Add Option Code 15 to order a finished back on these units.

Width	Item Number
15"	1950000
18"	1150000
24"	1250000
30"	1350000
36"	1450000
42"	1850000
48"	1550000
513mm	1650000
1000mm	1750000

### Full Door Units

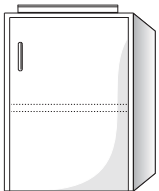

up to 24" wide

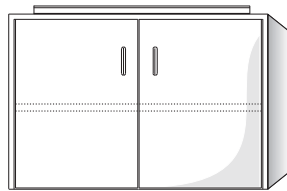

30" and wider

Width	Right Hinged	Left Hinged	# of Doors
15"	1950011	1950211	1
18"	1150011	1150211	1
24"	1250011	1250211	1
30"	1350011	-	2
36"	1450011	-	2
42"	1850011	-	2
48"	1550011	-	2
513mm	1650011	1650211	1
1000mm	1750011	-	2

### Door/Drawer Units

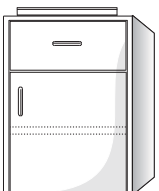

up to 24" wide

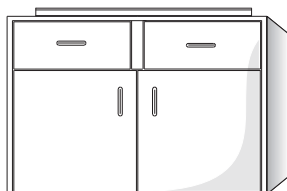

30" and wider

Width	Right Hinged	Left Hinged	# of Doors
15"	1950022	1950222	1
18"	1150022	1150222	1
24"	1250022	1250222	1
30"	1350022	-	2
36"	1450022	-	2
42"	1850022	-	2
48"	1550022	-	2
513mm	1650022	1650222	1
1000mm	1750022	-	2

- Cabinets up to 24" wide receive one shelf.
- Cabinets 25" and wider do not have a shelf.

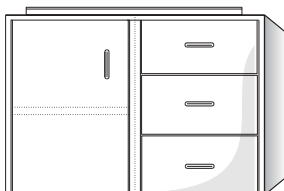

Width	Left Hand	Right Hand
30"	1350014	1350041
36"	1450014	1450041
42"	1850014	1850041
48"	1550014	1550041
1000mm	1750014	1750041

- Left hand Door/Drawer Unit shown.
- Right hand Door/Drawer Units are reverse of what is shown.

STEEL CASEWORK  
SUSPENDED CABINETS

Drawer Units

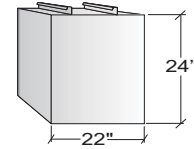

**Note:** Add Option Code 15 to order a finished back on these units.



up to 24" wide



30" and wider

Width	Item Number
15"	1950044
18"	1150044
24"	1250044
30"	1350044
36"	1450044
42"	1850044
48"	1550044
513mm	1650044
1000mm	1750044



up to 24" wide



30" and wider

Width	Item Number
15"	1950055
18"	1150055
24"	1250055
30"	1350055
36"	1450055
42"	1850055
48"	1550055
513mm	1650055
1000mm	1750055



up to 24" wide



30" and wider

Width	Item Number
15"	1950066
18"	1150066
24"	1250066
30"	1350066
36"	1450066
42"	1850066
48"	1550066
513mm	1650066
1000mm	1750066

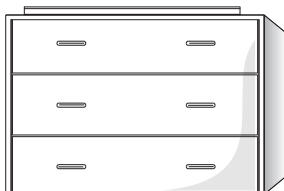

Width	Item Number
30"	1350097
36"	1450097
42"	1850097
48"	1550097
1000mm	1750097

## STEEL CASEWORK MISCELLANEOUS ITEMS - SUSPENDED COMPONENTS

### Pencil Drawers



Width	Item Number
15"	PEN0015
18"	PEN0018
20"	PEN0020
24"	PEN0024
30"	PEN0030

- Pencil Drawer suspends from tables with hanging rails.
- Drawer on Pencil Drawer is supplied with full extension runners.
- When ordering a table with aprons add option code HU to suspend Pencil Drawer.

### Pull Out Writing Tablet



Width	Item Number
15"	PUL0015
18"	PUL0018
20"	PUL0020
24"	PUL0024
30"	PUL0030

- Pull Out Writing Tablet suspends from tables with hanging rails.
- Pull Out Writing Tablet is supplied with full extension runners.
- When ordering a table with aprons add option code HU to suspend Pull Out Writing Tablet.

### Hanging CPU Holder

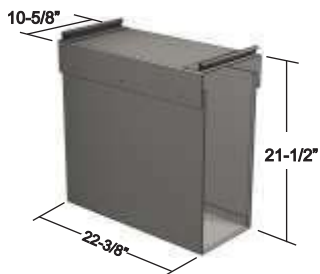

Item Number
CPU1010

- Suspends from tables with hanging rails and is supplied with full extension runners to slide out CPU unit.
- Inside clear dimension of CPU holder is 9-3/16".
- Hanging CPU Holder does not fit on a 22" deep table.
- When ordering a table with aprons add option code HU to suspend CPU holder.



## STEEL CASEWORK MISCELLANEOUS ITEMS - PANELS & ANGLES

### Finished Back Panels



- The Finished Back Panels are used to close off the back of a base cabinet when the back is in plain view.
- Available in sitting height (28-3/4"), ADA height (31-3/4") or standing height (34-3/4").
- Add option code 15 for a welded back on a cabinet.
- Filler panels can be ordered in 1" increments, up to 24" wide. Change the last two digits to the dimension required.

Width	Sitting Hgt	Standing Hgt	ADA Hgt
15"	FBP2015	FBP1015	FBP6015
18"	FBP2018	FBP1018	FBP6018
24"	FBP2024	FBP1024	FBP6024
30"	FBP2030	FBP1030	FBP6030
36"	FBP2036	FBP1036	FBP6036
42"	FBP2042	FBP1042	FBP6042
48"	FBP2048	FBP1048	FBP6048

### Extended Finished Back Panels



Width	Sitting Height		Standing Height		ADA Height	
	4" Depth	18" Depth	4" Depth	18" Depth	4" Depth	18" Depth
15"	FEC1504	FEC1518	FEA1504	FEA1518	FED1504	FED1518
18"	FEC1804	FEC1818	FEA1804	FEA1818	FED1804	FED1818
24"	FEC2404	FEC2418	FEA2404	FEA2418	FED2404	FED2418
30"	FEC3004	FEC3018	FEA3004	FEA3018	FED3004	FED3018
36"	FEC3604	FEC3618	FEA3604	FEA3618	FED3604	FED3618
42"	FEC4204	FEC4218	FEA4204	FEA4218	FED4204	FED4218
48"	FEC4804	FEC4818	FEA4804	FEA4818	FED4804	FED4818
60"	FEC6004	FEC6018	FEA6004	FEA6018	FED6004	FED6018
72"	FEC7204	FEC7218	FEA7204	FEA7218	FED7204	FED7218

- The Extended Finished Back Panels are used to close off the back of a base cabinet when the back is in plain view.
- Available in sitting height (28-3/4"), ADA height (31-3/4") or standing height (34-3/4").
- Panels are available in 1" increments from 4" - 18" Deep. Change the last two digits to the dimension required.
- Corner gussets are welded into top and bottom corners.

### Single Angles



Length	1" x 1"	2" x 2"
28 - 1/2"	SAG110C	SAG220C
31 - 1/2"	SAG110B	SAG220B
34 - 1/2"	SAG110A	SAG220A
18"	SAG1118	SAG2218
24"	SAG1124	SAG2224
36"	SAG1136	SAG2236
48"	SAG1148	SAG2248
60"	SAG1160	SAG2260
72"	SAG1172	SAG2272
84"	SAG1184	SAG2284

### Double Angles



Length	1" x 1"
28 - 1/2"	DAG110C
31 - 1/2"	DAG110B
34 - 1/2"	DAG110A
12"	DAG1112
24"	DAG1124
30"	DAG1130
36"	DAG1136
42"	DAG1142
48"	DAG1148
60"	DAG1160
72"	DAG1172
84"	DAG1184

## OPTIMA 2500 SERIES STEEL AND GLASS SHELF COMPONENTS

### Typical 2500 Series Steel Shelf Assembly

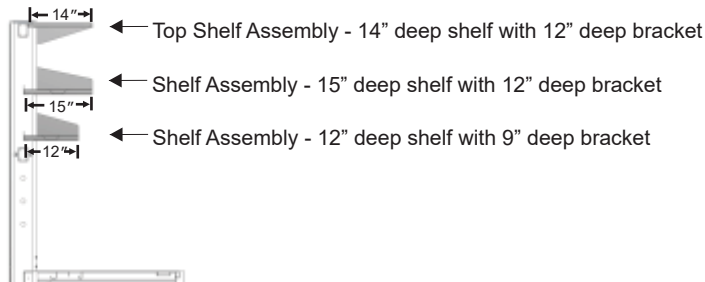

### Top Shelf Assemblies - Steel and Glass



Width of Bench	Glass Shelf Assembly	Steel Shelf Assembly	Shelf Assemblies Per Side
48"	VSG1448	VSS1448	1
60"	VSG1460	VSS1460	2
72"	VSG1472	VSS1472	2
96"	VSG1496	VSS1496	2

- 48" wide assembly includes one 1" thick shelf, one 14" deep shelf frame and a pair of 12" deep brackets. 60", 72" and 96" wide assemblies includes two 1" thick half width shelves, two 14" deep shelf frames and two pairs of 12" deep brackets. Available in stainless steel.
- 6mm thick laminated safety glass.
- Shelves are adjustable in 1" increments.
- Suitable for Optima™ 2500 Series only.

### Steel Shelf Assemblies



Width of Bench	12" Deep Shelf Assembly	15" Deep Shelf Assembly	Shelf Assemblies Per Side
48"	SAV1248	SAV1548	1
60"	SAV1260	SAV1560	2
72"	SAV1272	SAV1572	2
96"	SAV1296	SAV1596	2

- 48" wide assembly includes one 1" thick shelf, one rear shelf angle, one 12" deep or 15" deep shelf frame and a pair of brackets. 60", 72" and 96" wide assemblies include two 1" thick half width shelves, two rear shelf angles, two 12" deep or 15" deep shelf frames and two pairs of brackets (9" Bracket for 12" deep assembly, 12" bracket for 15" deep assembly). Available in stainless steel.
- Shelves are adjustable in 1" increments.
- Suitable for Optima™ 2500 Series only.

### Retainer Rods For Shelf Assemblies



Retainer Rod Option Code	
Powder Coated	Stainless Steel
CR	SR

- 1" high retainer rod (5/16" dia.) prevents articles from falling off the shelf.
- 48" wide benches receive one retainer rod. 60", 72" and 96" benches receive two retainer rods.
- Not suitable for Mott glass shelves.
- Available in stainless steel or powder coated stainless steel.
- Retainer rod ships assembled on the shelf.

## OPTIMA COMPONENTS

### Ceiling Service Panels

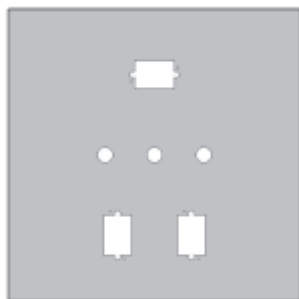

#### Item Number

OSP0001

- Powder coated steel panel takes the place of a standard ceiling tile.
- Offers the ability to mount and disconnect quick connect service fixtures, electrical and data outlets.
- Dimension 23-3/4" x 23-3/4".
- 3 service access holes and 3 electrical cutouts.
- Panel is compatible with most T grid acoustical suspended ceiling structures.
- Fixtures must be ordered separately.

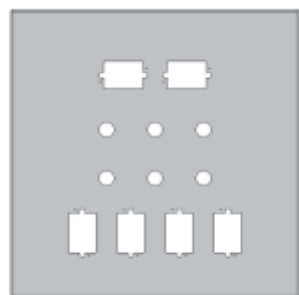

#### Item Number

OSP0002

- Powder coated steel panel takes the place of a standard ceiling tile.
- Offers the ability to mount and disconnect quick connect service fixtures, electrical and data outlets.
- Dimension 23-3/4" x 23-3/4".
- 6 service access holes and 6 electrical cutouts.
- Panel is compatible with most T grid acoustical suspended ceiling structures.
- Fixtures must be ordered separately.

Item #	QTY	MANUFACTURER	PART #	DESCRIPTION	TABLE ID	NOTES
1	2	MOTT MANUFACTURING	SAV1560	OP - OVAL UNIT, DBL SHELF ASSEMBLY 60"W X 15"D	A	RETAINING RODS @ FRONT AND BACK OF SHELF
2	1	MOTT MANUFACTURING	1150044	HC - 3"R"DRWRS 18" X 24" X 22"D	B	
3	1	MOTT MANUFACTURING	PEN0030	SP - HANGING PENCIL DRWR 30"W X 3"H X 21-1/8"D	B	
4	2	MOTT MANUFACTURING	SAV1560	OP - OVAL UNIT, DBL SHELF ASSEMBLY 60"W X 15"D	B	RETAINING RODS @ FRONT AND BACK OF SHELF
5	1	MOTT MANUFACTURING	1510022	BC - 2 DR/2 DRWR 48"X 34-3/4" X 22" D	C	MOBILE CABINET WITH FINISHED BACK
6	1	MOTT MANUFACTURING	FBP6048	MP - ABOVE COUNTER MODESTY PANEL	C	
7	2	MOTT MANUFACTURING	SAV1560	OP - OVAL UNIT, DBL SHELF ASSEMBLY 60"W X 15"D	C	RETAINING RODS @ FRONT AND BACK OF SHELF
8	1	MOTT MANUFACTURING	1210044	BC - 4 "R"DRWRS 24" X 34-3/4" X 22"D	D	MOBILE CABINET WITH FINISHED BACK
9	1	MOTT MANUFACTURING	PEN0024	SP - HANGING PENCIL DRWR 24"W X 3"H X 21-1/8"D	D	
10	1	MOTT MANUFACTURING	FBP6048	MP - ABOVE COUNTER MODESTY PANEL	D	
11	2	MOTT MANUFACTURING	SAV1560	OP - OVAL UNIT, DBL SHELF ASSEMBLY 60"W X 15"D	D	RETAINING RODS @ FRONT AND BACK OF SHELF
12	1	MOTT MANUFACTURING	1250211	HC - L.H. DR 24" X 24" X 22"D	E	
13	1	MOTT MANUFACTURING	PEN0018	SP - HANGING PENCIL DRWR 18"W X 3"H X 21-1/8"D	E	
14	2	MOTT MANUFACTURING	SAV1548	OP - OVAL UNIT, SING SHELF ASSEMBLY 48"W X 15"D	E	RETAINING RODS @ FRONT AND BACK OF SHELF
15	1	MOTT MANUFACTURING	PEN0030	SP - HANGING PENCIL DRWR 30"W X 3"H X 21-1/8"D	F	
16	2	MOTT MANUFACTURING	SAV1548	OP - OVAL UNIT, SING SHELF ASSEMBLY 42"W X 15"D	F	RETAINING RODS @ FRONT AND BACK OF SHELF
17	1	MOTT MANUFACTURING	1250044	HC - 3"R"DRWRS 24" X 24" X 20"D	G	
18	1	MOTT MANUFACTURING	PEN0030	SP - HANGING PENCIL DRWR 30"W X 3"H X 21-1/8"D	G	
19	2	MOTT MANUFACTURING	SAV1560	OP - OVAL UNIT, DBL SHELF ASSEMBLY 60"W X 15"D	G	RETAINING RODS @ FRONT AND BACK OF SHELF
20	1	MOTT MANUFACTURING	1550014	HC - DR L.H. /3 DRWRS R.H. 48" X 24" X 20"D	H	
21	2	MOTT MANUFACTURING	SAV1560	OP - OVAL UNIT, DBL SHELF ASSEMBLY 60"W X 15"D	H	RETAINING RODS @ FRONT AND BACK OF SHELF
22	1	MOTT MANUFACTURING	1810093	BC - 2 DR/1 "42R" DRWR 42" X 34-3/4" X 22" D	I	MOBILE CABINET WITH FINISHED BACK
23	2	MOTT MANUFACTURING	SAV1560	OP - OVAL UNIT, DBL SHELF ASSEMBLY 60"W X 15"D	I	RETAINING RODS @ FRONT AND BACK OF SHELF
24	1	MOTT MANUFACTURING	1250222	HC - L.H. DR/1DRWR 24" X 24" X 22"D	J	
25	2	MOTT MANUFACTURING	SAV1560	OP - OVAL UNIT, DBL SHELF ASSEMBLY 60"W X 15"D	J	RETAINING RODS @ FRONT AND BACK OF SHELF
26	1	MOTT MANUFACTURING	1250222	HC - L.H. DR/1DRWR 24" X 24" X 22"D	K	
27	1	MOTT MANUFACTURING	PEN0018	SP - HANGING PENCIL DRWR 18"W X 3"H X 21-1/8"D	K	
28	2	MOTT MANUFACTURING	SAV1548	OP - OVAL UNIT, SING SHELF ASSEMBLY 48"W X 15"D	K	RETAINING RODS @ FRONT AND BACK OF SHELF
29	1	MOTT MANUFACTURING	1410022	BC - 2 DR/2 DRWR 36"X 34-3/4" X 22" D	L	MOBILE CABINET WITH FINISHED BACK
30	2	MOTT MANUFACTURING	SAV1548	OP - OVAL UNIT, SING SHELF ASSEMBLY 42"W X 15"D	L	RETAINING RODS @ FRONT AND BACK OF SHELF
31	1	MOTT MANUFACTURING	PEN0030	SP - HANGING PENCIL DRWR 30"W X 3"H X 21-1/8"D	M	

32	1	MOTT MANUFACTURING	SAV1548	OP - OVAL UNIT, SING SHELF ASSEMBLY 42"W X 15"D	M	RETAINING RODS @ FRONT AND BACK OF SHELF
33	1	MOTT MANUFACTURING	1810000	BC - OPEN 42" X 34-3/4" X 22"D	N	MOBILE CABINET WITH FINISHED BACK
34	1	MOTT MANUFACTURING	SAV1548	OP - OVAL UNIT, SING SHELF ASSEMBLY 48"W X 15"D	N	RETAINING RODS @ FRONT AND BACK OF SHELF
35	1	MOTT MANUFACTURING	1410011	BC - 2 DR 36" X 34-3/4" X 22"D	O	MOBILE CABINET WITH FINISHED BACK
36	1	MOTT MANUFACTURING	SAV1560	OP - OVAL UNIT, DBL SHELF ASSEMBLY 60"W X 15"D	O	RETAINING RODS @ FRONT AND BACK OF SHELF
37	1	MOTT MANUFACTURING	SAV1560	OP - OVAL UNIT, DBL SHELF ASSEMBLY 60"W X 15"D	P	RETAINING RODS @ FRONT AND BACK OF SHELF
38	1	MOTT MANUFACTURING	SAV1560	OP - OVAL UNIT, DBL SHELF ASSEMBLY 60"W X 15"D	Q	RETAINING RODS @ FRONT AND BACK OF SHELF
39	1	MOTT MANUFACTURING	SAV1560	OP - OVAL UNIT, DBL SHELF ASSEMBLY 60"W X 15"D	R	RETAINING RODS @ FRONT AND BACK OF SHELF
40	1	MOTT MANUFACTURING	1950055	HC - 2 "R",2 "S" DRWRS 15" X 24" X 22"D	S	
41	1	MOTT MANUFACTURING	SAV1596	OP - OVAL UNIT, DBL SHELF ASSEMBLY 96"W X 15"D	S	RETAINING RODS @ FRONT AND BACK OF SHELF
42	1	MOTT MANUFACTURING	1210222	BC - LH DR/1DRWR 24" X 34-3/4" X 22"D	T	MOBILE CABINET WITH FINISHED BACK
43	1	MOTT MANUFACTURING	1310033	BC - 2 DR/4"S"DRWRS 30" X 34-3/4" X 22"D	T	MOBILE CABINET WITH FINISHED BACK
44	1	MOTT MANUFACTURING	SAV1560	OP - OVAL UNIT, DBL SHELF ASSEMBLY 60"W X 15"D	T	RETAINING RODS @ FRONT AND BACK OF SHELF
45	1	MOTT MANUFACTURING	PEN0024	SP - HANGING PENCIL DRWR 24"W X 3"H X 21-1/8"D	U	
46	1	MOTT MANUFACTURING	PEN0030	SP - HANGING PENCIL DRWR 30"W X 3"H X 21-1/8"D	U	
47	1	MOTT MANUFACTURING	SAV1560	OP - OVAL UNIT, DBL SHELF ASSEMBLY 60"W X 15"D	U	RETAINING RODS @ FRONT AND BACK OF SHELF
48	1	MOTT MANUFACTURING	1320014	BC - DR L.H./3 DRWRS R.H. 30" 28-3/4"H 22"D	V	MOBILE CABINET WITH FINISHED BACK
49	1	MOTT MANUFACTURING	SAV1596	OP - OVAL UNIT, DBL SHELF ASSEMBLY 96"W X 15"D	V	RETAINING RODS @ FRONT AND BACK OF SHELF
50	1	MOTT MANUFACTURING	PEN0030	SP - HANGING PENCIL DRWR 30"W X 3"H X 21-1/8"D	V	
51	1	MOTT MANUFACTURING	1320000	BC - OPEN 30" X 28-3/4" X 22"D	W	MOBILE CABINET WITH FINISHED BACK
52	1	MOTT MANUFACTURING	SAV1560	OP - OVAL UNIT, DBL SHELF ASSEMBLY 60"W X 15"D	W	RETAINING RODS @ FRONT AND BACK OF SHELF
53	1	MOTT MANUFACTURING	PEN0024	SP - HANGING PENCIL DRWR 24"W X 3"H X 21-1/8"D	W	
54	1	MOTT MANUFACTURING	PEN0030	SP - HANGING PENCIL DRWR 30"W X 3"H X 21-1/8"D	X	
55	1	MOTT MANUFACTURING	1220022	BC - R.H. DR/1DRWR 24" X 28-3/4" X 22"D	X	MOBILE CABINET WITH FINISHED BACK
56	1	MOTT MANUFACTURING	SAV1560	OP - OVAL UNIT, DBL SHELF ASSEMBLY 60"W X 15"D	X	RETAINING RODS @ FRONT AND BACK OF SHELF
57	1	MOTT MANUFACTURING	1810000	BC - OPEN 42" X 34-3/4" X 26"D	ADD ON	MOBILE CABINET WITH FINISHED BACK
58	4	MOTT MANUFACTURING	1310011	BC - 2 DR 30" X 34-3/4" X 22"D	ADD ON	FRAMED SLIDING GLASS DOORS - MOBILE CAB
59	6	MOTT MANUFACTURING	OSP0002	CEILING SERVICE PANEL 6 SERVICE HOLES, 6 ELEC.	ADD ONS	12 ELECTRICAL CUTOUTS PER CEILING PANEL
60		MOTT MANUFACTURING	EPOXY	EPOXY RESIN TOPS AND BACKSPLASH	MISC	