

GENERAL DRAWING NOTES:

EQUIVALENCIES HAVE BEEN GRANTED FOR THE FOLLOWING:

- 1. SELF CLOSING DOOR HARDWARE IN DOMICILLIARY OCCUPANCIES-DATED 1/09/98
- 2. INSTALLATION OF WIRELESS ACCESS POINT EQUIPMENT WITHIN EXIT STAIR ENCLOSURES-DATED 2/11/10

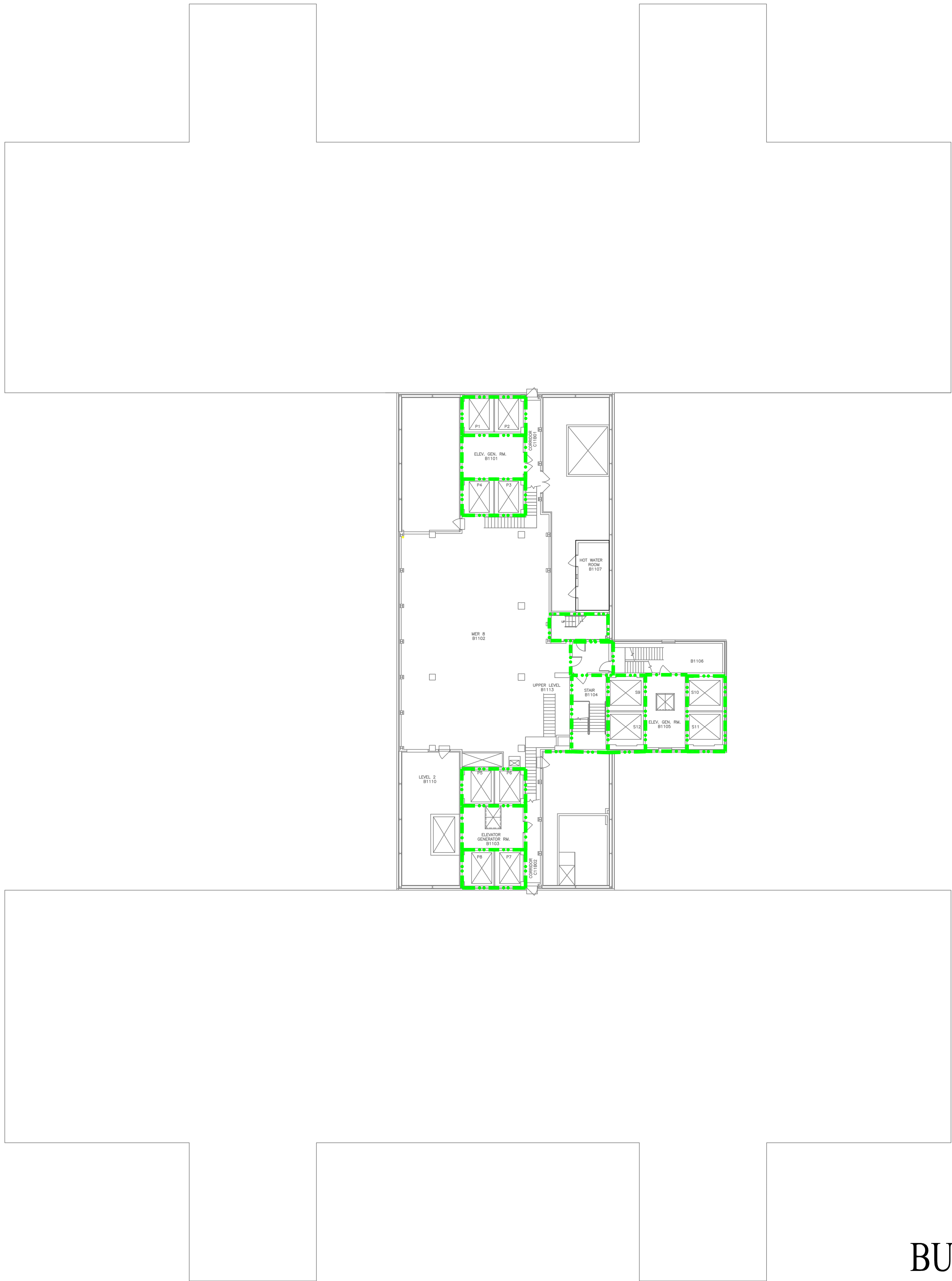

SYMBOLS LIST

- 2 HOUR FIRE BARRIER
- 1 HOUR FIRE BARRIER
- 2 HOUR FIRE/SMOKE BARRIER
- 1 HOUR FIRE/SMOKE BARRIER
- 30 MINUTE SMOKE BARRIER
- SMOKE RESISTIVE HAZARDOUS AREA

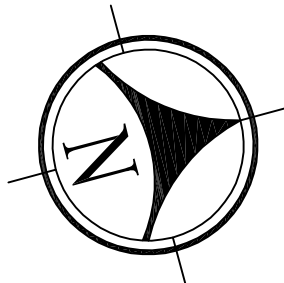

BUILDING 111 ELEVENTH FLOOR
(ELEVATOR PENTHOUSE-B WING)
FULLY SPRINKLERED
INDUSTRIAL OCCUPANCY

Revisions		Date	 <div>CLEMENT J. ZABLOCKI VAMC 5000 W. National Ave. Milwaukee, WI 53295</div>	 <div>FP&C CONSULTANTS, INC. 1520 MAIN STREET INDIANAPOLIS, IN 46224 (317)486-5188</div>	Drawing Title		Client Project No.	Contract No.	Project Title	Designed By	Checked By	Drawn By	Date	Drawing No.		
FP&C Proj.#:		1751.54			BUILDING 111 ELEVENTH FLOOR		Building No.	AutoCAD File Name		STATEMENT OF CONDITIONS	BAA	BAA	DN		12/2016	Sht. 12 Of 14
							111	SOC12 111-11			Location CLEMENT J. ZABLOCKI VAMC MILWAUKEE, WISCONSIN	Scale:	NO SCALE			