

three inches = one foot
one and one half inches = one foot
one inch = one foot
three quarters inch = one foot
one half inch = one foot
three eighths inch = one foot
one quarter inch = one foot
one eighth inch = one foot

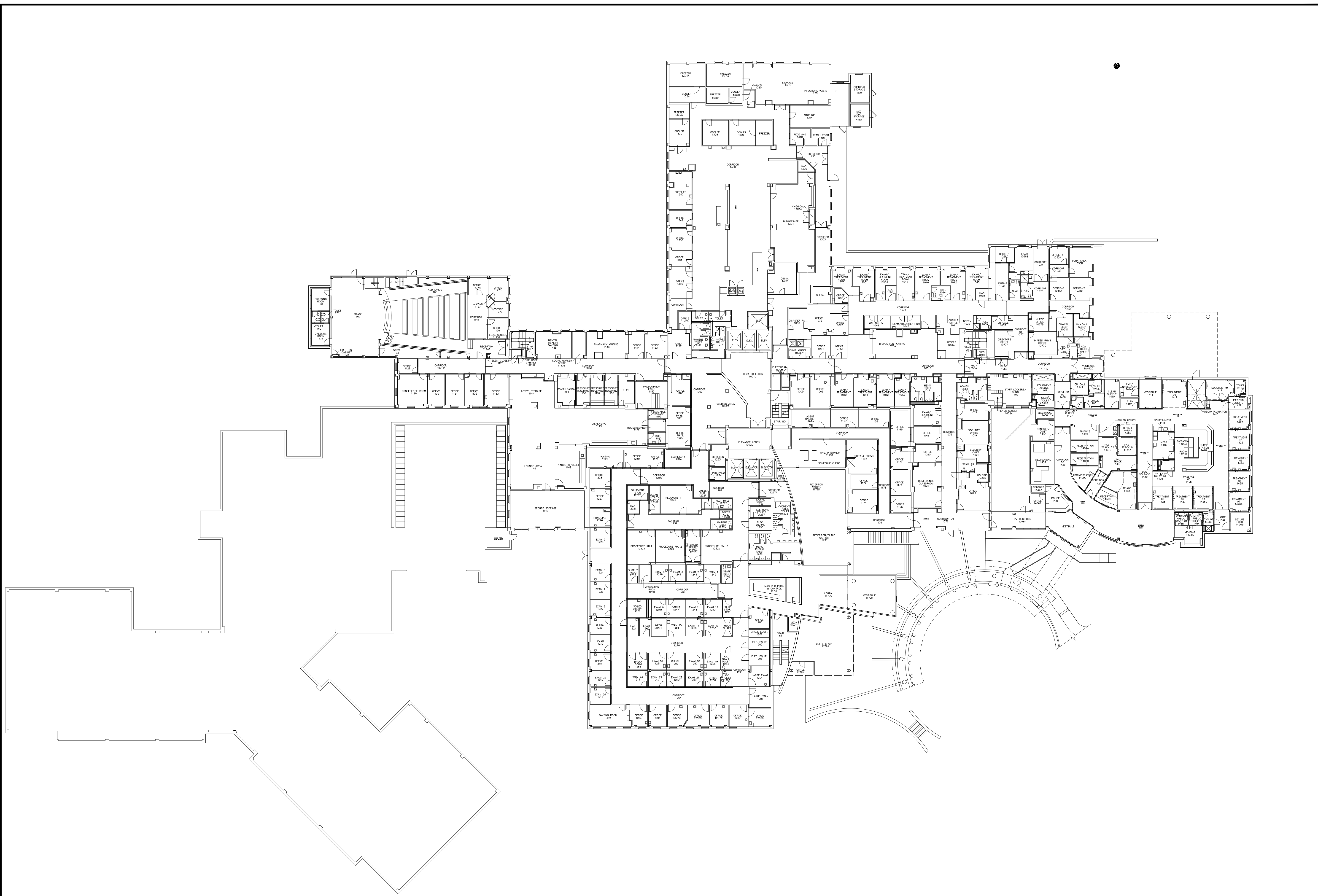

Revisions		Date	Professional Seal		Drawing Title FIRST FLOOR PLAN ARCHITECTURAL		Project Title AS-BUILT Drawings		Date 04-26-2016
					Site:		Building Number 01	Checked	Drawn
					Approved:		Location VAMC WILMINGTON DELAWARE	Drawing No. 460-1-1-AR	