

M5
Back - drill position

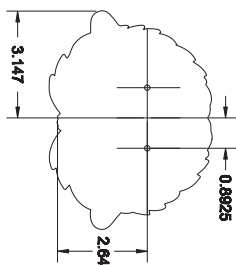

5" Medallion approx wt 1 lb 8.9 oz - Type M5

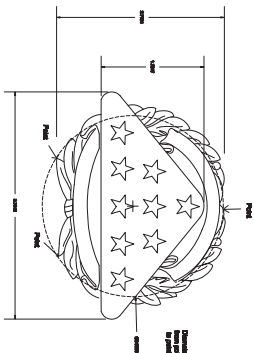
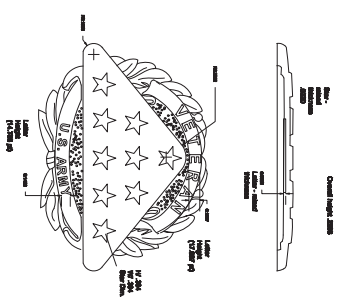

M3
Back - drill position

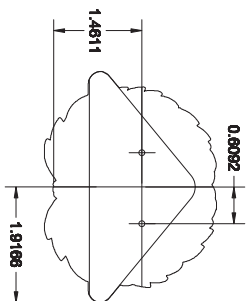

3" Medallion approx wt 7.2 oz - Type M3

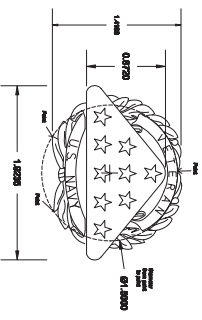
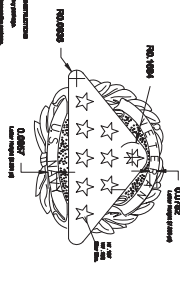
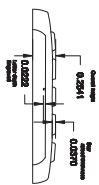

M1
Back - drill position

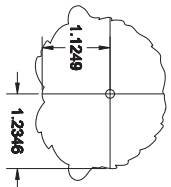

1 1/2" Medallion approx wt 1.3 oz - Type M1

Office

1. ALL DIMENSIONAL TOLERANCES ARE ± .002 UNLESS OTHERWISE SPECIFIED.
2. PROVIDE SAND CAST 285 BRONZE.
3. PROVIDE CLOTH TEXTURE REPRESENTING FOLDED FLAG FOR BACKGROUND OF STARS.

Mounting Hardware & Aids for 5" Modelon

[illegible]

Mounting Hardware & Aids for 3" or 1 1/2" N

[illegible]

NATIONAL
CEMETERY
ADMINISTRATION

1 1/2" - 3" - 5" Bronze Medallions

<p>•</p> <p>Agreement between, between program directors</p> <p>Agreement, Open to, supply</p> <p>Agreement, Rights, between, between program directors</p> <p>Agreement, Rights, between, between program directors</p>
--

GOVERNMENT MEDALLIONS

Isotope Type	Chemical	Isotopic
M1, M2, M3		SHORTER
Isotopes		

01-27-10