



One Monarch Drive
Littleton, MA 01460
Phone: 978.486.8494 Fax: 978.428.2694
www.imagestreammedical.com

© 2011 Image Stream Medical
This document is proprietary and shall not be reproduced or redistributed without the express written permission of Image Stream Medical.

Project Name / Site Location:
VA Medical Center
Minneapolis
2nd Floor ORs
Minneapolis, MN

Issued For:
COORDINATION

Drawing History	
Rev.	Date
1.0	JAN.11.2012
1.1	APR.26.2012

FOR COORDINATION
FOR COORDINATION

Rev. Dates: 1.1 / APR.26.2012

Designed by:
Drawn by: CF

Reviewed by:
Scale: AS NOTED

Project #:
Quote #:

1361 21132

System / Room:
2nd Floor ORs

Drawing Title:
MASTER
FLOOR PLAN

Drawing / Sheet Number:
AV - 0.01

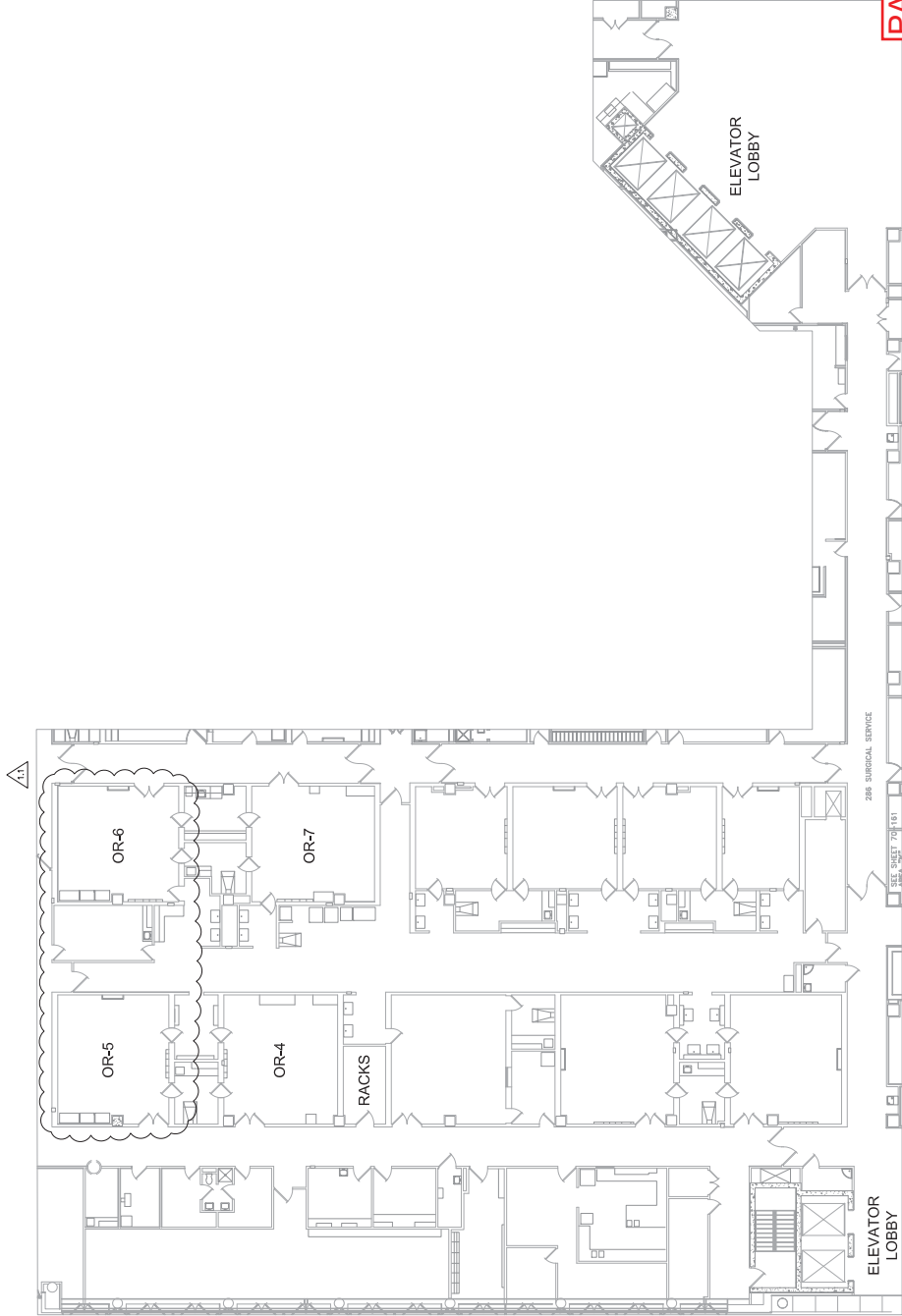

PAGE 1 of 4

EXHIBIT "I.1"
INSTALL OPERATING ROOM BOOMS
PHASE 2
PROJECT NO: 618-12-302
INTEGRATION SYSTEM REQUIREMENTS

2nd FLOOR ORs - PARTIAL FLOOR PLAN
SCALE: NTS

PAGE 2 of 4

AV-1.01

NOTE 2: PROVIDE ALL SPECIFIED CONDUIT FREE OF OTHER CABLE AND WITH INSTALLED PULL STRINGS.



THIS NUMBER DENOTES TYPICAL DEDICATED AV/IT -
DEVICE CIRCUIT NUMBER (PER ROOM).



One Monarch Drive
Littleton, MA 01460
Phone: 978.486.8494 Fax: 978.428.2694
www.imagestreammedical.com

© 2011 Image Stream Medical
This document is proprietary and shall not be reproduced or redistributed without the express written permission of Image Stream Medical.

Project Name / Site Name / Site Location:

VA Medical Center
Minneapolis
2nd Floor ORs
Minneapolis, MN

Issued For:

COORDINATION

Drawing History

Rev.	Date	Comment
1.0	JAN.11.2012	FOR COORDINATION
1.1	APR.26.2012	FOR COORDINATION

Rev./Dates: 1.1 / APR.26.2012

Designed by:

Drawn by: CF

Reviewed by:

Scale: AS NOTED

GMBN

Project #:

Quote #:

1361 21132

System / Room:

OR-4

Drawing Title:

CONDUIT AND ELECTRICAL

Drawing / Sheet Number:

AV-1.02

SYMBOL LEGEND

- (24) 24x24x8 JUNCTION BOX (BY EC) ABOVE CEILING IN ACCESSIBLE LOCATION IN OR NEAR ROOM.
- (AN) ANESTHESIA COLUMN (TYP - BY OTHERS)
- (C1) WALL-MOUNT CAMERA. PROVIDE 4" ELECTRICAL BOX ANCHORED FIRMLY TO STUD, W/ 20A PLASTER RING.
- (CC) CGU CONNECTION DEVICE PLATE FOR HOSPITAL. PROVIDE 4" ELECTRICAL BOX W/ 10A PLASTER RING.
- (EO) EQUIPMENT BOOM (TYP - BY OTHERS)
- (M) MONITOR BOOM (TYP - BY OTHERS)
- (N) NURSE STATION. PROVIDE (2) LINKED 4" BOXES W/ 10A & 20A PLASTER RINGS, AND (2) LINKED 4" BOXES W/ 10A PLASTER RINGS FOR PASS-THROUGH PLATES.
- (P1) FLAT PANEL DISPLAY. PROVIDE (3) LINKED 4" ELECTRICAL BOXES W/ 1-10A PLASTER RINGS FOR DISPLAY PASS-THROUGH PLATES.
- (R) 12x12x4 JUNCTION BOX (BY EC) IN WALL BEHIND EQUIPMENT RACK.
- (RL) OPTIONAL ROOM LIGHTING CONTROL INTERFACE (BY OTHERS) IN ACCESSIBLE LOCATION.
- (S) RECESSED CEILING MOUNTED LOUSPEAKER (TYP)
- (SL) OPTIONAL SURGICAL LIGHTING CONTROL INTERFACE (BY OTHERS) IN ACCESSIBLE LOCATION.
- (WP) WALL MOUNT CONNECTION PLATE. PROVIDE 4" ELECTRICAL BOX W/ 10A PLASTER RING.
- (W1) WORK STATION. (TYP FOR NURSE PC, USYS, ETC.) PROVIDE (2) LINKED 4" BOXES W/ 1-10A PLASTER RINGS FOR DEVICE PLATES.
- (W2) PACS WORK STATION. PROVIDE 4" BOX W/ 1-10A PLASTER RINGS FOR DEVICE PLATES.
- (75) 7" EMT CONDUIT (BY EC)
- (1) 1" EMT CONDUIT (BY EC)
- (1.25) 1" EMT CONDUIT (BY EC)
- (1.5) 1" EMT CONDUIT (BY EC)
- (8) 8x8x4 JUNCTION BOX (BY EC) NEAR ACCESS HATCH ABOVE BOOM (TYP FOR ALL BOOMS)
- (O) RECESSED SURVEY (C/O/O) OUTLET (BY EC) BEHIND DISPLAY ON DEDICATED 15-20A CIRCUIT - COORDINATE EXACT LOCATION WITH ISM. (SEE NOTE 1.)
- (OAV) DUPLEX OUTLET(S) (BY EC) FOR AV/IT EQUIPMENT ON DEDICATED 20A CIRCUIT. (SEE NOTE 1.)
- (OAV) DUPLEX OUTLET (BY EC) FOR AV/IT EQUIPMENT ON DEDICATED 20A CIRCUIT. (SEE NOTE 1.)
- (O) ANALOG (POTS) PHONE LINE & (O) DATA OUTLET (BY EC) FOR EQUIPMENT FOR RACK MOUNTED EQUIPMENT BY ISM.
- (U) VOICE & (U) DATA JEROPS (BY FACILITY). RECOMMENDED FOR FOR OR EQUIPMENT BY FACILITY.
- (U) DATA DROP(S) (BY FACILITY) FOR EQUIPMENT BY FACILITY

NOTE 1: AV POWER RECEPTACLES (BY EC) SHALL BE PROVIDED WITH HOSPITAL GRADE OUTLETS WIRED IN ACCORDANCE WITH NEC ARTICLE 517 AND ALL APPLICABLE CODES. AV BRANCH CIRCUITS SHALL BE DEDICATED (FOR LOCAL AV/IT EQUIPMENT ONLY) AND WITH RESPECT TO ANY GIVEN OR, SHALL BE FED FROM A SINGLE SUBPANEL.

NOTE 2: PROVIDE ALL SPECIFIED CONDUIT FREE OF OTHER CABLE, AND WITH INSTALLED PULL STRINGS.

PAGE 3 of 4

EXHIBIT "I.1"
INSTALL OPERATING ROOM BOOMS
PHASE 2
PROJECT NO: 618-12-302
INTEGRATION SYSTEM REQUIREMENTS

OR-4 (RM # 20-119) - AV FLOOR / CEILING PLAN
SCALE: 3/16" = 1'-0"



One Monarch Drive
Littleton, MA 01460
Phone: 978.486.8494 Fax: 978.428.2694
www.imagestreammedical.com

© 2011 Image Stream Medical
This document is proprietary and shall not be reproduced or redistributed without the express written permission of Image Stream Medical.

Project Name / Site Location:

VA Medical Center
Minneapolis
2nd Floor ORs
Minneapolis, MN

Issued For:
COORDINATION

Drawing History	
Rev.	Date
1.1	APR.26.2012
FOR COORDINATION	

Rev. Dates:	1.1 / APR.26.2012
Designed by:	CF
Reviewed by:	GMBN
Scale:	AS NOTED
Project #:	1361
Quote #:	21132

System / Room:
OR-5 & 6

Drawing Title:
CONDUIT AND ELECTRICAL

Drawing / Sheet Number:
AV-1.03

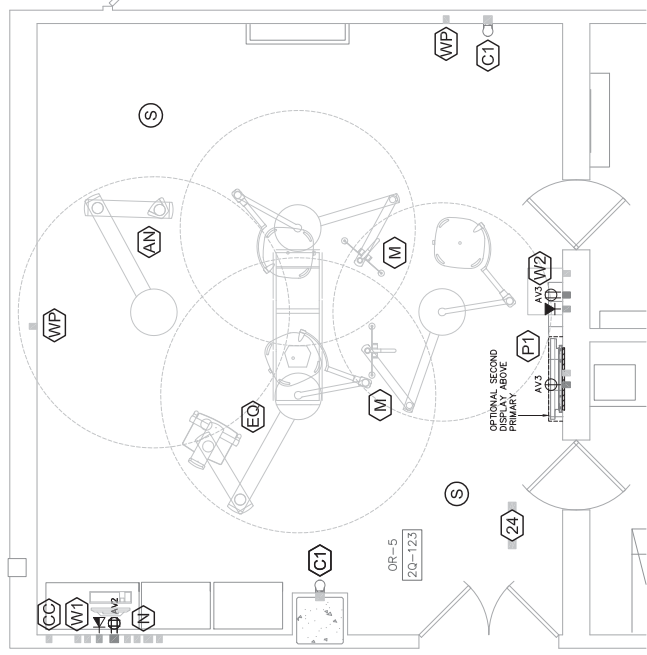

OR-5 (RM # 2Q-123) - AV FLOOR / CEILING PLAN
SCALE: 3/16" = 1'-0"

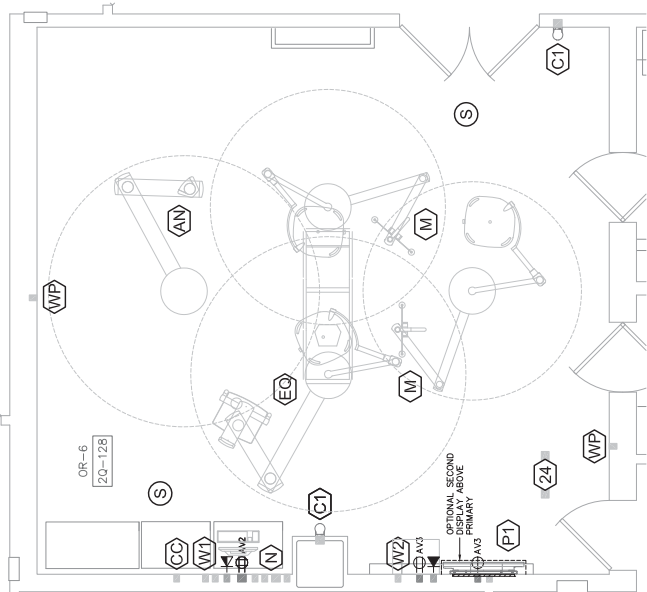

OR-6 (RM # 2Q-128) - AV FLOOR / CEILING PLAN
SCALE: 3/16" = 1'-0"

PAGE 4 of 4

NOTE: SEE DRAWING AV-1.02 FOR EQUIPMENT RACK LOCATION

EXHIBIT "I.1"
INSTALL OPERATING ROOM BOOMS
PHASE 2
PROJECT NO: 618-12-302
INTEGRATION SYSTEM REQUIREMENTS