

three inches = one foot
one and one half inches = one foot
one inch = one foot
three quarters inch = one foot
three eighths inch = one foot
one half inch = one foot
one quarter inch = one foot
three eighths inch = one foot
one eighth inch = one foot

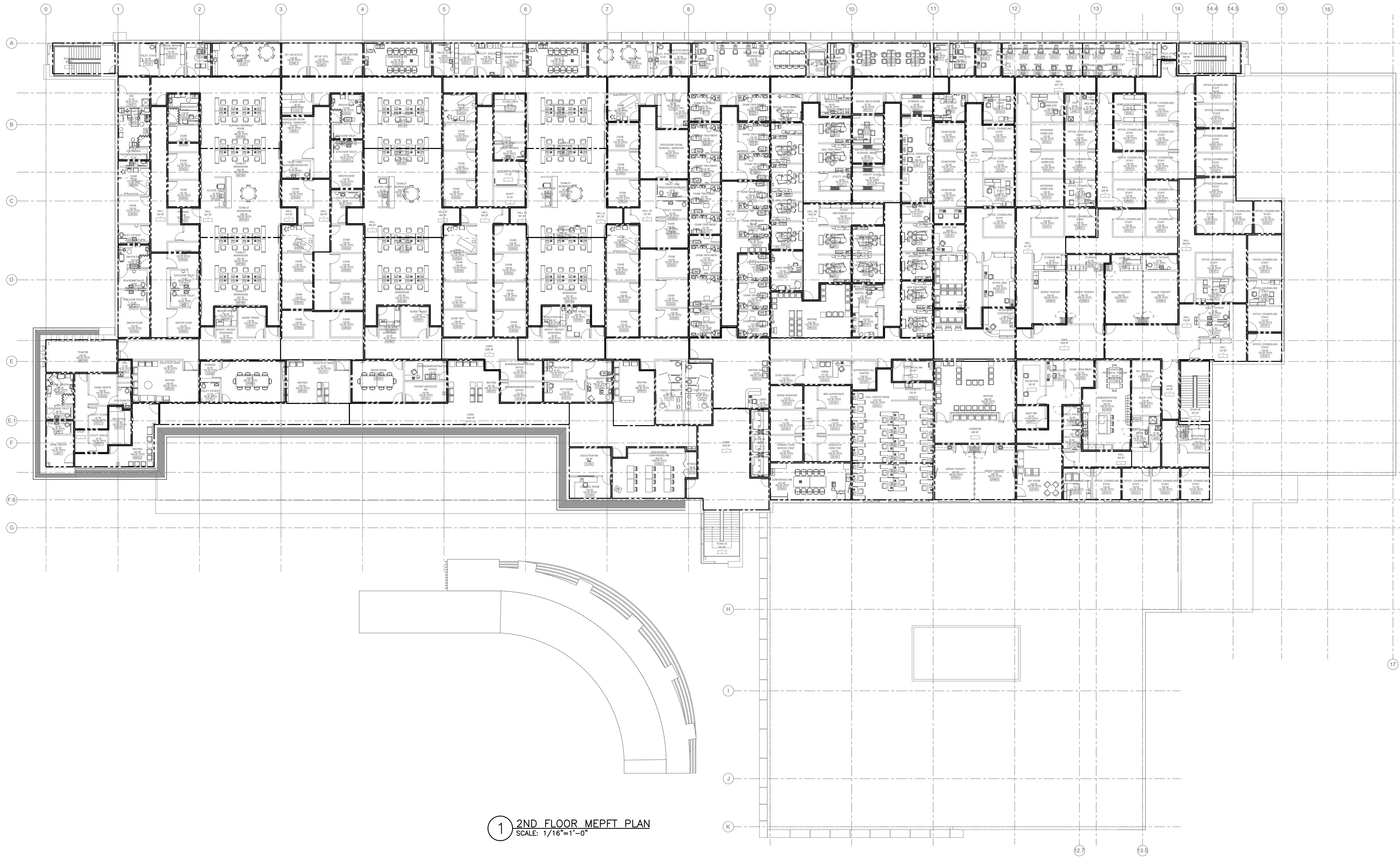



100% SCHEMATIC
DESIGN - NOT FOR
CONSTRUCTION

FULLY
SPRINKLERED

Revisions:	Date

CONSULTANTS:

**KJWW**
ENGINEERING
CONSULTANTS
Experience you can build on.®
15 Sunnen Drive, Suite 104 | St.
Louis, Missouri 63143
314.645.1132 Fax: 314.645.1173
www.kjww.com

**ANDERSON
ENGINEERING**
13605, 1st Ave. North, Suite 100 |
Plymouth, Minnesota 55441
763.412.4000 Fax: 763.412.4050 |
www.ae-min.com

**HENDERSON
ENGINEERS**
8345 LENEXA DRIVE, SUITE 300
LENEXA, KS 66042
TEL 913.742.5000 FAX 913.742.5001
www.hel-eng.com
16500000000
OK, CORPORATE NUMBER: Q 1639
EXPIRES 06/30/19

THIS DOCUMENT IS RELEASED
FOR THE PURPOSE OF
PRELIMINARY SUBMITTAL

LICENSE #

IT IS NOT TO BE USED FOR
CONSTRUCTION
PURPOSES.

ARCHITECT/ENGINEERS:

**Oculus Inc.**
ARCHITECTURE | STRATEGIC PLANNING |
INTERIORS | MOVE MANAGEMENT
1 South Memorial Drive
Suite 1500
Saint Louis, MO 63102
(p) 314.367.6100
(f) 314.367.1489
www.oculusinc.com

Drawing Title

**MEPFT SECOND FLOOR
EQUIPMENT LAYOUT**

Approved: Project Director

Project Title

**VA TULSA, OK CBOC - DESIGN
PROCESS DOCUMENT**

Location

TULSA, OK

Date

06/20/2017

Checked

HEI

Drawn

HEI

Project Number

VA101-17-R-0320

Building Number

Drawing Number

MEPT02

Dwg. of

**Office of
Facilities
Management**

Department of
Veterans Affairs