

LEGEND

- EXIST. WALL TO BE REMOVED
- NEW WALL
- NEW LIGHT FIXTURE

NEW WORK NOTES

1	PROVIDE AND INSTALL AMITCO, PRIORY OAK FLOORING
2	PROVIDE AND INSTALL JOHNSONITE 4" COVE BASE, 4' LENGTHS
3	PROVIDE AND INSTALL KNOCK DOWN FINISH ON ALL WALLS
4	PROVIDE AND INSTALL 1-COAT PRIMER, 2-COATS SHERWIN WILLIAMS, SEMI-GLOSS, HARMONY PAINT
5	PROVIDE AND INSTALL 6" BLOCK WALL FROM FLOOR TO THE SUBSTRATE, WITH 3" SHEETROCK ON BOTH SIDES
6	PROVIDE AND INSTALL NEW SOLID CORE BIRCH WOOD DOOR, HARDWARE WITH "BEST" MANUFACTURED LOCK SYSTEMS, STAIN AND FINISH DOOR, PAINT DOOR FRAME WITH DIM ACRYLIC PAINT
7	PROVIDE AND INSTALL NEW CEILING TILE AND GRID, TYPE BAROQUE, ITEM #BET-157, 24"x24"x5/8", CERTAINTED 18" CLASSIC STAB SYSTEM, WHITE
8	PROVIDE AND INSTALL NEW CEILING LIGHT FIXTURES, INDIRECT LUMINAIRE, 2'X4", METALUX, ARC LINE SERIES, 18 LAMPS
9	PROVIDE AND INSTALL NEW LIGHT SWITCHES, STAINLESS STEEL COVER PLATES, WIRING, NO SURFACE MOUNTED SWITCHES.
10	PROVIDE AND INSTALL NEW SOLID SURFACE COUNTERTOPS, 1-24" WX58" L AND 1-36" WX60" L (STARON, TEMPEST, COLOR: CINNAMON)
11	PROVIDE AND INSTALL NEW BASE CABINETS, WITH DRAWERS, LAMINATE COLOR TO BE DETERMINED BY THE VA. CONTRACTOR TO PROVIDE SHOP DRAWINGS.
12	PROVIDE AND INSTALL NEW ELECTRICAL OUTLETS, WIRING, STAINLESS STEEL FACE PLATES
13	PROVIDE AND INSTALL NEW DATA OUTLETS, WIRING, STAINLESS STEEL FACE PLATES
14	PROVIDE AND INSTALL NEW FUR DOWN
15	PROVIDE AND INSTALL A NEW STORE FRONT ROLL-UP 9' LINEAR FEET, TYPE ALPINEDOORS.COM, ALPINE ECONO GRILLE OR EQUAL. SECURITY DOOR WILL BE MOTOR OPERATED AND ALL ELECTRICAL INSTALLATION WILL BE PROVIDED BY THE CONTRACTOR ALONG WITH INCORPORATING IT INTO THE EXISTING SECURITY SYSTEM.
16	PROVIDE AND INSTALL NEW DIFFUSERS
17	PROVIDE AND INSTALL NEW RETURN AIR VENTS
18	PROVIDE AND INSTALL NEW DUCTING
19	PROVIDE AND INSTALL BLACK PIPE SPRINKLER PIPE, WITH DROPS, NEW WHITE POWDER COATED SPRINKLER HEADS, WITH WHITE ESCUTCHEONS, TIE INTO EXISTING SPRINKLER SYSTEM, CONTRACTOR WILL TEST UPON COMPLETION.
20	PROVIDE AND INSTALL TEMPORARY CONSTRUCTION WALL
21	PROVIDE AND INSTALL STICKY MATS AT EXIT
22	SEAL DOOR WITH PLASTIC
23	PROVIDE AND INSTALL METAL STUD WALL, 33 MILS, 3" SHEETROCK

DEMO NOTES

24	DEMO ASBESTOS VCT AND TERRAZO COVE BASE.
25	DEMO WALL PAPER
26	DEMO CEILING TILE AND GRID
27	DEMO LIGHT FIXTURES BACK TO NEAREST J-BOX
28	DEMO EXISTING LIGHT SWITCH BACK TO THE NEAREST J-BOX
29	MOVE ALL FURNITURE FROM THE ROOM TO BE STORED AT THE VA WAREHOUSE
30	DEMO BLOCK WALL TO THE SUBSTRATE
31	DEMO DIFFUSERS, RETURN AIR GRILLS, DUCTING
32	DEMO SPRINKLER PIPE AND DROP

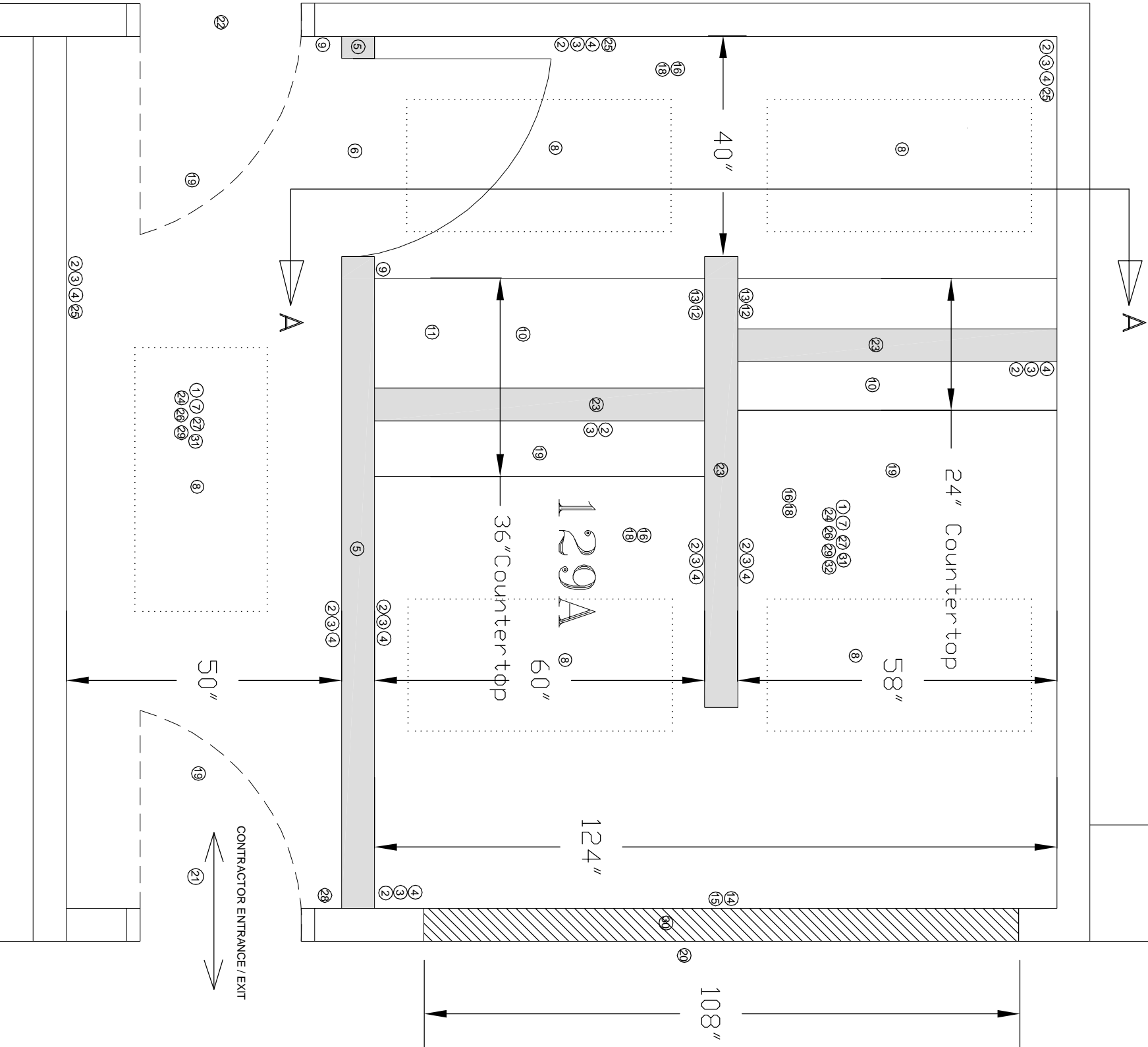

PLAN LAYOUT