

GENERAL NOTES:

1. EXISTING ELECTRICAL EQUIPMENT INCLUDING CONDUIT, CONDUCTORS, CIRCUIT BREAKERS AND SWITCHES MAY BE RE-USED ONLY AFTER THEY HAVE BEEN TESTED AND ARE CERTIFIED FOR RE-USE. THE EXISTING EQUIPMENT SHALL MATCH THE SIZE AND SHALL BE IDENTICAL FOR RE-USE. THE CONSTRUCTION DRAWINGS FOR THE NEW INSTALLATION, ADD DEDUCT SHOULD BE PRESENTED IN THE CONTRACTORS PROPOSAL IF THE EXISTING EQUIPMENT ARE TO BE RE-USED.
2. CONTRACTOR SHALL BE FAMILIAR WITH THE REQUIREMENTS FOR THE NEW EQUIPMENT TO BE INSTALLED. IT IS THE CONTRACTOR'S RESPONSIBILITY TO PROVIDE AND INSTALL ALL THE NECESSARY MATERIALS INCLUDING (BUT NOT LIMITED TO) CIRCUIT BREAKERS, CONDUIT/CONDUCTORS, J-HOOKS, JUNCTION BOXES, POWER SUPPLIES, ELECTRICAL TAPES, TWISTERS, RECEPTACLES AS REQUIRED; FOR THE PROPER INSTALLATION AND SUCCESSFUL OPERATION OF THE NEW EQUIPMENT. ALL THE INSTALLATION WORK SHALL BE DONE IN A NEAT AND WORKMAN LIKE MANNER.

SHEET NOTES:

1. CONTRACTOR TO VERIFY THE AVAILABILITY OF THE POWER FOR THE NEW DISPLAY MONITOR AT THE NURSE STATION. PROVIDE AND INSTALL A NEW 3/4" CONDUIT WITH 2 #12AWG & 1 #12 AWG (G) CONDUCTORS. FROM THE CLOSEST PANEL AS SHOWN ONLY IF THERE IS INSUFFICIENT AVAILABILITY OF POWER, PROVIDE AND INSTALL A 20A/1P CIRCUIT BREAKER AT THE PANEL, J-BOXES & RECEPTACLES AS REQUIRED FOR THE OPERATION OF THE DISPLAY MONITOR. EXACT ROUTING OF THE RACEWAY SHALL BE DETERMINED IN THE FIELD PRIOR TO THE CONSTRUCTION.
2. CONTRACTOR SHALL PROVIDE AND INSTALL CONDUIT AND CONDUCTORS WITH SIZES AS SHOWN ON THE DRAWING. ROUTING AS SHOWN ON THE DRAWING IS ONLY FOR SCHEMATIC PURPOSES. EXACT ROUTING OF THE RACEWAY SHALL BE DETERMINED IN THE FIELD PRIOR TO THE CONSTRUCTION. PROVIDE A SHORTEST POSSIBLE ROUTE FROM THE SOURCE TO THE DEVICE.
3. FOR EACH DOOR CONTROLLER THE CONTRACTOR SHALL PROVIDE AND INSTALL AN INDIVIDUAL POWER SUPPLY TO MEET ELECTRICAL SPECIFICATION PER MANUFACTURER'S RECOMMENDATION. THE INPUT TO THE POWER SUPPLY SHALL BE AT 120V AC. PROVIDE AND INSTALL RECEPTACLES AS SHOWN/REQUIRED.
4. CONTRACTOR SHALL PROVIDE AND INSTALL DATA/COMMUNICATION CABLE FROM THE KEYPAD, THE DOOR CONTROLLER AND THE LED ELECTRONIC DISPLAY TO THE "IT" CLOSET AND TO THE NURSE STATIONS. COORDINATE WITH THE COR OR THE VA MENLO PARK "IT" PERSONNEL PRIOR TO THE ROUTING AND INSTALLMENT OF THE DATA/COMMUNICATION CONDUCTORS. SEE DRAWING TY-100 FOR DETAIL.
5. FOR PANEL SCHEDULE SEE DRAWING E-107.
6. CONTRACTOR SHALL FURNISH AND INSTALL POWER SUPPLY AND WIRING REQUIRED TO CONNECT ALL KEYPADS FOR THIS PROJECT. PROVIDE A NEMA 3R WEATHER PROOF ENCLOSURES FOR ALL DEVICES INSTALLED OUTSIDE THE BUILDING.
7. CONTRACTOR SHALL FURNISH AND INSTALL, WIRING AND DEVICES TO CONNECT THE KEYPADS TO THE DOOR CONTROLLER AS REQUIRED TO COMPLETE A FULLY FUNCTIONAL SYSTEM. PROVIDE A NEMA 3R WEATHER PROOF ENCLOSURES FOR DEVICES INSTALLED OUTSIDE THE BUILDING.

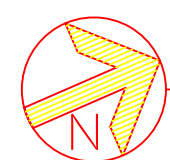

BUILDING 360 WINGS A - C ELECTRICAL POWER PLAN  
SCALE:N.T.S.

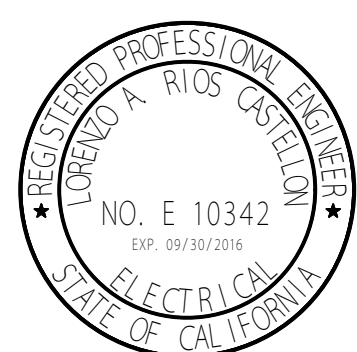
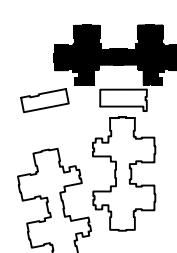

360

E - 102