

1  
2  
3  
4  
5  
6  
7  
8  
9

THREE EIGHTH INCH = ONE FOOT  
0 16  
8  
4

ONE EIGHTH INCH = ONE FOOT  
0 16  
8  
4

ONE QUARTER INCH = ONE FOOT  
0 8  
4

THREE EIGHTHS INCH = ONE FOOT  
0 8  
4

ONE HALF INCH = ONE FOOT  
0 6  
3

THREE QUARTERS INCH = ONE FOOT  
0 6  
3

ONE INCH = ONE FOOT  
0 6  
3

ONE AND ONE HALF INCHES = ONE FOOT  
0 6  
3

THREE INCHES = ONE FOOT  
0 6  
3

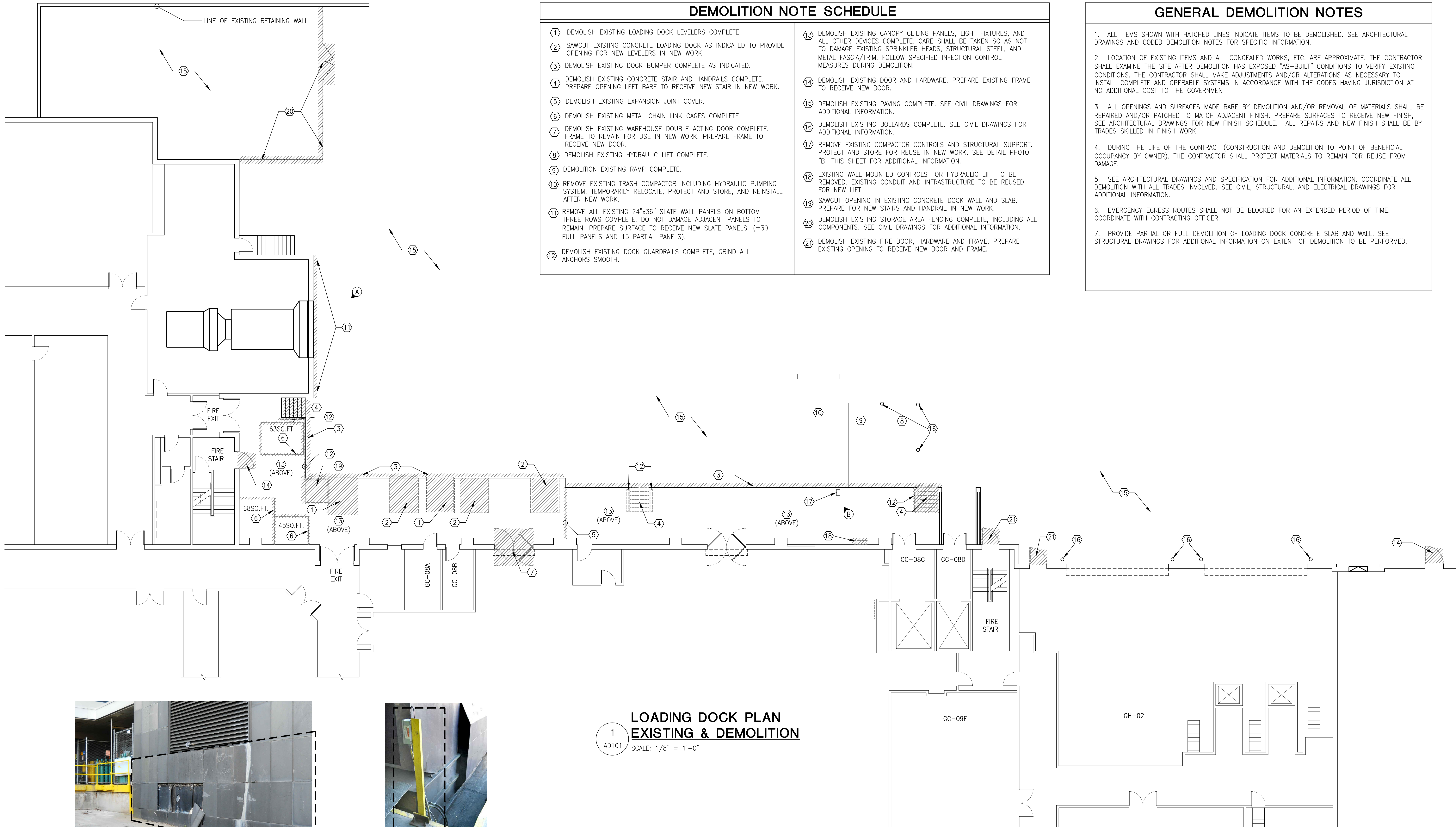

**LOADING DOCK PLAN  
EXISTING & DEMOLITION**

SCALE: 1/8" = 1'-0"



**A** **DETAIL PHOTO**  
AD101 NOT TO SCALE



**B** **DETAIL PHOTO**  
AD101 NOT TO SCALE

**DEMOLITION NOTE SCHEDULE**

- DEMOLISH EXISTING LOADING DOCK LEVELERS COMPLETE.
- SAWCUT EXISTING CONCRETE LOADING DOCK AS INDICATED TO PROVIDE OPENING FOR NEW LEVELERS IN NEW WORK.
- DEMOLISH EXISTING DOCK BUMPER COMPLETE AS INDICATED.
- DEMOLISH EXISTING CONCRETE STAIR AND HANDRAILS COMPLETE. PREPARE OPENING LEFT BARE TO RECEIVE NEW STAIR IN NEW WORK.
- DEMOLISH EXISTING EXPANSION JOINT COVER.
- DEMOLISH EXISTING METAL CHAIN LINK CAGES COMPLETE.
- DEMOLISH EXISTING WAREHOUSE DOUBLE ACTING DOOR COMPLETE. FRAME TO REMAIN FOR USE IN NEW WORK. PREPARE FRAME TO RECEIVE NEW DOOR.
- DEMOLISH EXISTING HYDRAULIC LIFT COMPLETE.
- DEMOLITION EXISTING RAMP COMPLETE.
- REMOVE EXISTING TRASH COMPACTOR INCLUDING HYDRAULIC PUMPING SYSTEM. TEMPORARILY RELOCATE, PROTECT AND STORE, AND REINSTALL AFTER NEW WORK.
- REMOVE ALL EXISTING 24"x36" SLATE WALL PANELS ON BOTTOM THREE ROWS COMPLETE. DO NOT DAMAGE ADJACENT PANELS TO REMAIN. PREPARE SURFACE TO RECEIVE NEW SLATE PANELS. (±30 FULL PANELS AND 15 PARTIAL PANELS).
- DEMOLISH EXISTING DOCK GUARDRAILS COMPLETE, GRIND ALL ANCHORS SMOOTH.
- DEMOLISH EXISTING CANOPY CEILING PANELS, LIGHT FIXTURES, AND ALL OTHER DEVICES COMPLETE. CARE SHALL BE TAKEN SO AS NOT TO DAMAGE EXISTING SPRINKLER HEADS, STRUCTURAL STEEL, AND METAL FASCIA/TRIM. FOLLOW SPECIFIED INFECTION CONTROL MEASURES DURING DEMOLITION.
- DEMOLISH EXISTING DOOR AND HARDWARE. PREPARE EXISTING FRAME TO RECEIVE NEW DOOR.
- DEMOLISH EXISTING PAVING COMPLETE. SEE CIVIL DRAWINGS FOR ADDITIONAL INFORMATION.
- DEMOLISH EXISTING BOLLARDS COMPLETE. SEE CIVIL DRAWINGS FOR ADDITIONAL INFORMATION.
- REMOVE EXISTING COMPACTOR CONTROLS AND STRUCTURAL SUPPORT. PROTECT AND STORE FOR REUSE IN NEW WORK. SEE DETAIL PHOTO "B" THIS SHEET FOR ADDITIONAL INFORMATION.
- EXISTING WALL MOUNTED CONTROLS FOR HYDRAULIC LIFT TO BE REMOVED. EXISTING CONDUIT AND INFRASTRUCTURE TO BE REUSED FOR NEW LIFT.
- SAWCUT OPENING IN EXISTING CONCRETE DOCK WALL AND SLAB. PREPARE FOR NEW STAIRS AND HANDRAIL IN NEW WORK.
- DEMOLISH EXISTING STORAGE AREA FENCING COMPLETE, INCLUDING ALL COMPONENTS. SEE CIVIL DRAWINGS FOR ADDITIONAL INFORMATION.
- DEMOLISH EXISTING FIRE DOOR, HARDWARE AND FRAME. PREPARE EXISTING OPENING TO RECEIVE NEW DOOR AND FRAME.

**GENERAL DEMOLITION NOTES**

- ALL ITEMS SHOWN WITH HATCHED LINES INDICATE ITEMS TO BE DEMOLISHED. SEE ARCHITECTURAL DRAWINGS AND CODED DEMOLITION NOTES FOR SPECIFIC INFORMATION.
- LOCATION OF EXISTING ITEMS AND ALL CONCEALED WORKS, ETC. ARE APPROXIMATE. THE CONTRACTOR SHALL EXAMINE THE SITE AFTER DEMOLITION HAS EXPOSED "AS-BUILT" CONDITIONS TO VERIFY EXISTING CONDITIONS. THE CONTRACTOR SHALL MAKE ADJUSTMENTS AND/OR ALTERATIONS AS NECESSARY TO INSTALL COMPLETE AND OPERABLE SYSTEMS IN ACCORDANCE WITH THE CODES HAVING JURISDICTION AT NO ADDITIONAL COST TO THE GOVERNMENT
- ALL OPENINGS AND SURFACES MADE BARE BY DEMOLITION AND/OR REMOVAL OF MATERIALS SHALL BE REPAIRED AND/OR PATCHED TO MATCH ADJACENT FINISH. PREPARE SURFACES TO RECEIVE NEW FINISH, SEE ARCHITECTURAL DRAWINGS FOR NEW FINISH SCHEDULE. ALL REPAIRS AND NEW FINISH SHALL BE BY TRADES SKILLED IN FINISH WORK.
- DURING THE LIFE OF THE CONTRACT (CONSTRUCTION AND DEMOLITION TO POINT OF BENEFICIAL OCCUPANCY BY OWNER). THE CONTRACTOR SHALL PROTECT MATERIALS TO REMAIN FOR REUSE FROM DAMAGE.
- SEE ARCHITECTURAL DRAWINGS AND SPECIFICATION FOR ADDITIONAL INFORMATION. COORDINATE ALL DEMOLITION WITH ALL TRADES INVOLVED. SEE CIVIL, STRUCTURAL, AND ELECTRICAL DRAWINGS FOR ADDITIONAL INFORMATION.
- EMERGENCY EGRESS ROUTES SHALL NOT BE BLOCKED FOR AN EXTENDED PERIOD OF TIME. COORDINATE WITH CONTRACTING OFFICER.
- PROVIDE PARTIAL OR FULL DEMOLITION OF LOADING DOCK CONCRETE SLAB AND WALL. SEE STRUCTURAL DRAWINGS FOR ADDITIONAL INFORMATION ON EXTENT OF DEMOLITION TO BE PERFORMED.

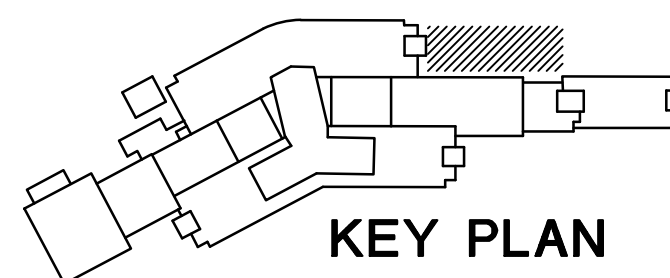

**KEY PLAN**

**FINAL SUBMISSION**

<b>CONSULTANTS:</b>			<b>ARCHITECT/ENGINEERS:</b>		<b>Drawing Title</b> <b>LOADING DOCK EXISTING &amp; DEMOLITION</b>		<b>Project Title</b> <b>CORRECT SAFETY DEFICIENCIES AT LOADING DOCK JAMES PETERS MEDICAL CENTER, BRONX, NY</b>		<b>Project Number</b> 526-13-108		<b>Office of Construction and Facilities Management</b>  				
			 <b>BES</b> ARCHITECTS ENGINEERS CONSTRUCTORS P.O. BOX 2060, BEAUFORT, S.C. 29901-2060 843-522-2094		Approved Project Director		Location		<b>Building Number</b> N/A						
<b>Revisions:</b>		<b>Date</b>				Date 11/07/2014		Checked RLD		Drawn JMA		<b>Drawing Number</b> <b>AD101</b>		<b>Dwg.</b> 20 of 38	