

PLOT DATE : 5/16/2012 2:24 PM FILE SAVED BY :ROBERT SIMMONS ON 5/16/2012 2:19 PM T:\GEO TECH\PROJECTS\GEO TECH\HUNTINGTON VA HOSPITAL SLIDE\DWG\VA HUNTINGTON DESIGN ROTATE WALL DOWN.DWG

# LEGEND

- PROPERTY LINE
- TRACT LINE
- RIGHT OF WAY
- STREAM/DITCH
- EXISTING FENCE LINE
- EXISTING SANITARY SEWER
- EXISTING STORM SEWER
- EXISTING WATER LINE
- EXISTING GAS LINE
- OVERHEAD ELECTRIC
- OVERHEAD TELEPHONE
- OVERHEAD CABLE
- OVERHEAD ELECTRIC/CABLE
- OVERHEAD ELECTRIC/CABLE/TELEPHONE
- OVERHEAD ELECTRIC/TELEPHONE
- OVERHEAD CABLE/TELEPHONE
- UNDERGROUND FIBER
- UNDERGROUND ELECTRIC
- UNDERGROUND TELEPHONE
- UNDERGROUND CABLE
- UNDERGROUND ELECTRIC/TELEPHONE
- 5/8" REBAR WITH CAP SET
- FOUND MONUMENTATION
- BENCH MARK
- CALCULATED POINT
- LIGHT POLE
- EXISTING FIRE HYDRANT
- EXISTING WATER OR GAS METER
- EXISTING WATER OR GAS VALVES
- TELEPHONE OR ELECTRIC RISER
- UTILITY POLE
- GRAVEL AREA
- CONCRETE AREA

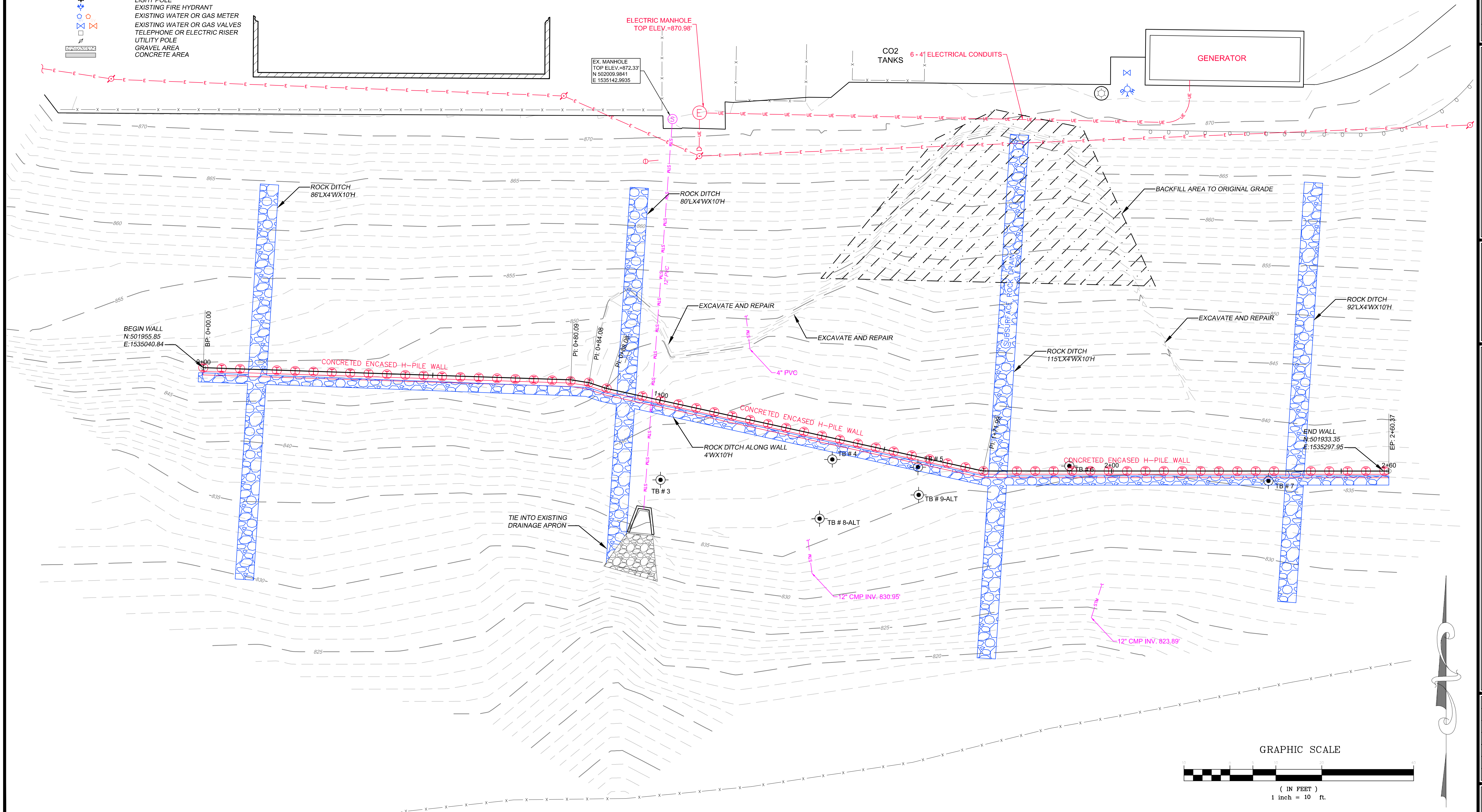

NO.	DATE	REVISION

**TERRADON**  
Engineering - Surveying - Landscape Architecture  
P.O. Box 519  
Nitro, West Virginia 25143  
(304) 755-8291 FAX 755-2636  
www.terraddon.com



## HUNTINGTON VA HOSPITAL SLIDE REPAIR

## HUNTINGTON, WEST VIRGINIA ENLARGED SITE PLAN

Project No.	12048-0001
Drawn:	EWJ
Checked:	JWJ
Approved:	JWJ
Scale:	1"=10'
Date:	5-9-2012
CAD File #	VA HUNTINGTON 4-3-12

C2