

## STATEMENT OF WORK

1. **Transaction:** 550-18-1-2959-0007, Furniture for New Decatur CBOC Activation.
2. **Background:** The furniture under this order consists of workstations, desks, tables, chairs, stools, storage cabinets, filing cabinets, bookcases, mobile technical carts, bulletin boards, and magazine holders for the activation of the new Decatur Community Based Outpatient Clinic (CBOC) located at 792 N. Sunnyside Road, Decatur, IL, 62522. These are items specified to materially, functionally and aesthetically fit the needs of the new Clinic.
3. **General Requirements:** The Vendor shall furnish all supplies, equipment, fasteners, fixtures and services required to perform the service under this contract.

**A. VA Coordination:** Selected Vendor shall coordinate with the VA Contracting Officer Representative (COR), Mark Shoviak, VA Projects Section Chief at (217) 554-4160 to finalize all color selections prior to placing order in production.

**B. Submittals:** The Vendor shall provide 3D and single plan view drawings for all typicals, to include corresponding parts list, evidencing compliance with all salient characteristics. For each Series of exposed finish required, provide a sample, not less than three (3) inches square, of same thickness and material indicated for the work. Sample(s) shall be submitted within 10 business days of award. If finishes involve normal color and texture variations, include sample sets showing the full range of variations expected. Literature and specifications shall be submitted within 10 business days of award.

**C. Delivery and Installation:** The Vendor shall deliver and install furniture concurrently with the activation phase for Government operational use no later than the expected dates of occupancy of the project. The activation phase is anticipated to start 4/16/2018 after construction completion and end 5/23/2018. The Government will not provide on-site storage for furniture requirements delivered before the start of the activation phase. Necessary storage must be included in proposal.

**D. Brand Name or Equal:** Substitution requests ("Or Equals") shall meet salient characteristics outlined in this Statement of Work. Substitution requests shall be similar to the specified dimensions, color scheme, function, and quality. "Or equal" products submissions shall include manufacturer's product brochure including specification information, warranty data, and physical samples of manufacturer's full range of finish options. All specified product(s) shall be under standard GSA Contract warranties.

**E. Installation:** Installation shall be performed by a licensed and bonded installation company, including any proprietary certifications necessary to maintain product warranties. The Installation Vendor shall have a minimum of three years of knowledge and experience with the products being installed. The Vendor shall ensure all staff arrives on site with all necessary tools and equipment required for the installation including dollies, ladders, hand tools and carts to deliver and install the products as required from

dock to installation work site. The Vendor shall provide floor protection. All material handling equipment shall have rubber wheels. Any damage incurred through the delivery or installation process must be repaired within 30 days at the furniture Vendor's expense.

**F. Safety:** All Vendor staff shall come to the job site equipped with all necessary safety gear including but not limited to eye protection, hard hats, etc.

**G. Deliveries and Work Schedule:** All deliveries must be scheduled through the COR before installation. All work is to be performed between 8:00am and 4:00pm weekdays, unless specifically coordinated otherwise with the COR. Vendor is responsible for notifying COR in advance of arrival and departure,

**H. Security:** The Vendor shall supply a list of personnel requiring access to the installation location five (5) days before starting work. There shall be no smoking, eating, or drinking inside the clinic at any time. Smoking in designated areas outside the buildings shall be allowed.

**I. Acceptance Inspection:** The Vendor shall conduct a joint inspection with the COR once all Furniture has been installed. The COR shall inspect all phases of delivery and installation with a sign-off of any and all missing or damaged products in the form of a Vendor provided punch list. The Vendor shall provide detailed punch list items and established dates for replacement parts and/or short ship items from the manufacturer(s). The COR shall ensure all work is completed satisfactorily prior to acceptance. Disputes shall be resolved by the Contracting Officer.

**J. Clean-up:** The Vendor shall remove all related shipping debris and construction cleanup associated with installation of the furniture. The Vendor shall be responsible for any damage to the building that occurs due to Vendor error or neglect. The Vendor shall be responsible for the coordination of staging areas and parking within the receiving area of the building.

4. **Scope:** The Vendor shall provide and install the furniture items listed in Attachment 1. Reference the Furniture Plan at Attachment 2 for corresponding room numbers and item placement locations. For each item, provide the specified Brand Name or Equal. All items must meet or exceed the specified Brand Name manufacturer's salient characteristics. All furnishing need to have anti-microbial properties and meet NFPA 101 requirements for furnishings.
5. **Guarantee/Warranty:** The Vendor is an authorized dealer for any Name Brand or Equal furniture items provided. Only Name Brand or Equal components and approved installation practices will be used. The Vendor warrants the installation against defects of materials and workmanship under normal use and service for one year from the date of installation. The Vendor will field-repair equipment or provide an equivalent loaned item while the item is under repair or replaced if necessary to the satisfaction of the Government. All furnishing items shall have a limited lifetime warranty for normal use and service. The Vendor shall provide a copy of the written warranty upon delivery of the equipment.

6. **Selection Criteria**: Submit a proposal on company letterhead for the above outlined products and services. Material and installation/delivery charges are to be listed separately. Only specified Name Brand, Equal or Better items on GSA schedule will be considered.

### Attachment 1 – Furnishings Listing

**A. Furniture Item: C1, Waiting Room and Conference Room Guest Chair**

Quantity: 36 each

Rooms: 101, 109, 110, and 180

Brand Name, Series: National Office Furniture, Timberlane Wood Side Chair

Part Number: 39A-GWXX

Salient Characteristics/Options:

- With arms
- 4 leg base
- 300-pound seating capacity
- 3/4 upholstered back
- Upholstered back and seat
- No contrasting fabric
- Finish, fabric: Grade 4 vinyl (standard manufacturer's color, provide standard color samples per paragraph 3B); fabric must be vinyl for easy cleaning for infection control
- Finish, frame: wood (standard manufacturer's color, provide standard color samples per paragraph 3B)
- Example photo:



**B. Furniture Item: C2, Waiting Room Bariatric Guest Chair**

Quantity: 6 each

Rooms: 101, 109, and 110

Brand Name, Series: National Office Furniture, Timberlane Bariatric Guest Chair

Part Number: 39A-BWAA

Salient Characteristics/Options:

- With arms
- 4-leg base
- 500-pound seating capacity
- 3/4 upholstered back
- Upholstered back and seat
- No contrasting fabric
- Finish, fabric: Grade 4 vinyl (standard manufacturer's color, provide standard color samples per paragraph 3B); fabric must be vinyl for easy cleaning for infection control
- Finish, frame: wood (standard manufacturer's color, provide standard color samples per paragraph 3B)
- Example photo:



**C. Furniture Item: C3a, Waiting Room and Conference Room Guest Chair**

Quantity: 2 each

Rooms: 102

Brand Name, Series: National Office Furniture, Timberlane Guest Chair

Part Number: 39A-GRXX

Salient Characteristics/Options:

- No arms
- 4 leg base
- 300-pound seating capacity
- 3/4 upholstered back
- Upholstered back and seat
- No contrasting fabric
- Finish, fabric: Grade 4 vinyl (standard manufacturer's color, provide standard color samples per paragraph 3B); fabric must be vinyl for easy cleaning for infection control
- Finish, frame: wood (standard manufacturer's color, provide standard color samples per paragraph 3B)
- Example photo:



**D. Furniture Item: C4, Side Chair**

Quantity: 10 each

Rooms: 101 and 159

Brand Name, Series: SitOnIt Seating, Freelance Chair

Part Number: 5234.UP

Salient Characteristics/Options:

- With arms
- Sled base
- 300-pound seating capacity
- Upholstered back and seat
- Finish, fabric: Grade 5 vinyl (standard manufacturer's color, provide standard color samples per paragraph 3B); fabric must be vinyl for easy cleaning for infection control
- Finish, frame: metal (standard manufacturer's color, provide standard color samples per paragraph 3B)
- Example photo:



**E. Furniture Item: C6, Training Side Chair**

Quantity: 42 each

Rooms: 106, 108, 179, 124 Team Work Zone #1, and 158 Team Work Zone #2

Brand Name, Series: Herman Miller, Caper Chair

Part Number: WC410P

Salient Characteristics/Options:

- Fixed arms
- 4 leg base
- Casters for both carpet and hard floor
- Molded poly seat and back; must be poly for easy cleaning for infection control
- 300-pound seating capacity
- Finish, set/back: molded plastic, black
- Finish, frame: black
- Example photo:





**F. Furniture Item: C7, Training Side Chair**

Quantity: 14 each

Rooms: 106, 108, and 179

Brand Name, Series: Herman Miller, Caper Chair

Part Number: WC410N

Salient Characteristics/Options:

- No arms
- 4 leg base
- Casters for both carpet and hard floor
- Molded poly seat and back; must be poly for easy cleaning for infection control
- 300-pound seating capacity
- Finish, set/back: molded plastic, black
- Finish, frame: black
- Example photo:



**G. Furniture Item: C8, Exam Room Side Chair**

Quantity: 16 each

Rooms: 115, 118, 119, 120, 130, 131, 136, 137, 144, 145, 146, 147, 149, 152, 153, and 160

Brand Name, Series: SitOnIt Seating, Freelance Chair

Part Number: 5213.UP

Salient Characteristics/Options:

- No arms
- 4 leg base
- Vinyl floor glides
- 300-pound seating capacity
- Upholstered back and seat
- Finish, fabric: Grade 5 vinyl (standard manufacturer's color, provide standard color samples per paragraph 3B); fabric must be vinyl for easy cleaning for infection control
- Finish, frame: metal (standard manufacturer's color, provide standard color samples per paragraph 3B)
- Example photo:



**H. Furniture Item: C9, Exam Room Side Chair**

Quantity: 21 each

Rooms: 112, 118, 119, 130, 131, 132, 133, 136, 138, 144, 145, 147, 148, 152, 154, 160, 162, 164, 165, 166, and 167

Brand Name, Series: SitOnIt Seating, Freelance Chair

Part Number: 5214.UP

Salient Characteristics/Options:

- With arms
- 4 leg base
- Vinyl floor glides
- 300-pound seating capacity
- Upholstered back and seat
- Finish, fabric: Grade 5 Vinyl (standard manufacturer's color, provide standard color samples per paragraph 3B); fabric must be vinyl for easy cleaning for infection control
- Finish, frame: metal (standard manufacturer's color, provide standard color samples per paragraph 3B)
- Example photo:



**I. Furniture Item: C10, Exam Room Side Bariatric Chair**

Quantity: 11 each

Rooms: 117, 121, 146, 160, 163, 170, 171, 172, 173, and 174

Brand Name, Series: SitOnIt Seating, Freelance 42-inch Wide Bariatric Chair

Part Number: 5414

Salient Characteristics/Options:

- With arms
- 4 leg base
- Vinyl floor glides
- 1000-pound seating capacity
- Upholstered back and seat
- Finish, fabric: Grade 5 vinyl (standard manufacturer's color, provide standard color samples per paragraph 3B); fabric must be vinyl for easy cleaning for infection control
- Finish, frame: metal frame finish (standard manufacturer's color, provide standard color samples per paragraph 3B)
- Example photo:



**J. Furniture Item: C11, Exam Room Physicians Stools**

Quantity: 18 each

Rooms: 112, 115, 117, 120, 121, 125, 126, 132, 133, 137, 138, 153, 162, 163, 164, 165, 166, and 167

Brand Name, Series: Hon, Medical Exam Task Stool

Part Number: HMTS01

Salient Characteristics/Options:

- 38-inch overall height
- 24-inch base diameter
- 16-inch seat diameter
- Pneumatic height adjustment
- 250-pound seating capacity
- Finish, fabric: vinyl, black
- Example photo:



**K. Furniture Item: C12, Task Chair**

Quantity: 70 each

Rooms: 103, 109, 118, 119, 128, 130, 131, 136, 144, 145, 146, 147, 148, 149, 152, 154, 159, 162, 170, 171, 172, 173, 174, 124 Team Work Zone #1, and 158 Team Work Zone #2

Part Number: CJ123AAHC

Brand Name, Series: Herman Miller, Celle Chair

Salient Characteristics/Options:

- Cellular suspension back
- Adjustable arms
- Tilt limiter/back lock
- Adjustable seat depth
- Adjustable lumbar
- 350-pound seating capacity
- Casters for both hard floor and carpet
- Need locking casters for two chairs in Room 162
- Finish, fabric: Grade 1 Vinyl, graphite; fabric must be vinyl for easy cleaning for infection control
- Finish, frame: graphite
- Example photo:



**L. Furniture Item: C13, Lounge Chair**

Quantity: 5 each

Rooms: 154, 171, 172, 173, and 174

Brand Name, Series: National Office Furniture, Reno

Part Number: QN32AAMS

Salient Characteristics/Options:

- Lounge seating
- Removable seat cushion for cleaning
- Finish, fabric: Grade 4 Vinyl (standard manufacturer's color, provide standard color samples per paragraph 3B); fabric must be vinyl for easy cleaning for infection control
- Finish, legs: metal (standard manufacturer's color, provide standard color samples per paragraph 3B)
- Example photo:



**M. Furniture Item: C14, Conference Room Task Chair**

Quantity: 16 each

Rooms: 177 and 180

Brand Name, Series: SitOnIt Seating, Focus **Work**

Part Number: ~~5623TB4-A91~~

**Back: 5623 B4**

**Swivel Tilt: Y**

**Seat Depth Adjustment: E3**

**Frame: Z1**

**Arms: A91**

**Base: B0**

**Casters: C15**

**Cylinder: S0**

**Material: FG5**

**Packaging: UC**

**Salient Characteristics/Options:**

- High back
- A 91 fixed arms
- Swivel tilt control
- Seat depth adjustment
- Carpet casters
- Upholstered seat and back
- Finish, fabric: Grade 5 vinyl (standard manufacturer's color, provide standard color samples per paragraph 3B); fabric must be vinyl for easy cleaning for infection control
- Finish, frame: (standard manufacturer's color, provide standard color samples per paragraph 3B)
- Example photo:





**N. Furniture Item: T1, Waiting Room and Office Side Table**

Quantity: 24 each

Rooms: 101, 109, 110, 118, 119, 130, 131, 136, 146, 152, 154, and 160

Brand Name, Series: National Office Furniture, Myriad Cylindrical End Table

Part Number: 91NA242CYL

Salient Characteristics/Options:

- Laminate
- 24-inch diameter tabletop x 20.5-inch high base
- Finish, laminate: (standard manufacturer's color, provide standard color samples per paragraph 3B)
- Example photo:



**O. Furniture Item: T2, Waiting Room Table**

Quantity: 1 each

Rooms: 102

Brand Name, Series: Herman Miller, Everywhere Round Table

Part Number: DT1CS.30LS

Salient Characteristics/Options:

- Laminate
- 30-inch diameter tabletop
- Finish, laminate: (standard manufacturer's color, provide standard color samples per paragraph 3B)
- Finish, base: metal (standard manufacturer's color, provide standard color samples per paragraph 3B)
- Example photo:



**P. Furniture Item: T3, Group Room Table**

Quantity: 16 each

Rooms: 106 and 108

Brand Name, Series: Herman Miller, Everywhere Flip-Top Table

Part Number: DT5AS.2460LT

Salient Characteristics/Options:

- 24-inch depth x 60-inch width
- Flip/nest T-leg base
- Laminate top
- Locking casters for carpet and hard floor
- Finish, laminate: (standard manufacturer's color, provide standard color samples per paragraph 3B)
- Finish, base: metal (standard manufacturer's color, provide standard color samples per paragraph 3B)
- Example photo:



**Q. Furniture Item: T4, Fitting Room Table**

Quantity: 1 each

Rooms: 159

Brand Name, Series: Herman Miller, Everywhere Rectangular Table

Part Numbers:

- DT1AS.3060LP table
- LW100.24BBF pedestal with pull, freestand 24D B/B/F

Salient Characteristics/Options:

- 30-inch depth x 60-inch width
- Post legs
- Laminate top
- Vinyl floor glides
- Box/Box/File metal pedestal; 3/4 -extension roller slides on box drawer, full-extension ball bearing on file drawer, smooth paint on steel, keyed alike, raised height, drawer divider in one box drawer, pencil tray in one box drawer, 2 file converters in file drawer
- Finish, laminate: (standard manufacturer's color, provide standard color samples per paragraph 3B)
- Finish, base: (standard manufacturer's color, provide standard color samples per paragraph 3B)
- Finish, pedestal: (standard manufacturer's color, provide standard color samples per paragraph 3B)
- Example photo:



**R. Furniture Item: T5, Team Work Zone Table**

Quantity: 2 each

Rooms: 124 Team Work Zone #1 and 158 Team Work Zone #2

Brand Name, Series: Herman Miller, Everywhere Round Table

Part Number: DT1CS.42LX

Salient Characteristics/Options:

- 42-inch diameter
- Laminate top
- Locking casters for carpet and hard floor
- Finish, laminate: (standard manufacturer's color, provide standard color samples per paragraph 3B)
- Finish, base: metal (standard manufacturer's color, provide standard color samples per paragraph 3B)
- Example photo:



**S. Furniture Item: T6, Conference Room Table**

Quantity: 2 each

Rooms: 177 and 180

Brand Name, Series: National Office Furniture, Footings Conference Table

Part Numbers:

- 83N4296SRTL (top)
- CBV286428YBKP (footing)

Salient Characteristics/Options:

- 42-inch depth x 96-inch width soft rectangular top
- Laminate top
- Metal Y-base
- Finish, laminate: (standard manufacturer's color, provide standard color samples per paragraph 3B)
- Finish, base: metal (standard manufacturer's color, provide standard color samples per paragraph 3B)
- Example photo:

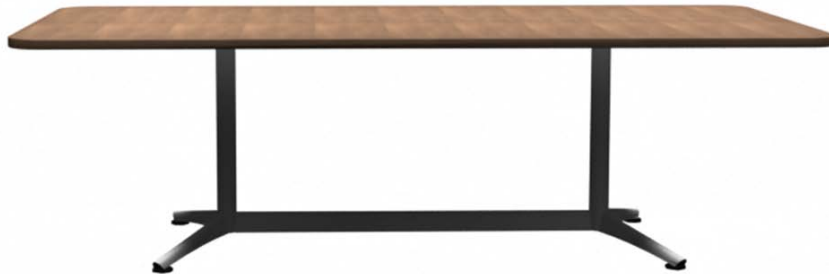

**T. Furniture Item: T7, Lounge Table**

Quantity: ~~1 each~~ **2 each**

Rooms: 179

Brand Name, Series: National Office Furniture, ~~Epic Table~~ **Footings**

Part Numbers:

- 83N3696SRTL (top)
- CBV246228YBKP (footing)

Salient Characteristics/Options:

- 36-inch depth x 96-inch width soft rectangular top
- Laminate top
- Metal Y-base
- Finish, laminate: (standard manufacturer's color, provide standard color samples per paragraph 3B)
- Finish, base: metal (standard manufacturer's color, provide standard color samples per paragraph 3B)
- Example photo:

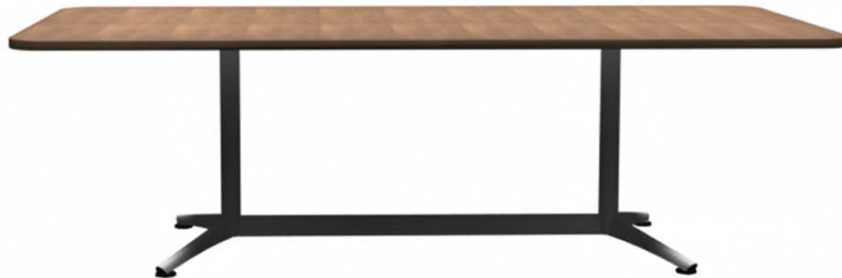

**U. Furniture Item: D1, Reception Desk**

Quantity: 1 each

Rooms: 109

Brand Name, Series: Herman Miller, Canvas

Part Numbers:

- FTS35.3072LF peninsula surface, round end, square-edge, laminate top/thermos edge, 30D 72W, frame atch
- FT280.36LP transition surface, square-edge, laminate top/thermos edge, standard top cap, 36W
- LW100.24BBF pedestal with pull, freestand 24D B/B/F
- FT121.246 conn 90, universal, 2-way, 90 deg-for 46H frames and lower
- E2931.L work surface support bracket left (4 pk)
- E2931.R work surface support bracket right (4 pk)
- FT110.4230N frame base covers, no knockouts 42H 30W
- FT110.4236N frame base covers, no knockouts 42H 36W
- FT112.30AP frame top cap, standard painted 30W
- FT123.242BP conn cover 90-deg, 2 sides covered, base cover painted 42H
- FT126.2AP top cap, conn 90-deg, connects 2 frame top caps, 90-deg painted
- FT160.42BP finished end, base cover painted 42H (2 ea)
- FV2D1.A30F square open support leg, inset for 30"D surface, fixed height
- FT170.3030L lower tile, laminate 30H 30W
- FT170.3036L lower tile, laminate 30H 36W
- FT180.3730L tile, full-height, laminate 37H 30W
- FT180.3736L tile, full-height, laminate 37H 36W
- FT181.0730T upper tile, tackable fabric 07H 30W
- FT181.0736T upper tile, tackable fabric 07H 36W

Salient Characteristics/Options:

- 30-inch deep x 72-inch width laminate peninsula worksurface, thermos edge
- 42-inch high panels, 30-inch and 36-inch wide
- Wood grain laminate exteriors
- Grade 2 fabric interiors with tackable/acoustical tiles
- Laminate transaction top, thermos edge
- Box/Box/File metal pedestal; 3/4 -extension roller slides on box drawer, full-extension ball bearing on file drawer, smooth paint on steel, keyed alike, raised height, drawer divider in one box drawer, pencil tray in one box drawer, 2 file converters in file drawer
- Key alike
- Finish, fabric: Grade 2 (standard manufacturer's color, provide standard color samples per paragraph 3B)
- Finish, laminate: (standard manufacturer's color, provide standard color samples per paragraph 3B)
- Finish, paint: (standard manufacturer's color, provide standard color samples



per paragraph 3B)

- Finish, pedestal: (standard manufacturer's color, provide standard color samples per paragraph 3B)
- Example layout/photo:

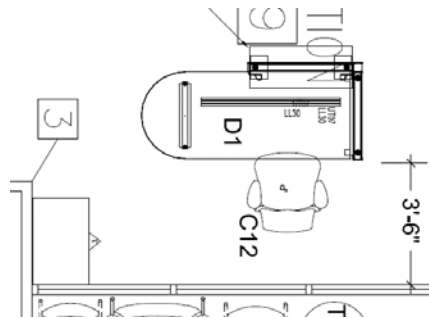

**V. Furniture Item: D2, Fitting Room Table**

Quantity: 7 each

Rooms: 130, 146, 170, 171, 172, 173, and 174

Brand Name, Series: Herman Miller, Canvas

Part Numbers:

- FTS10.3060LS rectangular surface, square edge, laminate top/thermos edge, 30D 60W, no brackets
- FV2E2.S30FL closed support leg for square edge surface, 30D, fixed height, laminate (2 per table)
- FV697.60FL modesty panel, full modesty panel, 60W laminate
- LW100.24BBF pedestal with pull, freestanding 24D B/B/F

Salient Characteristics/Options:

- 30-inch depth x 60-inch width laminate desk shell
- Inset full modesty panel
- Full laminate end panels
- Box/Box/File metal pedestal; 3/4 -extension roller slides on box drawer, full-extension ball bearing on file drawer, smooth paint on steel, keyed alike, raised height, drawer divider in one box drawer, pencil tray in one box drawer, 2 file converters in file drawer (all options per table)
- Keyboard tray-19-inch track, 20-inch HDPE tray with adjustable mouse tray
- Key alike
- Finish, laminate: (standard manufacturer's color, provide standard color samples per paragraph 3B)
- Finish, paint: (standard manufacturer's color, provide standard color samples per paragraph 3B)
- Finish, pedestal: (standard manufacturer's color, provide standard color samples per paragraph 3B)
- Example layout/photo:

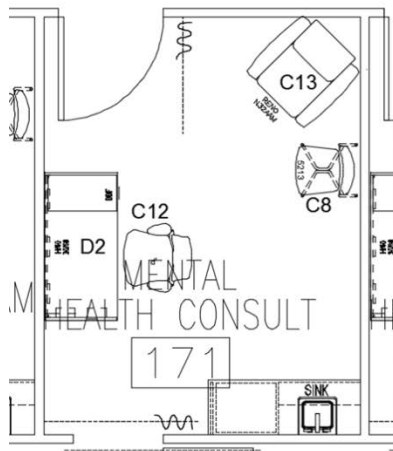

**W. Furniture Item: D3, Patient Advocate Office Desk and Storage**

Quantity: 1 each

Rooms: 145

Brand Name, Series: Herman Miller, Canvas Private Office

Part Numbers:

- FTS10.2460LS rectangular surface, square edge, laminate top/thermos edge, 24D 60W, no brackets
- FTS10.3072LS rectangular surface, square edge, laminate top/thermos edge, 30D 72W, no brackets
- FV2E2.S30FL closed support leg for square edge surface, 30D, fixed height, laminate (2 each)
- FV697.72FL modesty panel, full modesty panel, 72W laminate
- FT29B.2 surface ganging bracket pair
- FV696.48 Stiffner, 48W (2 each)
- G6120.60NS task light, no dim, AO/etho/canvas, 60W
- LTPL-06020 file top, laminate top/TP edge 60W 20D
- FV980.HM1260R tackboard, hutch mounted, fabric, 12H 60W
- LW100.24BBF pedestal with pull, freestand 24D B/B/F
- LW100.24FF pedestal with pull, freestand 24D F/F
- FV442.WM1560LPL cabinet, overhead storage, full enclosure, wall mounted, case/primary door laminate, secondary door pointed, lock, 15H 60W

Salient Characteristics/Options:

- 30-inch depth X 72-inch wide main desk, laminate, thermos edge
- 24-inch depth X 60-inch wide return, laminate, thermos edge
- Full laminate recessed modesty panel
- Closed end panels
- Box/Box/File metal pedestal; ¾-extension roller slides on box drawer, full-extension ball bearing on file drawer, smooth paint on steel, keyed alike, raised height, drawer divider in one box drawer, pencil tray in one box drawer, 2 file converters in file drawer (all options per table)
- File/File metal pedestal; full-extension ball bearing on file drawer, smooth paint on steel, keyed alike, raised height, 2 file converters in each file drawer
- Wall mounted laminate overhead with sliding locking doors
- 60-inch wide X 12-inch high wall mounted tackboard
- 60-inch energy efficient task light
- 2 each 30-inch wide lateral files, front to back filing with common laminate top
- Key alike
- Finish, fabric: Grade 2 (standard manufacturer's color, provide standard color samples per paragraph 3B)
- Finish, laminate: (standard manufacturer's color, provide standard color samples per paragraph 3B)
- Finish, paint: (standard manufacturer's color, provide standard color samples per paragraph 3B)

- Finish, pedestal: (standard manufacturer's color, provide standard color samples per paragraph 3B)
- Example layout/photo:



Note: Example picture shows 2 drawer high lateral file. Requirement is for 4 drawer high lateral file. See EE. Furniture Item: F3, Filing, for this item.

**X. Furniture Item: D4, Nurse Manager Office Desk and Storage**

Quantity: 2 each

Rooms: 144

Brand Name, Series: Herman Miller, Canvas Private Office

Part Numbers:

- FTS10.2442LS rectangular surface, square edge, laminate top/thermos edge, 24D 42W, no brackets
- FTS10.3060LS rectangular surface, square edge, laminate top/thermos edge, 30D 60W, no brackets
- FV2E2.S30FL closed support leg for square edge surface, 30D, fixed height, laminate (2 per table)
- FV697.60HL modesty panel, half modesty panel, 60W laminate
- G6120.60NS task light, no dim, AO/etho/canvas, 60W
- FV980.HM1260R tackboard, hutch mounted, fabric, 12H 60W
- FV442.WM1560LPL cabinet, overhead storage, full enclosure, wall mounted, case/primary door laminate, secondary door pointed, lock, 15H 60W
- FV696.39 Stiffner, 38-5/8W
- FT29B.2 Surface ganging bracket pair
- LW100.24BBF pedestal with pull, freestand 24D B/B/F, 3/4 -extension roller slides on box drawer, full-extension ball bearing on file drawer, smooth paint on steel, keyed alike, raised height, drawer divider in one box drawer, pencil tray in one box drawer, 2 file converters in file drawer (all options per table)

Salient Characteristics/Options:

- ~~30-inch depth X 72-inch wide main desk, laminate, thermos edge~~
- 30-inch depth X 60-inch wide main desk, laminate, thermos edge
- ~~24-inch depth X 60-inch wide return, laminate, thermos edge~~
- 24-inch depth X 42-inch wide return, laminate, thermos edge
- Half modesty panel
- Closed end panels
- Box/Box/File metal pedestal; 3/4 -extension roller slides on box drawer, full-extension ball bearing on file drawer, smooth paint on steel, keyed alike, raised height, drawer divider in one box drawer, pencil tray in one box drawer, 2 file converters in file drawer (all options per table)
- Wall mounted laminate overhead with sliding locking doors
- 60-inch wide X 12-inch high wall mounted tackboard
- 60-inch energy efficient task light
- 2 each 30-inch wide lateral files, front to back filing with common laminate top
- Key alike
- Finish, fabric: Grade 2 (standard manufacturer's color, provide standard color samples per paragraph 3B)
- Finish, laminate: (standard manufacturer's color, provide standard color samples per paragraph 3B)
- Finish, paint: (standard manufacturer's color, provide standard color samples

per paragraph 3B)

- Finish, pedestal: (standard manufacturer's color, provide standard color samples per paragraph 3B)
- Example layout/photo:

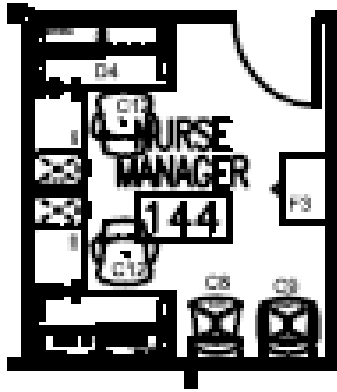

**Y. Furniture Item: D5, Desk**

Quantity: 3 each

Rooms: 147, 148 & 149

Brand Name, Series: Herman Miller, Canvas

Part Numbers:

- FTS10.3036LS rectangular surface, square edge, laminate top/thermos edge, 30D 36W, no brackets (per table)
- FV689.P Support leg, post (4 per table)
- LW110.20BF pedestal with pull, mobile 20D B/F

Salient Characteristics/Options:

- ~~30-inch depth X 72-inch wide laminate freestanding table, thermos edge~~
- **30-inch depth X 36-inch wide laminate freestanding table, thermos edge**
- Four post legs
- Box/File metal pedestal 3/4-extension roller slides on box drawer, full-extension ball bearing on file drawer, smooth paint on steel, keyed alike, drawer divider in one box drawer, pencil tray in one box drawer, 2 file converters in file drawer (all options per table)
- Key alike
- Finish, laminate: (standard manufacturer's color, provide standard color samples per paragraph 3B)
- Finish, paint: (standard manufacturer's color, provide standard color samples per paragraph 3B)
- Finish, pedestal: (standard manufacturer's color, provide standard color samples per paragraph 3B)
- Example layout/photo:



**Z. Furniture Item: D6, Patient Consult (Social) Room**

Quantity: 1 each

Rooms: 152

Brand Name, Series: Herman Miller, Canvas

Part Numbers:

- FTS10.3060LS rectangular surface, square edge, laminate top/thermos edge, 30D 60W, no brackets
- FV697.60FL modesty panel, full modesty panel, 60W laminate
- FV2E2.S30FL closed support leg for square edge surface, 30D, fixed height, laminate (2 per table)
- FM73K.60202ABP06L metal low credenza, open with drawers, bar pull, 2-1/4H base, open left, 30" B/F, painted metal, 1-1/4" laminate top, lock 60W 20D

Salient Characteristics/Options:

- 30-inch depth X 60-inch wide main desk, laminate, thermos edge
- Full laminate end panels
- Full inset laminate modesty panel
- 20-inch X 60-inch metal low credenza, 30-inch bookcase/30-inch box file with laminate top, keyed alike
- Front to back filing
- Finish, fabric: Grade 2 (standard manufacturer's color, provide standard color samples per paragraph 3B)
- Finish, laminate: (standard manufacturer's color, provide standard color samples per paragraph 3B)
- Finish, paint: (standard manufacturer's color, provide standard color samples per paragraph 3B)
- Finish, pedestal: (standard manufacturer's color, provide standard color samples per paragraph 3B)
- Example layout/photo:





**AA. Furniture Item: WS1, Lab Area**

Quantity: 2 each

Rooms: 128

Brand Name, Series: Herman Miller, Canvas

Part Numbers:

- A2310.2454L work surface, square edge, rectangular laminate top/TP edge, 24D 54W ( 1 per table)
- Y5010 drawer, pencil, 21W 16D (1 per table)
- A2381.29 C-leg, 29H (2 per tale)
- AO213.60 wall strip, 60H (3 total)

Salient Characteristics/Options:

- 24-inch depth X 108-inch wide worksurface
- 2 each pencil drawers
- Finish, laminate: (standard manufacturer's color, provide standard color samples per paragraph 3B)
- Finish, bracket: (standard manufacturer's color, provide standard color samples per paragraph 3B)
- Example layout/photo:



**BB. Furniture Item: WS2, Team Zone Work Stations**

Quantity: 40 each

Rooms: 124 Team Zone #1 and 158 Team Zone #2

Brand Name, Series: Herman Miller, Action Office 2

Part Numbers:

- FM73K.60202ABP06L metal low credenza, open with drawers, bar pull, 2-1/4H base, open left, 30" B/F, painted metal, 1-1/4" laminate top, lock 60W 20D (1 per workstation)
- A8125.4760G panel, tac Ac-barr, thin base pwr 4-circ w/com Lc 47H 60W (1 per workstation)
- A2310.3060L work surface, square edge, rectangular laminate top/TP edge, ~~30D 54W~~ **30D 60W** (1 per workstation)
- A1322.06E base power entry, direct connect, 4-circuit, 6 foot length (10 total)
- FM920.0020 front to back filing rail, for 32" or 42" wide drawers, for 20D 2-high lateral file drawers (1 per workstation)
- A1311.A 15 Amp receptacle, 4 circuit, duplex, Circuit A, 6 per pack (7 total)
- A1311.B 15 Amp receptacle, 4 circuit, duplex, Circuit B, 6 per pack (7 total)
- A1311.C 15 Amp receptacle, 4 circuit, duplex, Circuit C, 6 per pack (7 total)
- A1311.DN 15 Amp receptacle, 4 circuit, duplex, Circuit D, 6 per pack (7 total)
- A3610.60 tool bar, -style, 4H 60W (1 per workstation)
- A8380.30L support panel, work surface, end, thin base laminate, 30D (1 per workstation)
- Y1414.J03S logic mini, 1 Simplex receptacle/2 powered USB, 3 foot coord, surface clamp (1 per workstation)
- Y7216.10 paper tray, 10W (2 per workstation)
- Y7218 diagonal tray (1 per workstation)
- A8240.47H connector, 4-way 90 degree, thin base, 47H (10 total)
- A8271.47H finish end, thin base, 47H (1 per workstation)
- Y91178 Concerto single-screen monitor arm support, surface clamp mount, silver (2 per workstation)

Salient Characteristics/Options:

- 47-inch high X 72-inch wide powered panels, tackable/acoustical
- 30-inch depth X 60-inch wide laminate top surface
- Metal low credenza 30-inch open bookcase, 30-inch lateral file, 1-6-inch/1-12-inch drawers with front to back filing rails with common top
- 2 USB / 1 receptacle logic clamp on unit
- Duel monitor arms
- 60-inch tool bar with 1-diagonal tray, 2 paper trays
- Each quad (4 workstation grouping) shall have a base entry location for a direct wired electrical power feed from a floor receptacle. See Attachment 2 Centerline (CL) measurements for location of electrical power floor receptacles.
- 1 A and 1 B duplex receptacle per workstation

- Finish, fabric: Grade 2 (standard manufacturer's color, provide standard color samples per paragraph 3B)
- Finish, laminate: (standard manufacturer's color, provide standard color samples per paragraph 3B)
- Finish, paint: (standard manufacturer's color, provide standard color samples per paragraph 3B)
- Example layout/photo:

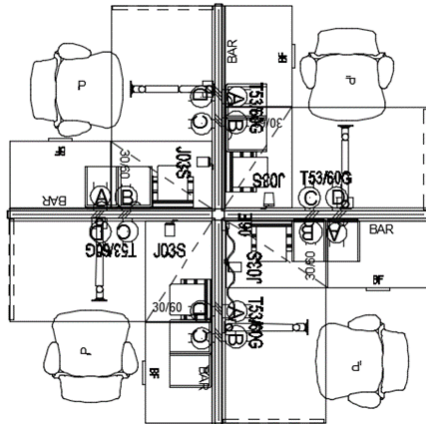

**CC. Furniture Item: F1, Filing**

Quantity: 6 each

Rooms: 162, 163, 164, 165, 166, and 167

Brand Name, Series: Herman Miller, Meridian Lateral File

Part Number: 26-30 20-2E

Salient Characteristics/Options:

- 30-inch wide X 20-inch deep X 28¾-inch high
- Smooth paint on smooth steel
- 4 each 6-inch drawers with dividers
  - Fixed 2-half height 13-1/8 inch drawers with fixed fronts
  - 3 adjustable partitions per half height drawer (12 total per item)
- Standard pull
- Keyed alike
- Laminate top with vinyl edge
- 1-1/2 inch base
- Counterweight
- Finish, laminate: (standard manufacturer's color, provide standard color samples per paragraph 3B)
- Finish, paint: (standard manufacturer's color, provide standard color samples per paragraph 3B)
- Example layout/photo:

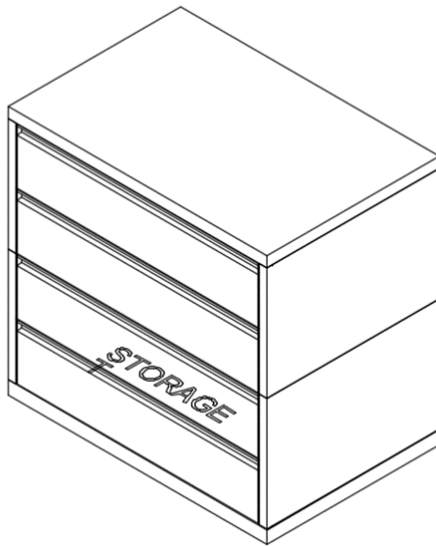

**DD. Furniture Item: F2, Filing**

Quantity: 20 each

Rooms: 124 Team Work Zone #1 and 158 Team Work Zone #2

Brand Name, Series: Herman Miller, TU Lateral File

Part Numbers:

- LW200.423 lateral file, W-pull, freestanding 3 drawer, 42W (20 total)
- LTPL-04220 TU file top, laminate top/TP edge, 42W 20D (2 total)
- LTPL-08440 TU file top, laminate top/TP edge, 84W 40D (4 total)
- LTPL-08420 TU file top, laminate top/TP edge, 84W 20D (1 total)

Salient Characteristics/Options:

- 42-inch wide X 20-inch deep 3 high metal lateral file
- Front to back hanging rails
- Counterweight
- Keyed alike
- Common laminate tops per plan
- Finish, laminate: (standard manufacturer's color, provide standard color samples per paragraph 3B)
- Finish, paint: (standard manufacturer's color, provide standard color samples per paragraph 3B)
- Example layout/photo:



**EE. Furniture Item: F3, Filing**

Quantity: 4 each

Rooms: 109, 128, 144, and 145

Brand Name, Series: Herman Miller, Meridian Lateral File

Part Number: 26-30 20-4N

Salient Characteristics/Options:

- 30-inch wide X 20-inch deep X 4 each 11-3/4-inch high drawers metal lateral file
- Front to back hanging rails
- Counterweight
- Base 2-1/4-inch high
- 1-1/4-inch high laminate top
- ~~2 each drawers keyed alike, 2 each drawers keyed alike~~
- Drawers keyed alike
- Finish, paint: (standard manufacturer's color, provide standard color samples per paragraph 3B)
- Example layout/photo:



**FF. Furniture Item: F4, Storage Cabinet**

Quantity: 2 each

Rooms: 175

Brand Name, Series: Herman Miller, TU Storage Cabinet

Part Number: 46-30 20-63

Salient Characteristics/Options:

- 30-inch wide X 20-inch deep X 60 1/8-inch metal storage cabinet
- 4 adjustable shelves
- Keyed alike
- Finish, paint: (standard manufacturer's color, provide standard color samples per paragraph 3B)
- Example layout/photo:

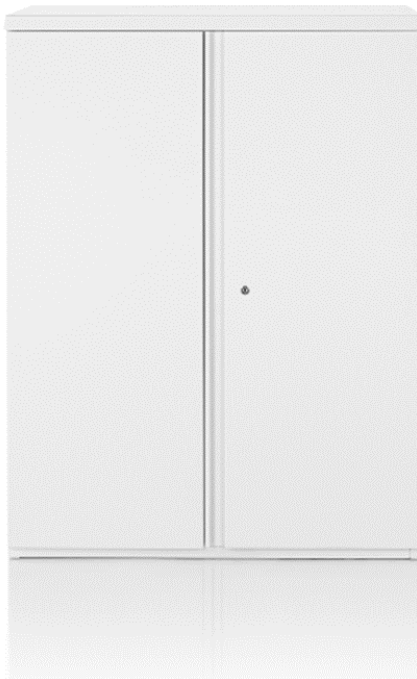

**GG. Furniture Item: F5, Storage Cabinet**

Quantity: 1 each

Rooms: 175

Brand Name, Series: Herman Miller, TU Storage Cabinet

Part Number: 46-42 20-63

Salient Characteristics/Options:

- 42-inch wide X 20-inch deep X 60 1/8-inch metal storage cabinet
- 4 adjustable shelves
- Keyed alike
- Finish, paint: (standard manufacturer's color, provide standard color samples per paragraph 3B)
- Example layout/photo:





**HH. Furniture Item: F6, Storage Cabinet**

Quantity: 1 each

Rooms: 181

Brand Name, Series: Herman Miller, TU Storage Cabinet

Part Number: 46-36 20-63

Salient Characteristics/Options:

- 36-inch wide X 20-inch deep X 60 1/8-inch metal storage cabinet
- 4 adjustable shelves
- Keyed alike
- Finish, paint: (standard manufacturer's color, provide standard color samples per paragraph 3B)
- Example layout/photo:



## II. Furniture Item: F7, Storage Cabinet

Quantity: 2 each

Rooms: 181

Brand Name, Series: Herman Miller, TU Storage Cabinet

Part Numbers:

- 46-42 20-38 standing case, standard pull, 42W 20D, case height 35-1/4"
- LTPL-06020 TU file top, laminate top/TP edge, 60W 20D (2 total)

Salient Characteristics/Options:

- 42-inch wide X 20-inch deep X 35¼-inch metal storage cabinet
- 2 adjustable shelves
- Laminate top
- Keyed alike
- Finish, laminate: (standard manufacturer's color, provide standard color samples per paragraph 3B)
- Finish, paint: (standard manufacturer's color, provide standard color samples per paragraph 3B)
- Example layout/photo:



**JJ. Furniture Item: F8, Conference Room Credenza**

Quantity: 2 each

Rooms: 177 and 180

Brand Name, Series: National Office Furniture, Universal Entertainment Credenza

Part Number: CCW2472CBVLW

Salient Characteristics/Options:

- 24-inch deep X 72-inch wide
- Laminate top, wood edge
- 2 storage compartments and 2 drawers
- Finish, laminate: (standard manufacturer's color, provide standard color samples per paragraph 3B)
- Example layout/photo:



**KK. Furniture Item: F9, Lounge Room Lockers**

Quantity: 5 each

Rooms: 179

Brand Name, Series: Herman Miller, Lockers

Part Number: 4LH.K30203R

Salient Characteristics/Options:

- 30-inch wide X 20-inch deep
- 3 high metal locker units with locks, double door with right hinge
- Laminate top
- 2-1/4-inch base
- Finish, laminate: (standard manufacturer's color, provide standard color samples per paragraph 3B)
- Finish, metal: (standard manufacturer's color, provide standard color samples per paragraph 3B)
- Example layout/photo:



Note – picture is only 2 high; requirement is for 3 high

**LL. Furniture Item: F10, Bookcase**

Quantity: 2 each

Rooms: 102

Brand Name, Series: National Office Furniture, Bookcase

Part Number: 10N3630BCOFL

Salient Characteristics/Options:

- 11¾-inch deep X 35¾-inch wide X 30-inch high
- 2H laminate bookcase
- Open
- Freestanding
- Finish, laminate: (standard manufacturer's color, provide standard color samples per paragraph 3B)
- Example layout/photo:



**MM. Furniture Item: A1, Waiting Public Areas**

Quantity: 6 each

Rooms: 101, 109, 110, and 179 (exact wall locations to be determined at time of installation)

Brand Name, Series: Claridge, Classic Series Bulletin Board Cabinet

Part Number: 1026

Salient Characteristics/Options:

- 48-inch high X 72-inch wide
- Metal case
- Hinged glass doors
- Tackable cork back panels
- Wall mount
- Locks
- Finish, Metal: satin anodized finish
- Finish, tackable surface: cork
- Example layout/photo:



**OO. Furniture Item: A2, Waiting Public Areas**

Quantity: 1 each

Rooms: 102

Brand Name, Series: Peter Pepper, Magazine Holder

Part Numbers:

- 431 - 7 pocket high with painted front panels 14"W x 51.5H x 4"D
- DV480 - pocket dividers

Salient Characteristics/Options:

- 14-inch wide X 51½-inch high 4-inch deep
- 7 pocket chart holder
- 3 pocket dividers
- Finish, wood: (standard manufacturer's color, provide standard color samples per paragraph 3B)
- Finish, paint: (standard manufacturer's color, provide standard color samples per paragraph 3B)

**PP. Furniture Item: A3, Mobile Technical Cart**

Quantity: 21 each

Rooms: 112, 115, 117, 118, 119, 120, 121, 131, 132, 133, 136, 137, 138, 153, 154, 162, 163, 164, 165, 166, and 167

Brand Name, Series: Herman Miller, Mobile Tech Cart

Part Number: CO601.PNNN

Salient Characteristics/Options:

- Flat panel version
- Monitor arm swivels, tilts, and adjusts in height-sit/stand
- 10-onch wide column CPU holder with straps
- Arm meets VESA standards
- Power strip
- Finish, surface: (standard manufacturer's color, provide standard color samples per paragraph 3B)
- Finish, base: (standard manufacturer's color, provide standard color samples per paragraph 3B)
- Example layout/photo:





**QQ. Furniture Item: A4, Keyboard Tray**

Quantity: 5 each

Rooms: 170, 171, 172, 173, and 174

Brand Name, Series: Herman Miller, Keyboard and Mouse Tray

Part Number: Y7737.2A

Salient Characteristics/Options:

- LT Series keyboard tray
- Fully adjustable
- HDPE tray with adjustable mouse tray
- 19-inch track
- Finish, surface: black
- Example layout/photo:



**Attachment 2 – Furniture Plan**

**Attachment 3 – Floor Plan w/ Room Dimensions**