

KEYNOTES

- 1

PROVIDE REMOVAL OF APPROXIMATELY 300 FEET OF ASBESTOS INSULATION ON PIPING IN THIS AREA. REINSULATE PIPING AS PER SPECIFICATION SECTION FOR EXISTING PIPING SYSTEM.
- 2

EXCAVATE A LANDING AREA ON THE CRAWL SPACE SIDE OF DOOR 4' BELOW NEW EQUIPMENT ROOM FLOOR. AREA SHALL BE 3'x5'.

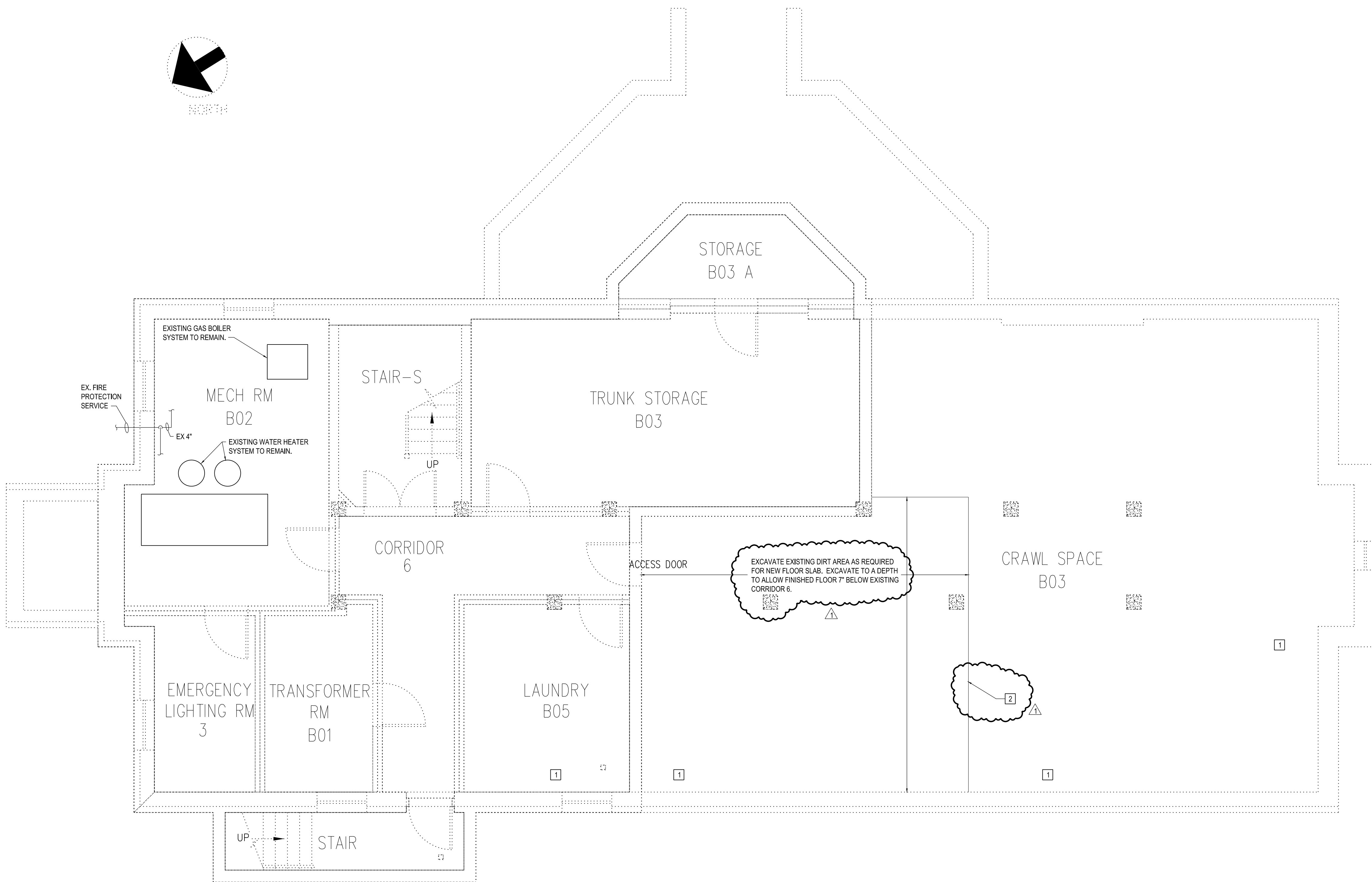

BASEMENT MECHANICAL DEMOLITION PLAN

1/4"=1'-0"

CONSULTANTS:



400 Morgan Center
101 East Diamond Street
Butler, PA 16001
tel: 724.285.4761
fax: 724.285.6815
www.burthill.com

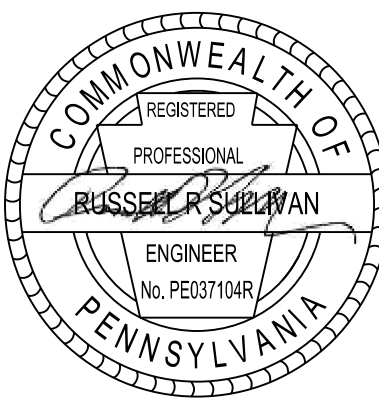

ARCHITECT/ENGINEERS:

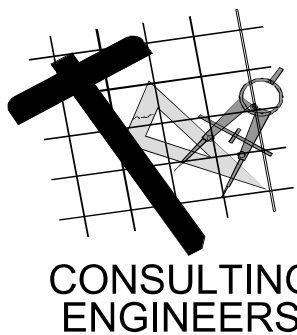

TOLMAN ENGINEERING, PLLC
3610 LAWSON ROAD
JAMESTOWN, NEW YORK 14701
PHONE: (716) 484 - 1366
FAX: (716) 484 - 1519

Drawing Title
**BASEMENT
MECHANICAL DEMOLITION PLAN**

Approved Project Director

Project Title
**REPLACE BUILDING EXTERIOR
GAS LINES**

Location
BUTLER VAMC

Date
02-17-2012

Checked
RRS

Drawn
JJB

Project Number
529-11-109
Building Number
N/A

Drawing Number
MD-1
Dwg. 40 of 48

Office of
Construction
and Facilities
Management

