

A
three inches = one foot
B
one and one half inches = one foot
C
three quarters inch = one foot
D
one half inch = one foot
E
one eighth inch = one foot

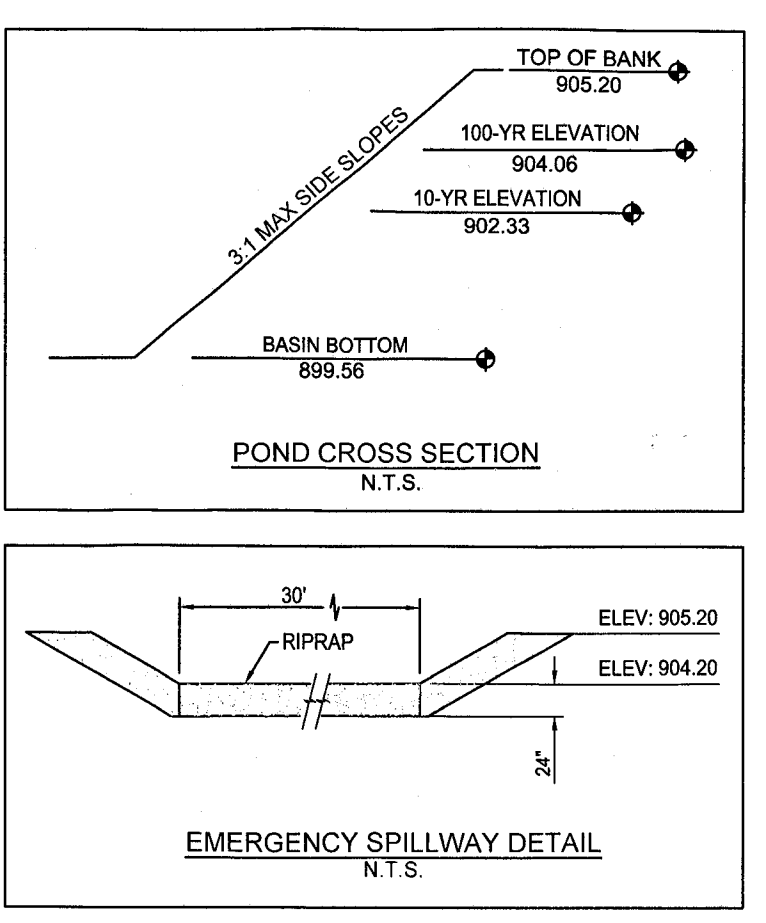

- ### EXISTING LEGEND
- | | |
|--------------------|--------------------|
| Air Conditioner | Light Pole |
| Clean Out | Manhole |
| Curb Inlet | Post |
| Drainage Inlet | Power Pole |
| Drainage MH | Sanitary MH |
| Electric Box | Sign |
| Electric Handhole | Spigot |
| Electric Meter Box | Stand Pipe |
| Electric MH | Telephone Handhole |
| Gas Meter | Flag |
| Gas Valve | Telephone Pedestal |
| Guard Post | Transformer |
| Guy Wire | Vent |
| Lid | Water Valve |
| | Fence |

- ### BENCHMARK INFORMATION
- Datum: NAVD 88 (Computed using GEOID12B from OPUS solution)
- TBM 21**
CHISELED "X" NORTHEAST BOLT FIRE HYDRANT LOCATED @ NORTHEAST QUAD OF AN INTERSECTION & ±120' SOUTH OF THE SOUTHWEST CORNER OF BUILDING #117.
ELEV: 925.67
- TBM 23**
CHISELED SQUARE ON NORTHEAST SIDE OF LIGHT POLE BASE LOCATED IN BETWEEN TWO PARKING LOTS & ±100' SOUTHEAST OF BUILDING #122 & ±75' SOUTHEAST OF BUILDING #48.
ELEV: 916.96
- TBM 34**
CHISELED SQUARE ON NORTHWEST SIDE OF LIGHT POLE #72 LOCATED INSIDE COURTYARD & IN FRONT OF BUILDING #29.
ELEV: 914.48

- ### PROPOSED GRADING LEGEND
- | | |
|---------------------|--------------------------|
| ME 000.00 | MATCH EXISTING ELEVATION |
| FL 000.00 | FLOW LINE OF SWALE |
| HP 000.00 | HIGH POINT |
| 000.00 | SPOT ELEVATIONS |
| SWALE | SWALE |
| RIDGE | RIDGE |
| FLOW ARROW | FLOW ARROW |
| GRADING WALL DETAIL | GRADING WALL DETAIL |
- TW: TOP OF WALL
FGU: FINISH GRADE AT UPPER SIDE OF WALL
FGL: FINISH GRADE AT LOWER SIDE OF WALL

★ ALTERNATE DEDUCT NOTES

- OMIT CONNECTING CANOPY STRUCTURE BETWEEN BUILDINGS AND CANOPY EXTENSION TO PARKING AREA OMIT ALL STEEL STRUCTURE, CLADDING, FOUNDATIONS AND ELECTRICAL LIGHTING CONNECTED TO CANOPY SIDEWALK TO REMAIN. IN LIEU OF THE INTEGRATED PATIENT HEALTHCARE CASEWORK, PROVIDE SUSPENDED MANUFACTURED PLASTIC CASEWORK WITH SOLID SURFACE COUNTERTOP AND BACKSPLASH. ALL OTHER DESIGN ELEMENTS ARE TO REMAIN THE SAME. OMIT PAVING AND BASE AT THE PARKING SPACES REMOTE FROM THE SIDEWALKS ACCESSING THE BUILDINGS. PROVIDE SEEDED AREA IN PLACE OF THE PAVING. MATCHING THE ADJACENT SEEDED AREAS AS REQUIRED. TOPSOIL AS REQUIRED. THE PERIOD OF PERFORMANCE FOR THE WORK IN ALTERNATE DEDUCT #1 IS 460 CALENDAR DAYS FROM RECEIPT OF NOTICE TO PROCEED.
- OMIT BUILDING # 202 AND ALL SITE FEATURES SUPPORTING OR ACCESSING THE BUILDING. PROVIDE SEEDED AREA TO INCLUDE TOPSOIL AS REQUIRED IN PLACE OF THE AREA OCCUPIED BY THE BUILDING AND RELATED SURFACE PAVING MATCHING THE ADJACENT SEEDED AREA. THE PERIOD OF PERFORMANCE FOR THE WORK IN ALTERNATE DEDUCT #2 IS 420 CALENDAR DAYS FROM RECEIPT OF NOTICE TO PROCEED.

GENERAL NOTES:

- CONTRACTOR SHALL PROTECT AND NOT DESTROY THE PROPERTY CORNER MONUMENTS DURING CONSTRUCTION.
- CONTRACTOR TO VERIFY LOCATION, SIZE AND DEPTH OF EXISTING UTILITIES PRIOR TO COMMENCING ANY CONSTRUCTION. CONTACT ENGINEER IF VARIATION EXISTS.
- SEE SHEET G0001 GENERAL NOTES FOR MORE INFORMATION.

CAUTION!!

THE LOCATIONS OF ALL EXISTING UNDERGROUND UTILITIES SHOWN ON THIS PLAN ARE BASED UPON ABOVE GROUND EVIDENCE (including, but not limited to, manholes, inlets, valves, and marks made upon the ground by others) AND ARE SPECULATIVE IN NATURE. THERE MAY ALSO BE OTHER EXISTING UNDERGROUND UTILITIES FOR WHICH THERE IS NO ABOVE GROUND EVIDENCE OR FOR WHICH NO ABOVE GROUND EVIDENCE WAS OBSERVED. THE EXACT LOCATIONS OF SAID EXISTING UNDERGROUND UTILITIES SHALL BE VERIFIED BY THE CONTRACTOR PRIOR TO ANY AND ALL CONSTRUCTION.

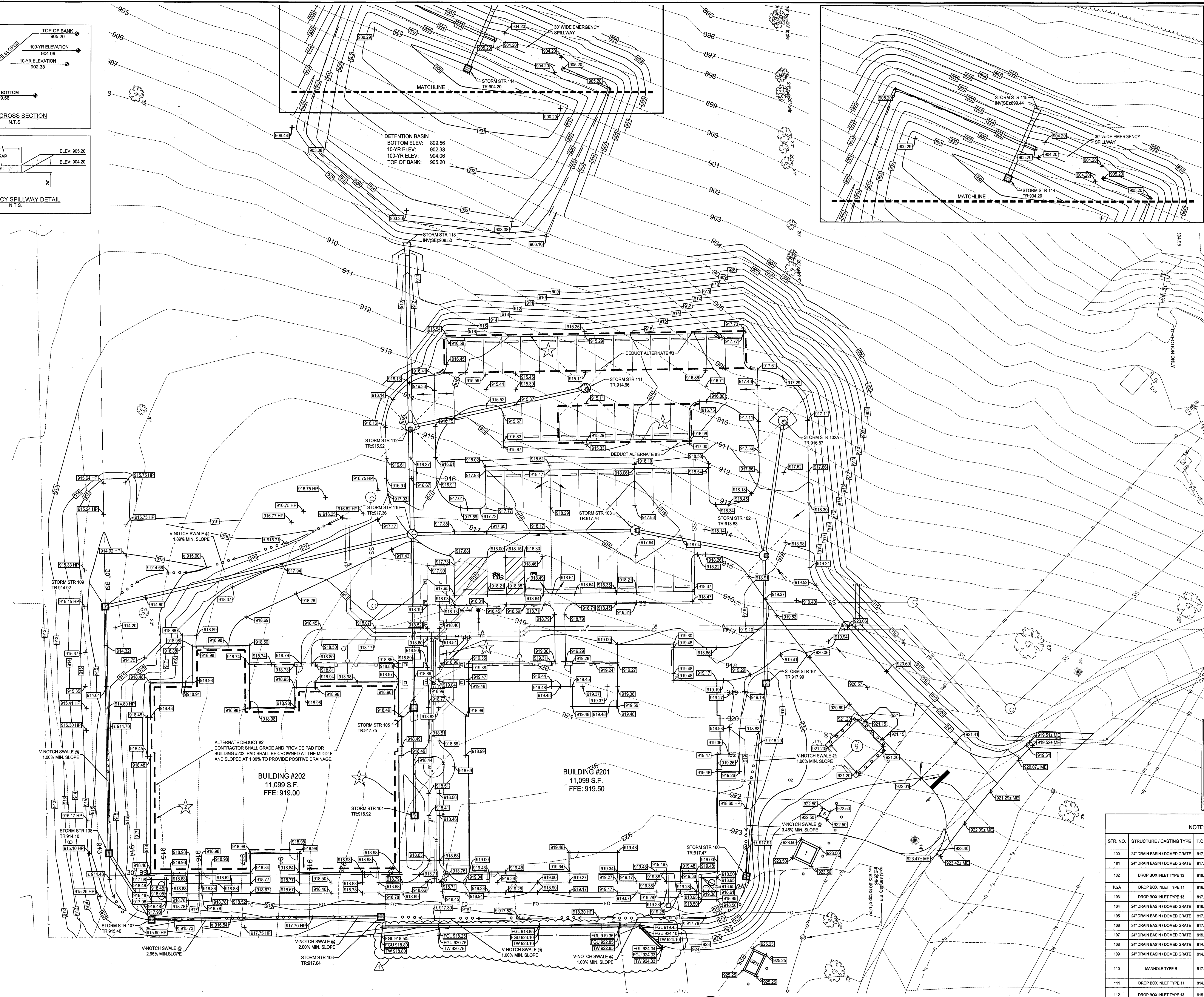

GRADING PLAN
1" = 20'
0' 10' 20' 40'
NORTH

STORM STRUCTURE DATA TABLE NOTE: ALL CASTINGS SHALL BE LABELED "DUMP NO WASTE-DRAINS TO WATERWAY"									
STR. NO.	STRUCTURE / CASTING TYPE	T.O.R.	INCOMING PIPE DATA (DIRECTION) FROM STR.	OUTGOING PIPE DATA (DIRECTION) TO STR.	OUTGOING PIPE SIZE	OUTGOING GRADE (%)	CONNECT TO STRUCT	REMARKS	
100	24" DRAIN BASIN / DOMED GRATE	917.47	12" HDPE 912.79 (SE) [100]	12" HDPE 913.16 (NW) [101]	94"	12"	0.40%	101	
101	24" DRAIN BASIN / DOMED GRATE	917.39	12" HDPE 912.79 (SE) [100]	12" RCP 912.34 (SW) [103]	63"	12"	0.40%	103	
102	DROP BOX INLET TYPE 13	918.83	12" RCP 912.44 (NW) [103]	12" RCP 912.44 (NW) [103]	63"	12"	0.40%	103	
103	DROP BOX INLET TYPE 11	918.87	12" RCP 912.08 (NE) [102]	12" RCP 911.98 (SW) [110]	66"	12"	0.40%	110	
104	24" DRAIN BASIN / DOMED GRATE	918.82	12" RCP 912.08 (NE) [102]	8" HDPE 913.12 (NW) [105]	52"	8"	2.00%	105	
105	24" DRAIN BASIN / DOMED GRATE	917.75	8" HDPE 912.07 (SE) [104]	8" HDPE 911.67 (NW) [110]	84"	8"	2.00%	110	
106	24" DRAIN BASIN / DOMED GRATE	917.64	12" HDPE 911.67 (NW) [110]	12" HDPE 911.68 (SW) [107]	111"	12"	0.40%	107	
107	24" DRAIN BASIN / DOMED GRATE	915.40	12" HDPE 911.23 (NE) [106]	12" HDPE 910.50 (NW) [108]	38"	12"	0.40%	108	
108	24" DRAIN BASIN / DOMED GRATE	914.10	12" HDPE 910.36 (SE) [107]	12" HDPE 910.25 (NW) [109]	120"	12"	0.40%	109	
109	24" DRAIN BASIN / DOMED GRATE	914.02	12" HDPE 909.77 (SE) [108]	14" HDPE 909.67 (NE) [110]	183"	19"	0.30%	110	
110	MANHOLE TYPE B	917.36	18" HDPE 909.21 (SW) [109]	18" RCP 909.11 (NW) [112]	52"	18"	0.30%	112	
111	DROP BOX INLET TYPE 11	914.96	12" RCP 910.80 (SW) [112]	12" RCP 910.80 (SW) [112]	87"	12"	0.40%	112	
112	DROP BOX INLET TYPE 13	915.93	18" RCP 909.96 (SE) [113]	18" RCP 909.86 (NW) [113]	90"	18"	0.40%	113	
113	CONCRETE END SECTION	910.29	18" RCP 910.45 (NE) [111]	18" RCP 910.45 (NE) [111]					DEBRIS GUARD REQUIRED
114	OUTLET CONTROL STRUCTURE	904.20	18" RCP 909.50 (SE) [112]	18" RCP 909.50 (SE) [112]					SEE DETAIL
115	CONCRETE END SECTION	901.22	18" RCP 899.44 (SE) [114]	18" RCP 899.44 (SE) [114]	38"	18"	0.31%	115	DEBRIS GUARD REQUIRED

BID DOCUMENTS

ADDENDUM #2

01/17/18

CONSULTANTS:

AMERICAN
STRUCTUREPOINT
INC.

7260 Shadeland Station, Indianapolis, IN 46256
TEL: 317.257.5580 FAX: 317.243.0270
www.structurepoint.com

LOVE & ASSOCIATES, INC.

1015 E. 10th Street, Suite 100
Indianapolis, IN 46202
TEL: 317.257.5580 FAX: 317.243.0270
www.loveandassociates.com

PROJECT MANAGER:

Project Number
15-584

Scale
AS INDICATED

Drawing Title:

PHASE 1
GRADING PLAN

Location:

LEXINGTON VAMC, LEESTOWN DIVISION
2250 LEESTOWN ROAD
LEXINGTON, KY 40511

Project Title:

CONSTRUCT CONTINUING
CARE FACILITIES - PHASE 1

Approved: Project Director

Date
SEPTEMBER 8, 2017

Checked
NRE

Drawn
ALR

VA PROJECT NUMBER

596-332

Building Number

201 & 202

Drawing Number

CG101

Dwg. 08 of 23

Office of
Construction
and Facilities
Management

VA U.S. Department of Veterans Affairs