

REVISIONS

NO.	DATE	DESCRIPTION
1		
2		
3		
4		
5		
6		
7		
8		
9		

RECORD DRAWINGS:

These record drawings (as-built drawings) are prepared by the architect from the construction documents and field notes. They are not to be used for construction purposes. The architect is not responsible for the accuracy of the information contained herein. The user of these drawings is advised that they are not to be used for construction purposes.

REVISED FOR "AS BUILT" CONDITIONS 4-5-84

NOTE: AREAS A1 AND A2 ARE TO BE FULLY SPRINKLED PER NFPA 101 UNDER THIS CONTRACT

FIRST FLOOR PLAN
AREA A1 1/8"=1'-0"

OUTPATIENT/CLINICAL
ADDITION

Building Number 1
Checked KLL
Drawn FCB
Drawing No. 1-9

Project Title
JULY 16, 1986
575-025

Location
VAMC-GRAND JUNCTION, COLORADO

Drawn
1-9

Veterans Administration

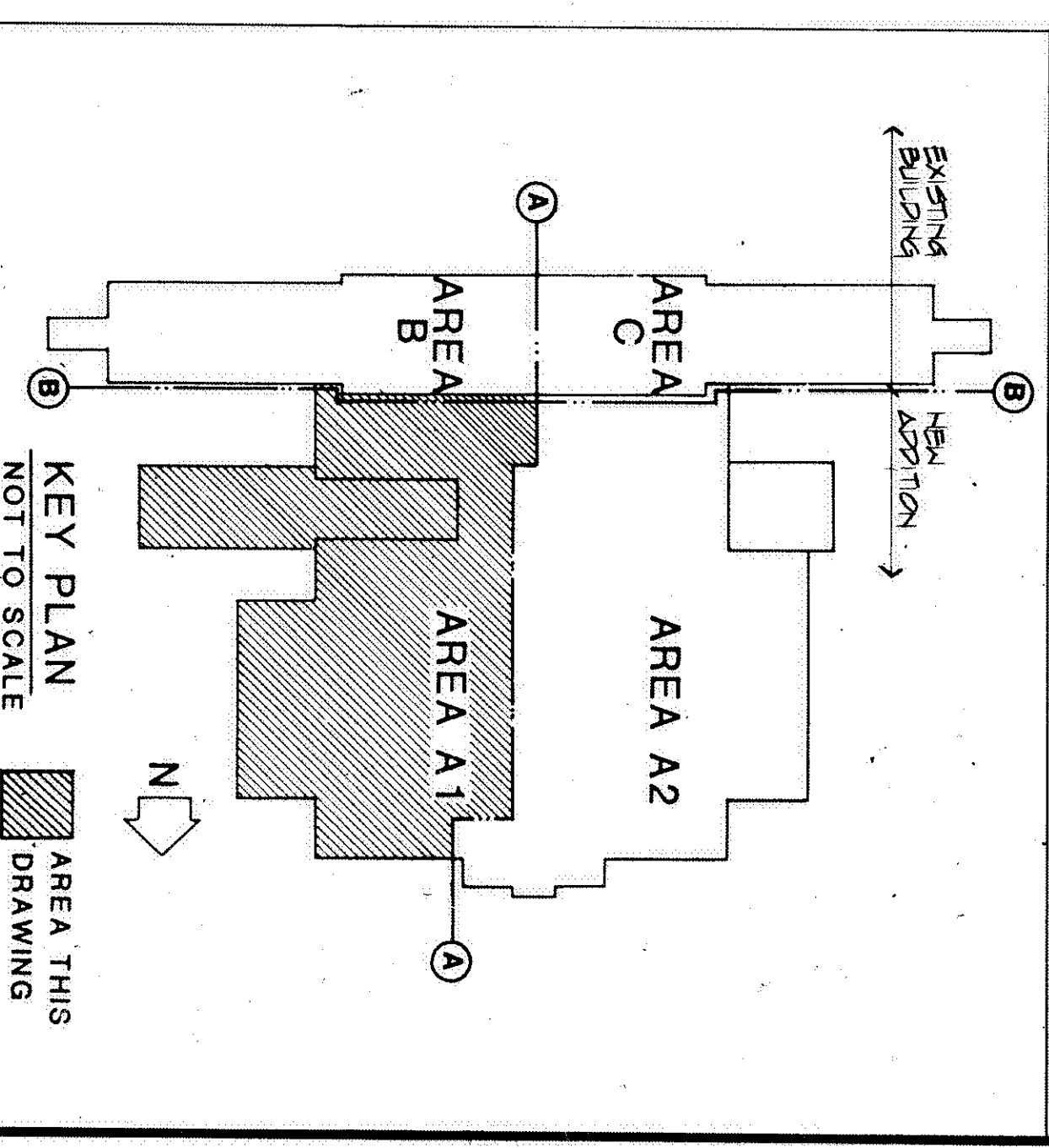
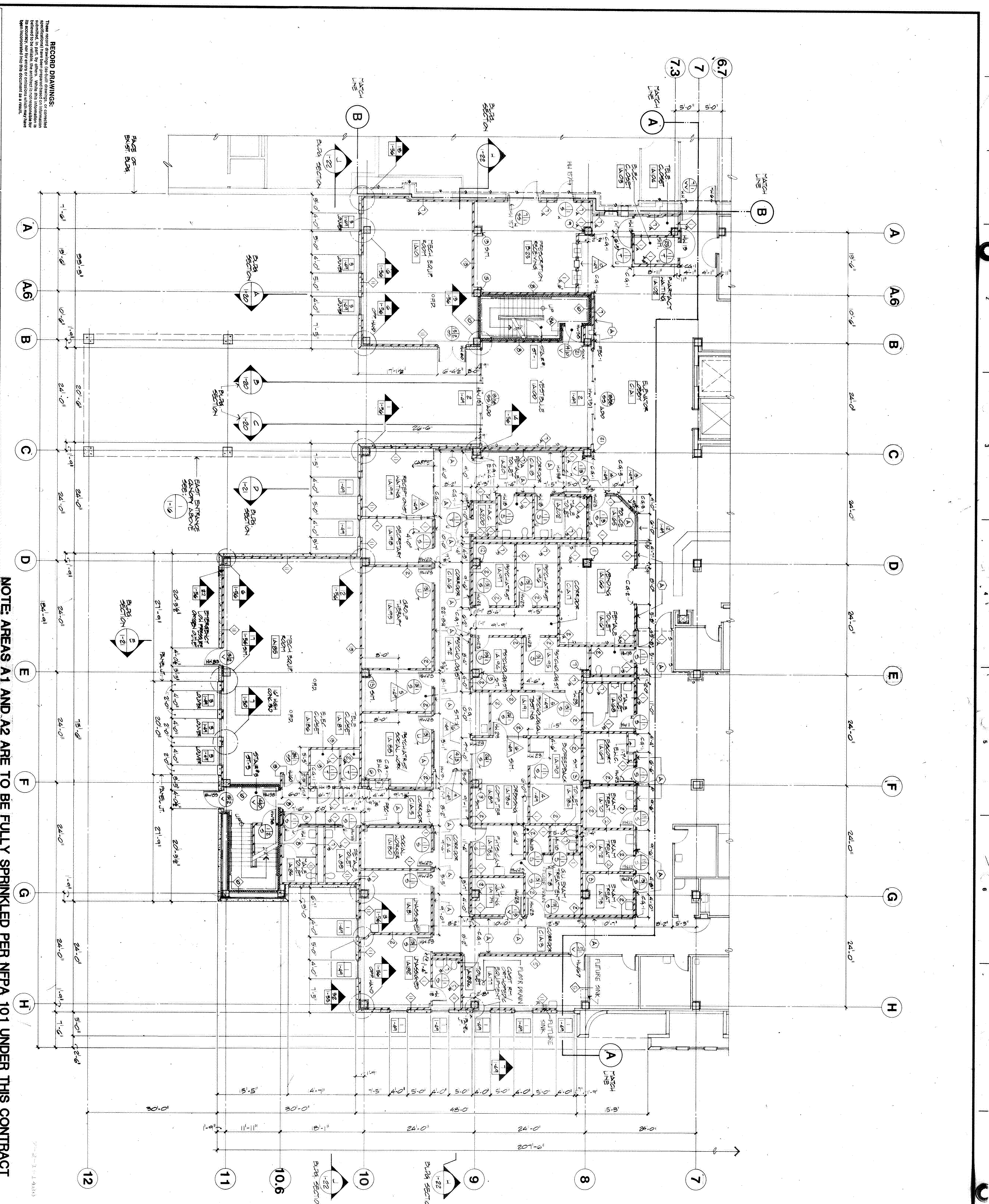

WALL SYMBOL LEGEND

- 1HR. WALL
- 2HR. WALL
- 1HR. SMOKE WALL
- LEAD LINED WALL

AMBULATORY CARE SERVICE
OUTPATIENT PSYCHIATRIC SERVICE

FIRST FLOOR PLAN FINISH FLOOR ELEVATION = 4618.73

- GENERAL FLOOR PLAN NOTES
- FOR STANDARD ARCHITECTURAL SYMBOLS, REFER TO SHEET 1-A3.
 - FOR LARGE SCALE STAIR PLANS, SECTIONS AND DETAILS, REFER TO SHEETS 1-31, 1-32 AND 1-33.
 - FOR LARGE SCALE ELEVATOR AND DRINK/WATER PLANS, SECTIONS AND DETAILS, REFER TO SHEETS 1-34 AND 1-35.
 - FOR ROOF AND FLOOR TYPES AND SIZES, REFER TO SHEET 1-41.
 - FOR INTERIOR WALL TYPES, REFER TO SHEET 1-50.
 - FOR INTERIOR COLUMN PLAN DETAILS, REFER TO SHEET 1-54 AND 1-55.
 - FOR 1/4" PLAN ENLARGEMENTS SHOWING EQUIPMENT, CASEWORK, TOILET ROOM LAYOUTS, REFER TO ARCHITECTURAL DRAWINGS 1-52 THROUGH 1-74.
 - CONTRACTOR TO FIELD VERIFY LOCATION OF EXISTING CORRIDORS WHERE NEW CORRIDORS ARE TO BE ADDED.
 - INTERIOR DIMENSIONS ARE TAKEN TO FACE OF METAL STUD TYPICALLY AT NEW CONSTRUCTION UNLESS NOTED OTHERWISE.
 - FOR FINISH REQUIREMENTS AND COLORS, REFER TO SPECIFICATIONS SECTION 0900.
 - FINISH AND INSTALL CORRIDOR HANDRAILS WHERE DESIGNATED ON PLAN WITH KEY NOTE (3). SEE DETAIL 12, SHEET 1-59.
 - TO DETAIL 11, SHEET 1-59.
 - FOR FIRE EXTINGUISHER CABINETS (FEC) DETAILS, REFER TO DETAIL 9, SHEET 1-60.
 - FOR ELECTRIC WATER COOLER (E.W.C.) DETAILS, REFER TO DETAIL 10, SHEET 1-60.