



ISO 9001:2008 &amp; ISO 17025:2005 CERTIFIED

Specialists in Clean Air Certification  
177 N. Commerce Way  
Bethlehem, PA 18017

PAGE 1 OF 14

## ACCEPTANCE CRITERIA SUMMARY REPORT

TEST REPORT NO.: 93048- 000409339  
COMPLETION DATE: 23 Apr 2017  
CLIENT: CHIEF SUPPLY  
ADDRESS: 1111 E END BLVD  
WILKES BARRE PA 18711  
ATTN: Joe Kiddish  
TEMPLATE REVIEW: JAZ 19 APR 2016

QA REVIEWED  
KA 284062017  
TYPE OF EQUIPMENT BEING TESTED  
MFG.: PHARMACY CLEANROOM  
IDENTIFYING NO.: NA  
LOCATION: MAIN BLDG BASEMENT  
ROOM: INPATIENT PHARMACY (ANTE, CHEMO, IV PREP)  
OTHER: MCI # 93048  
RETEST DATE: February 2018

PAGE	DOCUMENTATION OR DATA TITLE	TEST STATUS: PASS; FAIL; NO TEST; FOR REFERENCE ONLY	ACCEPTANCE CRITERIA: NOT APPLICABLE; AS PER DESIGN; CLIENT CRITERIA; USED FOR DIAGNOSTIC PURPOSES
1 & 2 OF 14	ACCEPTANCE CRITERIA SUMMARY REPORT	FOR REFERENCE ONLY	NOT APPLICABLE
3 OF 14	IDENTIFICATION DRAWING	FOR REFERENCE ONLY	NOT APPLICABLE
4 OF 14	AIRFLOW VOLUME PROFILE	PASS	SUFFICIENT TO ACHIEVE AIR CHANGES PER HOUR
5 OF 14	FILTER DIFFERENTIAL PRESSURE	FOR REFERENCE ONLY	NOT APPLICABLE
6 OF 14	FILTER HISTORICAL DATA	FOR REFERENCE ONLY	USED FOR DIAGNOSTIC PURPOSES
7 OF 14	AIR CHANGES PER HOUR	PASS	ALL ROOMS $\geq 30$ ACPH
8 OF 14	ROOM DIMENSIONS	FOR REFERENCE ONLY	NOT APPLICABLE
9 OF 14	ROOM DIFFERENTIAL PRESSURES/ ROOM PRESSURIZATION & AIRFLOW DIRECTIONAL SMOKE PATTERN TESTS	PASS	ANTE TO CHEMO I.V. PREP $\geq 0.01$ "W.C. I.V. PREP TO ANTE $\geq 0.02$ "W.C. ANTE TO AMBIENT $\geq 0.02$ "W.C.
10 OF 14	AEROSOL CHALLENGE INSTALLATION LEAK TEST	PASS	$\leq 0.010\%$ PENETRATION
11 OF 14	FILTER MEDIA REPAIR TRACKING	PASS	LESSER DIMENSION OF EACH REPAIR NO GREATER THAN 1.50"  TOTAL OF ALL REPAIRS NOT TO EXCEED 3.00% OF THE EFFECTIVE FILTER AREA
12 OF 14	AEROSOL CHALLENGE INTRODUCTION LOCATION  SMOKE DETECTOR YES <input type="checkbox"/> NO <input checked="" type="checkbox"/> Verify prior to test	FOR REFERENCE ONLY	NOT APPLICABLE

# ACCEPTANCE CRITERIA SUMMARY REPORT

TEST REPORT NO.: 93048- 000407339

PAGE 2 OF 14

PAGE	DOCUMENTATION OR DATA TITLE	TEST STATUS: PASS; FAIL; NO TEST; FOR REFERENCE ONLY	ACCEPTANCE CRITERIA: NOT APPLICABLE; AS PER DESIGN; CLIENT CRITERIA; USED FOR DIAGNOSTIC PURPOSES
<u>13</u> OF <u>14</u>	AIRBORNE PARTICLE COUNT SURVEY	PASS	ISO CLASS 7 ≤ 352,000 PPCM @ 0.5 MICRON & LARGER  PER ISO 14644-1:2015 - OPERATIONAL
<u>14</u> OF <u>14</u>	LIGHTING LEVEL & NOISE LEVEL	FOR REFERENCE ONLY	NOT APPLICABLE

Tested in Accordance With Micro-Clean SOP CR- 0616 MCI and CETA CAG-003-2006-13

Reviewed by Micro-Clean:

Technician

Dylan Shupp

Signature

[Signature]

Date

23 Aug 2017

MCI QA Reviewed by:

Print Name

KENNETH ANSBACH

Signature

[Signature]

Date

28 AUG 2017

Reviewed by Client:

Print Name

Signature

Date

QA REVIEWED  
14 28 AUG 2017



SPECIALISTS IN CLEAN AIR CERTIFICATION  
177 N. Commerce Way  
Bethlehem, PA 18017  
1-800-523-9852

PAGE 3 OF 14

TEST REPORT NO. 93048-000409339

CLIENT: CHIEF SUPPLY

ADDRESS: 1111 E END BLVD

WILKES BARRE PA 18711

TYPE OF EQUIPMENT BEING TESTED

MFG.: PHARMACY CLEANROOM

IDENTIFYING NO.: NA

LOCATION: MAIN BLDG BASEMENT

ROOM: INPATIENT PHARMACY (ANTE, CHEMO, IV PREP)

OTHER: MCI# 93048

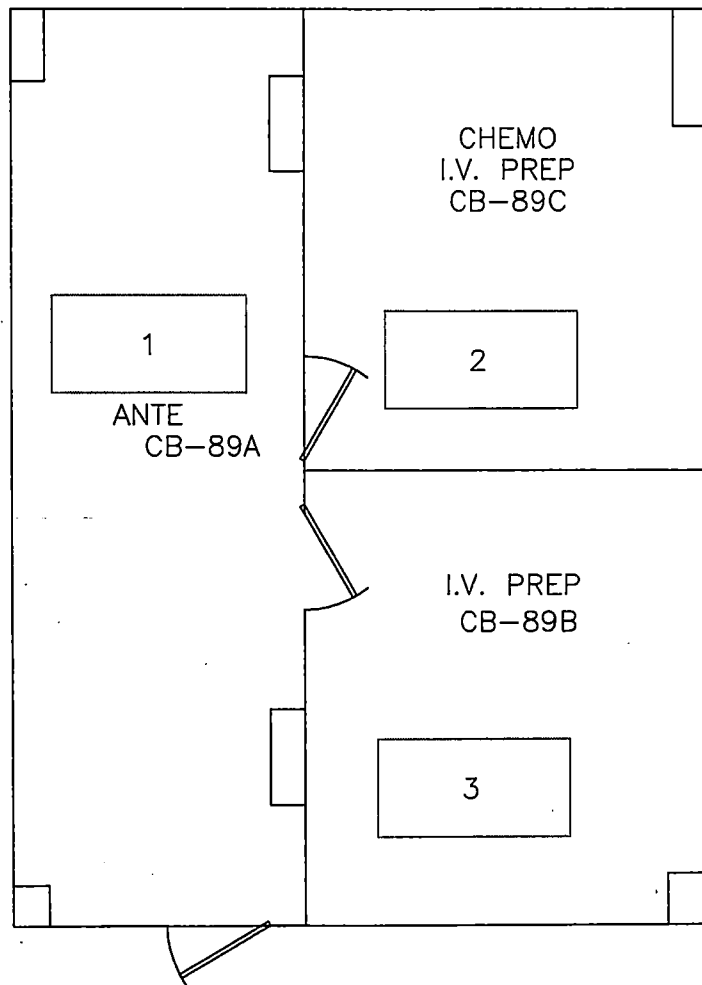

QA REVIEWED  
1/4 28 AUG 2017

**IDENTIFICATION DRAWING**



SPECIALISTS IN CLEAN AIR CERTIFICATION  
177 N. Commerce Way  
Bethlehem, PA 18017  
1-800-523-9852

PAGE 4 OF 14

TEST REPORT NO. 93048-000409339

TYPE OF EQUIPMENT BEING TESTED  
MFG.: PHARMACY CLEANROOM

CLIENT: CHIEF SUPPLY

IDENTIFYING NO.: NA

ADDRESS: 1111 E END BLVD

LOCATION: MAIN BLDG BASEMENT

WILKES BARRE PA 18711

ROOM: INPATIENT PHARMACY (ANTE, CHEMO, IV PREP)

OTHER: MCI# 93048

TEST EQUIPMENT - Balometer : Mfg. Shortridge Model ADM 870 S/N M00429

CAL DUE 01 Nov 2017

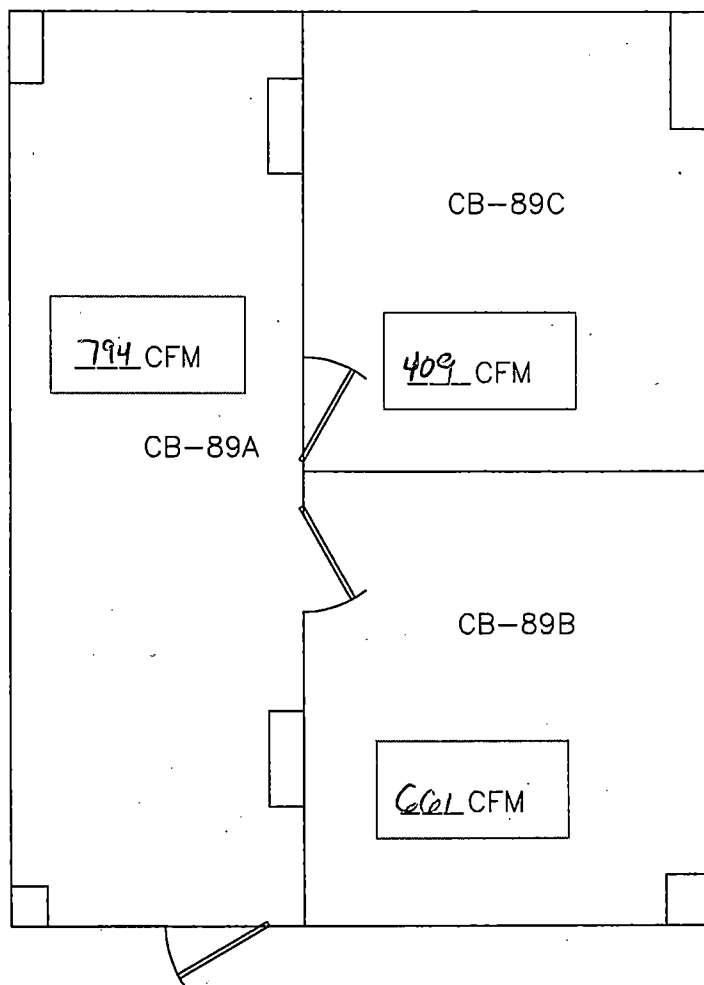

QA REVIEWED  
14 28 AUG 2017

Brian Scheetz  
Brian Scheetz  
23 Aug 2017

### AIRFLOW VOLUME PROFILE

READINGS RECORDED IN CUBIC FEET PER MINUTE (CFM)  
USING A CAPTURE HOOD  
(ALL READINGS: BACKPRESSURE COMPENSATED)



SPECIALISTS IN CLEAN AIR CERTIFICATION  
177 N. Commerce Way  
Bethlehem, PA 18017  
1-800-523-9852

PAGE 5 OF 14

TEST REPORT NO. 93048-000409339

TYPE OF EQUIPMENT BEING TESTED  
MFG.: PHARMACY CLEANROOM

CLIENT: CHIEF SUPPLY

IDENTIFYING NO.: NA

ADDRESS: 1111 E END BLVD

LOCATION: MAIN BLDG BASEMENT

WILKES BARRE PA 18711

ROOM: INPATIENT PHARMACY (ANTE, CHEMO, IV PREP)

OTHER: MCI# 93048

TEST EQUIPMENT - Manometer: Mfg. TSI Model 9565P S/N 9565P1334024

CAL DUE 06 Oct 2017

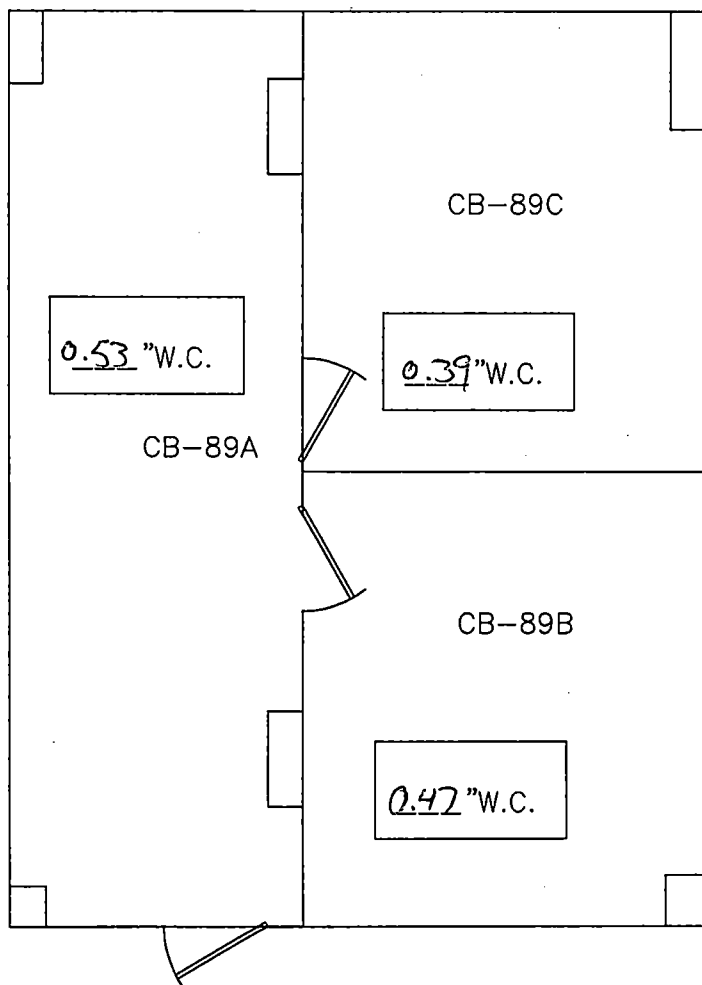

QA REVIEWED  
14 28 AUG 2017

Brian Schett  
Brian Schett  
23 Aug 2017

### FILTER DIFFERENTIAL PRESSURE

INDICATED IN INCHES OF WATER COLUMN ("W.C.)

**FILTER HISTORICAL DATA**

TEST REPORT NO. 93048-000409339

CLIENT: CHIEF SUPPLY

ADDRESS: 1111 E END BLVD  
WILKES BARRE PA 18711

## TYPE OF EQUIPMENT BEING TESTED

MFG: PHARMACY CLEANROOM

IDENTIFYING NO.: NA

LOCATION: MAIN BLDG BASEMENT

ROOM: INPATIENT PHARMACY (ANTE, CHEMO, IV PREP)

OTHER: MCI# 93048

FILTER ID	FILTER REPLACEMENT	S/N	DATE	INITIAL ΔP	INITIAL VOLUME
1	FILTRATION GROUP - AEROSTAR PART NUMBER: 43862 20.63 x 44.63 ROOMSIDE REPLACEABLE / GEL EPOXY SCREEN WITH 1 PRESSURE PORT	695765	UNKNOWN	NA "W.C. @	NA CFM
2	FILTRATION GROUP - AEROSTAR PART NUMBER: 43862 20.63 x 44.63 ROOMSIDE REPLACEABLE / GEL EPOXY SCREEN WITH 1 PRESSURE PORT	695803	UNKNOWN	NA "W.C. @	NA CFM
3	FILTRATION GROUP - AEROSTAR PART NUMBER: 43862 20.63 x 44.63 ROOMSIDE REPLACEABLE / GEL EPOXY SCREEN WITH 1 PRESSURE PORT	695761	UNKNOWN	NA "W.C. @	NA CFM

QA REVIEWED  
14 28 AUG 2017



SPECIALISTS IN CLEAN AIR CERTIFICATION  
177 N. Commerce Way  
Bethlehem, PA 18017  
1-800-523-9852

PAGE 7 OF 14

TEST REPORT NO. 93048-000409339

CLIENT: CHIEF SUPPLY

ADDRESS: 1111 E END BLVD

WILKES BARRE PA 18711

TYPE OF EQUIPMENT BEING TESTED

MFG.: PHARMACY CLEANROOM

IDENTIFYING NO.: NA

LOCATION: MAIN BLDG BASEMENT

ROOM: INPATIENT PHARMACY (ANTE, CHEMO, IV PREP)

OTHER: MCI# 93048

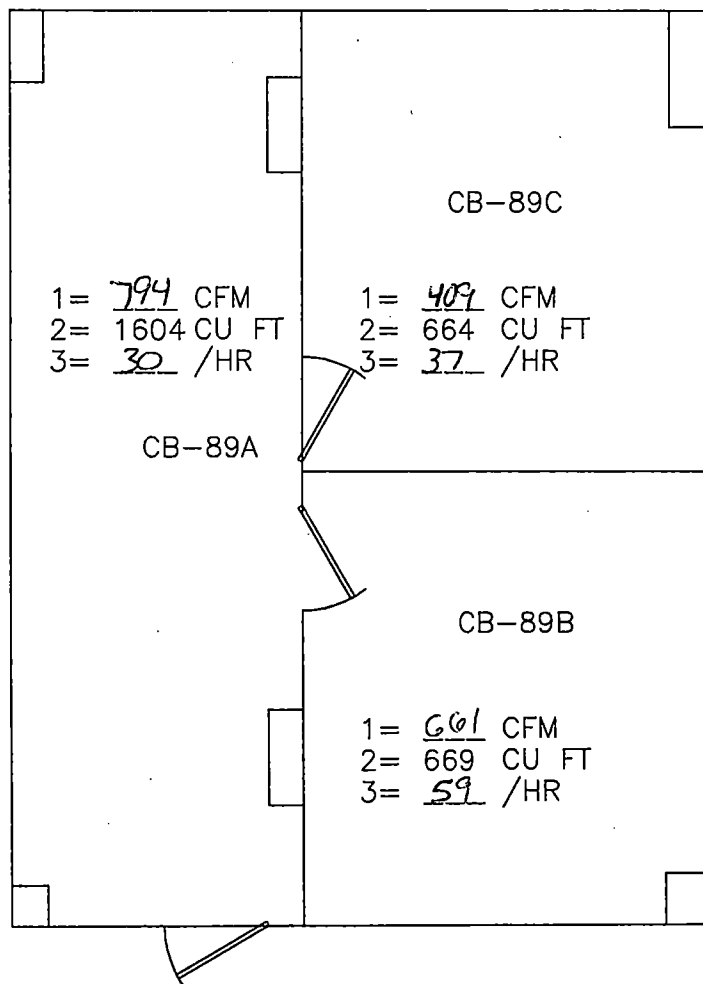

QA REVIEWED  
14 28 AUG 2017

Brian Scheetz  
Brian Scheetz  
23 AUG 2017

### AIR CHANGES PER HOUR

1 = TOTAL AIRFLOW VOLUMES IN CUBIC FEET PER MINUTE (CFM)  
(CFM<sub>1</sub>+ CFM<sub>2</sub> +CFM<sub>3</sub>+...)=CFM<sub>TOTAL</sub>

2 = ROOM VOLUME IN CUBIC FEET (CU FT) (L"XW"XH"/1728)

3 = AIR CHANGES/HOUR (/HR) (CFM/CU FT X 60)







SPECIALISTS IN CLEAN AIR CERTIFICATION  
177 N. Commerce Way  
Bethlehem, PA 18017  
1-800-523-9852

PAGE 9 OF 14

TEST REPORT NO. 93048-000409339

TYPE OF EQUIPMENT BEING TESTED  
MFG.: PHARMACY CLEANROOM

CLIENT: CHIEF SUPPLY

IDENTIFYING NO.: NA

ADDRESS: 1111 E END BLVD

LOCATION: MAIN BLDG BASEMENT

WILKES BARRE PA 18711

ROOM: INPATIENT PHARMACY (ANTE, CHEMO, IV PREP)

OTHER: MCI# 93048

TEST EQUIPMENT - Manometer: Mfg. TSI Model 9565-P S/N 9565P1334024

CAL DUE 0604 2017

Brian Scheek  
Brian Scheek  
23 Aug 2017

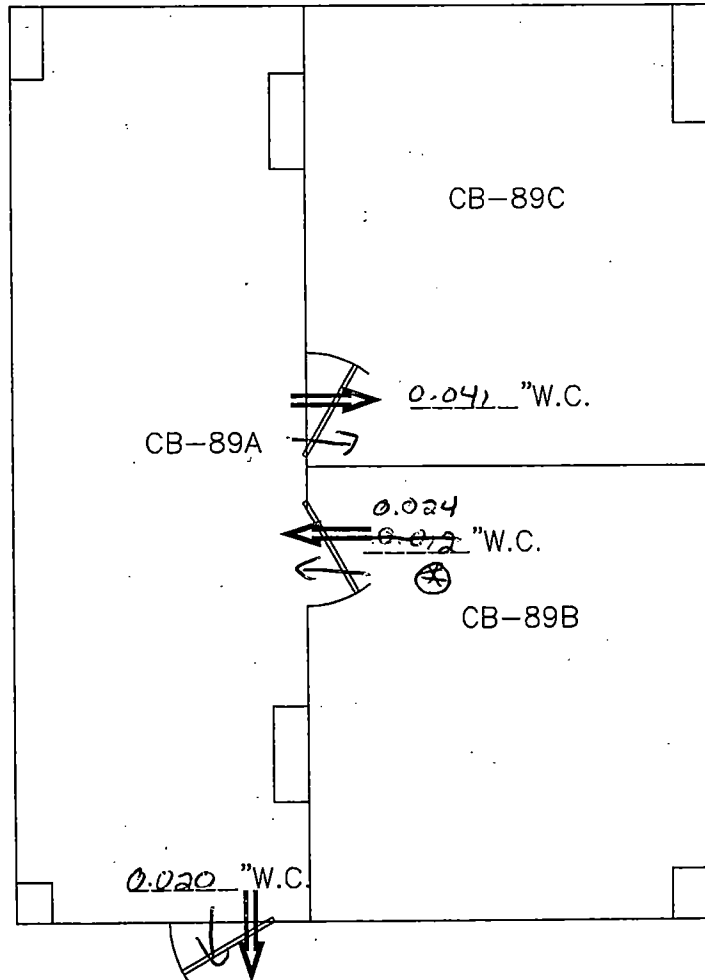

QA REVIEWED  
1/4 28 AUG 2017

⊗ Door was open  
on first reading  
Brian Scheek  
Brian Scheek  
23 Aug 2017

### ROOM PRESSURIZATION

ROOM-TO-ROOM PRESSURES ARE INDICATED IN INCHES OF WATER COLUMN ("W.C.") ADJACENT TO AIRFLOW DIRECTIONAL ARROW. AIRFLOW DIRECTION VERIFIED WITH A VISUAL SMOKE SOURCE.

CURRENT AIRFLOW DIRECTION → NEUTRAL (0.000"W.C.") ↔  
DESIGN AIRFLOW DIRECTION ⇒ NO DESIGN DIRECTION ↔

PRESSURES TAKEN ON 23 Aug 2017 @ 1015



SPECIALISTS IN CLEAN AIR CERTIFICATION  
177 N. Commerce Way  
Bethlehem, PA 18017  
1-800-523-9852

PAGE 10 OF 14

TEST REPORT NO. 93048-000409339

TYPE OF EQUIPMENT BEING TESTED  
MFG.: PHARMACY CLEANROOM

IDENTIFYING NO.: NA

LOCATION: MAIN BLDG BASEMENT

ROOM: INPATIENT PHARMACY (ANTE, CHEMO, IV PREP)

OTHER: MCI# 93048

CLIENT: CHIEF SUPPLY

ADDRESS: 1111 E END BLVD

WILKES BARRE PA 18711

TEST EQUIPMENT - Photometer: Mfg. ATI Model TDA-26 S/N 10405

CAL DUE 09 Jan 2018

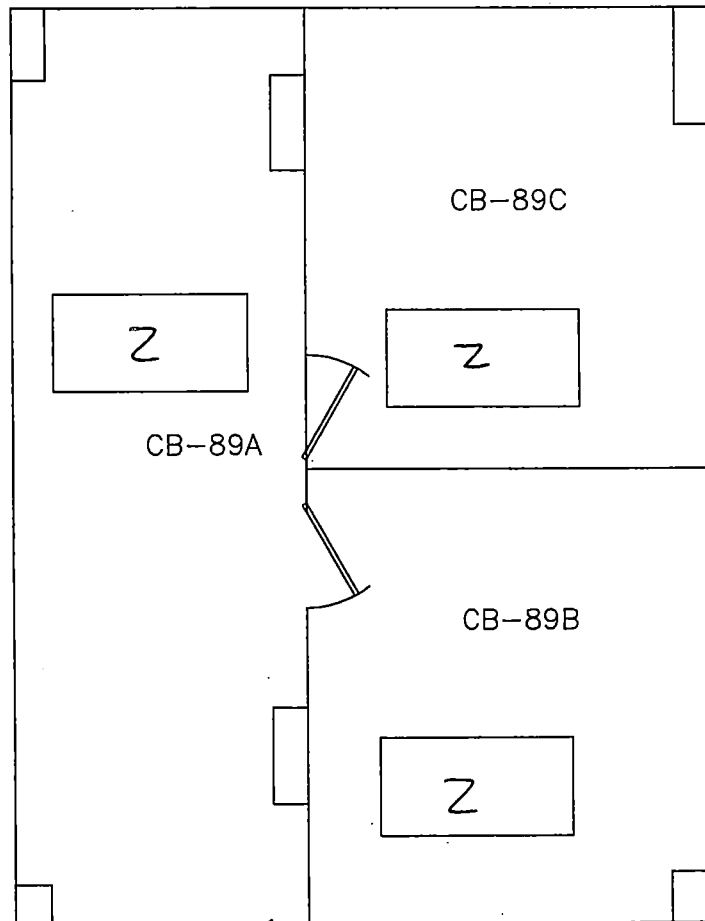

QA REVIEWED  
1628 AUG 2017

Brian Scheetz  
Brian Scheetz  
23 Aug 2017

### AEROSOL CHALLENGE INSTALLATION LEAK TEST

A MINIMUM OF 10  $\mu\text{g/L}$  LASKIN NOZZLE GENERATED PAO WAS INTRODUCED INTO FLEX DUCT ABOVE CEILING. A 100% SCAN OF THE FILTER MEDIA AND SURROUNDING FRAME / SEAL WAS CONDUCTED. RESULTS INDICATED ON DIAGRAM.

Z=ZERO LEAKAGE DETECTED, BR=BEFORE REPAIRS, AR=AFTER REPAIRS (REPAIRS MADE WITH RTV SILICONE), // = MEDIA LEAKAGE, XX=FRAME LEAKAGE, ZAR=ZERO LEAKAGE AFTER REPAIR



# FILTER MEDIA REPAIR TRACKING

TEST REPORT NO. 93048-000409339

TYPE OF EQUIPMENT BEING TESTED

MFG: PHARMACY CLEANROOM

CLIENT: CHIEF SUPPLY

IDENTIFYING NO.: NA

ADDRESS: 1111 E END BLVD

LOCATION: MAIN BLDG BASEMENT

WILKES BARRE PA 18711

ROOM: INPATIENT PHARMACY (ANTE, CHEMO, IV PREP)

OTHER: MCI# 93048

FILTER #	FILTER MEDIA AREA (dimensions in inches)	PATCH SIZE (dimensions in inches)	UP/DOWN	DATE OF REPAIR	% AREA	TOTAL REPAIR %
			STREAM			
1	19.25 x 42.00 = 808.50 SQ IN	0.00 x 0.00 = 0.00 SQ IN	NA	NA	0.00	0.00
2	19.25 x 42.00 = 808.50 SQ IN	0.00 x 0.00 = 0.00 SQ IN	NA	NA	0.00	0.00
3	19.25 x 42.00 = 808.50 SQ IN	0.00 x 0.00 = 0.00 SQ IN	NA	NA	0.00	0.00

QA REVIEWED  
14 28 AUG 2017



SPECIALISTS IN CLEAN AIR CERTIFICATION  
177 N. Commerce Way  
Bethlehem, PA 18017  
1-800-523-9852

PAGE 12 OF 14

TEST REPORT NO. 93048-00409339

TYPE OF EQUIPMENT BEING TESTED  
MFG.: PHARMACY CLEANROOM

IDENTIFYING NO.: NA

CLIENT: CHIEF SUPPLY

LOCATION: MAIN BLDG BASEMENT

ADDRESS: 1111 E END BLVD

ROOM: INPATIENT PHARMACY (ANTE, CHEMO, IV PREP)

WILKES BARRE PA 18711

OTHER: MCI# 93048

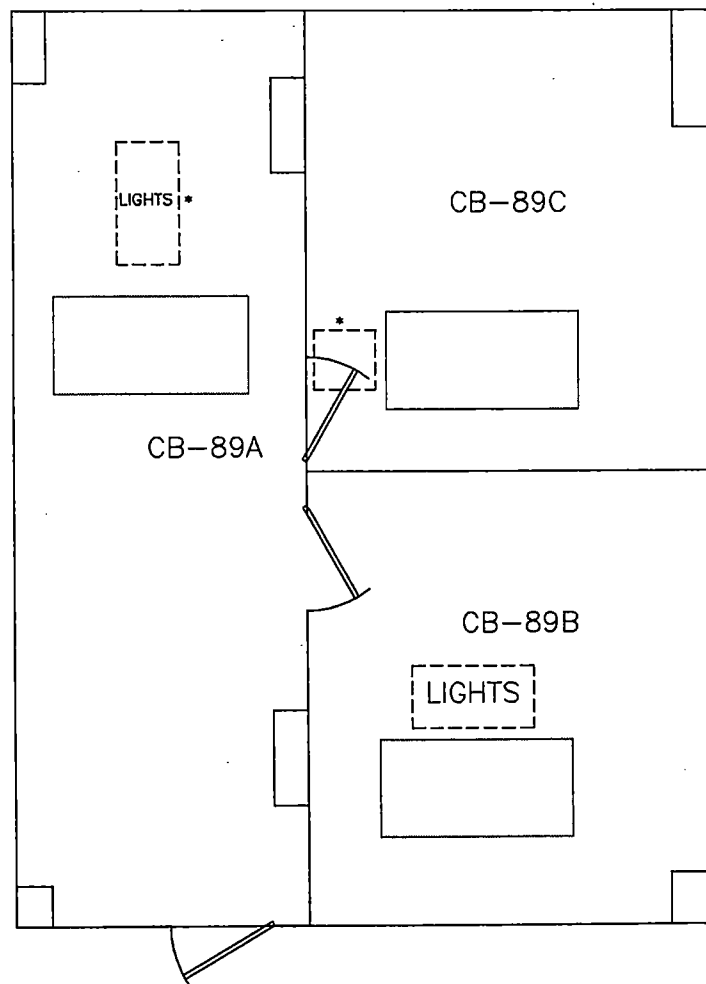

QA REVIEWED  
14 28 AUG 2017

### AEROSOL CHALLENGE INTRODUCTION LOCATION

SMOKE DETECTORS: NO

\* SMOKE INTRODUCED INTO FLEX DUCT ABOVE CEILING.



SPECIALISTS IN CLEAN AIR CERTIFICATION  
177 N. Commerce Way  
Bethlehem, PA 18017  
1-800-523-9852

PAGE 13 OF 14

TEST REPORT NO. 93048-000409339

CLIENT: CHIEF SUPPLY

ADDRESS: 1111 E END BLVD

WILKES BARRE PA 18711

TYPE OF EQUIPMENT BEING TESTED

MFG.: PHARMACY CLEANROOM

IDENTIFYING NO.: NA

LOCATION: MAIN BLDG BASEMENT

ROOM: INPATIENT PHARMACY (ANTE, CHEMO, IV PREP)

OTHER: MCI# 93048

TEST EQUIPMENT - Particle Counter: Mfg. TSI Model 9350-02 S/N 93501244001

CAL DUE 16 Sep 2017

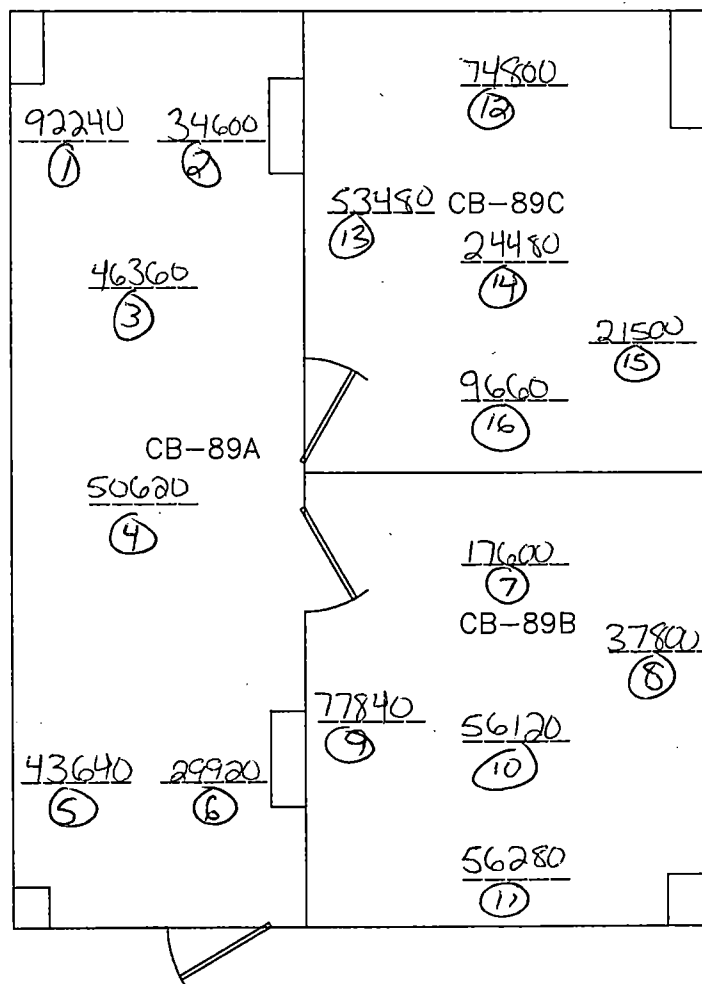

QA REVIEWED  
K4 28 AUG 2017

Brian Scheetz  
Brian Scheetz  
23 Aug 2017

### AIRBORNE PARTICLE COUNT SURVEY

TAKEN AT 42" WORK SURFACE ELEVATION.

ROOM IN OPERATIONAL CONDITIONS WITH 2 PERSON(S) IN ROOM.

GOWNING LEVEL = Hairnet, goggle, coveralls, gloves, shoe covers, facemask  
MINIMUM SAMPLE VOLUME 2 LITERS @ 50 LPM FOR 1 MINUTE

SURVEY TO BE READ AS FOLLOWS:

0.5 MICRON & LARGER PARTICLES PER CUBIC METER (PPCM)



SPECIALISTS IN CLEAN AIR CERTIFICATION  
177 N. Commerce Way  
Bethlehem, PA 18017  
1-800-523-9852

PAGE 14 OF 14

TEST REPORT NO. 93048-000409339

TYPE OF EQUIPMENT BEING TESTED  
MFG.: PHARMACY CLEANROOM

CLIENT: CHIEF SUPPLY

IDENTIFYING NO.: NA

ADDRESS: 1111 E END BLVD

LOCATION: MAIN BLDG BASEMENT

WILKES BARRE PA 18711

ROOM: INPATIENT PHARMACY (ANTE, CHEMO, IV PREP)

OTHER: MCI# 93048

TEST EQUIPMENT - Light Meter: Mfg. AEMC Model CA811 S/N 102926CY  
CAL DUE 05 Jan 2018

TEST EQUIPMENT - Sound Meter: Mfg. Center Model 325 S/N 121001263  
CAL DUE 05 Oct 2017

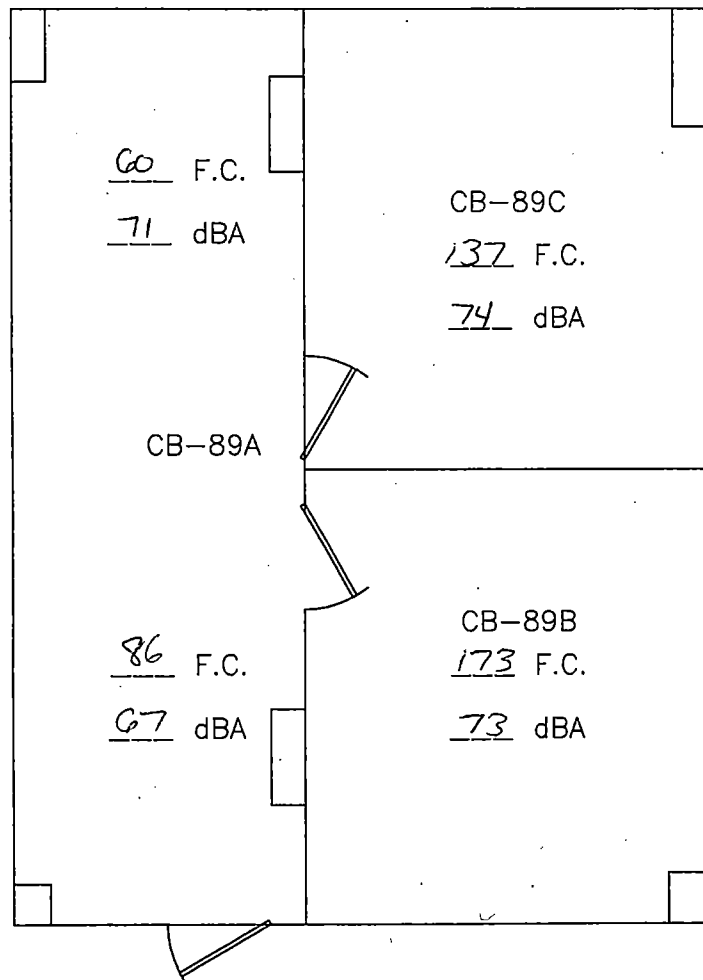

QA REVIEWED  
14 28 AUG 2017

Brian Schmitt  
Brian Schmitt  
23 Aug 2017

### LIGHTING LEVEL & NOISE LEVEL

LIGHTING LEVEL WAS MEASURED AT 42" ABOVE THE FLOOR WORK SURFACE ELEVATION.  
NOISE LEVEL WAS MEASURED AT 5' ABOVE THE FLOOR.

SURVEY TO BE READ AS FOLLOWS:

LIGHTING LEVEL - FOOT CANDLES (F.C.)

NOISE LEVEL - DECIBELS (dBA)



Micro-Clean  
177 N. Commerce Way  
Bethlehem, PA 18017

800-523-9852 or 610-867-5302  
Fax: 610-954-7803  
email: [micro-clean@microcln.com](mailto:micro-clean@microcln.com)  
[www.microcln.com](http://www.microcln.com)

## CERTIFICATE OF CALIBRATION

MODEL ADM-870 SERIAL NO M00429  
DESCRIPTION Shortridge Airdata Multimeter

***Micro-Clean Calibration Services does hereby certify that all  
performance and acceptance tests required were successfully conducted  
according to required specifications. All calibration data and test instrumentation  
used have been obtained using standards whose accuracies are traceable to the  
National Institute of Standards and Technology (NIST),  
have been derived from accepted values of natural physical constants,  
or by the use of ratio type of self calibration.***

***The calibration system complies with ANSI/NCSL Z540-1-2006.***

November 2, 2016  
Date of Calibration

November 1, 2017  
Next Calibration is Due

Charles Gilman Charles Gilman 07 Nov 2016  
Authorized Name/Signature/Date

MCI# 102358



Accredited  
Technicians

Assuring Performance of Critical Environments  
Since 1974



Cert. No. CR159  
Cleanroom Performance  
Testing

## CERTIFICATE OF CALIBRATION

MODEL 9565-P SERIAL NO. 9565P1334024  
DESCRIPTION TSI VelociCalc Thermoanemometer (Meter)

***Micro-Clean Calibration Services does hereby certify that all performance and acceptance tests required were successfully conducted according to required specifications. All calibration data and test instrumentation used have been obtained using standards whose accuracies are traceable to the National Institute of Standards and Technology (NIST), have been derived from accepted values of natural physical constants, or by the use of ratio type of self calibration.***

***The calibration system complies with ANSI/NCSL Z540-1-2006.***

July 7, 2017  
Date of Calibration

October 6, 2017  
Next Calibration is Due

Brian Hess *Brian Hess* 07JUL2017  
Authorized Name/Signature/Date

MCH# / RPT# 122641 / 000040242



Accredited  
Technicians

**Assuring Performance of Critical Environments  
Since 1974**



## CERTIFICATE OF CALIBRATION

MODEL TDA-2G SERIAL NO. 10405

DESCRIPTION Air Techniques Aerosol Photometer

***Micro-Clean Calibration Services does hereby certify that all performance and acceptance tests required were successfully conducted according to required specifications. All calibration data and test instrumentation used have been obtained using standards whose accuracies are traceable to the National Institute of Standards and Technology (NIST), have been derived from accepted values of natural physical constants, or by the use of ratio type of self calibration.***

***The calibration system complies with ANSI/NCSL Z540-1-2006.***

July 10, 2017  
Date of Calibration

January 9, 2018  
Next Calibration is Due

Thomas Dahl

 11 JUL 2017  
Authorized Name/Signature/Date

MCI# / RPT# 100118 / 000021920



Accredited  
Technicians

**Assuring Performance of Critical Environments  
Since 1974**



Micro-Clean  
177 N. Commerce Way  
Bethlehem, PA 18017

800-523-9852 or 610-867-5302  
Fax: 610-954-7803  
email: [micro-clean@microcln.com](mailto:micro-clean@microcln.com)  
[www.microcln.com](http://www.microcln.com)

## CERTIFICATE OF CALIBRATION

MODEL 9350-02 SERIAL NO. 93501244001  
DESCRIPTION TSI Airborne Particle Counter

***Micro-Clean Calibration Services does hereby certify that all performance and acceptance tests required were successfully conducted according to required specifications. All calibration data and test instrumentation used have been obtained using standards whose accuracies are traceable to the National Institute of Standards and Technology (NIST), have been derived from accepted values of natural physical constants, or by the use of ratio type of self calibration.***

***The calibration system complies with ANSI/NCSL Z540-1-2006.***

June 17, 2017  
Date of Calibration

September 16, 2017  
Next Calibration is Due

Thomas Dahl

17 JUN 2017  
Authorized Name/Signature/Date

MCI# / RPT# 121164 / 000005340



Accredited  
Technicians

Assuring Performance of Critical Environments  
Since 1974

## CERTIFICATE OF CALIBRATION

MODEL CA811 SERIAL NO. 1029CGCY  
DESCRIPTION AEMC Light Meter

***Micro-Clean Calibration Services does hereby certify that all performance and acceptance tests required were successfully conducted according to required specifications. All calibration data and test instrumentation used have been obtained using standards whose accuracies are traceable to the National Institute of Standards and Technology (NIST), have been derived from accepted values of natural physical constants, or by the use of ratio type of self calibration.***

***The calibration system complies with ANSI/NCSL Z540-1-2006.***

July 6, 2017  
Date of Calibration

January 5, 2018  
Next Calibration is Due

Brian Hess Brian Hess 06 JUL 2017  
Authorized Name/Signature/Date

MCH# / RPT# 100268 / 000016971



Accredited  
Technicians

Assuring Performance of Critical Environments  
Since 1974

## CERTIFICATE OF CALIBRATION

MODEL 325 SERIAL NO. 121001263  
DESCRIPTION Center Digital Sound Meter

***Micro-Clean Calibration Services does hereby certify that all performance and acceptance tests required were successfully conducted according to required specifications. All calibration data and test instrumentation used have been obtained using standards whose accuracies are traceable to the National Institute of Standards and Technology (NIST), have been derived from accepted values of natural physical constants, or by the use of ratio type of self calibration.***

***The calibration system complies with ANSI/NC SL Z540-1-2006.***

July 6, 2017  
Date of Calibration

October 5, 2017  
Next Calibration is Due

Chad Mason  06 JUL 2017  
Authorized Name/Signature/Date

MCH# / RPT# 122872 / 000016988



Accredited  
Technicians

**Assuring Performance of Critical Environments  
Since 1974**