

- KEYED NOTES
- 2A SEE 1/AS701 FOR TYP. BEDROOM A LAYOUT
  - 2B HOUSEKEEPING CLOSET WITH MOP SINK, 12" X 24" SST UTILITY SHELF AND MOPBROOM HOLDER. SEE SHEET AS800.
  - 2C SEE 1/AS704 FOR TYPICAL BEDROOM E LAYOUT

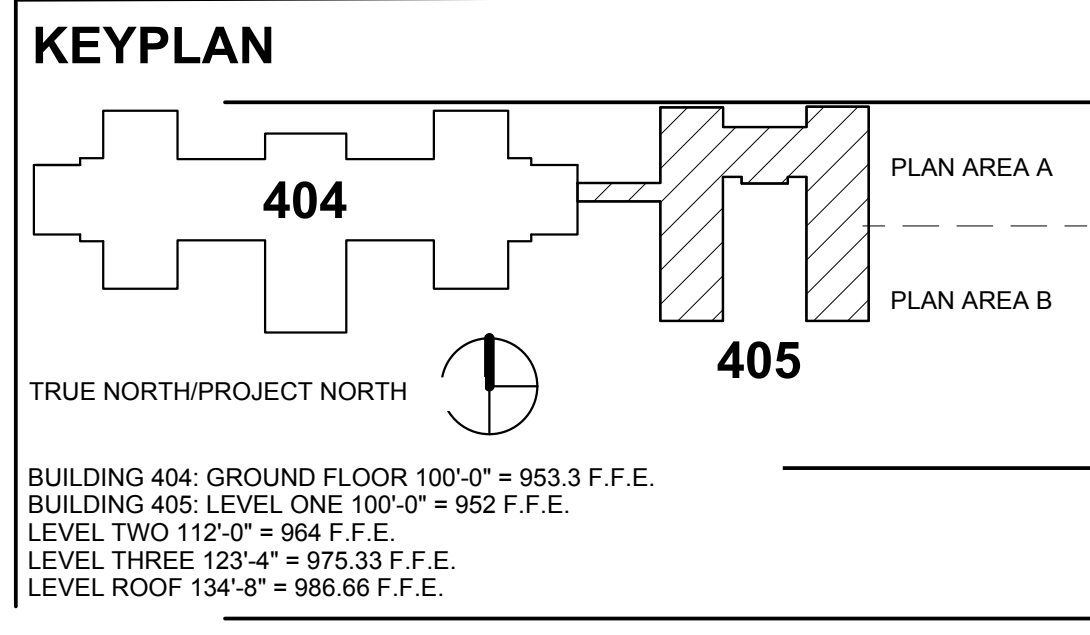

**1 FLOOR PLAN LEVEL TWO**  
1/8" = 1'-0"

			CONSULTANTS:			ARCHITECT/ENGINEERS:		Drawing Title FLOOR PLAN LEVEL TWO		Project Title COMPLETE CONSTRUCTION 1ST & 2ND FLOOR B405		Project Number 676-18-107		Office of Construction and Facilities Management		
										Building Number 405						
										Drawing Number 405 AS102						
										Dwg. 11 of 92						
No.	Revisions	Date						Approved: Project Director		Location VA MEDICAL CENTER TOMAH, WI		Date 07/25/2017		Checked VAS	Drawn JE/BH	Department of Veterans Affairs