

ELECTRICAL SYMBOLS

- PLAN NOTE DESIGNATION.
LUMINAIRE TYPE DESIGNATION. "2" = PROVIDE DIMMING BALLAST FOR LUMINAIRE.
CEILING MOUNTED FLUORESCENT LUMINAIRE. (NOTE 6)
WALL MOUNTED FLUORESCENT LUMINAIRE. (NOTE 6)
CEILING MOUNTED INCANDESCENT, FLUORESCENT OR HID LUMINAIRE. (NOTE 6)
WALL MOUNTED INCANDESCENT, FLUORESCENT OR HID LUMINAIRE. (NOTE 6)
FACED EXIT SIGN. SHADDED QUADRANT(S) INDICATES FACE(S). PROVIDE ARROWS AS INDICATED ON DRAWINGS. LUMINAIRE TYPE "X1", UNO.
WALL MOUNTED EXIT SIGN. SHADDED QUADRANT(S) INDICATES FACE(S). PROVIDE ARROWS AS INDICATED ON DRAWINGS. LUMINAIRE TYPE "X1", UNO.
GENERAL USE SWITCH, SINGLE POLE.
GENERAL USE SWITCH, THREE WAY.
GENERAL USE SWITCH, PILOT LIGHT TYPE. PILOT LIGHT IS "ON" WHEN SWITCH IS "ON".
TIME SWITCH OVERRIDE SWITCH.
OCCUPANCY SENSOR SWITCH. WALL MOUNTED. DUAL TECHNOLOGY TYPE (UNLESS OTHERWISE NOTED). INFRARED. TYPE "U" = ULTRASONIC TYPE. "2" = 2-POLE DUAL RELAYS; LOWER CASE ALPHABETIC SUBSCRIPT, WHERE SHOWN, INDICATES LOADS CONTROLLED. SET TIME DELAY TO AUTOMATIC UNLESS INDICATED OTHERWISE.
DUPLICATE RECEPTACLE, WALL. ALPHA-NUMERIC OR NUMERIC SUBSCRIPT, WHERE SHOWN, INDICATES CIRCUIT. "C" = MOUNT BOTTOM 0'-1" ABOVE BACKSPLASH / COUNTER. (TYPICAL FOR ALL RECEPTACLES)
DUPLICATE RECEPTACLE, FLOOR.
SPECIAL PURPOSE RECEPTACLE, WALL. "D" = DRIVER (NEMA 14-30R), "R" = RANGE (NEMA 14-50R), UNO.
JUNCTION BOX, WALL.
TELEDATA OUTLET, WALL. "W" = WALL TYPE TELEDATA OUTLET MOUNTED 54" AFF.
SMOKE DETECTOR, CEILING.
SMOKE DETECTOR, DUCT TYPE. SEE MECHANICAL DRAWINGS FOR EXACT LOCATION.
HEAT DETECTOR, CEILING.
FIRE ALARM MANUAL PULL STATION.
FIRE ALARM VISUAL DEVICE, NUMBER INDICATES CANDELA RATING OF VISUAL DEVICE.
FIRE ALARM CHIME WITH INTEGRAL VISUAL DEVICE, NUMBER INDICATES CANDELA RATING OF VISUAL DEVICE.
NURSES' CALL MASTER STATION.
NURSES' CALL EMERGENCY STATION, WALL.
NURSES' CALL CORRIDOR DOME LIGHT, WALL.
SOUND SYSTEM SPEAKER, CEILING.
208/120 VOLT PANELBOARD.
480/277 VOLT PANELBOARD.
DISCONNECT SWITCH, "N" = NON-FUSIBLE, "F" = FUSIBLE, "T" = TYPE, "P" = POLES, "R" = RATING, "A" = AMPERES, "D" = DISCONNECT SWITCH 3-POLES/60 AMP RATING/FUSED AT 45 AMP.
ENCLOSED CIRCUIT BREAKER, NUMBER INDICATES CIRCUIT BREAKER 3-POLES/100 AMP FRAME/60 AMP RATING.
MANUAL MOTOR STARTER WITH PILOT LIGHT, SURFACE MOUNTED. "P" = FLUSH MOUNTED.
COMBINATION MAGNETIC MOTOR STARTER AND FUSED DISCONNECT SWITCH.
GROUND CONNECTION.
SPRINKLER SYSTEM PRESSURE SWITCH.
SPRINKLER SYSTEM VALVE SUPERVISORY SWITCH.
RANGE CONTROL SWITCH. REFER TO WIRING DIAGRAM & DETAIL ON THIS DRAWING.
SURFACE CEILING/WALL MOUNTED SECURITY CAMERA.
WIRELESS ACCESS POINT

ELECTRICAL SYMBOLS

- INTERCOM OR INTERRUPTING CAPACITY
ISOLATED GROUND
INDICATED BY METAL CONDUIT INITIAL
JUNCTION BOX
KNOCKOUT
KILOVOLT
KILOVOLT-AMPERE REACTIVE
KILOWATT-HOUR
LIGHTNING ARRESTER
LOW PRESSURE SODIUM LIGHTING
LUMENS
MAGNETIC MANUAL ANTENNA TELEVISION
MAIN CIRCUIT BREAKER
MOTOR CONTROL CENTER
THOUSAND CIRCULAR MILS
MOTOR/GENERATOR
HEIGHT
MINIMUM
MAIN LUGS ONLY
MOTOR OPERATED DAMPER
MAGNETIC STARTER
MOUNTED OR MOUNTING METER
MERCURY VAPOR
NATIONAL ELECTRICAL CODE
NEUTRAL
NON-FUSIBLE SAFETY SWITCH
NUMBER
OVERHEAD
POLE
PULL BOX OR PUSHBUTTON
PUSHBUTTON STATION
PHASE
PANELBOARD
PRIMARY
POTENTIAL TRANSFORMER
POLYVINYL CHLORIDE
POWER
QUANTITY
RECEPTACLE
REFRIGERATOR
RIGID STEEL CONDUIT
RSC
SHORT CIRCUIT CURRENT
SDR
SECONDARY
SMR
SURFACE METAL RACEWAY
SURFACE SUPPRESSOR/ISOLATED GROUND
STARTER
SW
SWBD
SWITCHBOARD
SWGR
SYMMETRICAL
S/N
SOLID NEUTRAL
TC
TIME CLOCK
TEL
TELEPHONE
TYPICAL
UF
UNDERFLOOR
UG
UNDERGROUND, LABORATORIES UNLESS NOTED OTHERWISE
UNO
V
VOLT
VA
VOLT-AMPERE REACTIVE
VM
VOLT-METER
W
WATT OR WIRE
WP
WEATHERPROOF
XFER
TRANSFER
XFMR
TRANSFORMER

ELECTRICAL ABBREVIATIONS

- A OR AMP
ABV ABOVE
AC ALTERNATING CURRENT
ACB ABOVE COUNTER BACKSPLASH
ACD ABOVE COUNTER COUNTER DRIVE
AFF ABOVE FINISHED FLOOR
AIC AMPERES INTERRUPTING CAPACITY
AL ALUMINUM
AM AMP METER
ASYM ASYMMETRICAL
ATS AUTOMATIC TRANSFER SWITCH
AWG AMERICAN WIRE GAGE
BEL BELOW
BD BUS DUCT
BE BOT
BTR BOTTOM BREAKER
BRK BREAKER
C CABLE
CAB COMMUNITY ANTENNA TELEVISION OR CABLE
CATV TELEVISION
CB TV
CBT CIRCUIT BREAKER
CF COMPACT FLUORESCENT
CFL CIRCUIT
CEILING
CGR COUNTER
CMT COMBINATION
CONB CONDUCTOR
CONN CONNECTION
CONT CONTROLLER
COPPER
CU COPPER
CW COLD WATER
DB DOOR BELL
DC DIRECT CURRENT
DIM DIMENSION
DISC DISCONNECT
DIS DISCONNECT SERVICE
DIS DOOR SWITCH
DWG DRAWING
E OR EMER EMERGENCY
EL EXISTING TO BE RELOCATED
ELEC ELECTRIC(ELE)
ELEV ELEVATOR
EXIST EXISTING TO BE REMOVED
EXM EXISTING TO BE REMOVED AND RELOCATED TO THIS POSITION
EMN EXISTING TO BE REMOVED AND NEWLY INSTALLED
ENCL ENCLOSURE
ENG ENGINE
EXPLOSIONPROOF
EQUIP EQUIPMENT TO REMAIN
ERC ELEVATOR RECALL
EWC ELECTRIC WATER COOLER
EXIST EXISTING
EXT EXTERIOR
FA FIRE ALARM CONTROL PANEL
FDR FEEDER
FC FLOOR CANTILEVER
FSS FUSIBLE SAFETY SWITCH
FXTR FIXTURE
GEN GENERATOR
GF OR GROUND FAULT
GFI GROUND FAULT INTERRUPTER
GND GROUND
HG HORIZONTAL
HGT HOSPITAL GRADE
HID HIGH INTENSITY DISCHARGE
HDA HAND-OFF-AUTOMATIC
HPP HORSEPOWER OR HEAT PUMP
HPS HIGH POWER FACTOR
HTR HEATER
HW HOT WATER
HERTZ
H

THESE SYMBOLS AND ABBREVIATIONS ARE ELECTRICAL DEPARTMENT STANDARDS AND MAY NOT NECESSARILY BE APPLICABLE TO OR APPEAR ON THESE DRAWINGS, HOWEVER WHEREVER THESE SYMBOLS DO OCCUR ON THE DRAWINGS, THE ITEM SHALL BE PROVIDED AND INSTALLED. SEE ARCHITECTURAL DRAWINGS FOR ADDITIONAL ABBREVIATIONS.

- NOTES (ELECTRICAL SYMBOL LEGEND):
1. THESE ARE STANDARD SYMBOLS AND MAY NOT ALL APPEAR ON THE PROJECT DRAWINGS. HOWEVER, WHEREVER THIS SYMBOL APPEARS ON THE PROJECT DRAWINGS, THE ITEM SHALL BE FURNISHED AND INSTALLED.
2. UNLESS NOTED OTHERWISE, MOUNTING HEIGHTS ARE FROM FINISHED FLOOR TO CENTERLINE OF OUTLET, WHERE THE MOUNTING HEIGHT INDICATED ON PLAN IS DIFFERENT FROM THE LEGEND, THE PLAN TAKES PRECEDENT.
3. INSTALL RECEPTACLE AND TELEPHONE OUTLET BOXES (OR OTHER OUTLET BOXES SUCH AS TV, COMPUTER ETC.) 6" APART (EDGE TO EDGE) WHERE SHOWN SIDE BY SIDE ON WALL.
4. SEE ELECTRICAL ABBREVIATIONS FOR ALPHABETIC SUBSCRIPT WITH SYMBOL, UNO.
5. ARROW(S) INDICATE DIRECTION OF MAXIMUM LIGHT DISTRIBUTION.
6. " " = COMPLETE LUMINAIRE CONNECTED ON EMERGENCY CIRCUIT.
7. FIRE ALARM VISUAL DEVICE (STAND-ALONE OR INTEGRAL STROBE) SHALL BE LOCATED 30" INCHES TO THE BOTTOM ABOVE THE HIGHEST FLOOR LEVEL BELOW THE SPACE OR 6" INCHES TO THE TOP BELOW THE CEILING, WHICHEVER IS LOWER.

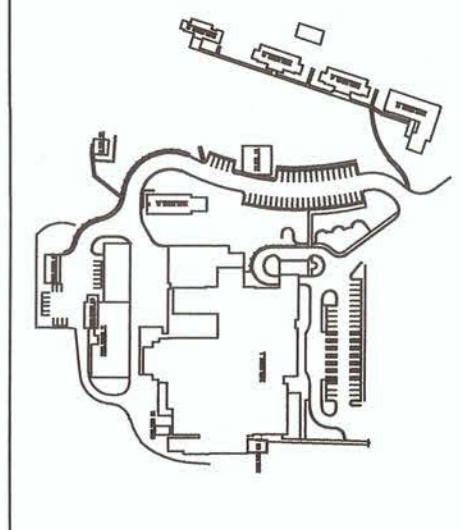

General Notes :

- 1. All work and equipment shall be in accordance with all applicable codes, ordinances and N. E. C. current edition.
2. All wiring shall be in conduit, unless otherwise noted. Minimum size shall be #12 AWG minimum, type THWN insulation or required by N. E. C.
3. Wire and cable shall be #12 AWG minimum, type THWN insulation unless otherwise indicated on the drawings. Conductors shall be copper #10 AWG and smaller shall be #8 AWG and larger shall be stranded. All work and material shown is new and shall be provided by the contractor, unless otherwise noted.
4. Grounding shall be provided for all enclosures. Provide separate equipment grounding conductor in all new work, sized as indicated on the drawings.
5. Any openings created in a fire or smoke rated wall by provision of any electrical device or conduit shall be sealed after the work is completed with a UL-approved fire/smoke sealant appropriate to re-establish the previous rating of the wall.
6. Contractor may utilize existing cable trays for routing of power and system cabling. Contractor shall verify maximum fill per cross sectional area per N. E. C. is not exceeded.
7. Where a new-to-existing connection is indicated, the contractor shall provide all materials (junction boxes, conduit, wire, etc.) and labor required to make the connection.
8. Contractor shall replace all damaged ceiling tile and grid at no additional cost.

WIRELESS NETWORK NOTES:

- 1. Contractor will be connecting to existing network. Contractor to comply with all VA IT requirements.
2. All equipment used to connect to existing network will match what is presently being used. All submittals will be reviewed and approved by OIR and IT department before any equipment is ordered.

Table with 4 columns: Item, Description, Qty, Model #. Includes items like CISCO UCS C220 M3 RACK SERVER, CISCO PRIME INFRASTRUCTURE UCS HARDWARE APPLIANCE, 3850 stackable switches, Uplink Module, Power Supply, Stack cable, Power stack cable, Fiber SFP's, Smartnet, AP's, and AP FIPS kit.

Medical Center Av
200 Veterans Av
Beckley, WV. 25801
DRAWING No. EY-100
PROJECT No. 517-17-101
DRAWN BY: JPP
CHECKED BY: KB, JH
DATE: 8/16/2017
REV. N/A
SCALE: NTS

APPROVED: MEDICAL CENTER DIRECTOR
STACY J. VASQUEZ
APPROVED: ASSOCIATE DIRECTOR
JOHN D. STOUT
APPROVED: CHIEF OF STAFF

APPROVED: CHIEF, FACILITIES MANAGEMENT SERVICE LINE
JOHN MONTGOMERY
APPROVED: ASSOCIATE DIRECTOR FOR PATIENT CARE SERVICES/EXECUTIVE NURSE
DEBRA LEGG, RN, MSN
APPROVED: SERVICE LINE CHIEF

APPROVED: SAFETY MANAGER
JUSTIN GREENE
APPROVED: INFECTION CONTROL
APPROVED:

APPROVED:
APPROVED:
APPROVED:

APPROVED:
APPROVED:
APPROVED:

Medical Center Av
200 Veterans Av
Beckley, WV. 25801
DRAWING No. EY-100
PROJECT No. 517-17-101
DRAWN BY: JPP
CHECKED BY: KB, JH
DATE: 8/16/2017
REV. N/A
SCALE: NTS