

NOT TO SCALE

DRAWING TITLE:	DRAWING No.
Building 10 - New Work Continuous Water monitoring System	EY-102
PROJECT TITLE:	PROJECT No.
Correct Water System for Legionella Phase 2	517-17-101
DATE	DRAWN BY:
8/16/2017	JPP
REV.	SCALE
	NTS
CHECKED BY:	
KB, JH	

APPROVED: MEDICAL CENTER DIRECTOR
STACY J VASQUEZ
APPROVED: ASSOCIATE DIRECTOR
JOHN D. STOUT
APPROVED: CHIEF OF STAFF
JOHN D. BERRYMAN, M. D.

APPROVED: CHIEF, FACILITIES MANAGEMENT SERVICE LINE
JOHN MONTGOMERY
APPROVED: ASSOCIATE DIRECTOR for PATIENT CARE SERVICES/EXECUTIVE NURSE
DEBRA LEGG, RN, MSN
APPROVED: SERVICE LINE CHIEF

APPROVED: SAFETY MANAGER
JUSTIN GREENE
APPROVED: INFECTION CONTROL

APPROVED:
APPROVED:
APPROVED:

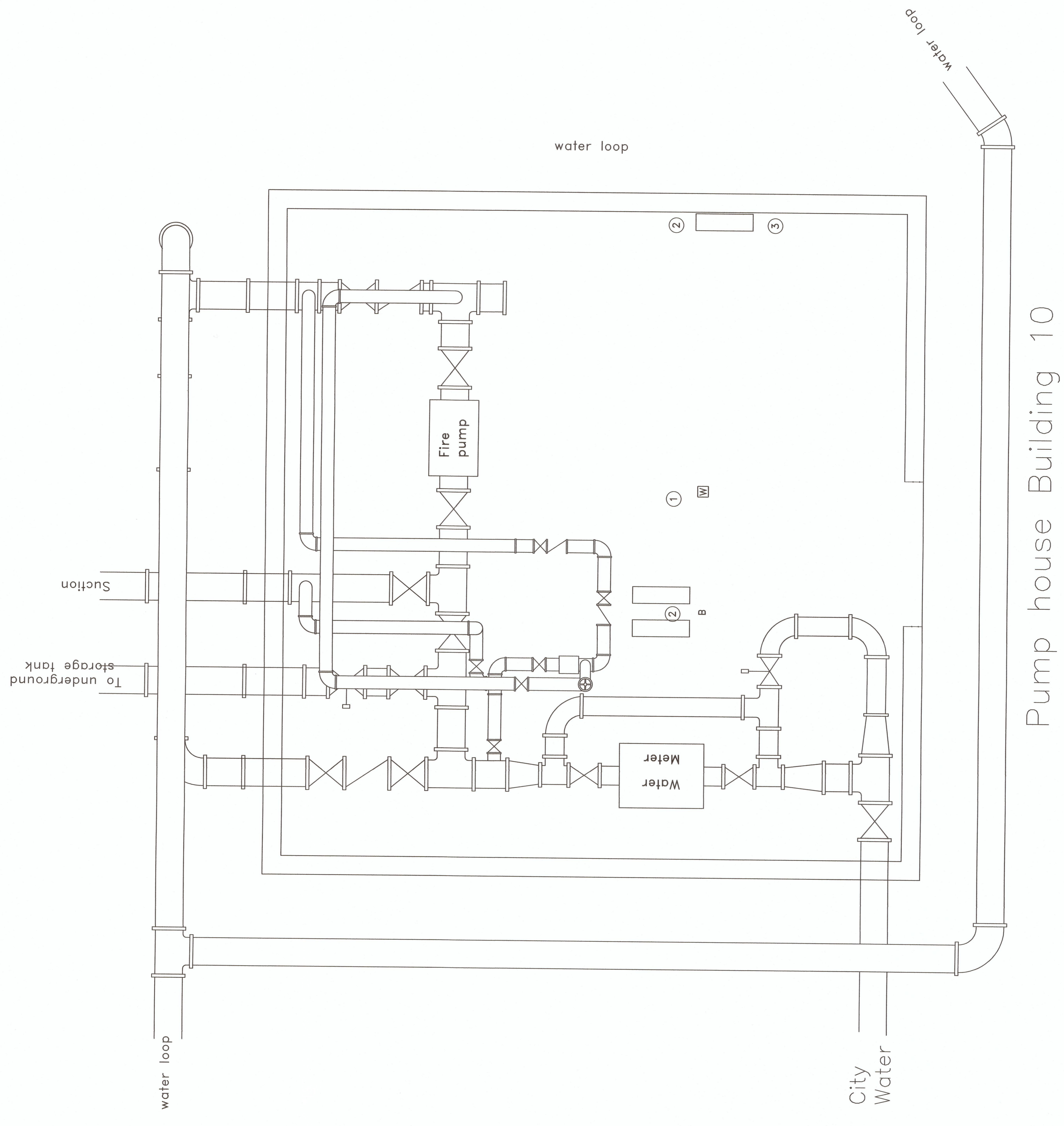
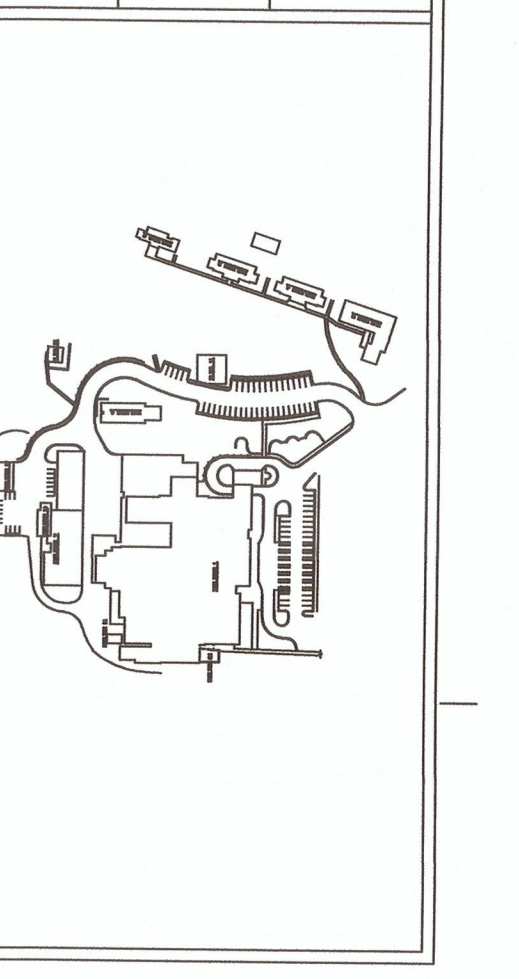

General Notes :

- A. See this drawing for monitor module locations.
- B. Monitors are to be mounted on a steel frame anchored to the floor and ceiling. Frame to be primed and painted. See COR for color.

Notes :
(This sheet only)

- ① Provide wireless communication and strong signal to support water monitoring system. See mechanical sheets for locations of monitoring devices. Provide CAT 6 cable in 1" surface mounted conduit.
- ② Provide surface mounted duplex receptacle. Provide cast type surface box with threaded hubs. provide 2#12, #12G in 1/2" conduit surface from nearest existing receptacle circuit. Anticipated max. load is 0.5 amps.
- ③ Mount Switch in this general location.
- ④ Provide fiber optic cable from switch in building 2 basement to building 10 through existing space. Conduit runs from building 2 to building 7. See COR for location of Conduit.

